

1	PAINTED DIRECTIONAL ARROW
2	PAINTED DRIVE—THRU GRAPHICS
58	90° PARKING STALL
6	DIRECTIONAL SIGNAGE (SEE SIGNAGE PACKAGE)
66	"PEDESTRIAN CROSSWALK" SIGN (SEE SIGNAGE PACKAGE)
69	"MEAL DELIVERY ZONE" SIGN
9	RETURNED CURB ACCESSIBLE RAMP
11	TYPICAL CONCRETE SIDEWALK
12	SIDEWALK WITH CURB & GUTTER SECTION
13	DRIVE—THRU PLAN
14	DRIVE—THRU ISOMETRIC
16	LANDSCAPE & IRRIGATION PROTECTOR
17	CONCRETE CURB & GUTTER
20	CONCRETE BOLLARD
21	TYPICAL PAVEMENT SECTION — HEAVY DUTY
22	TRANSVERSE & LONGITUDINAL CONTRACTION JOINT
23	TRANSVERSE & LONGITUDINAL DOWELED CONSTRUCTION JOINT
24	CONCRETE APRON @ TRASH ENCLOSURE
25	STAMPED CONCRETE PAVING DRIVE—THRU LANE
26	ALUMINUM HANDRAIL
28	CONTRACTION JOINT
29	KEYED CONSTRUCTION JOINT
30	LONGITUDINAL BUTT JOINT
31	EXPANSION JOINT
32	MULTI—LANE DIRECTIONAL GRAPHICS
33	PAINTED CROSS WALK
34	MENU BOARD & CANOPY ORDERING STATION
35	MENU BOARD LOOP DETECTION SYSTEM
36	5'x5' LANDING AND ENTRY DOOR FROST SLAB
39	LANDSCAPED AREA (SEE LANDSCAPE PLAN)
40	CLEARANCE BAR (SEE SIGNAGE PACKAGE)
41	PAVEMENT STRIPING AREA
42	THICKENED SLAB EDGE AT RAILING CORE—DRILLS
45	EX./PROP. ASPHALT INTERFACE
46	EX./PROP. CONCRETE INTERFACE
47	SINGLE BIKE RACK
50	RELOCATED FLAGPOLE
53	4" THICK CONCRETE STRIP BETWEEN BUILDING AND BACK OF CURB
54	4" THICK CONCRETE STRIP BETWEEN CURBS
55	4" WIDE PAINT STRIPE
58	MAGNETIC DELINEATOR
59	PROPOSED F2F CANOPY — SEE FASHION CANOPY PLANS
60	PROPOSED OMD CANOPY — SEE FASHION CANOPY PLANS
61	RELOCATED GROUND MOUNTED LIGHT
62	PROPOSED CONCRETE RIBBON CURB

DETAIL 1/C-400
DETAIL 2/C-400
DETAIL 5/C-400
DETAIL 6/C-400
DETAIL 66/C-400
DETAIL 58/C-440
DETAIL 9/C-400
DETAIL 11/C-400
DETAIL 12/C-400
DETAIL 13/C-410
DETAIL 14/C-410
DETAIL 16/C-410
DETAIL C-500
DETAIL 20/C-410

DETAIL 22/C-420
DETAIL 23/C-420
DETAIL 24/C-420
DETAIL SHEET C-200
DETAIL 4/A-101
DETAIL 28/C-420
DETAIL 29/C-420
DETAIL 30/C-420
DETAIL 31/C-420
DETAIL 32/C-430
DETAIL 33/C-430
DETAIL 34/C-430
DETAIL 35/C-430
DETAIL 36/C-430

DETAIL 41/C-430
DETAIL 42/C-440
DETAIL 45/C-440
DETAIL 46/C-440
DETAIL 47/C-440

DETAIL 57/C-440

DETAIL 62/C-210

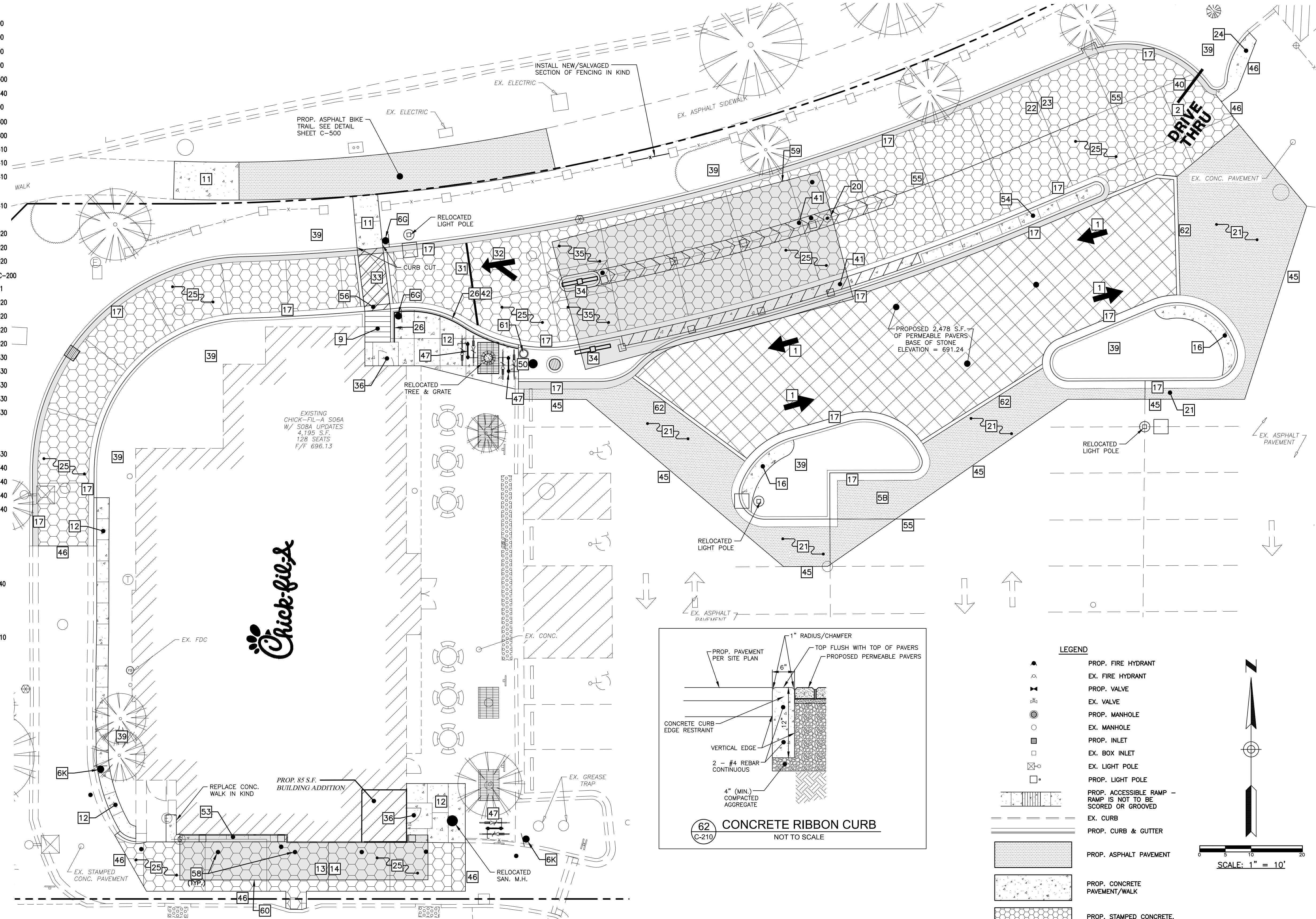

NOTE: CONTRACTOR TO VERIFY SIGNAGE ITEMS WITH CLAYTON SIGNS PRIOR TO THE START OF CONSTRUCTION.

CONTRACTOR RESPONSIBLE TO FIELD VERIFY LOCATIONS AND ELEVATIONS OF EXISTING UTILITY TIE-INS AND CROSSINGS AS SHOWN ON SITE PLANS (SANITARY, STORM, WATER, GAS, ELECTRIC, PHONE, ETC.) PRIOR TO THE START OF CONSTRUCTION. CONTACT ALLAN WILEY AT GBC DESIGN, INC., 330-836-0228, WITH ANY CONCERNS OR CONFLICTS PRIOR TO THE START OF CONSTRUCTION. CONTRACTOR TO VERIFY THE THICKNESS OF ANY OFF-SITE PAVEMENT (ASPHALT AND CONCRETE) AND SIDEWALK SO THE RESTORATION WORK IS INCLUDED IN THE BID.



Chick-fil-A
5200 Buffington Road
Atlanta, Georgia 30349-2998

GBC DESIGN, INC.

565 White Pond Dr. Akron, OH 44320-1123
 Phone 330-836-0228 Fax 330-836-5782

Akron, OH 44320-1123
Fax 330-836-5782

565 White Pond Dr.
Phone 330-836-0228

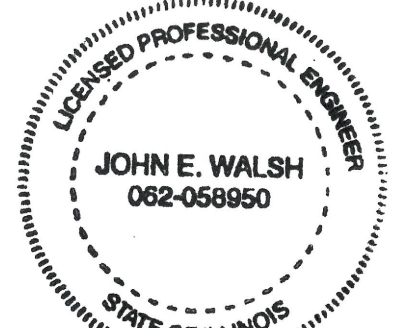

Signature [Signature]
Date 3/5/21
License Expires 11/30/2021

CHICK-FIL-A
ORLAND PARK FSU
2020 REINVESTMENT
15605 SOUTH LA GRANGE ROAD
ORLAND PARK, IL 60462

FSU# 02638

REVISION SCHEDULE		
NO.	DATE	DESCRIPTION
1	10/6/2020	CITY COMMENTS
2	1/27/2021	CITY COMMENTS

GBC PROJECT #	52188R
PRINTED FOR	Permit
DATE	5/1/20
DRAWN BY	B.A.W.

Information contained on this drawing and in all digital files produced for above named project may not be reproduced in any manner without express written or verbal consent from authorized project representatives.

SHEET
**SITE PLAN
 DETAIL**
 Permit
 SHEET NUMBER

C-210