



JGS	2019/12/28
JGS	2020/05/1

JGS	2020/07/1
JGS	2020/07/2
JGS	2020/12/1

<u>GANOPIY TREES</u>	<u>BOTANICAL / COMMON NAME</u>	<u>COND</u>	<u>SIZE</u>	<u>QTY</u>
CEL OCC	CELTIS OCCIDENTALIS / COMMON HACKBERRY	B # B	2.5' GAL	5
TIL RED	TILIA AMERICANA 'REDMOND' / REDMOND AMERICAN LINDEN	B # B	2.5' GAL	5
TIL GRE	TILIA CORDATA 'GREENSPIRE' / GREENSPIRE LITTLELEAF LINDEN	B # B	2.5' GAL	4

<u>EVERGREEN TREES</u>	<u>BOTANICAL / COMMON NAME</u>	<u>COND</u>	<u>SIZE</u>	<u>QTY</u>
JUN HIL	JUNIPERUS VIRGINIANA 'HILLSPIRE' / HILLSPIRE JUNIPER	B	4' HT.	2
PIC ABI	PICEA ABIES / NORMAY SPRUCE	B	6' HT.	3
PIC COL	PICEA PUNGENS 'COLORADO GREEN' / BLUE SPRUCE	B	6' - 8' HT.	6
PIN STR	PINUS STROBUS / WHITE PINE	B	6' - 8' HT.	4
THU GR2	THUJA STROBILIF. x PLICATA 'GREEN GIANT' / GREEN GIANT ARBORVITAE	B	6' HT.	3

<u>UNDERSTORY TREES</u>	<u>BOTANICAL / COMMON NAME</u>	<u>COND</u>	<u>SIZE</u>	<u>QTY</u>
AME AJ2	AMELANCHIER CANADENSIS 'AUTUMN BRILLIANCE' / AUTUMN BRILLIANCE SERVICEBERRY	B & B	8' CLUMP	2
SYR IVO	SYRINGA RETICULATA 'IVORY SILK' / IVORY SILK JAPANESE TREE LILAC	B & B	8' CLUMP	3

<u>DECIDUOUS SHRUBS</u>	<u>BOTANICAL / COMMON NAME</u>	<u>COND.</u>	<u>SIZE</u>	<u>QTY</u>
CEA AME	CEANOTHUS AMERICANUS / NEW JERSEY TEA	B # B	30" HT.	12
COT ACU	COTONEASTER AGUTIFOLIUS / PEKING COTONEASTER	B # B	36" HT.	7
PHY AMT	PHYSOCARPUS OPULIFOLIUS / AMBER JUBILEE / NINEBARK	B # B	36" HT.	8
RIB EUR	RIBES ALPINUM 'EUROPA' / ALPINE CURRANT	B # B	36" HT.	7
SYR CHA	SYRINGA VULGARIS 'CHARLES JOLY' / CHARLES JOLY LILAC	B # B	36" HT.	8
VIB LUS	VIBURNUM DENTATUM 'CHICAGO LUSTER' / CHICAGO LUSTER ARROWWOOD	B # B	36" HT.	9

<u>EVERGREEN SHRUBS</u>	<u>BOTANICAL / COMMON NAME</u>	<u>COND.</u>	<u>SIZE</u>	<u>QTY</u>
PIN CUS	PINUS MUGO 'VALLEY CUSHION' / VALLEY CUSHION MUGO PINE	B & B	30" HT.	10
THU HOL	THUJA OCCIDENTALIS 'HOLMSTRUP' / HOLMSTRUP CEDAR	B & B	36" HT.	17

1. PLANT QUALITIES SHOWN IN THE PLANT SCHEDULE ARE FOR CONVENIENCE ONLY. THE CONTRACTOR IS RESPONSIBLE FOR PROVIDING AND INSTALLING ALL MATERIALS SHOWN ON THE PLAN AND SHOULD NOT RELY ON THE PLANT SCHEDULE FOR DETERMINING QUALITIES.

- II. SIZE AND GRADING STANDARDS OF PLANT MATERIALS SHALL CONFORM TO THE LATEST EDITION OF ANSI Z60.1, AMERICAN STANDARDS FOR NURSERY STOCK, BY THE AMERICAN NURSERY & LANDSCAPE ASSOCIATION.

12. REFER TO PLAN OF SURVEY FOR LEGAL DESCRIPTION, BOUNDARY DIMENSIONS AND EXISTING CONDITIONS.
13. ALL PLANT MATERIAL ON THIS PLANTING PLAN REPRESENTS THE INTENTION AND INTENSITY OF THE PROPOSED LANDSCAPE MATERIAL. THE EXACT SPECIES AND LOCATIONS MAY VARY IN THE FIELD DUE TO MODIFICATIONS IN THE SITE IMPROVEMENTS AVAILABILITY OF PLANT MATERIAL AT THE TIME OF INSTALLATION. ANY SUCH CHANGES MUST FIRST BE APPROVED BY THE VILLAGE IN WRITING.
14. ALL PLANT MATERIAL SHALL BE PLANTED WITH A MINIMUM OF SIX INCHES OF ORGANIC SOIL AND MULCHED WITH MERRIMAC STONE MULCH TO A 2" DEPTH.
15. ALL BEDS SHALL BE EDGED, HAVE KEEP PREEMERGENTS APPLIED AT THE RECOMMENDED RATE.
16. ALL PARKWAYS AND PARKING LOT ISLANDS SHALL HAVE SOD AS A GROUNDCOVER, UNLESS OTHERWISE NOTED.
17. ALL LAWN AREAS ON THIS PLAN SHALL BE GRADED SMOOTH AND TOPPED WITH AT LEAST 4" OF TOPSOIL. ALL LAWN AREAS TO BE ESTABLISHED USING SOD UNLESS OTHERWISE NOTED.
18. THIS LANDSCAPE PLAN ASSUMES THE SITE WILL BE PREPARED WITH TOP SOIL, SUITABLE FOR THE ESTABLISHMENT OF THE LANDSCAPE MATERIAL PRESENTED ON THIS PLAN. IF ADDITIONAL TOP SOIL IS REQUIRED IT IS UP TO THE LANDSCAPE CONTRACTOR ON THE PROJECT TO PROVIDE, SPREAD AND PREPARE THE SITE AS NEEDED FOR THE IMPLEMENTATION OF THIS LANDSCAPE PLAN.
19. CONTRACTORS MUST VERIFY ALL QUANTITIES AND OBTAIN ALL PROPER PERMITS AND LICENSES FROM THE PROPER AUTHORITIES.
20. ALL MATERIAL MUST MEET INDUSTRY STANDARDS AND THE LANDSCAPE ARCHITECT HAS THE RIGHT TO REFUSE ANY POOR MATERIAL OR WORKMANSHIP.
21. LANDSCAPE ARCHITECT IS NOT RESPONSIBLE FOR UNSEEN SITE CONDITIONS.
22. ALL PLANTINGS SHALL BE SPACED EQUAL DISTANT, BACK FILLED WITH AMENDED SOIL IN A HOLE TWICE THE ROOTBALL DIAMETER, WATERED, FERTILIZED, PRUNED, AND HAVE ALL TAGS AND ROPES REMOVED.
23. TREES SHALL BE STAKED AND GUYPED, AND HAVE A WATERING SAUCER AT BASE.
24. ALL BEDS TO BE BERNED 12" TO 24" ABOVE GRADE AND MEET DRAINAGE REQUIREMENTS.
25. LAWN AND BED AREAS SHALL BE ROTOTILLED, RAKED OF CLUMPS AND DEBRIS.
26. REMOVE ALL DEAD AND DISEASED PLANT MATERIAL FROM SITE AND DISPOSE OF PROPERLY.
27. PRUNE AND FERTILIZE ALL EXISTING VEGETATION TO REMAIN ON SITE.

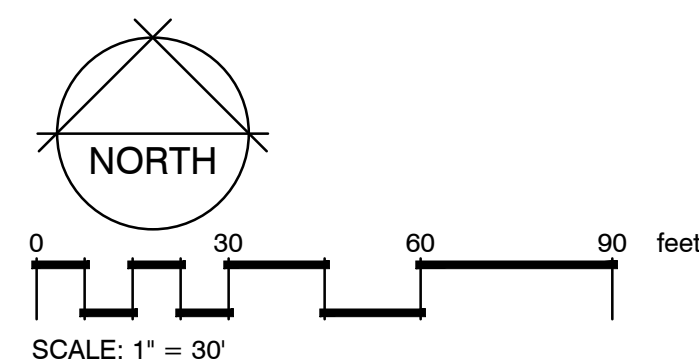

© 2018 Copyright. This Drawing is the Property of John G. Schiera Landscape Architects, Inc. All Rights Reserved.

JOB NUMBER:

L-11