



ORLAND  
PARK

# VILLAGE OF ORLAND PARK

## PARKS CONCEPTUAL MASTER PLANNING & DESIGN

February 8, 2021

---

# JSD Professional Services, Inc.

---



LORI VIEROW

SENIOR LANDSCAPE ARCHITECT  
WALKED 60 MILES IN  
THREE DAYS

---



SARAH DREIER

LANDSCAPE ARCHITECT  
HAS MADE 93  
CONSECUTIVE FREE THROWS

---



DAVE ROBERTS

SENIOR PROJECT ENGINEER  
CAN TALK LIKE ELMO

---

**Multidisciplinary** Firm of Landscape  
Architects, Planners, Engineers & Surveyors

We **custom-tailor** every project to the  
**unique** needs of the community

Create the Vision  Tell the Story

# Team Members

---



JAMES PETRAKOS

PRINCIPAL ARCHITECT  
HAS TAKEN HELICOPTER  
PILOT LESSONS

---



FRANK COVELLI

SURVEY CONSULTANT  
IS A CERTIFIED SCUBA DIVER

---



BONNIE COVELLI

SURVEY RESEARCHER  
ALSO A CERTIFIED SCUBA DIVER

---



**OVER 16 YEARS IN BUSINESS**

Proudly serving our clients since 2004

**OVER \$500M IN CONSTRUCTION PROJECTS**



Pathways Resource Group, Inc.

Services include: **Surveys**, Research, **Needs Assessments**, Strategy, Business & Talent Development

Focused on **Flexible & Creative** Solutions

February 4, 2021

20-10081 MISTY MEADOWS PARK: PROJECT SCHEDULE

Design Development	
Week of December 7	Virtual Kick-off Meeting with the Client and JSD to discuss park amenities and neighborhood ideas.
December 14 -24	JSD will conduct a design charrette and prepare two conceptual plans, including opinion of probable construction costs.
Week of December 28 or January 4	Meet with the Client to review the conceptual designs and discuss revisions. We will also gain authorization to proceed with the public meeting presentation.
Week of January 11	JSD to lead the Public Meeting and present two concepts to the residents and gain feedback. We will revise the plans into the Final Master Plan and gain authorization to proceed with Construction Documents.
Construction Documents	
January 18 – February 19	JSD prepares 85% Construction Documents, Technical Specifications and revised Opinion of Probable Construction Costs (OPCC)
February 22	85% Submittal – Recreation Department to review and provide comments/mark-ups by <b>March 1, 2021</b> .
March 1	Receive Recreation Department comments
March 1 - 19	JSD prepares 100% CDs, Project Manual, and revised/updated OPCC.
March 22	100% Submittal – Recreation Department to review and provide comments/mark-ups by <b>March 29</b> .
March 29	Receive Recreation Department comments
March 29 - 31	Team revises documents per comments received and prepares Issued for Bid documents.
Bidding Period	
April 1	Advertise for Bid
April 16	Bid Opening at 2:00 PM

• Idaho • Illinois • Wisconsin  
[www.jsdinc.com](http://www.jsdinc.com)



# PROJECT MANAGER & COMMUNICATION

- Day To Day Management
- Timely Communication
  - Phone calls
  - Email
  - Zoom & Microsoft Teams
- Team Management, Schedules, & Design Strategies
- Public Facilitation Lead
- Quality Control & Review
- Ensure Project Remains on Schedule and Budget

*“if a topic takes more than three emails, we pick up the phone”*







# PUBLIC INVOLVEMENT

# PUBLIC PROCESS



## **VISIONING SESSIONS (3-4)**

- Village Board/Staff
- Recreation Advisory Board
- Elected Officials
- Key Community Leaders

## **FOCUS GROUPS (2-4)**

- Athletic Affiliates
- School District 135, School District 230, Kirby School District 140
- Event Coordinators

## **PUBLIC FORUM**

- Community Open House/Neighborhood Meetings (12)
- Statistically Valid-Survey
- YouTube Meeting/Zoom/Teams Meetings

## **OUTREACH/SOCIAL MEDIA**

- YouTube/Project Webpage/Facebook
- Student-Parent School Assignment
- Pop-up Events/Village Event Participation
- Posters/Brochures/Social Media



# COMMUNITY- WIDE SURVEY



# EXAMPLE SURVEY QUESTIONS

## Statistically Significant Survey

### Sample Questions:

#### ❖ Current Use

- *How often did you or members of your household visit the following park sites located in Orland Park...*

#### ❖ Desired Use

- *What type of facilities, parks, recreation activities would you like to see developed in Orland Park?*

#### ❖ Satisfaction

- *Please indicate your overall satisfaction with...*

#### ❖ Demographics

- *Example: age of members in the household*

#### ❖ Open Ended/Other

- *Based on input from public engagement & staff*



#### **Category: Desired Use of Facilities, Parks, Recreation**

This list will be modified based on recommendations from staff and t

6. What type of facilities would you like to see developed in the V

	High Priority	Low Priority
Baseball Field(s)	<input type="checkbox"/>	<input type="checkbox"/>
Basketball Court(s)	<input type="checkbox"/>	<input type="checkbox"/>
Dog Park	<input type="checkbox"/>	<input type="checkbox"/>
Fishing Pier	<input type="checkbox"/>	<input type="checkbox"/>
Frisbee Golf	<input type="checkbox"/>	<input type="checkbox"/>
Football Field(s)	<input type="checkbox"/>	<input type="checkbox"/>
Inline roller/ Ice Hockey Rink	<input type="checkbox"/>	<input type="checkbox"/>
Lacrosse Field(s)	<input type="checkbox"/>	<input type="checkbox"/>
Open Space (Undeveloped)	<input type="checkbox"/>	<input type="checkbox"/>
Outdoor Fitness Equipment	<input type="checkbox"/>	<input type="checkbox"/>
Outdoor Skate Board Park	<input type="checkbox"/>	<input type="checkbox"/>
Outdoor Water "Play" Feature	<input type="checkbox"/>	<input type="checkbox"/>
Parking (Additional Parking)	<input type="checkbox"/>	<input type="checkbox"/>
Picnic Area Shelter	<input type="checkbox"/>	<input type="checkbox"/>
Playground Equipment	<input type="checkbox"/>	<input type="checkbox"/>
Recreation Center	<input type="checkbox"/>	<input type="checkbox"/>
Teen/Active Adult Center	<input type="checkbox"/>	<input type="checkbox"/>
Soccer Field (s)	<input type="checkbox"/>	<input type="checkbox"/>
Softball Field (s)	<input type="checkbox"/>	<input type="checkbox"/>
Splash Pad	<input type="checkbox"/>	<input type="checkbox"/>
Tennis Court (s)	<input type="checkbox"/>	<input type="checkbox"/>
Trails	<input type="checkbox"/>	<input type="checkbox"/>
Volleyball Court(s) Sand	<input type="checkbox"/>	<input type="checkbox"/>
Volleyball Court(s) Indoor	<input type="checkbox"/>	<input type="checkbox"/>
Walking Path	<input type="checkbox"/>	<input type="checkbox"/>
Other _____	<input type="checkbox"/>	<input type="checkbox"/>



# PROPOSED TIMELINE

# SCHEDULE/ TIMELINE

## PROJECT INITIATION & INFORMATION GATHERING

- |  |                    |
|--|--------------------|
| <input type="checkbox"/> Contract Award/Kick-off Meeting     | March 2021         |
| <input type="checkbox"/> Site Inventory/Analysis/Site Survey | March – April 2021 |
| <input type="checkbox"/> Visioning Sessions                  | April 2021         |

## COMMUNITY ENGAGEMENT

- |  |                  |
|--|------------------|
| <input type="checkbox"/> Public Meetings/Community Input | April – May 2021 |
| <input type="checkbox"/> Statistically Valid Survey      | April – May 2021 |
| <input type="checkbox"/> Staff Meeting                   | May – June 2021  |

## CONCEPTUAL DESIGN

- |   |                  |
|---|------------------|
| <input type="checkbox"/> Prepare Conceptual Design Alternatives | June 2021        |
| <input type="checkbox"/> COW/Rec Advisory Board/Staff Review    | June – July 2021 |
| <input type="checkbox"/> Public Engagement Meetings             | July 2021        |
| <input type="checkbox"/> Village Board of Trustees Presentation | July 2021        |

## FINAL MASTER PLANS

- |   |                          |
|---|--------------------------|
| <input type="checkbox"/> Prepare Draft Final Master Plans       | August 2021              |
| <input type="checkbox"/> Public Engagement Meetings             | September 2021           |
| <input type="checkbox"/> COW/Rec Advisory Board/Staff Review    | September – October 2021 |
| <input type="checkbox"/> Prepare Final Master Plan/Report       | October 2021             |
| <input type="checkbox"/> Village Board of Trustees Presentation | November 2021            |
| <input type="checkbox"/> Adoption of Master Plans               | November 2021            |





# O'NEIL PARK MASTER PLAN







Bloomington Parks, Recreation and Cultural Arts Department

### O'Neil Park Master Plan Public Workshop



### O' Neil Park

1515 W Chestnut Street

- 18.70 Acres
- Existing Park Elements
  - Pool
  - Baseball/softball fields
  - Playground
  - Half court basketball



### O' Neil Park

Parks, Recreation & Cultural Arts Department



### O' Neil Park



### O' Neil Park

Parks, Recreation & Cultural Arts Department



■ Aquatic Elements



■ Park Elements



# ASPEN TRAILS PARK



# ASPEN TRAILS PARK

## MASTER PLAN & OSLAD GRANT MOUNT PROSPECT, IL

### A Happy Trails to You



### C Climb With Me



CIRCLE YOUR FAVORITE THEME



#### RANK 5 ITEMS IN EACH THEME (In Order of Most Importance)

##### Happy Trails to You (A1 to A15)

##### Let's Play House (B1 to B14)

##### Climb With Me (C1 to C14)

1	_____
2	_____
3	_____
4	_____
5	_____

1	_____
2	_____
3	_____
4	_____
5	_____

1	_____
2	_____
3	_____
4	_____
5	_____





# ASPEN TRAILS PARK

## MASTER PLAN & OSLAD GRANT MOUNT PROSPECT, IL







# HERITAGE PARK

# HERITAGE PARK

## SITE ACQUISITION AND VILLAGE HALL VILLAGE OF HOMER GLEN

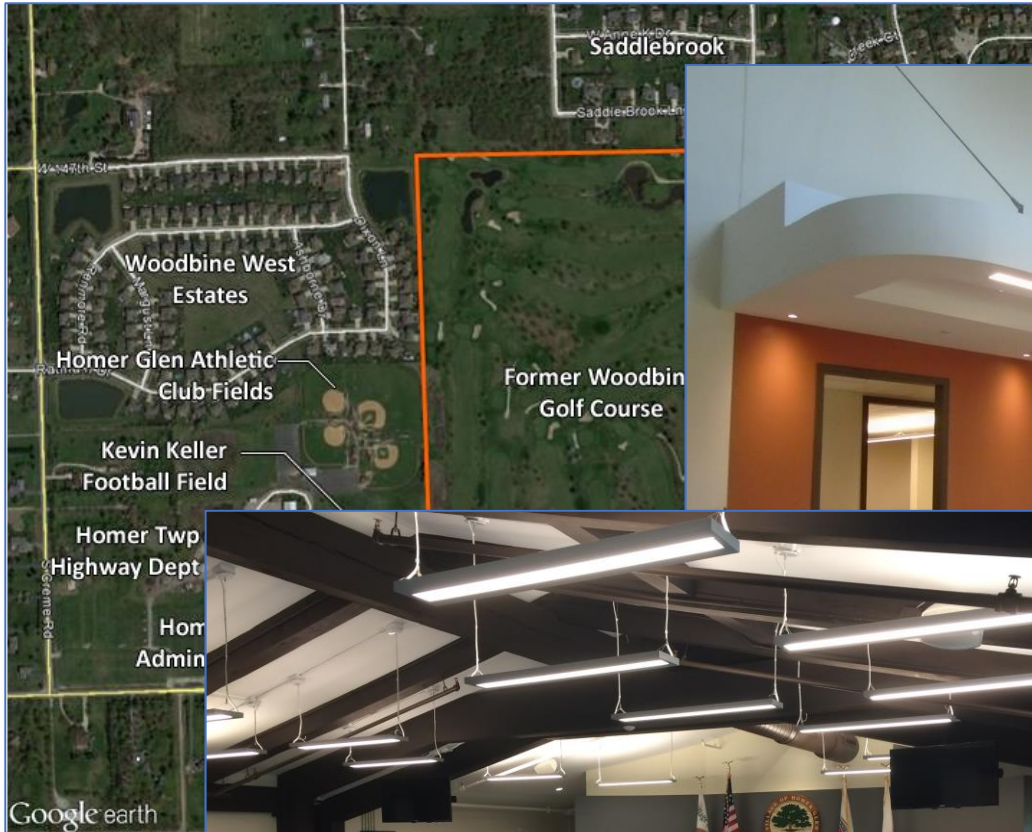



# HERITAGE PARK

## INITIAL MASTER PLANNING

### VILLAGE OF HOMER GLEN

Put  
- W  
Ser  
- Fo  
So  
P  
N  
Pa  
But  
Th

e Hall

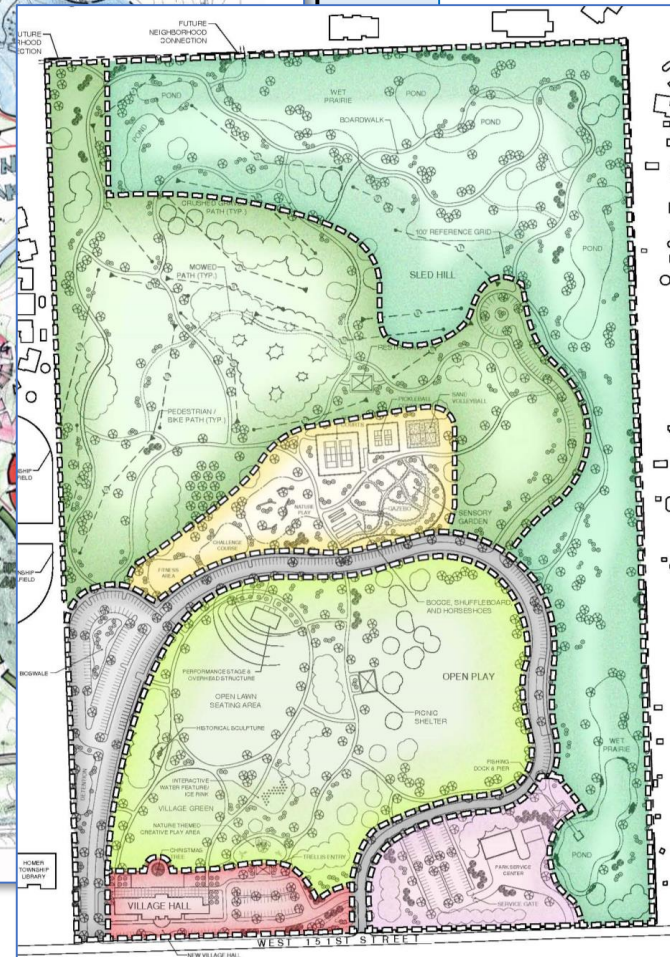



# HERITAGE PARK

## VILLAGE PROJECTS VILLAGE OF HOMER GLEN

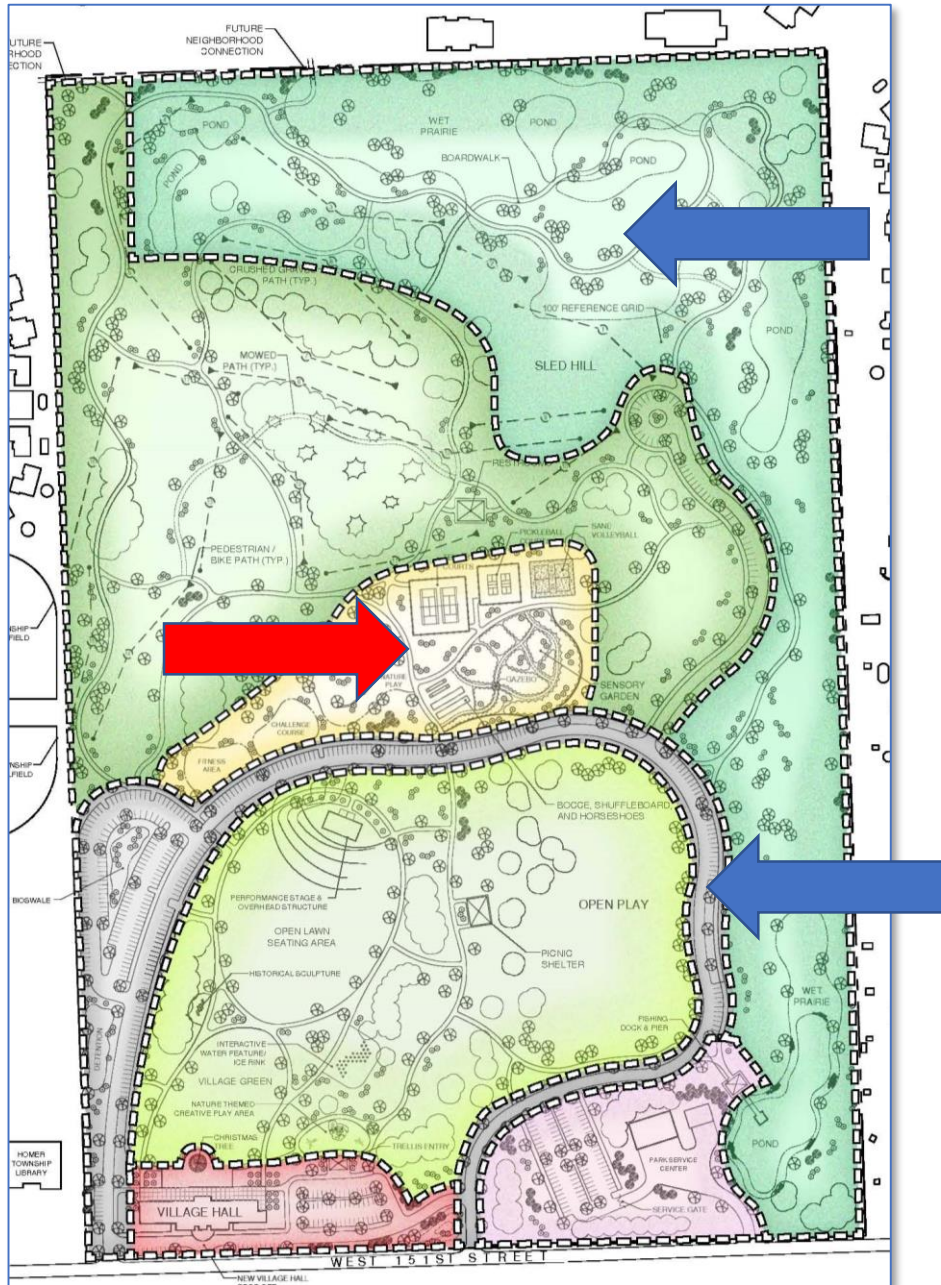



# HERITAGE PARK

ACTIVE CORE  
VILLAGE OF HOMER GLEN





# Cost Phasing Plan

## OPTION A - Complete One Project a Year

Phase	in 2018 Dollars	in 2019 Dollars	in 2020 Dollars	in 2021 Dollars	in 2022 Dollars	in 2023 Dollars	in 2024 Dollars	in 2025 Dollars	in 2026 Dollars	in 2027 Dollars	in 2028 Dollars
Phase 1A and 1B: Disc Golf Course	\$358,750	\$376,688	\$395,522	\$415,298	\$436,063	\$457,866	\$480,759	\$504,797	\$530,037	\$556,539	\$584,366
Phase 2: Open Play	\$374,688	\$393,422	\$413,093	\$433,748	\$455,435	\$478,207	\$502,117	\$527,223	\$553,584	\$581,263	\$610,326
Phase 3A and 3B: Sled Hill	\$1,030,625	\$1,082,156	\$1,136,264	\$1,193,077	\$1,252,731	\$1,315,368	\$1,381,136	\$1,450,193	\$1,522,370	\$1,598,838	\$1,678,780
Phase 4a: Village Hall and Christmas Tree and 151st Streetscape	\$1,416,875	\$1,487,719	\$1,562,105	\$1,640,210	\$1,722,220	\$1,808,331	\$1,898,748	\$1,993,685	\$2,093,370	\$2,198,038	\$2,307,940
Phase 4b: Village Green and Amphitheater	\$3,637,500	\$3,819,375	\$4,010,344	\$4,210,861	\$4,421,404	\$4,642,474	\$4,874,598	\$5,118,328	\$5,374,244	\$5,642,956	\$5,925,104
Phase 5: Activity Area	\$2,525,000	\$2,651,250	\$2,783,813	\$2,923,003	\$3,069,153	\$3,222,611	\$3,383,741	\$3,552,929	\$3,730,575	\$3,917,104	\$4,112,959
Phase 6: Fishing Dock	\$418,750	\$439,688	\$461,672	\$484,755	\$508,993	\$534,443	\$561,165	\$589,223	\$618,684	\$649,619	\$682,100
Phase 7: Cul-du-Sac Road	\$664,500	\$697,725	\$732,611	\$769,242	\$807,704	\$848,089	\$890,494	\$935,018	\$981,769	\$1,030,858	\$1,082,400
Phase 8: 151st Street Expansion Parking Lot	\$472,750	\$428,138	\$449,544	\$472,022	\$495,623	\$520,404	\$546,424	\$573,745	\$602,432	\$632,554	\$664,182
Phase 9: Heritage Park Parking Lot Expansion	\$604,125	\$634,331	\$666,048	\$699,350	\$734,318	\$771,034	\$809,585	\$850,065	\$892,568	\$937,196	\$984,056
<b>Grand Total</b>	<b>\$11,438,563</b>	<b>\$12,010,491</b>	<b>\$12,611,015</b>	<b>\$13,241,566</b>	<b>\$13,903,644</b>	<b>\$14,598,826</b>	<b>\$15,328,768</b>	<b>\$16,095,206</b>	<b>\$16,899,966</b>	<b>\$17,744,965</b>	<b>\$18,632,213</b>
Select Projects Estimated Grand Total		\$376,688	\$413,093	\$1,193,077	\$1,722,220	\$4,642,474	\$3,383,741	\$589,223	\$981,769	\$632,554	\$984,058
<b>Grand Total after 10 Years</b>											<b>\$14,918,896</b>

Note: 5% Yearly Escalation Factor Used for Every Year

## OPTION B - Complete All Projects in 2019

Phase	in 2018 Dollars	in 2019 Dollars
Phase 1A and 1B: Disc Golf Course	\$358,750	\$376,688
Phase 2: Open Play	\$374,688	\$393,422
Phase 3A and 3B: Sled Hill	\$1,030,625	\$1,082,156
Phase 4a: Village Hall and Christmas Tree and 151st Streetscape	\$1,416,875	\$1,487,719
Phase 4b: Village Green and Amphitheater	\$3,637,500	\$3,819,375
Phase 5: Activity Area	\$2,525,000	\$2,651,250
Phase 6: Fishing Dock	\$418,750	\$439,688
Phase 7: Cul-du-Sac Road	\$664,500	\$697,725
Phase 8: 151st Street Expansion Parking Lot	\$407,750	\$428,138
Phase 9: Heritage Park Parking Lot Expansion	\$604,125	\$634,331
<b>Grand Total</b>	<b>\$11,438,563</b>	<b>\$12,010,491</b>
<b>Grand Total after 1 Year</b>		<b>\$12,010,491</b>

## OPTION C - Complete Select Projects in 2019

Phase	in 2018 Dollars	in 2019 Dollars
Phase 1A: Disc Golf Course	\$43,750	\$45,938
Phase 2: Open Play	\$374,688	\$393,422
Phase 3A: Sled Hill	\$131,875	\$138,469
Phase 4a: Village Hall and Christmas Tree and 151st Streetscape	\$1,416,875	\$1,487,719
Phase 4b: Village Green and Amphitheater	\$3,637,500	\$3,819,375
Phase 5: Activity Area	\$0	\$0
Phase 6: Fishing Dock	\$0	\$0
Phase 7: Cul-du-Sac Road	\$0	\$0
Phase 8: 151st Street Expansion Parking Lot	\$0	\$0
Phase 9: Heritage Park Parking Lot Expansion	\$0	\$0
<b>Grand Total</b>	<b>\$5,604,688</b>	<b>\$5,884,922</b>
<b>Grand Total after 1 Year</b>		<b>\$5,884,922</b>

## OPTION D - Complete Schematic Design in 2019

Phase	in 2018 Dollars	in 2019 Dollars
Phase 1A and 1B: Disc Golf Course	\$0	\$0
Phase 2: Open Play	\$374,688	\$393,422
Phase 3A and 3B: Sled Hill	\$1,030,625	\$1,082,156
Phase 4aA and 4aB: Village Hall and Christmas Tree and 151st Streetscape	\$1,416,875	\$1,487,719
Phase 4b: Village Green and Amphitheater	\$0	\$0
Phase 5A and 5B: Activity Area	\$2,525,000	\$2,651,250
Phase 6: Fishing Dock	\$418,750	\$439,688
Phase 7: Cul-du-Sac Road	\$0	\$0
Phase 8: 151st Street Expansion Parking Lot	\$0	\$0
Phase 9: Heritage Park Parking Lot Expansion	\$0	\$0
<b>Grand Total</b>	<b>\$5,765,938</b>	<b>\$6,054,234</b>
<b>Grand Total after 1 Year</b>		<b>\$6,054,234</b>

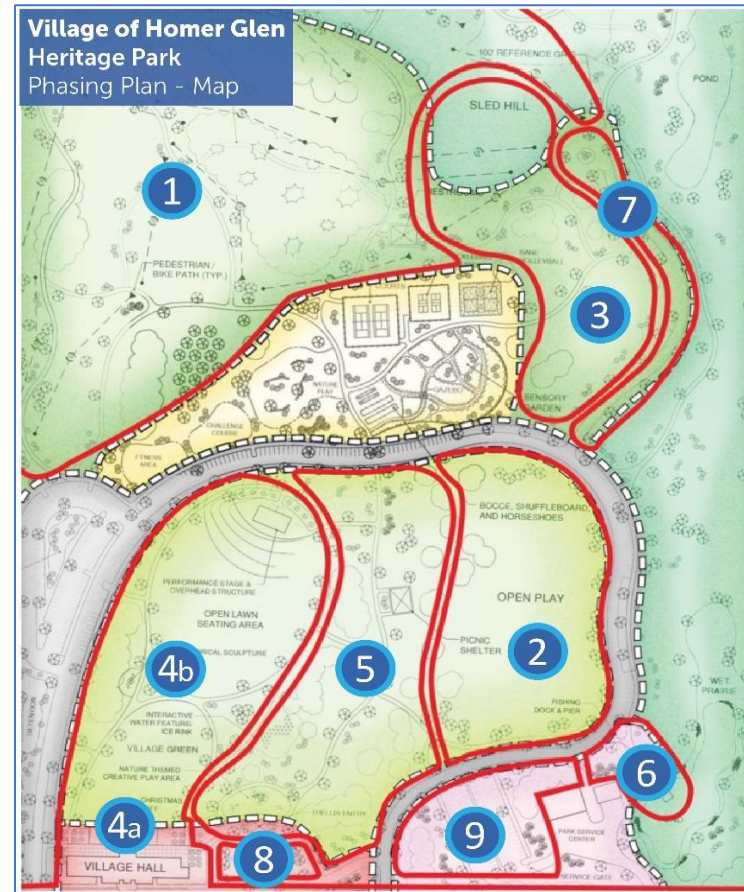





# HERITAGE PARK

## AMPHITHEATER – VISUAL PREFERENCE VILLAGE OF HOMER GLEN

### Visual Preference Survey Heritage Park - Village Green Phase

Instructions: Check only the ones you like. For the ones you check, describe what elements caught your eye.

\*Results from this survey are not intended to be a final selection on design, but rather a tool to generate initial thoughts on general design direction.



### Visual Preference Survey Heritage Park - Village Green Phase

Instructions: Check only the ones you like. For the ones you check, describe what elements caught your eye.

\*Results from this survey are not intended to be a final selection on design, but rather a tool to generate initial thoughts on general design direction.



### Visual Preference Survey Heritage Park - Village Green Phase

Instructions: Check only the ones you like. For the ones you check, describe what elements caught your eye.

\*Results from this survey are not intended to be a final selection on design, but rather a tool to generate initial thoughts on general design direction.



### Visual Preference Survey Heritage Park - Village Green Phase

Instructions: Check only the ones you like. For the ones you check, describe what elements caught your eye.

\*Results from this survey are not intended to be a final selection on design, but rather a tool to generate initial thoughts on general design direction.







# HERITAGE PARK

AMPHITHEATER, VILLAGE GREEN &  
VETERANS MEMORIAL

VILLAGE OF HOMER GLEN



# OUR TEAM'S EXPERIENCE

- Alsip Park District
- Bensenville Park District
- Bloomington Parks, Recreation & Cultural Arts Dept.
- Bolingbrook Park District
- Broadview Park District
- Burbank Park District
- Carol Stream Park District
- Channahon Park District
- **City of Country Club Hills**
- **City of Eau Claire, WI Parks & Recreation**
- **City of Franklin, WI**
- **City of Lockport**
- **City of Rhinelander, WI**
- **City of Rolling Meadows**
- **City of Waukesha Parks & Recreation**
- Community Park District, La Grange Park
- Crystal Lake Park District
- Des Plaines Park District
- Dundee Township Park District
- **Frankfort Park District**
- Glencoe Park District
- Glen Ellyn Park District
- Hodgkins Park District
- **Midlothian Park District**
- Morton Grove Park District
- **New Lenox Community Park District**
- Oak Brook Park District
- **Open Lands of Orland Park**
- **Orland Township**
- **City of Palos Heights Parks & Recreation**
- Park District of La Grange
- Park Ridge Park District
- Prospect Heights Park District
- River Trails Park District
- Rock County, Wisconsin
- Rolling Meadows Park District
- Salt Creek Rural Park District
- South Elgin Parks & Recreation
- Sugar Grove Park District
- SWSRA Strategic Plan
- **Tinley Park Park District**
- Vernon Hills Park District
- **Village of Frankfort**
- **Village of Hoffman Estates**
- **Village of Homer Glen**
- **Village of New Lenox**
- **Village of Niles**
- **Village of Tinley Park**
- Wood Dale Park District







# CREATIVE FUNDING

Join the Movement: Donate today!

## MEMORIAL PARK: Fitness & Court Games

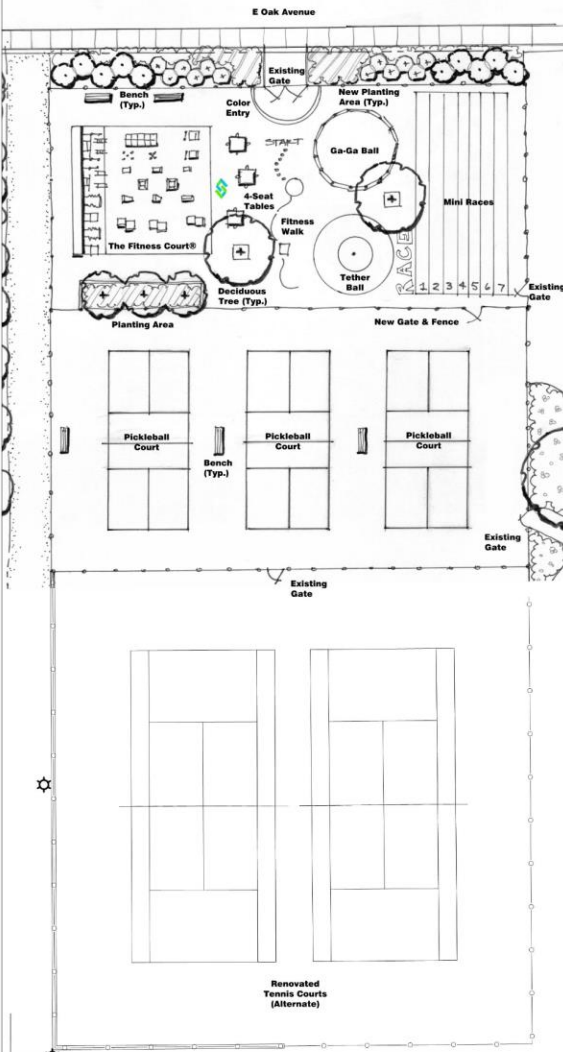

**DONATE  
HERE:**

([www.communityparkdistrict.org](http://www.communityparkdistrict.org))



# CREATIVE FUNDING

## Traditional Funding Sources

- IDNR – OSLAD, PARC, Illinois Bike Path & LWCF Grants
- Rebuild Illinois
- Community Development Block Grant (CDBG)
- EPA 319 Grant
- Green Infrastructure Grant

## Alternative Funding Sources

- Partnership Opportunities
- MLB Baseball Tomorrow Fund
- W.K. Kellogg Foundation
- Meet Me at the Park NRPA/Disney Grant
- Crowd Fundraising

**Authored over 50 grants  
Over \$30 million!**





WHY US?





WE ARE DEDICATED PARK & RECREATION DESIGN PROFESSIONALS





---

WE UNDERSTAND ENGAGEMENT & CONSENSUS BUILDING

---





---

WE CREATE PLACES THAT REFLECT YOUR COMMUNITY





WE EXPLORE SUSTAINABLE SOLUTIONS

---





WE LOVE WHAT WE DO ~ AND...





WE KNOW & LOVE ORLAND PARK!

---





ANY QUESTIONS?

---



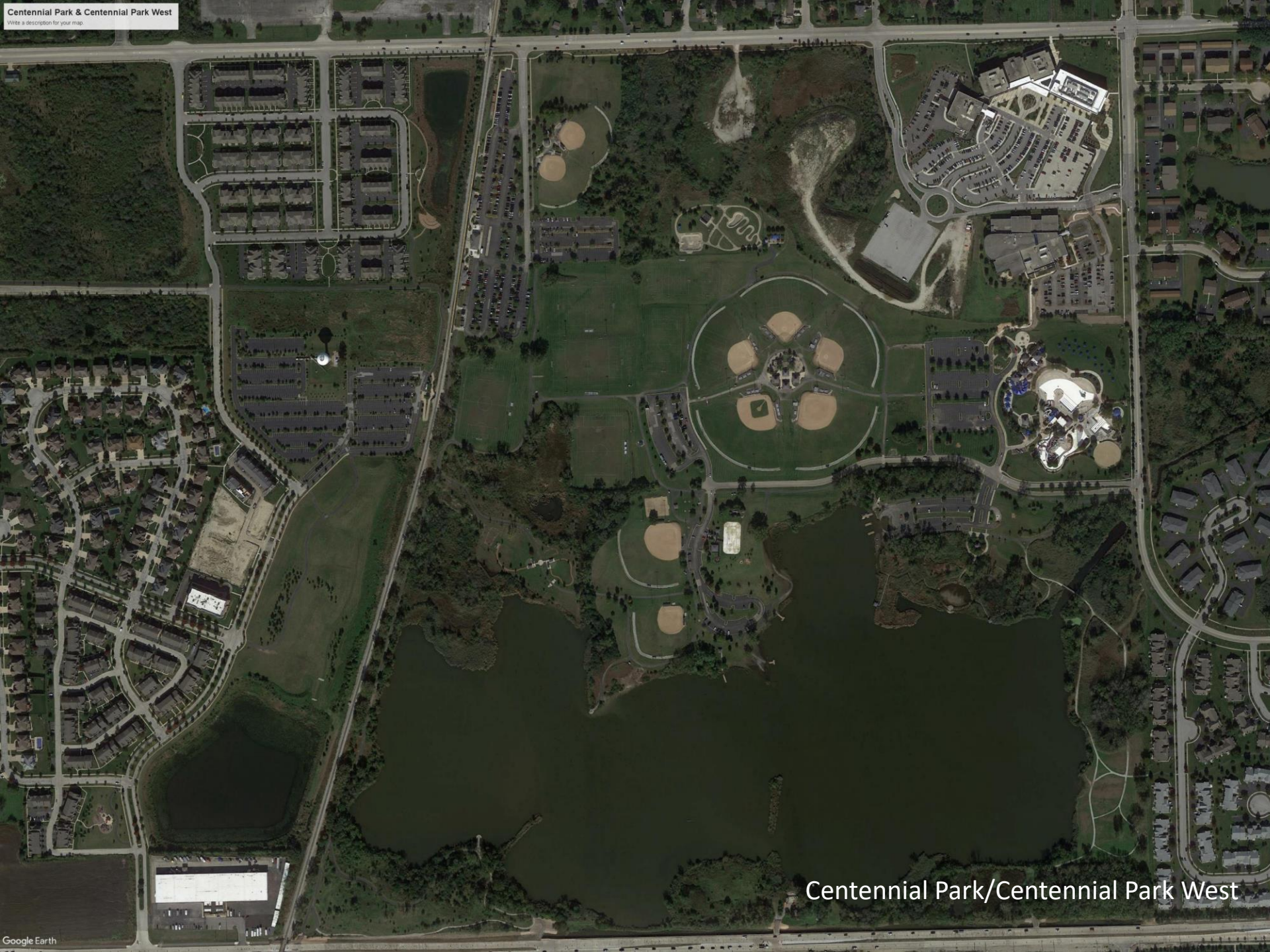

Centennial Park/Centennial Park West





John Humphrey Complex





Schussler Park



# HERITAGE PARK

RECREATION/ACTIVE CORE  
HOMER GLEN, IL





# HERITAGE PARK

RECREATION/ACTIVE CORE  
HOMER GLEN, IL





# HERITAGE PARK

RECREATION/ACTIVE CORE  
HOMER GLEN, IL





# LONGFELLOW PARK

UNIVERSALLY ACCESSIBLE PARK  
OAK PARK, IL



ILASLA AWARD WINNER





# HODAG PARK MASTER PLAN

## WATERFRONT PARK DEVELOPMENT RHINELANDER, WI





# HODAG PARK MASTER PLAN

WATERFRONT PARK DEVELOPMENT  
RHINELANDER, WI





# BALLPARK COMMONS

BASEBALL STADIUM/MIRACLE FIELD  
FRANKLIN, WI





# FRAME PARK

BASEBALL STADIUM  
WAUKESHA, WI





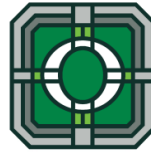

# ORLAND PARK

LORI VIEROW, JSD  
PROJECT MANAGER

JAMES PETRAKOS, TRIA  
PROJECT ARCHITECT

SARAH DREIER, JSD  
LANDSCAPE ARCHITECT

DAVE ROBERTS, JSD  
CIVIL ENGINEER

BONNIE COVELLI, PRG  
SURVEY PRINCIPAL

RON MCGRATH, TRIA  
QA/QC MANAGER

KEVIN YESKA, JSD  
LANDSCAPE ARCHITECT

JOHN KREBS, JSD  
SURVEYOR

FRANK COVELLI, PRG  
SURVEY MANAGER

MIKE KREN, TRIA  
STAFF ARCHITECT