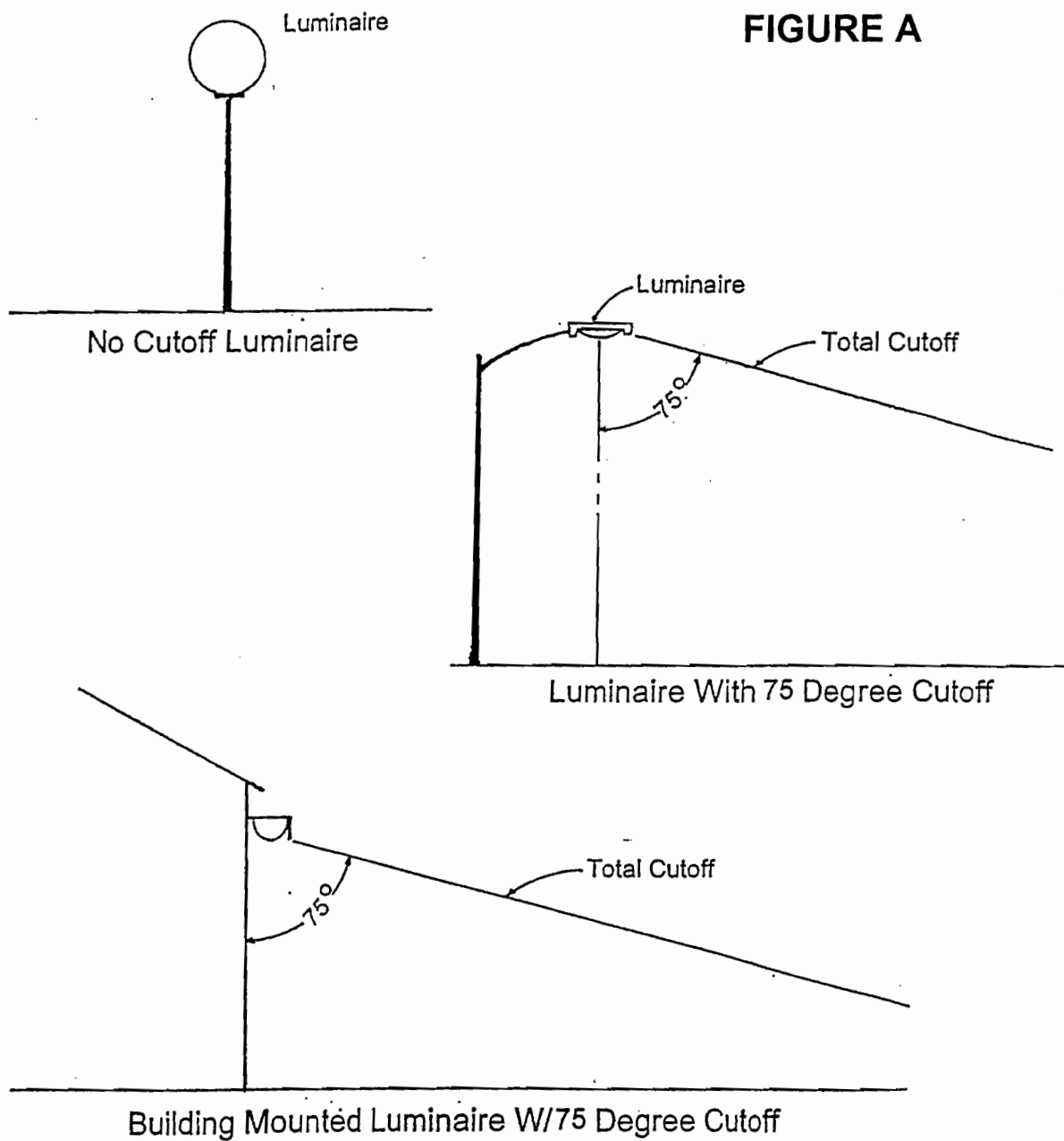

Figure A: Luminaire Types

Section 6-407.1
Commercial Lighting

FIGURE A



NOT TO SCALE

(12/03)

Figure B: Height of Luminaires and Total Height

Section 6-407.1
Commercial Lighting

FIGURE B

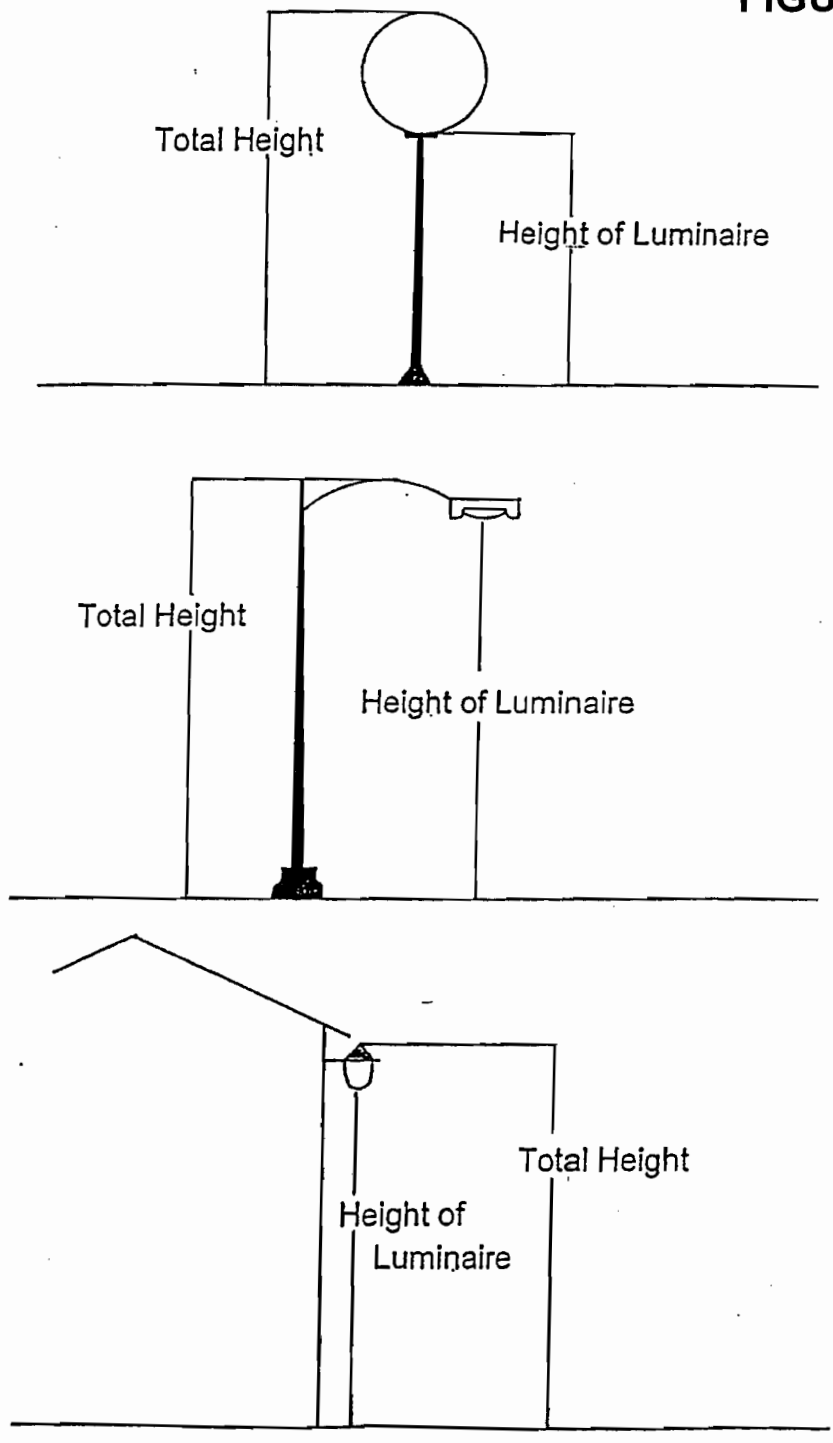

NOT TO SCALE
(12/03)

FIGURE C

Figure C: Luminaires With Cutoff (Cutoff Angle Shall be 75 Degrees or Less)

Luminaire Height = 10' +/-

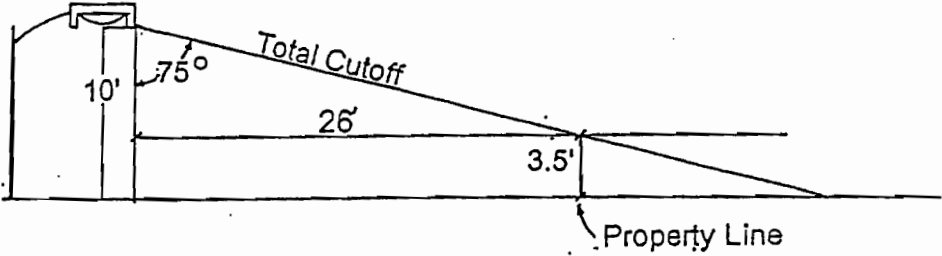

Luminaire Height = 15' +/-

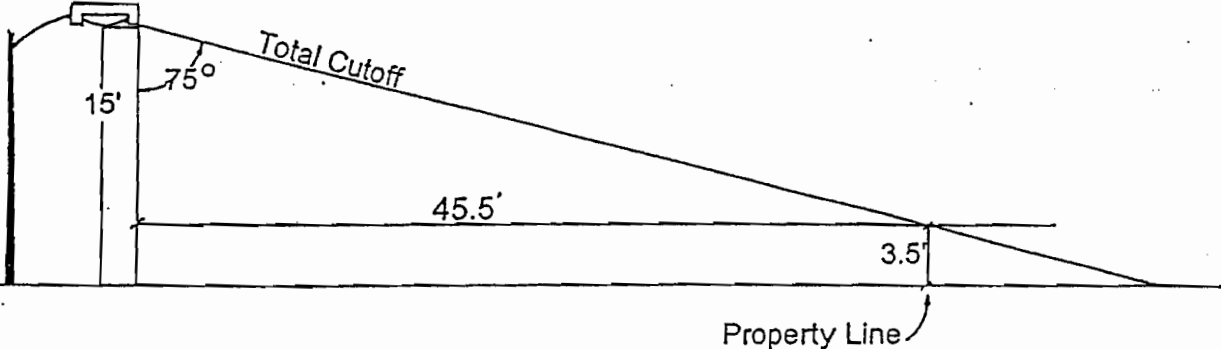

Luminaire Height = 20' +/-

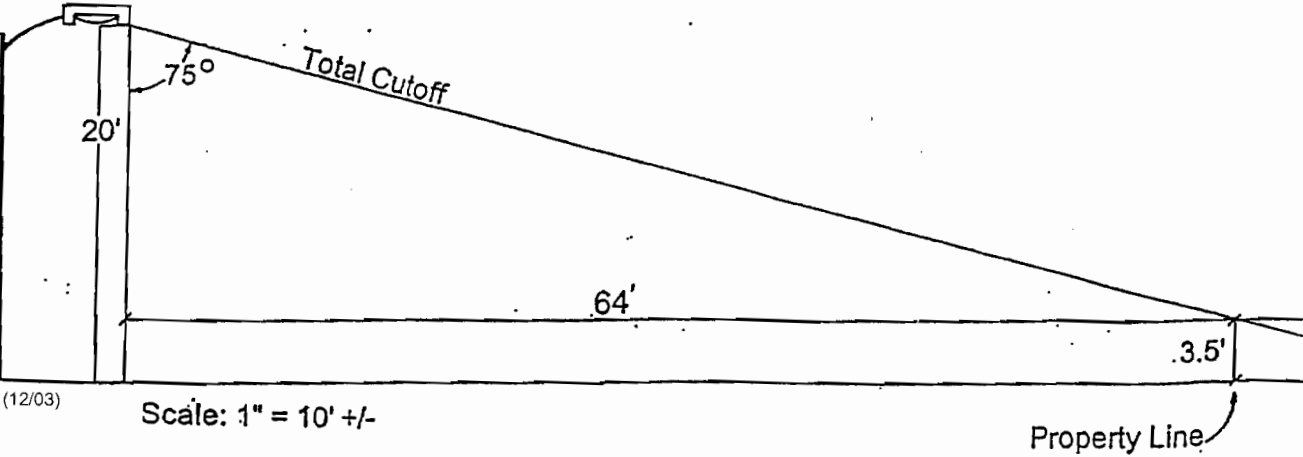

(12/03)

Scale: 1" = 10' +/-

FIGURE D

Figure D: Luminaires With No Cutoff or a Cutoff Angle Greater than 75 Degrees

- Height* = 3 feet + D/3 (D is the distance in feet of the luminaire from the property line.)
- Maximum Height* = 16 feet
- Maximum Watts or Lumens = 100 watts or 10,000 lumens, whichever is less (provided the luminaries meet the performance standards)

*The performance standards set forth in Table 2 cannot be exceeded.

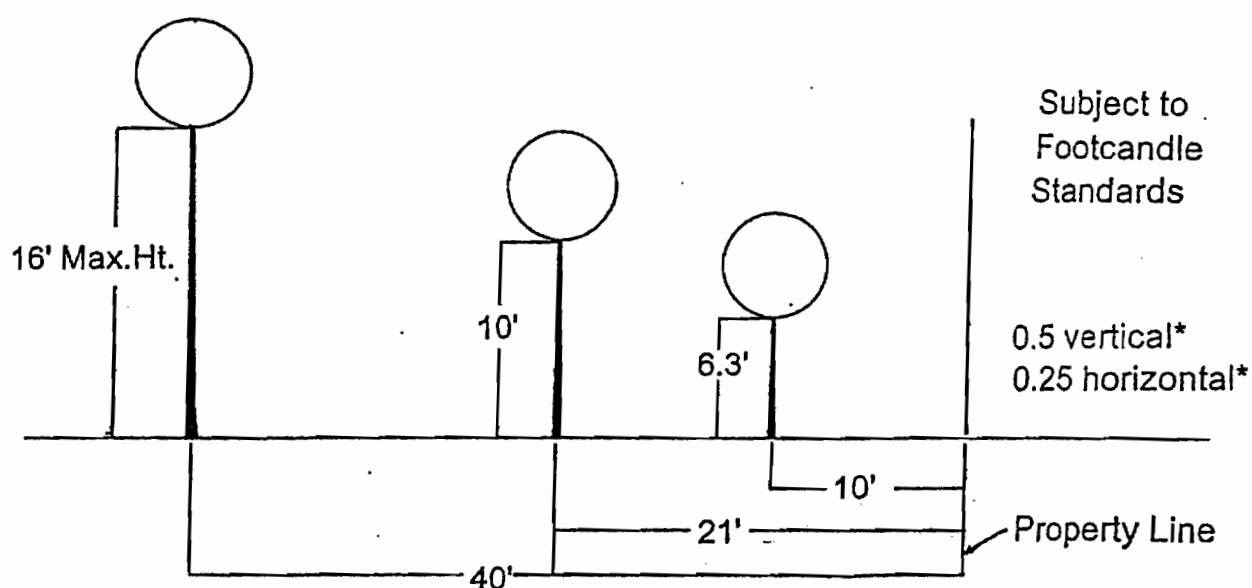

Scale 1" = 10' +/-

*Measured 3.5' above ground.

Figure E

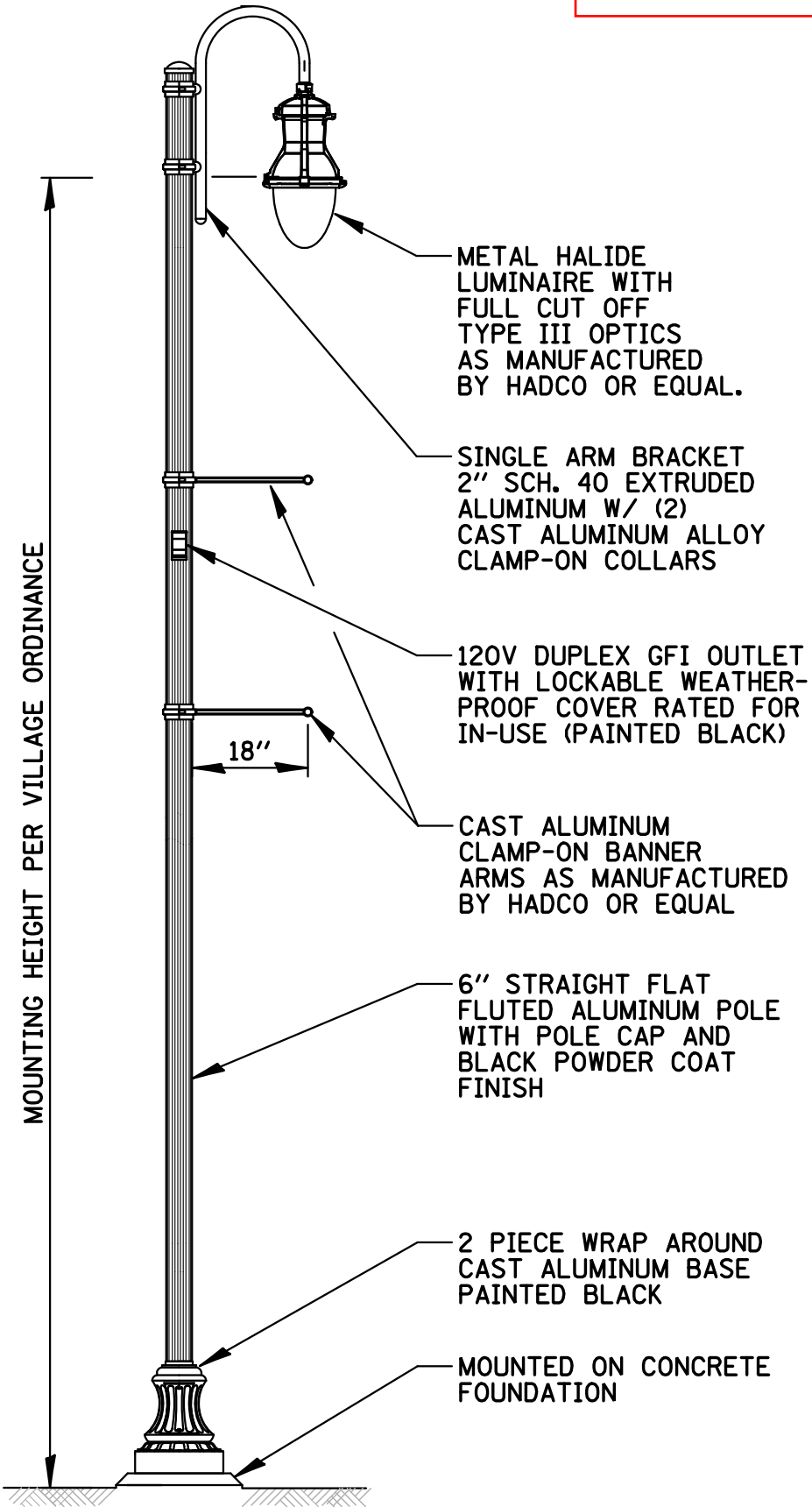

LIGHT STANDARD DETAIL – TYPE 1

N.T.S.

~~Section 6-302~~
Commercial Lighting

TABLE 1

Lamp Wattage	LIGHTING IN RESIDENTIAL DISTRICT					
	Single Family Use		Multiple Family Use		Non-Residential Uses (Institutional, etc.)	
	Street Right-of-Way Width		Street Right-of-Way Width		Street Right-of-Way Width	
	< 80 feet	80 feet +	< 80 feet	80 feet +	< 80 feet	80 feet +
0-250 (1)	P	P	P	P	P	P
251-400	X	VAR	X	VAR	X	P
401+	X	X	X	X	X	X

Lamp Wattage	LIGHTING IN NON-RESIDENTIAL DISTRICT AND FOR NON-RESIDENTIAL USES IN RESIDENTIAL DISTRICTS			
	External – Abutting a Residential Zoning District or Street R.O.W.			Internal
	Setback Less Than 40 Feet	Setback Less than 100 Feet	Setback Less than 200 Feet	Setback 200 Feet +
0-250 (1)	P	P	P	P
251-400	VAR	P	P	P
401+	X	X	VAR	VAR

(1) A luminaire without a cutoff shall not exceed 100 watts.
P = Permitted.
VAR = Variances.
X = Not permitted, except with approval of a Variances.
(Ord. 4210 – 12/18/06)

(12/06)

TABLE 2

MAXIMUM FOOT CANDLES AT A PROPERTY LINE – HORIZONTAL AND VERTICAL MEASUREMENTS									
Residential to Residential		Non-Residential to Non-Residential				Non-Residential to Residential			
<u>Horizontal</u>	<u>Vertical</u>	<u>Horizontal</u>		<u>Vertical</u>		<u>Horizontal</u>		<u>Vertical</u>	
		<u>Security Hours</u>	<u>Operating Hours</u>	<u>Security Hours</u>	<u>Operating Hours</u>	<u>Security Hours</u>	<u>Operating Hours</u>	<u>Security Hours</u>	<u>Operating Hours</u>
0.25	0.5	2	5	3	10	0.25	0.5	0.5	0.5

MAXIMUM FOOT CANDLES – INTERNAL – HORIZONTAL MEASUREMENT					
Residential Districts			Non-Residential Districts		
<u>Horizontal Permitted</u>	<u>Variation</u>	<u>Operating Hours</u>		<u>Security Hours</u>	
		<u>Permitted</u>	<u>Variation</u>	<u>Permitted</u>	<u>Variation</u>
≤ 10	10 +	≤ 15	15 +	≤ 3	3 +

Notes

Footcandle – Horizontal Measurement: The measurement of footcandles utilizing a direct reading, portable light meter mounted in the horizontal position.

Footcandle – Vertical Measurement: The measurement of footcandles utilizing a direct reading, portable light meter mounted in the vertical position.

Operating Hours: The period of time from one hour prior to opening to one hour after closing of a non-residential establishment.

Security Hours: The period of time from one hour after closing to one hour prior to opening of a non-residential establishment.

(Ord. 4210 – 12/18/06)

(12/06)