

**PLAN NOTES:**

- The contractor shall provide and install all plant materials in quantities sufficient to complete the planting shown on the drawing, unless noted otherwise. Size and grading standards of plant materials shall conform to the latest edition of ANSI Z60.1, AMERICAN STANDARD FOR NURSERY STOCK, by the American Nursery & Landscape Association. Plants shall meet size, genus, species, and variety. Plants shall be in good health, free of disease, insects and defects. No "Trunk Grade" material shall be accepted. Trees not exhibiting a central (or single) leader will be rejected unless called out in the Plant Schedule as multi-stem. Plants may be substituted upon the approval of the Landscape Architect or the governing municipality.
- All plants shall be watered during the first 24-hour period after installation. Contractor is responsible for watering sod once. A schedule must be agreed upon with the owner, before sod is installed, of whom, when and how sod is to be properly watered. The contractor is responsible for site visits to ensure the proper watering is being done for establishment and health of sod.
- Plants shall be balled and burlapped or container grown as specified. No root bound material shall be accepted and all wrapping material made of synthetics or plastics shall be removed at the time of planting. It is the contractor's option to roll back burlap from the top of the ball.
- All shrub beds and tree rings shall receive 3" depth of shredded hardwood mulch. All new tree rings shall be 4" in diameter. All perennials shall receive 1" depth of hardwood mulch.
- All plants shall be set plumb. It is the contractor's option to stake deciduous trees, but it is also the contractor's responsibility to ensure plants remain plumb until the end of the guarantee period. All deciduous trees shall be wrapped to prevent winter damage, which shall be removed after the first winter. All evergreen trees must be staked.
- Prune, thin out, and shape new plants in accordance with standard horticultural practices to retain their natural character. Do not cut tree leader, but be sure to remove any injured, damaged, dead, or crossed branches from the plant at the time of installation.
- All ground cover and flowerbeds shall receive a 3" depth of organic compost, which shall be rototilled into the existing topsoil utilizing two lifts. Trees and shrubs shall be back filled with good existing topsoil.
- The contractor shall locate the existence of all underground utilities prior to starting. The contractor must also keep the pavement and work area in a neat and orderly condition throughout the construction process.
- Owner shall provide contractor with finish grade from the approved grading plan to a tenth of a foot with sufficient quality topsoil. If imported topsoil is required it shall be done at the owners expense. The general contractor should remove all construction debris.
- Sod shall extend to all property lines, unless otherwise noted.
- All edging to be a spaded natural edge, no steel or plastic edging shall be used unless otherwise noted.
- Information contained in "Plan Notes" take precedence over other information.

NOTE: ALL TREES AND SHRUBS SHALL BE PLANTED NO LESS THAN 10' HORIZONTALLY FROM UTILITY STRUCTURES.

NOTE: ALL SOD AREAS SHALL BE PERMANENTLY IRRIGATED.

NOTE: ONCE FINAL APPROVAL IS GRANTED, ALL ALTERATIONS ARE SUBJECT TO THE APPROVAL OF THE DIRECTOR OF COMMUNITY DEVELOPMENT.

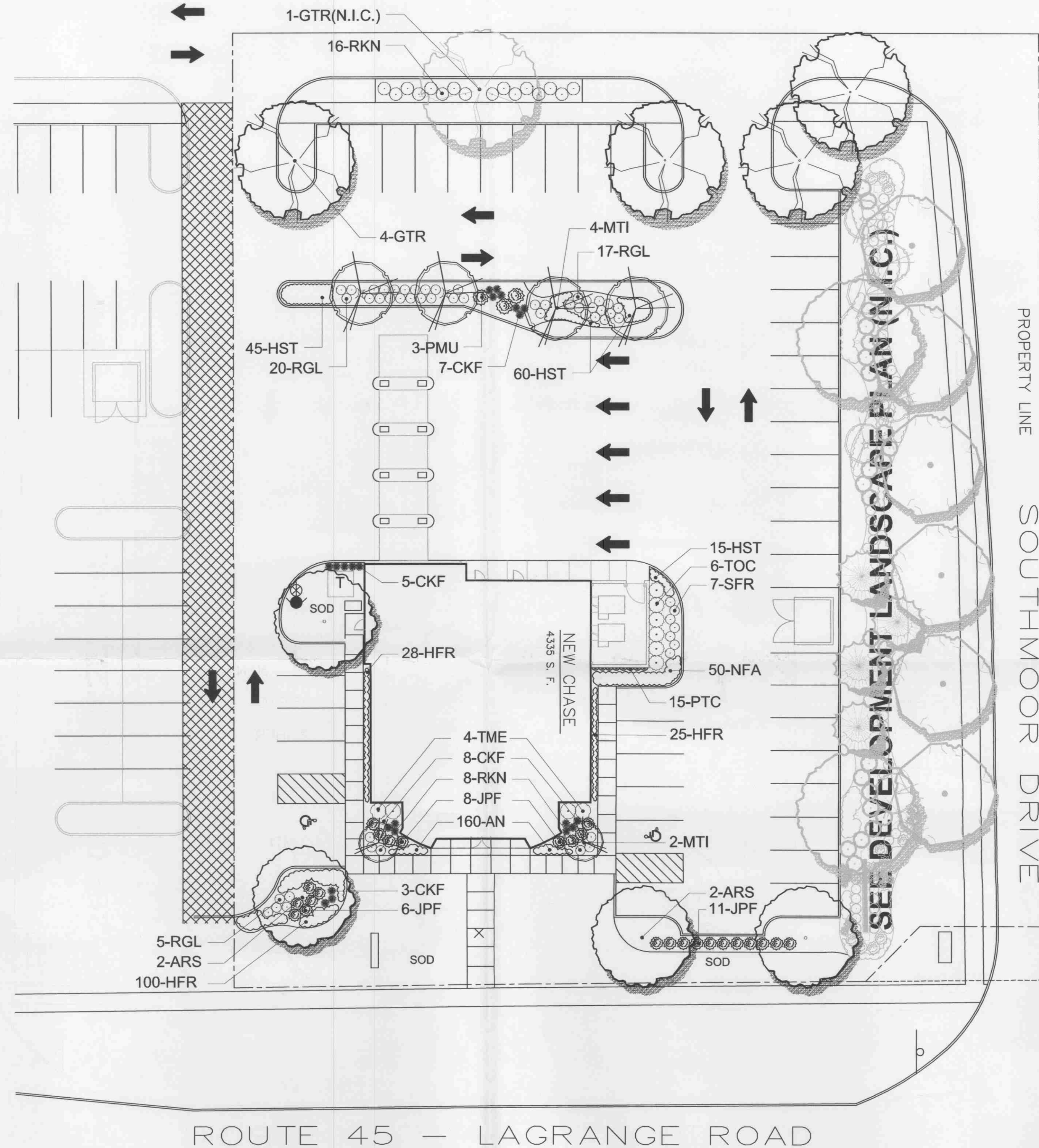

**Chase Bank - Southmoor Commons  
Orland Park, IL**

**Plant Material List:**

Symbol	Botanical Name	Common Name	Size	Spacing	Qty	Remarks
<b>Shade Trees</b>						
ARS	Acer r. 'Red Sunset'	Red Sunset Maple	3" Cal.	per plan	4	Matching Specimens
GTR	Gleditsia triacanthos inermis 'Skyline'	Skyline Honeylocust	3" Cal.	per plan	4	Matching Specimens
					<b>8</b>	
<b>Ornamental Trees</b>						
MTI	Malus 'Tina'	Tina Crab	2" Cal.	per plan	6	Grafted on 2" Standard
					<b>6</b>	
<b>Evergreen Shrubs</b>						
JPF	Juniperus c. 'Kallay'	Kallay Compact Juniper	5 Gal.	3' o.c.	25	Matching Specimens
PMU	Prunus m. 'Mugo'	Dwarf Mugo Pine	24" Ht.	4' o.c.	3	Matching Specimens
TME	Taxus x media 'Densiflora'	Densiflora Yew	18" Ht.	4' o.c.	4	Matching Specimens
TOC	Thuja occidentalis 'Techny'	Techny Mission Arborvitae	5" Ht.	4' o.c.	6	Matching Specimens
					<b>38</b>	
<b>Deciduous Shrubs</b>						
RGL	Rhus aromatica 'Gro-Low'	Gro-Low Sumac	5 Gal.	3' o.c.	42	Matching Specimens
RKN	Rosa 'Knockout'	Knockout Rose	5 Gal.	3' o.c.	24	Matching Specimens
SFR	Spiraea 'Froebelii'	Froebel Spirea	5 Gal.	3' o.c.	7	Matching Specimens
					<b>73</b>	
<b>Perennials, Groundcover &amp; Grasses</b>						
AN	Annuals	Misc Annuals	3" pot	6" o.c.	160	Matching Specimens
CKF	Calamagrostis xacutiflora 'Karl Forester'	Karl Forester Feather Reed Grass	1 Gal.	24" o.c.	23	Matching Specimens
HFR	Hosta 'Frances'	Frances Hosta	2 Gal.	15" o.c.	153	Matching Specimens
HST	Hemerocallis 'Stella De Oro'	Stella De Oro Daylily	1 Gal.	15" o.c.	120	Matching Specimens
PTC	Parthenocissus tricuspidata	Boston Ivy	1 Gal.	12" o.c.	15	Train to climb wall
					<b>471</b>	

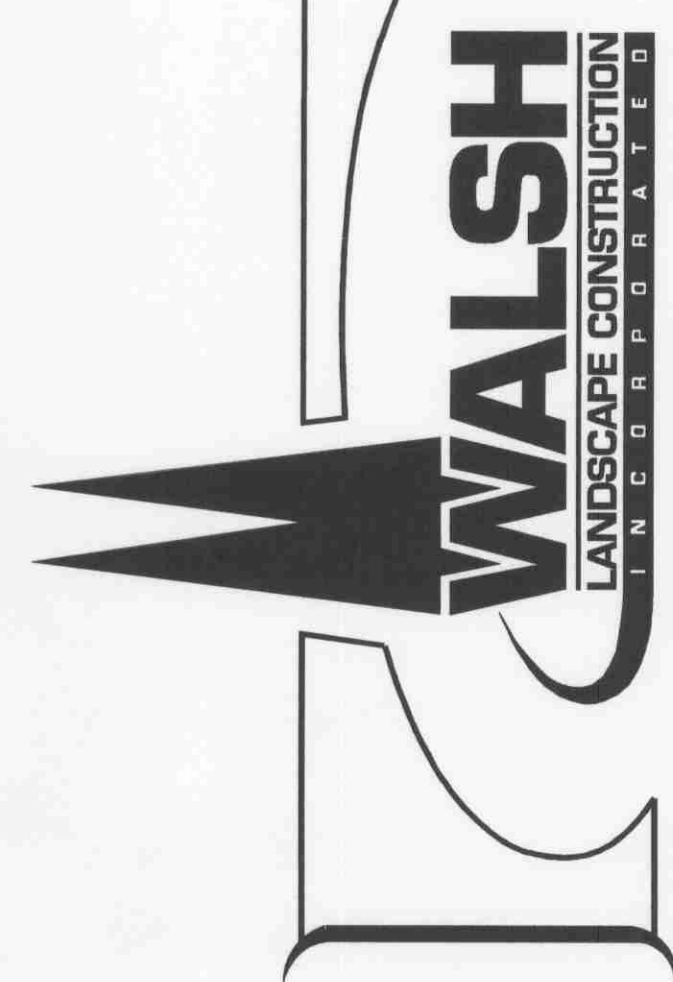
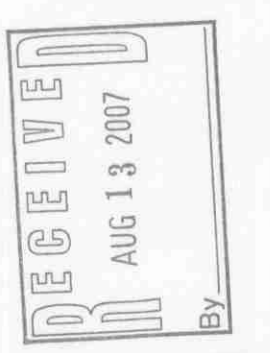

A LANDSCAPE PLAN FOR  
CHASE BANK  
SOUTHMOOR COMMONS  
ORLAND PARK, IL

1050 W. Lily Cache Lane • Bolingbrook, IL 60440 • Tel 630.759.8300 • Fax 630.759.7245

BOARD APPROVED  
CASE NO. 2007-0574.0  
DATE 9-17-07  
W/CONDITIONS \_\_\_\_\_  
W/O CONDITIONS

Scale 1" = 20'

REVISIONS	BY
09.13.06	NZ
06.14.07	NZ
07.09.07	NZ
DATE	08.14.06
SCALE	1"=20'
DRAWN BY	NZ
JOB	
SHEET	L-1
OF	SHEET