

SITE PLAN DESIGN NOTES & KEY PLAN

- 1 PAINTED DIRECTIONAL ARROW
- 2 PAINTED DRIVE-THRU GRAPHICS
- 5B 90° PARKING STALL
- 6 DIRECTIONAL SIGNAGE (SEE SIGNAGE PACKAGE)
- 6G "PEDESTRIAN CROSSWALK" SIGN (SEE SIGNAGE PACKAGE)
- 6K "MEAL DELIVERY ZONE" SIGN
- 9 RETURNED CURB ACCESSIBLE RAMP
- 11 TYPICAL CONCRETE SIDEWALK
- 12 SIDEWALK WITH CURB & GUTTER SECTION
- 13 DRIVE-THRU PLAN
- 14 DRIVE-THRU ISOMETRIC
- 16 LANDSCAPE & IRRIGATION PROTECTOR
- 17 CONCRETE CURB & GUTTER
- 20 CONCRETE BOLLARD
- 21 TYPICAL PAVEMENT SECTION - HEAVY DUTY
- 22 TRANSVERSE & LONGITUDINAL CONTRACTION JOINT
- 23 TRANSVERSE & LONGITUDINAL DOWELED CONSTRUCTION JOINT
- 24 CONCRETE APRON @ TRASH ENCLOSURE
- 25 STAMPED CONCRETE PAVING DRIVE-THRU LANE
- 26 ALUMINUM HANDRAIL
- 28 CONTRACTION JOINT
- 29 KEYED CONSTRUCTION JOINT
- 30 LONGITUDINAL BUTT JOINT
- 31 EXPANSION JOINT
- 32 MULTI-LANE DIRECTIONAL GRAPHICS
- 33 PAINTED CROSS WALK
- 34 MENU BOARD & CANOPY ORDERING STATION
- 35 MENU BOARD LOOP DETECTION SYSTEM
- 36 5'x5' LANDING AND ENTRY DOOR FROST SLAB
- 39 LANDSCAPED AREA (SEE LANDSCAPE PLAN)
- 40 CLEARANCE BAR (SEE SIGNAGE PACKAGE)
- 41 PAVEMENT STRIPING AREA
- 42 THICKENED SLAB EDGE AT RAILING CORE-DRILLS
- 45 EX./PROP. ASPHALT INTERFACE
- 46 EX./PROP. CONCRETE INTERFACE
- 47 SINGLE BIKE RACK
- 50 RELOCATED FLAGPOLE
- 53 4" THICK CONCRETE STRIP BETWEEN BUILDING AND BACK OF CURB
- 54 4" THICK CONCRETE STRIP BETWEEN CURBS
- 55 4" WIDE PAINT STRIPE
- 58 MAGNETIC DELINEATOR
- 59 PROPOSED F2F CANOPY - SEE FASHION CANOPY PLANS
- 60 PROPOSED OMD CANOPY - SEE FASHION CANOPY PLANS
- 61 RELOCATED GROUND MOUNTED LIGHT
- 62 PROPOSED CONCRETE RIBBON CURB

- DETAIL 1/C-400
- DETAIL 2/C-400
- DETAIL 5/C-400
- DETAIL 6/C-400
- DETAIL 9/C-400
- DETAIL 11/C-400
- DETAIL 12/C-400
- DETAIL 13/C-410
- DETAIL 14/C-410
- DETAIL 16/C-410
- DETAIL C-500
- DETAIL 20/C-410
- DETAIL 22/C-420
- DETAIL 23/C-420
- DETAIL 24/C-420
- DETAIL SHEET C-200
- DETAIL 4/A-101
- DETAIL 28/C-420
- DETAIL 29/C-420
- DETAIL 30/C-420
- DETAIL 31/C-420
- DETAIL 32/C-430
- DETAIL 33/C-430
- DETAIL 34/C-430
- DETAIL 35/C-430
- DETAIL 36/C-430
- DETAIL 41/C-430
- DETAIL 42/C-440
- DETAIL 45/C-440
- DETAIL 46/C-440
- DETAIL 47/C-440
- DETAIL 57/C-440
- DETAIL 62/C-210

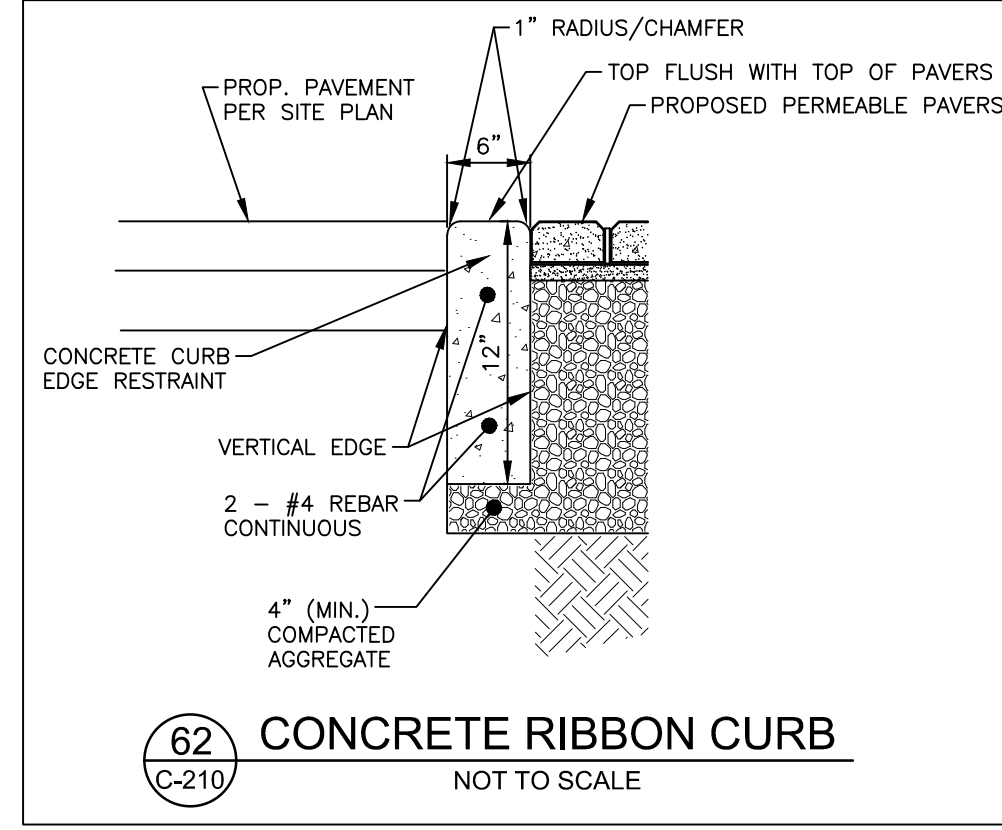
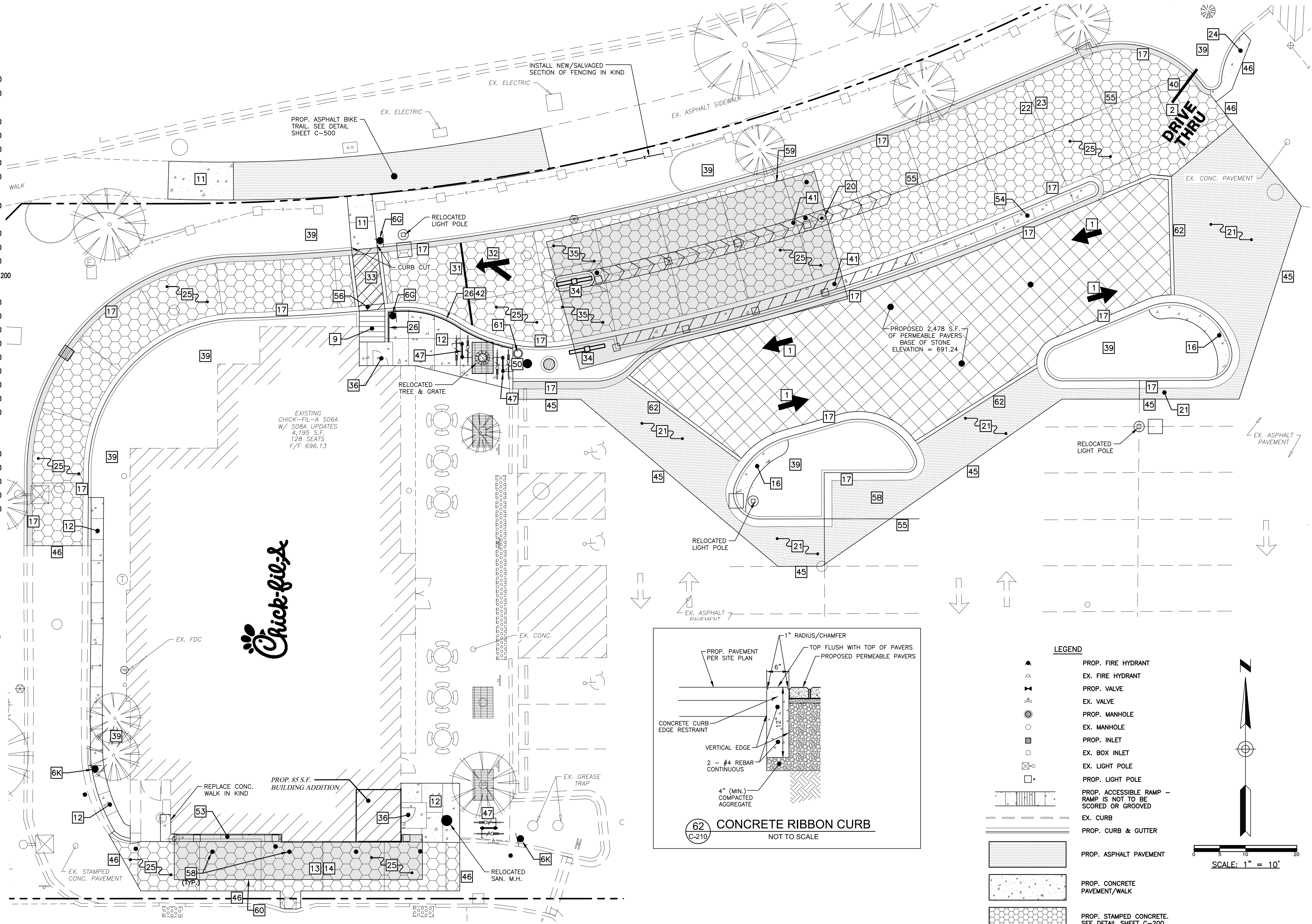

- LEGEND**
- ▲ PROP. FIRE HYDRANT
 - △ EX. FIRE HYDRANT
 - ⊕ PROP. VALVE
 - ⊖ EX. VALVE
 - ⊙ PROP. MANHOLE
 - ⊘ EX. MANHOLE
 - PROP. INLET
 - ⊠ EX. BOX INLET
 - ⊛ EX. LIGHT POLE
 - ⊞ PROP. LIGHT POLE
 - ▭ PROP. ACCESSIBLE RAMP - RAMP IS NOT TO BE SCORED OR GROOVED
 - ▭ EX. CURB
 - ▭ PROP. CURB & GUTTER
 - ▭ PROP. ASPHALT PAVEMENT
 - ▭ PROP. CONCRETE PAVEMENT/WALK
 - ▭ PROP. STAMPED CONCRETE. SEE DETAIL SHEET C-200
 - ▭ PROP. PERMEABLE PAVERS. SEE DETAIL SHEET C-200

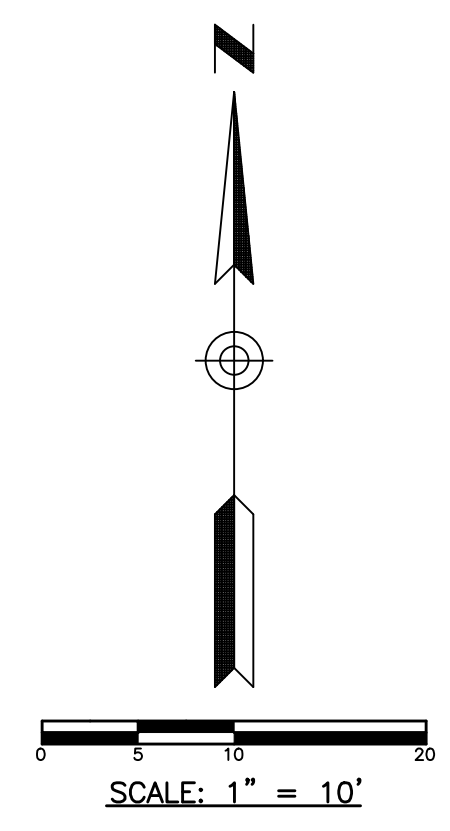

NOTE: CONTRACTOR TO VERIFY SIGNAGE ITEMS WITH CLAYTON SIGNS PRIOR TO THE START OF CONSTRUCTION.

CONTRACTOR RESPONSIBLE TO FIELD VERIFY LOCATIONS AND ELEVATIONS OF EXISTING UTILITY TIE-INS AND CROSSINGS AS SHOWN ON SITE PLANS (SANITARY, STORM, WATER, GAS, ELECTRIC, PHONE, ETC.) PRIOR TO THE START OF CONSTRUCTION. CONTACT ALLAN WILEY AT GBC DESIGN, INC., 330-836-0228, WITH ANY CONCERNS OR CONFLICTS PRIOR TO THE START OF CONSTRUCTION. CONTRACTOR TO VERIFY THE THICKNESS OF ANY OFF-SITE PAVEMENT (ASPHALT AND CONCRETE) AND SIDEWALK SO THE RESTORATION WORK IS INCLUDED IN THE BID.



Chick-fil-A

Chick-fil-A
5200 Buffington Road
Atlanta, Georgia 30349-2998

GBC DESIGN, INC.

565 White Pond Dr.
Akron, OH 44320-1123
Phone 330-836-0228 Fax 330-836-5782



Signature
3/3/21
Date
License Expires 11/30/2021

CHICK-FIL-A
ORLAND PARK FSU
2020 REINVESTMENT
15605 SOUTH LA GRANGE ROAD
ORLAND PARK, IL 60462

FSU# 02638

NO.	DATE	DESCRIPTION
1	10/6/2020	CITY COMMENTS
2	1/27/2021	CITY COMMENTS

GBC PROJECT #	52188R
PRINTED FOR	Permit
DATE	5/1/20
DRAWN BY	B.A.W.

Information contained on this drawing and in all digital files produced for above named project may not be reproduced in any manner without express written or verbal consent from authorized project representatives.

SHEET
SITE PLAN
DETAIL

Permit
SHEET NUMBER
C-210