

Drawing name: \\kimley-horn.com\WMS\CHS_LDE\168626000_SR Jacobson_Orland Park, IL\2 Design\CAD\Exhibits\2018-1105 - Park Exhibit.dwg EX Feb 06, 2019 8:31am By: jesse.cornell
 This document, together with the concepts and designs presented herein, is intended only for the specific purpose and client for which it was prepared. Reuse of and improper reliance on this document without written authorization and adaptation by Kimley-Horn and Associates, Inc. shall be without liability to Kimley-Horn and Associates, Inc.

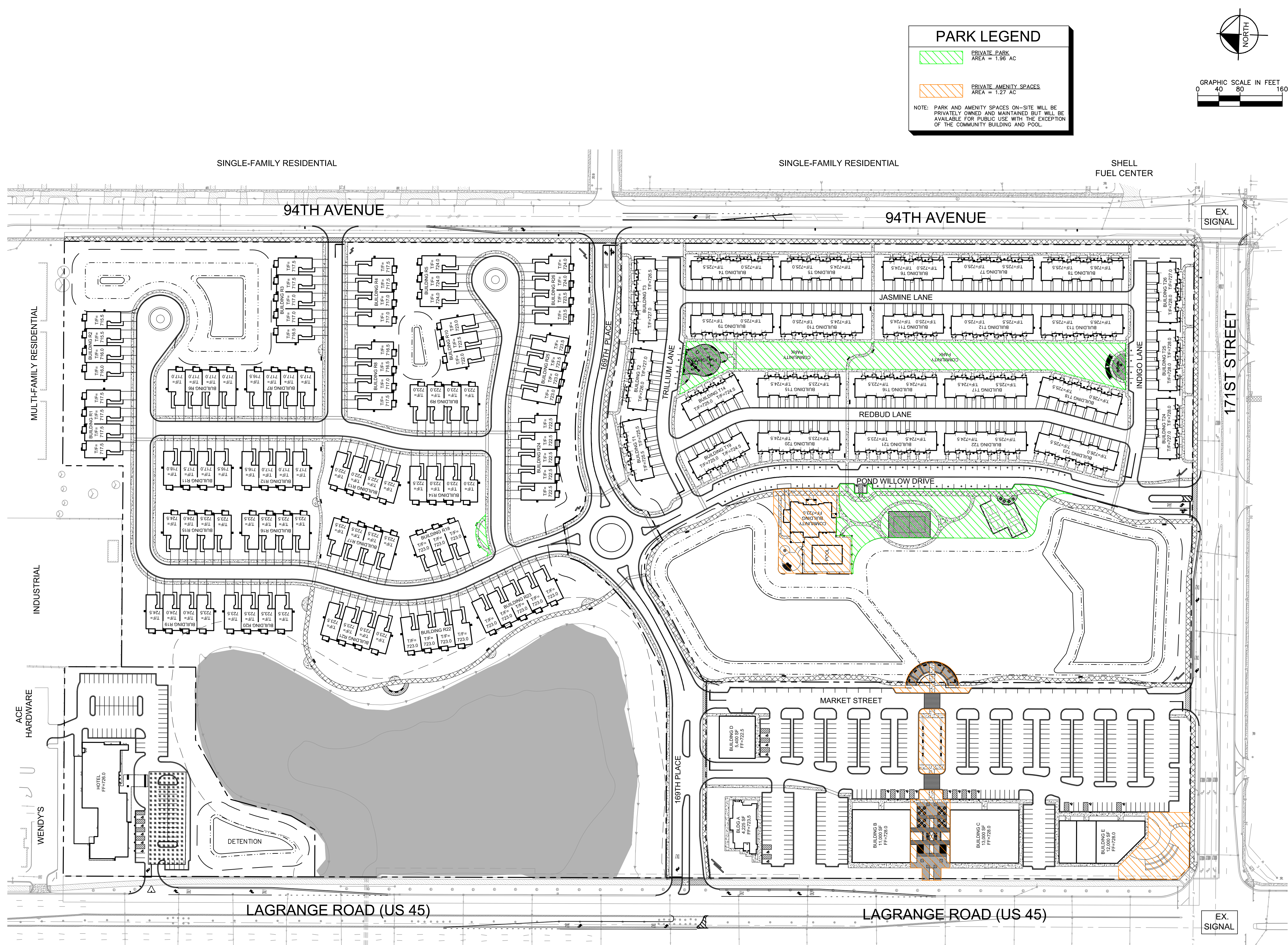

NO.	REVISIONS	DATE	BY
1	REVISED PER VILLAGE COMMENTS	11/16/18	WAW
2	REVISED PER VILLAGE COMMENTS	01/07/19	WAW

Kimley»Horn
 © 2018 KIMLEY-HORN AND ASSOCIATES, INC.
 1001 WARRENVILLE ROAD, SUITE 350,
 Lisle, IL 60532-5450
 WWW.KIMLEY-HORN.COM

SCALE: AS NOTED
 DESIGNED BY: TBE
 DRAWN BY: JDC
 CHECKED BY: WAW

**PRELIMINARY
 NOT FOR
 CONSTRUCTION**



**PARK AREA
 EXHIBIT**

ORLAND RIDGE
 LAGRANGE ROAD & 171ST STREET
 ORLAND PARK, IL 60487

ORIGINAL ISSUE:
 11/06/2018
 KHA PROJECT NO.
 168626000
 SHEET NUMBER

EX 1