

# PARKREATION, INC

**27 East Palatine Road, Prospect Heights, IL 60070**

February 2, 2016

Quotation Number: P010816D-REV

Orland Park Recreation & Parks Department  
14700 Ravinia Ave.,  
Orland Park, IL 60462

Project Name: Shades for the pool

Quoted By: Paul Gozder

<u>QTY.</u>	<u>Product #</u>	<u>Description</u>	<u>All pricing is valid for 30 days</u>		<u>Unit Price</u>	<u>Total Price</u>
09	SP12	12' x 12' x 8' high single post shade units by Shade Systems Inc. Turn n' slide easy fabric removal system on all 4 corners Inground – direct bury post 2016 list price	\$ 2,996.00		\$ 26,964.00	
		Less applied discount	\$ -661.00		\$ -5,949.00	
		<b>Total</b>	<b>\$ 2,335.00</b>		<b>\$ 21,015.00</b>	
01	custom	Shade Sail per attached drawing (10-13-15) Consisting of (5) 10' columns and (1) 15' column and (5) shade sails Direct bury – inground footings Engineering on shade unit (if needed) Shipping on (9) SP12 and (1) custom shade sail <b>Total</b>				<b>\$ 18,658.00</b>
				add	\$ 900.00	
					<b>\$ 3,520.00</b>	
						<b>\$ 44,093.00</b>

Frame Color: \_\_\_\_\_ Fabric Color: \_\_\_\_\_

**Terms:**

1. "I/We understand that all accounts are payable to Parkreation, Inc. according to the terms of their invoice, and if not paid on or before said date, are then delinquent. I/We agree to pay any and all service charges added each month to past due invoices. Terms are Net 30 days upon delivery with approved credit. All charges are due and payable in full at Parkreation, Inc., 27 E. Palatine Rd., Prospect Heights, IL 60070 unless notified in writing to the contrary. To the extent the terms and conditions of any purchase order/contract and/or any purchase order/contract confirmations are inconsistent with the terms and conditions of this signed quote, the terms and conditions of this signed quote shall prevail.
2. All pricing is valid for 30 days from the date above.
3. The above pricing (if more than one item) is based upon a package purchase. Any adjustments may be subject to a price revision.
4. Customer is responsible for the off-loading of the equipment and an accurate inventory should be taken at the time and all missing or damaged parts should be noted to the Driver. You have 60 days to report any missing or damaged parts to your sales representative. Truck Driver will not unload equipment.
5. Nontaxable entities are required to provide copy of tax exempt certificate or be taxed upon invoice.
6. Installation not included unless specifically quoted

Date \_\_\_\_\_ Purchaser's Signature \_\_\_\_\_ Purchaser's Title \_\_\_\_\_

Email Address \_\_\_\_\_ Special Instructions \_\_\_\_\_

Ship to address \_\_\_\_\_

Park Site Address \_\_\_\_\_

**IllinoisOffice@Parkreation.com - 27 East Palatine Road, Prospect Heights, IL 60070 - Phone 847-419-7744, Fax 847-419-7747**

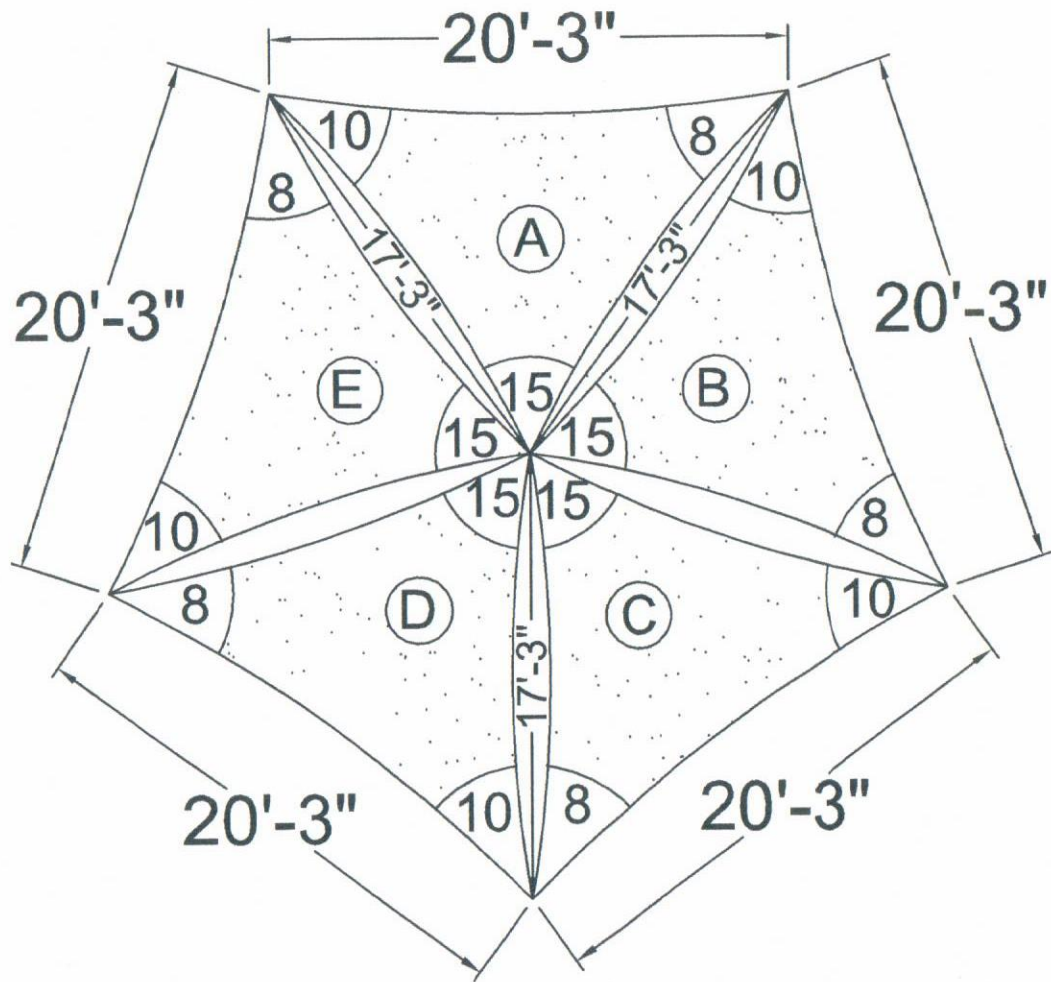

**Detail**

**Centennial Pool**  
10/13/15

Drawing. Not for construction. All information shown is subject to change by mfr prior to delivery. Use only drawings and instructions provided with your order for construction.