

LEGEND	
	HMA PAVEMENT
	HEAVY DUTY PAVEMENT (HMA) ON TOP
	CONCRETE SIDEWALK
	NEW LANDSCAPED AREA
	DEPRESSED CURB AND GUTTER
	8-6.12 CURB AND GUTTER
	REVERSE PITCH CURB AND GUTTER
	6-INCH BARRIER CURB

- SITE PLAN GENERAL NOTES:**
- CONTRACTOR SHALL PERFORM ALL CONSTRUCTION WORK IN ACCORDANCE WITH ALL FEDERAL, STATE AND LOCAL REQUIREMENTS.
 - THE VILLAGE OF ORLAND PARK AND THE OWNER SHALL BE NOTIFIED AT LEAST 48 HOURS PRIOR TO THE START OF CONSTRUCTION.
 - THIS PLAN WAS PREPARED FROM TOPOGRAPHIC SURVEY PREPARED BY MACKIE CONSULTANTS, LLC - SURVEYING DATED 11/02/2011 AND AVAILABLE RECORDS. BEFORE COMMENCING WORK, THE ENGINEER HAS REVIEWED THE OWNER'S RECORDS. ANY DISCREPANCIES ARE TO BE NOTED.
 - ALL DIMENSIONS ARE TO THE BACK OF CURB OR FACE OF BUILDING, UNLESS OTHERWISE NOTED.
 - ALL RADIUS ARE TO THE BACK OF CURB, UNLESS OTHERWISE NOTED.
 - ALL ON-SITE PAVEMENT MARKINGS SHALL BE YELLOW EPOXY PAINT, UNLESS OTHERWISE NOTED.
 - CONCRETE SHALL BE CAST WITH AN EXISTING DEPTH WITHIN 1/4" OF VARIATION.
 - REFLECTIVE MARKINGS FOR HANDICAPPED ACCESSIBLE RAMPS SHALL BE RED IN COLOR.
 - SEE ARCHITECTURAL PLANS FOR DETAILS OF TRASH COMPACTOR.
 - ALL CURB ISLANDS TO HAVE 2' MIN. RADIUS ON CORNERS UNLESS OTHERWISE SHOWN.
 - ALL PAVING WORK FOR ROAD AND DRIVEWAY CONSTRUCTION SHALL BE IN ACCORDANCE WITH THE STANDARD SPECIFICATIONS FOR ROAD AND DRIVEWAY CONSTRUCTION, TYPICAL AND FIELD CONDITIONS, 2011 EDITION, ILLINOIS STATE HIGHWAY DEPARTMENT, AND FIELD CONDITIONS, 2011 EDITION, ILLINOIS STATE HIGHWAY DEPARTMENT.
 - ALL TRASH ENCLOSEURES SHALL BE RECONSTRUCTED WITH A 6" HIGH FENCE MADE OF SOLID PANEL WOOD OR WOOD-LIKE MATERIAL. NO CHAIN LINK FENCE WILL BE ALLOWED FOR THE TRASH ENCLOSURES.

PARKING	
EXISTING PARKING STALLS PROVIDED	224
EXISTING NON-ACCESSIBLE PARKING STALLS PROVIDED	214
EXISTING ACCESSIBLE PARKING STALLS PROVIDED	10
TOTAL PARKING STALLS PROPOSED	247
TOTAL NON-ACCESSIBLE PARKING STALLS PROPOSED	240
TOTAL ACCESSIBLE STALLS PROPOSED	7

EXISTING PARKING LOT (OUTSIDE LIMITS OF PAVEMENT) SHALL REMAIN UNDISTURBED

FIRE LANES AND EMERGENCY ACCESS SHALL BE MAINTAINED AT ALL TIMES

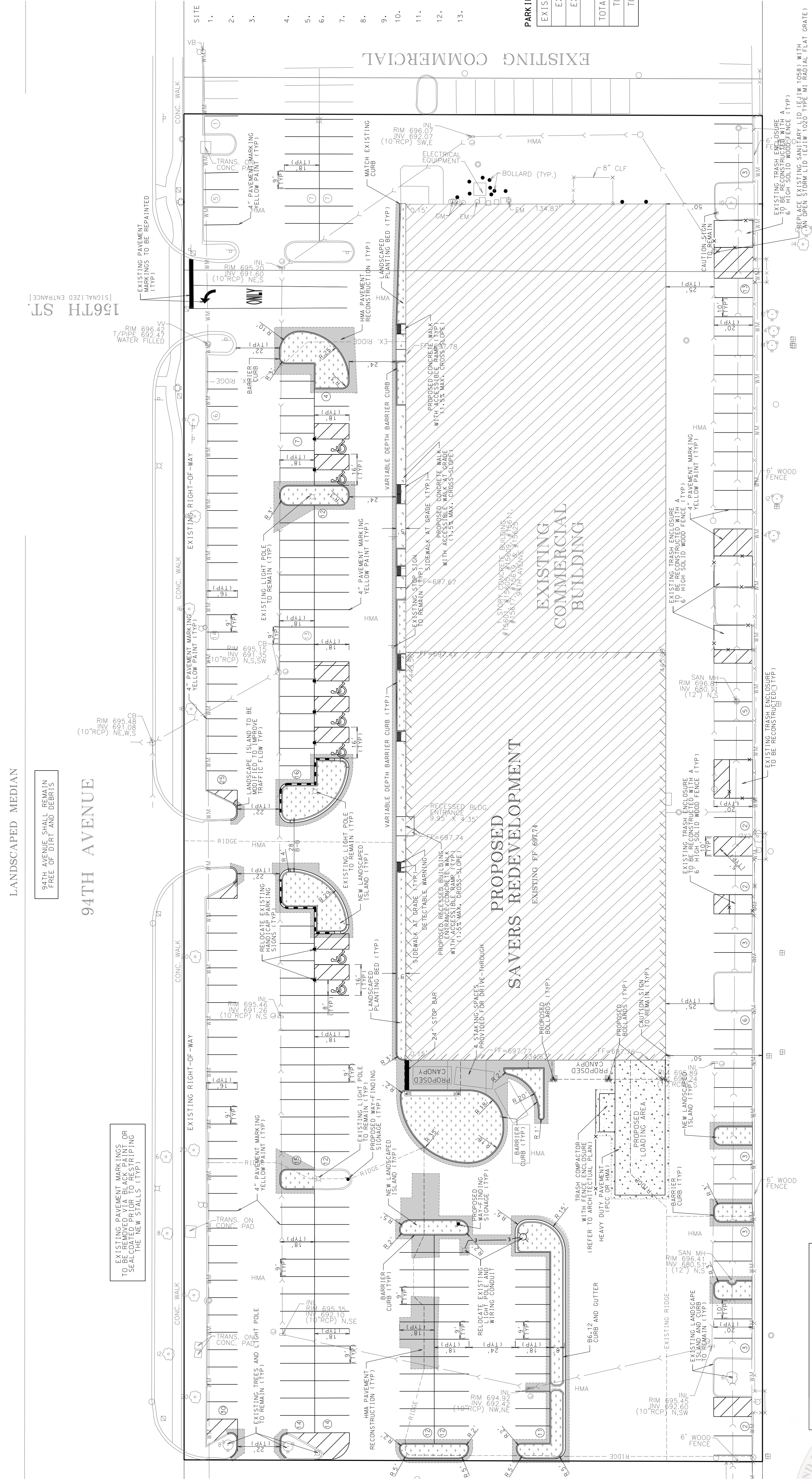

BOARD APPROVED

Case No: 2011-0745
 Date: 02.16.12
 W/Conditions: YES
 W/Out Conditions:



VILLAGE OF ORLAND PARK

Mackie Consultants, LLC
 9575 W. Higgins Road, Suite 500
 Rosemont, IL 60018
 (847) 986-1400
 www.mackieconsult.com

CROSSROADS DEVELOPMENT PARTNERS LLC
 1300 EAST WOODFIELD ROAD, SUITE 150
 SCHAUMBURG, ILLINOIS 60173
 (P) 847-239-7506 (F) 847-239-7520

DATE	DESCRIPTION OF REVISION	BY	SCALE
1-25-12	REVISED PER VILLAGE OF ORLAND PARK COMMENTS	AJM	1" = 30'
1-13-12	REVISED PER VILLAGE OF ORLAND PARK COMMENTS	AJM	1" = 30'
12-23-11	REVISED PER VILLAGE OF ORLAND PARK COMMENTS	AJM	1" = 30'

DESIGNED: AJM
 DRAWN: WHM
 APPROVED: MTB
 DATE: 11-11-11

FINAL SITE PLAN
SAVERS - ORLAND PARK PLAZA
ORLAND PARK, ILLINOIS