



MIDWAY FLOORING

10216 Werch Drive, Suite #114
 Woodridge, IL 60517
 (630)-520-8816

Proposal Letter JE004231-001

CLIENT	PROJECT
VILLAGE OF ORLAND PARK 14700 RAVINA AVENUE ORLAND PARK, IL 60462	ORLAND PARK - FRANKLIN LOEBE RE 14650 S RAVINIA AVE LOWER LEVEL ORLAND PARK, IL 60467

Proposal Letter Date	Job Contact	Salesperson 1	Job #			
08/16/24	MICHAEL MAZZA	GLENN SUTKUS				
Area	Style/Item	Color/Desc	Qty	Price	Total	
01. CARPET TILE	SHAW CONTRACT - 59455 FOCUS TILE	54505 FREEDOM - 24" CARPET TILES	538.63 SY	39.59	21,324.36	
02. CARPET TILE (OVERAGE)	SHAW CONTRACT - 59455 FOCUS TILE	54505 FREEDOM - 24" CARPET TILES	53.33 SY	39.59	2,111.33	
03. ADHESIVE	SHAW LOKWORX+ CARPET TILE ADHESIVE	4 GALLON PAIL	5.00 EA	123.25	616.25	
04. CARPET INSTALL	LABOR TO INSTALL CARPET TILE		510.00 SY	11.95	6,094.50	
					CARPET Sub Total:	30,146.44
05. VCT REMOVAL	LABOR TO REMOVE EXISTING VCT TO CUSTOMER SUPPLIED DUMSPTER		2,315.00 SF	2.00	4,630.00	
06. CARPET REMOVAL	LABOR TO REMOVE EXISTING CARPET TO CUSTOMER SUPPLIED DUMSPTER		252.00 SY	7.02	1,769.04	
					DEMO WORK Sub Total:	6,399.04
07. SKIM COAT	MATERIAL AND LABOR TO SKIM COAT FLOORS FOR NEW FINISHES		4,590.00 SF	1.60	7,344.00	
					FLOOR PREPARATION Sub Total:	7,344.00
08. WALL BASE	TARKETT 4" COVE VINYL BASE	40 BLACK - 4' LENGTHS	960.00 LF	1.02	979.20	
09. BASE INSTALL	LABOR TO INSTALL BASE		860.00 LF	2.00	1,720.00	



MIDWAY FLOORING

10216 Werch Drive, Suite #114
 Woodridge, IL 60517
 (630)-520-8816

Proposal Letter JE004231-001

CLIENT	PROJECT
VILLAGE OF ORLAND PARK 14700 RAVINA AVENUE ORLAND PARK, IL 60462	ORLAND PARK - FRANKLIN LOEBE RE 14650 S RAVINIA AVE LOWER LEVEL ORLAND PARK, IL 60467

Proposal Letter Date	Job Contact	Salesperson 1	Job #
08/16/24	MICHAEL MAZZA	GLENN SUTKUS	

Area	Style/Item	Color/Desc	Qty	Price	Total
10. TRANSITIONS	FURNISH AND INSTALL TRANSITIONS		123.00 LF	5.33	655.59
WALL BASE Sub Total:					3,354.79
11. STAIR TREADS	TARKETT - RUBBER STAIR TREADS - HAMMERED	COLOR TBD - 6' WIDE	150.00 LF	35.60	5,340.00
12. NOSING EPOXY	TARKETT 930 NOSING EPOXY CAULK	13.5 OZ	3.00 EA	54.28	162.84
13. RUBBER ADHESIVE	TARKETT 965 ADHESIVE	4 GALLON PAIL	1.00 EA	180.40	180.40
14. STAIR INSTALL	LABOR TO INSTALL RUBBER STAIR TREADS		120.00 LF	29.41	3,529.20
15. STAIR DEMO	LABOR TO TAKE UP EXISTING RUBBER STAIR TREADS		120.00 LF	13.51	1,621.20
STAIRS Sub Total:					10,833.64
16. TF-1	FLOOR TILE ALLOWANCE	FIGURED AS DAL TILE - VOLUME 1.0	460.00 SF	5.67	2,608.20
17. TW-1	WALL TILE ALLOWANCE	FIGURED AS DAL TILE - VOLUME 1.0	330.00 SF	5.67	1,871.10
18. TB-1	TILE BASE ALLOWANCE	FIGURED AS DAL TILE - VOLUME 1.0	130.00 PC	7.09	921.70
19. WATERPROOFING	CUSTOM REDGARD	3.5 GALLON PAIL	2.00 EA	226.67	453.34
20. SETTING MATERIALS	STANDARD MORTAR AND GROUT	STANDARD SETTING MATERIALS (NO EPOXY)	690.00 SF	1.77	1,221.30
21. FLOOR TILE INSTALL	LABOR TO INSTALL FLOOR TILE OVER WATERPROOF MEMBRANE		405.00 SF	19.34	7,832.70



MIDWAY FLOORING

10216 Werch Drive, Suite #114
 Woodridge, IL 60517
 (630)-520-8816

Proposal Letter JE004231-001

CLIENT	PROJECT
VILLAGE OF ORLAND PARK 14700 RAVINA AVENUE ORLAND PARK, IL 60462	ORLAND PARK - FRANKLIN LOEBE RE 14650 S RAVINIA AVE LOWER LEVEL ORLAND PARK, IL 60467

Proposal Letter Date	Job Contact	Salesperson 1	Job #
08/16/24	MICHAEL MAZZA	GLENN SUTKUS	

Area	Style/Item	Color/Desc	Qty	Price	Total
22. WALL TILE INSTALL	LABOR TO INSTALL WALL TILE		285.00 SF	21.34	6,081.90
23. BASE TILE INSTALL	LABOR TO INSTALL TILE BASE		116.00 LF	11.34	1,315.44
24. FLOOR LEVELING (AT RESTROOMS)	MATERIAL AND LABOR TO SELF LEVEL FLOORS AT RESTROOMS		405.00 SF	6.75	2,733.75
RESTROOMS Sub Total:					25,039.43
25. FREIGHT/DELIVERY	FREIGHT/DELIVERY TO JOBSITE		1.00 LS	875.00	875.00
FREIGHT/DELIVERY Sub Total:					875.00
26. BOND	BOND		1.00 LS	4,199.62	4,199.62
BOND Sub Total:					4,199.62



MIDWAY FLOORING

10216 Werch Drive, Suite #114
Woodridge, IL 60517
(630)-520-8816

CLIENT	PROJECT
VILLAGE OF ORLAND PARK 14700 RAVINA AVENUE ORLAND PARK, IL 60462	ORLAND PARK - FRANKLIN LOEBE RE 14650 S RAVINIA AVE LOWER LEVEL ORLAND PARK, IL 60467

Proposal Letter Date	Job Contact	Salesperson 1	Job #		
08/16/24	MICHAEL MAZZA	GLENN SUTKUS			
Area	Style/Item	Color/Desc	Qty	Price	Total

**** Franklin Loebe Recreation Center - Lower Level Carpet, Stair Treads, & (2) Restrooms ****
Pricing per Sourcewell Contract #080819

Notes:

1. Labor figured for standard daytime hours - No Overtime/Double Time included
2. Material quantities have been rounded to the full carton
3. Vinyl planks, resilient, carpet to be glued directly to the floor surface – No underlayment or padding
4. Transitions to be standard black vinyl or satin anodized aluminum unless otherwise noted
5. **Due to volatile product pricing – This quote is only good for 30 Days**

Exclusions:

1. Extensive Floor Prep: Shot blasting, Scarifying, Deep Fills, Floating to ceramic, and Leveling
2. Expansion/Control Joints, Chair Rails, Corner Guards, and Wood Base
3. Epoxy thinset or epoxy grout
4. Haul away or dumpster service
5. Post/Final Cleanup – Wall wipe downs, Dusting, Vacuuming, Deep Cleaning, Waxing, and Buffing
6. Patching/repairing finishes
7. Attic stock
8. Moisture testing and mitigation

Total Proposal: \$88,191.96

Customer Approval:
Please sign and date your acceptance of this proposal.

Signature

Date of Acceptance

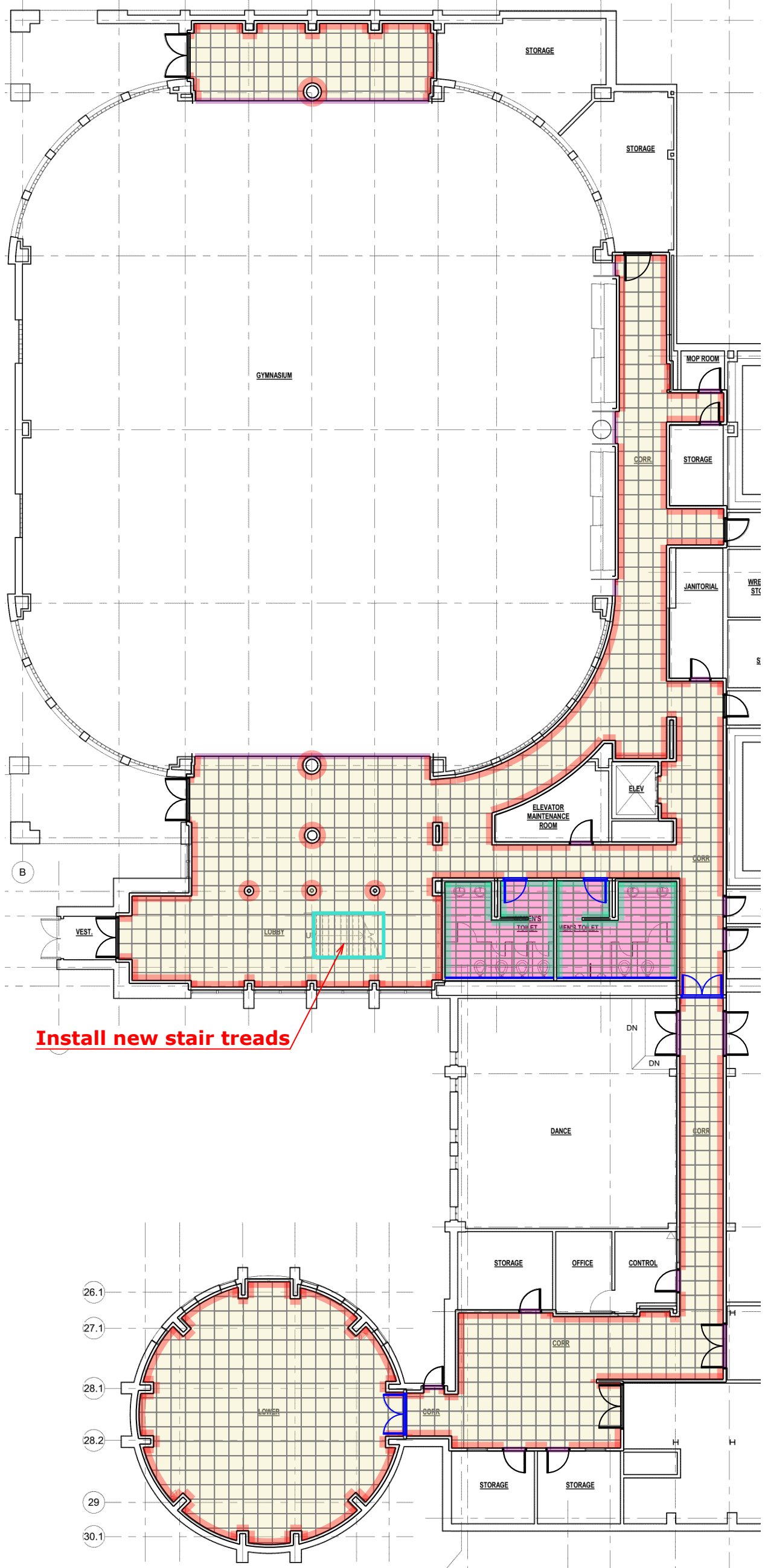

Install new stair treads

- CPT-1: Shaw - Focus Tile 59455 - Freedom 54505 - 24" x 24" SY
- VBC-1: Tarkett 4" Cove Base - 40 Black - 4' Lengths - 4" LF
- Carpet to EX - 4" LF
- Floor Tile Allowance - 12" x 24" SF
- Wall Tile Allowance - 6" x 6" SF
- Tile Cove Base - 4" LF

