

131st STREET

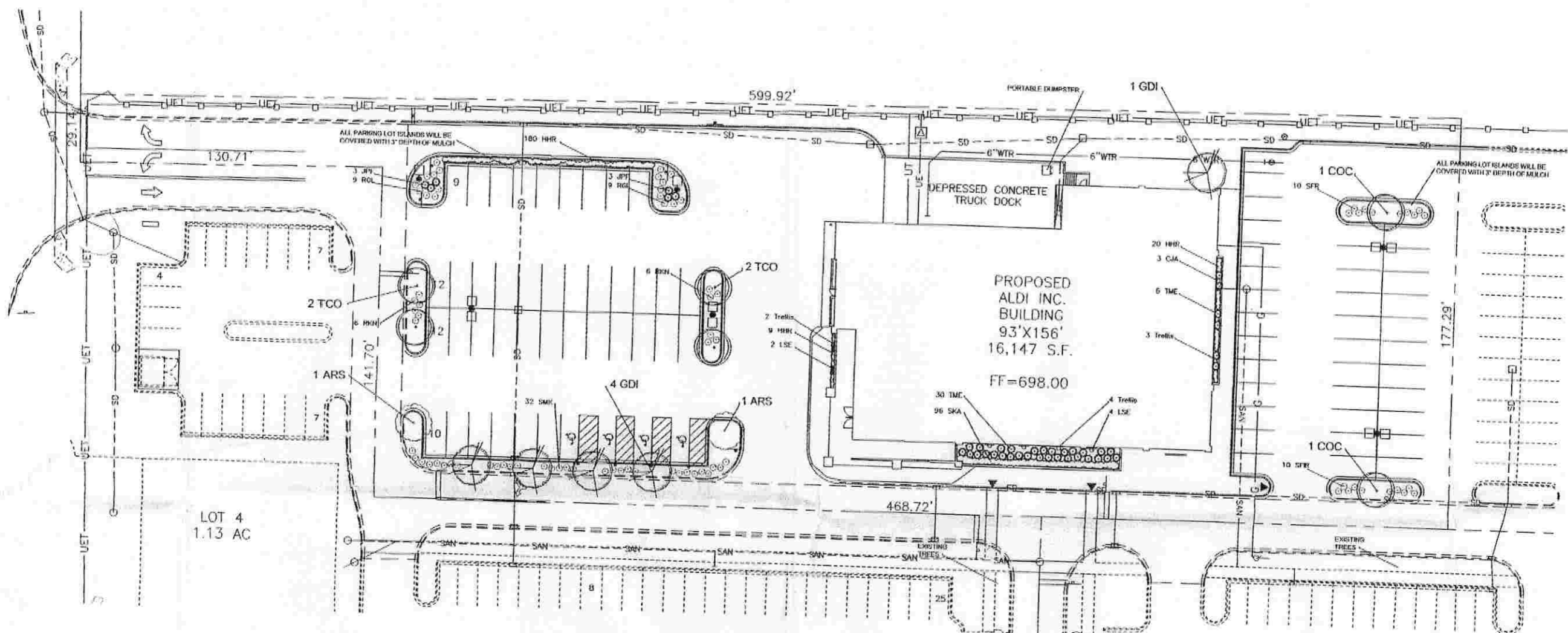

BOARD APPROVED

CASE NO. 2007-0708-0

DATE 11-5-07

W/CONDITIONS \_\_\_\_\_

W/O CONDITIONS

PLAN NOTES:

- The contractor shall provide and install all plant materials in accordance with the quantities and specifications shown on the drawings unless noted otherwise. All plants shall comply with the requirements of the current American Standard for Nursery Stock, published by the American Association of Nurseries. Plants shall meet size, genus, species, and variety. Plants shall be in good health, free of disease, insects and defects. No "Bare Ground" material shall be accepted. Plants may be substituted upon the approval of the Landscape Architect or the governing municipality.
- All plants shall be watered during the first 24-hour period after installation. Contractor is responsible for watering and care. A schedule must be approved upon with the owner, before and is included, of when, when and how and to be properly watered. The contractor is responsible for site visits to ensure the proper watering is being done for establishment and health.
- Plants shall be balled and burlapped in containers given as specified. No root bound material shall be accepted and all wrapping material made of synthetic or plastic shall be removed at the time of planting. It is the contractor's option to risk back being from the top of the ball.
- All shrub beds and tree rings shall receive 3" depth of standard hardwood mulch. All new tree rings shall be 4" in diameter. All perennials shall receive 1" depth of hardwood mulch.
- All plants shall be set/planted. It is the contractor's option to allow deciduous trees, but if it then the contractor's responsibility to ensure plants remain planted until the end of the growing period. All deciduous trees shall be wrapped to prevent winter damage, which shall be removed after the first winter. All evergreen trees must be staked.
- Prune, trim, and shape new plants in accordance with standard horticultural practices to retain their natural character. Do not cut live leader, but be sure to remove any spread, damaged, dead, or crossed branches from the plant at the time of installation.
- All ground cover and perennials shall receive a 3" depth of organic compost, which shall be installed into the existing topsoil utilizing two lifts. Trees and shrubs shall be back filled with good existing topsoil.
- The contractor shall locate the existence of all underground utilities prior to starting. The contractor must also keep the pavement and work area in a neat and orderly condition throughout the construction process.
- Owner shall provide contractor with final grade from the approved grading plan to a finish of a foot with sufficient quality to support the proposed landscape. If important topsoil is required it shall be done at the owner's expense. The general contractor shall remove all construction debris.
- Seed & straw blanket shall extend to all property lines, unless otherwise noted.
- All edging to be specified material edge, no steel or plastic edging shall be used unless otherwise noted.
- Information contained in "Plan Notes" take precedence over other information.

Plant Material List:

Symbol	Botanical Name	Common Name	Size	Qty	Remarks
<b>Shade Trees</b>					
ARS	<i>Acer r. 'Red Sunset'</i>	Red Sunset Maple	3" Cal.	2	Matching Specimens
COC	<i>Celtis occidentalis</i>	Common Hackberry	3" Cal.	2	Matching Specimens
GDI	<i>Gymnocladus dioica</i>	Kentucky Coffeetree	3" Cal.	5	Matching Specimens
TCO	<i>Tilia cordata</i>	Littleleaf Linden	3" Cal.	4	Matching Specimens
				<b>Total</b>	<b>13</b>
<b>Evergreen Shrubs</b>					
JFF	<i>Juniperus c. 'Pfitzerana'</i>	Compact Pfitzer Juniper	24" H.	6	Matching Specimens
TME	<i>Taxus x media densiformis</i>	Densi Yew	24" H.	36	Matching Specimens
				<b>Total</b>	<b>42</b>

ALDI - Orland Park, Illinois

Symbol	Botanical Name	Common Name	Size	Qty	Remarks
<b>Deciduous Shrubs</b>					
RGL	<i>Rhus a. 'Gro-Low'</i>	Gro-Low Sumac	5 Gal.	18	Matching Specimens
RKN	<i>Rosa 'Knockout'</i>	Knockout Rose	3 Gal.	12	Matching Specimens
SFR	<i>Spiraea j. 'Frabeli'</i>	Frabeli Spiraea	5 Gal.	20	Matching Specimens
SMK	<i>Syringa p. 'Miss Kim'</i>	Miss Kim Lilac	24" H.	32	Matching Specimens
				<b>Total</b>	<b>82</b>
<b>Perennials, Groundcover &amp; Grasses</b>					
CJA	<i>Clematis x jacksonii</i>	Clematis	1 Gal.	3	Spacing as shown on plan
HFR	<i>Hemerocallis 'Happy Returns'</i>	Daylily	1 Gal.	209	Spacing 18" o.c.
LSE	<i>Lonicera sempervirens</i>	Trumpet Honeysuckle	1 Gal.	6	Spacing as shown on plan
SKA	<i>Sedum kamichaticum</i>	Low Stonecrop	3" Pot	96	Spacing 9" o.c.
				<b>Total</b>	<b>314</b>



1050 W. Lily Cache Lane • Bolingbrook, IL 60440 • Tel 630.759.8300 • Fax 630.759.7245



ALDI - SOUTHMOOR COMMONS  
LA GRANGE ROAD & 131ST STREET  
ORLAND PARK, ILLINOIS



REVISIONS	BY	DATE	SHEET
10/3/2007	SFG	5/29/2007	
SCALE			L-7
1" = 30'			
DRAWN BY			SHEET
CT			
JOB			2

PLOT FILE NAME:

PLOT DATE: