



BOARD APPROVED

Case No: 2011-0080

Date: 10-3-2011

W/Conditions: X

W/Out Conditions:

THOMAS PLACE
ORLAND PARK

PROJECT NAME
NEW BUILDING

LOCATION
ORLAND PARK,
ILLINOIS

Revisions		
Rev #	Rev Date	Description

I hereby certify that this plan, specification, or report was prepared by me or under my direct supervision and that I am a duly Registered Architect under the laws of the State of Illinois.

REGISTRATION NO. DATE

© 2008 RYAN COMPANIES US, INC.

DRAWING STATUS:
PRELIMINARY

SHEET TITLE
BUILDING
ELEVATIONS

SHEET NUMBER

A201

DRAWN BY: PDW CHECKED BY: RSD

JOB NO. 1407-126 DATE 01-31-2011

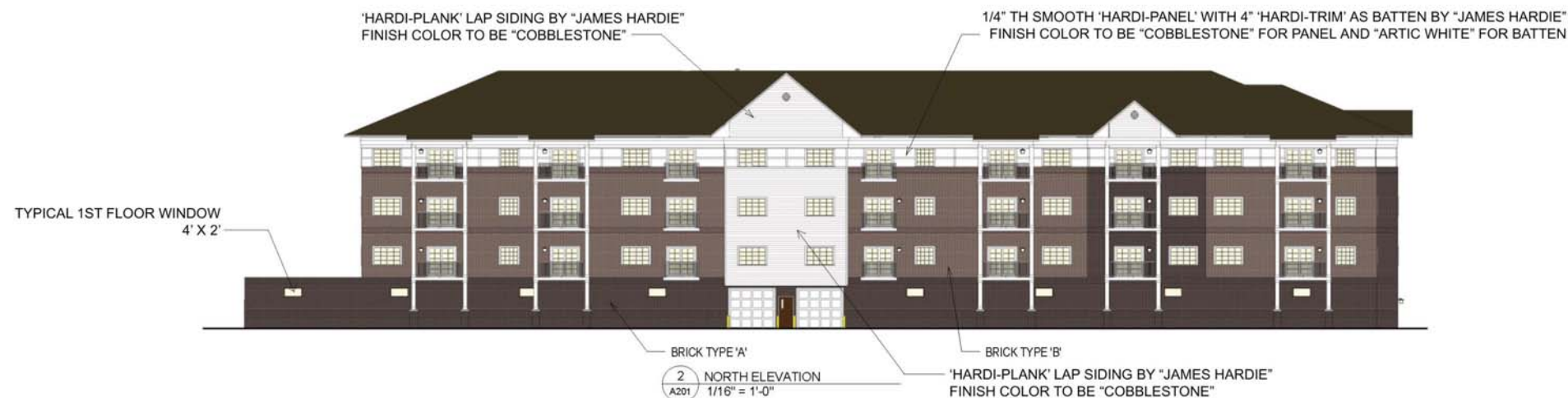

- MECH DECKS 143' - 11 3/4"
- TRUSS BEARING 142' - 2 3/8"
- FOURTH FLOOR 133' - 1 1/4"
- THIRD FLOOR 122' - 2 5/8"
- SECOND FLOOR 111' - 4"
- FIRST FLOOR 100' - 0"