

PROJECT DATA

CLIENT:	COSTCO WHOLESALE 730 LAKE DRIVE ISSAQUAH, WA 98027
PROJECT ADDRESS:	9915 WEST 159TH STREET ORLAND PARK, IL 60462
ZONING:	
EXISTING:	COR-MIXED USE DISTRICT
PROPOSED:	BIZ-GENERAL DISTRICT
EXISTING SITE AREA:	15.60 ACRES (679,436 SF)
PROPOSED SITE AREA:	6.06 ACRES (263,974 SF)
TOTAL NEW SITE AREA:	21.66 ACRES (943,410 SF)
JURISDICTION:	VILLAGE OF ORLAND PARK
SETBACKS:	PER ZONING

BUILDING DATA:	
BUILDING AREA	145,056 S.F.
FOOD SERVICE	1,127 S.F.
TIRE CENTER	5,200 S.F.
TOTAL BUILDING	151,383 S.F.

ENTRY CANOPY	4,052 S.F.
--------------	------------

PARKING DATA:	
EXISTING PARKING PROVIDED:	
# 10' WIDE STALLS	743 STALLS
# HANDICAP STALLS	20 (3 VAN) STALLS
TOTAL EXISTING PARKING	763 STALLS
NO. OF STALLS PER 1000 SF OF BUILDING AREA:	5.28 STALLS

PROPOSED PARKING PROVIDED:	
# 10' WIDE STALLS	845 STALLS
# HANDICAP STALLS	21 (3 VAN) STALLS
TOTAL PROPOSED PARKING	865 STALLS
NO. OF STALLS PER 1000 SF OF BUILDING AREA:	5.71 STALLS
TOTAL PARKING GAINED	+102 STALLS

REVISED PER  
VILLAGE COMMENTS

VICINITY MAP

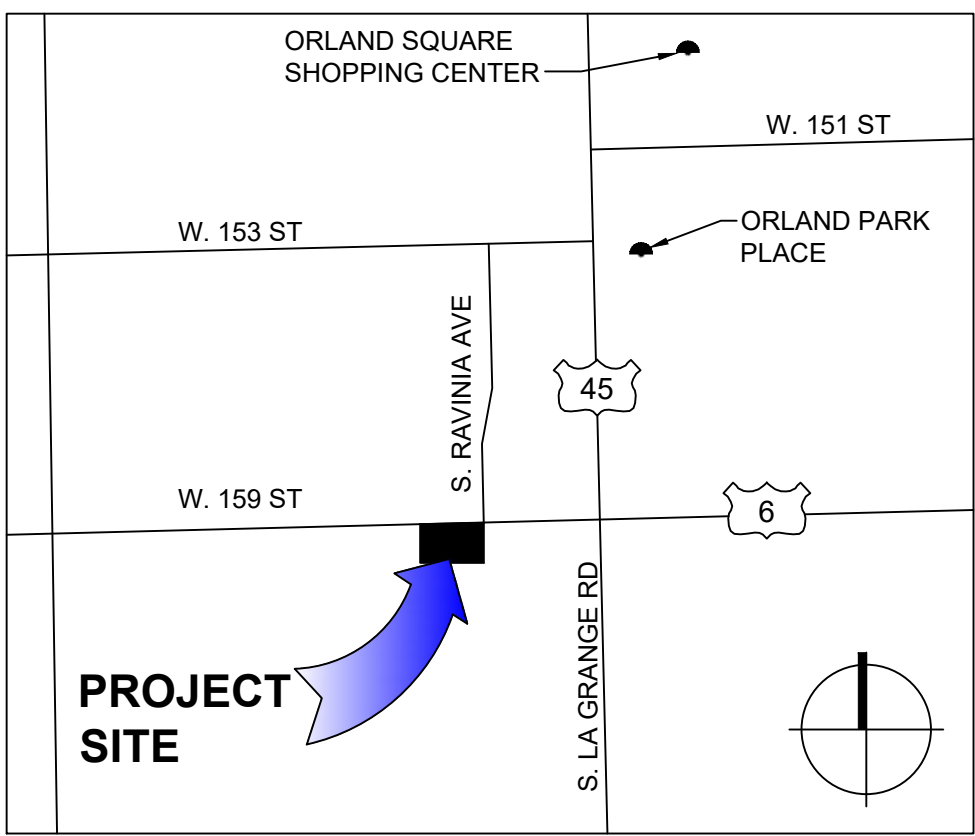

REGIONAL MAP

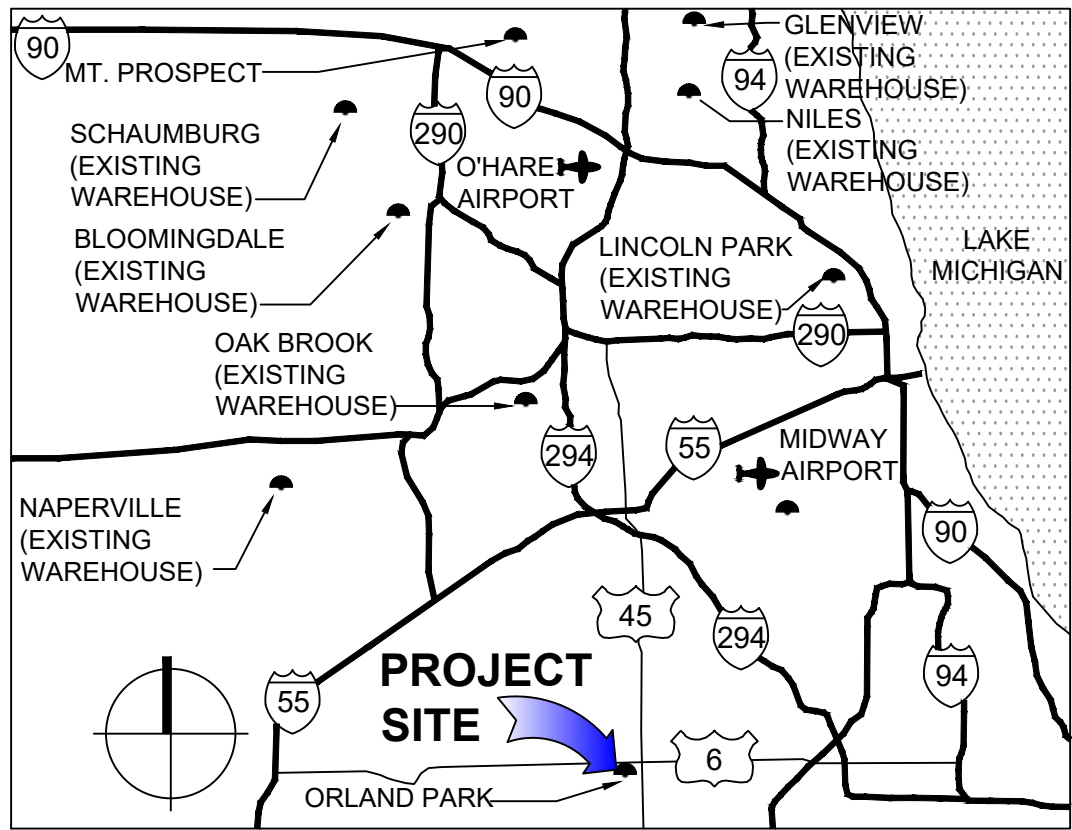

COSTCO WHOLESALE

OVERALL SITE PLAN

ORLAND PARK , IL

JUNE 27 , 2025



ORLAND PARK , IL  
#647

9915 WEST 159TH STREET  
ORLAND PARK , IL 60462

1101 Second Ave, Ste 100  
Seattle, WA 98101  
206 962 6500  
MG2.com



03-1462-12  
JUNE 27, 2025

OVERALL  
SITE PLAN

DD11-10

© MG2, Inc. All rights reserved. No part of this document may be reproduced in any form or by any means without permission in writing from MG2.



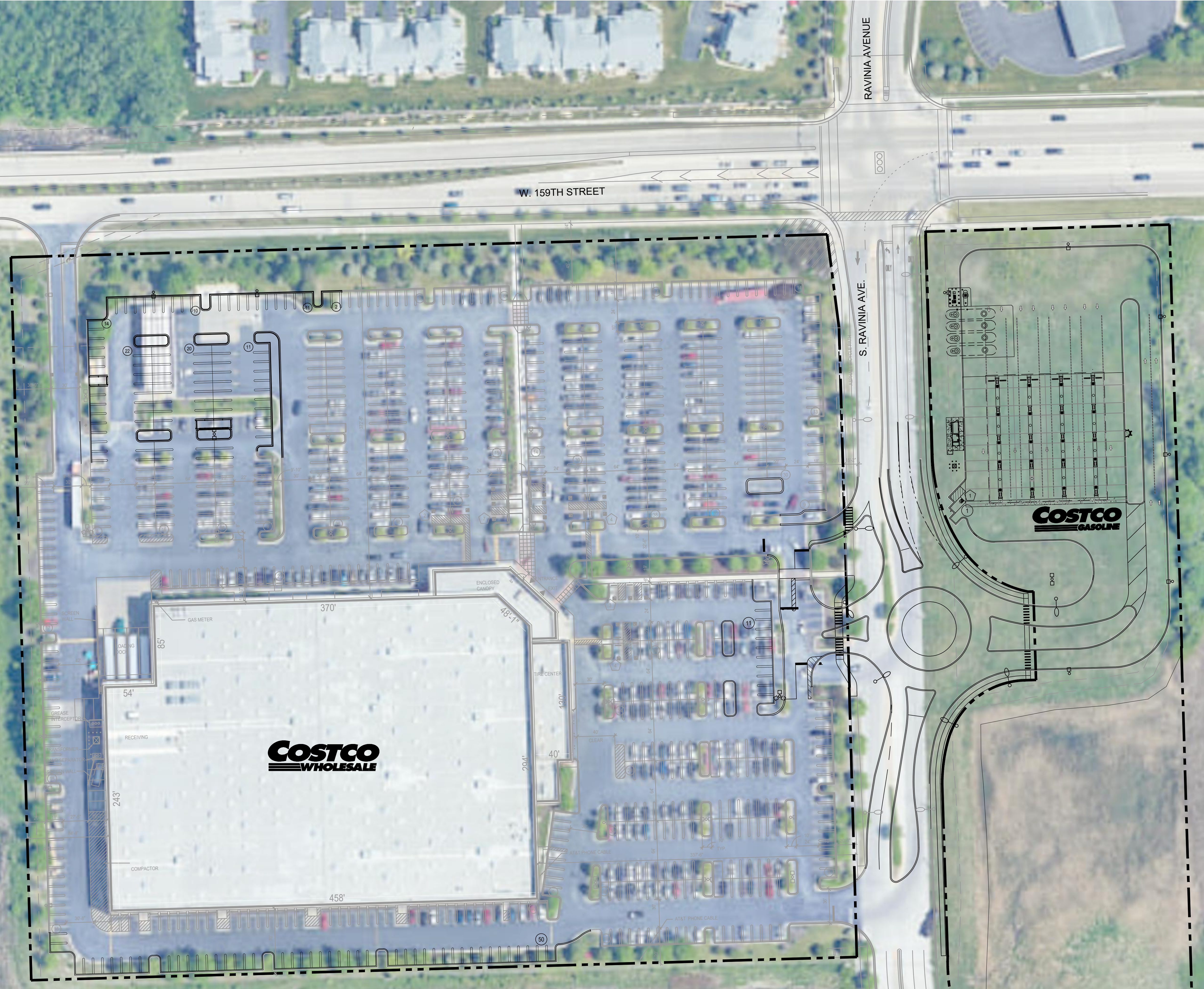

PROJECT DATA

CLIENT:	COSTCO WHOLESALE 730 LAKE DRIVE ISSAQUAH, WA 98027
PROJECT ADDRESS:	9915 WEST 159TH STREET ORLAND PARK, IL 60462
ZONING:	
EXISTING:	COR-MIXED USE DISTRICT
PROPOSED:	BIZ-GENERAL DISTRICT
EXISTING SITE AREA:	15.60 ACRES (679,436 SF)
PROPOSED SITE AREA:	6.06 ACRES (263,974 SF)
TOTAL NEW SITE AREA:	21.66 ACRES (943,410 SF)
JURISDICTION:	VILLAGE OF ORLAND PARK
SETBACKS:	PER ZONING

BUILDING DATA:	
BUILDING AREA	145,056 S.F.
FOOD SERVICE	1,127 S.F.
TIRE CENTER	5,200 S.F.
TOTAL BUILDING	151,383 S.F.
ENTRY CANOPY	4,052 S.F.

PARKING DATA:	
EXISTING PARKING PROVIDED:	
10' WIDE STALLS	743 STALLS
HANDICAP STALLS	20 (3 VAN) STALLS
TOTAL EXISTING PARKING	763 STALLS
NO. OF STALLS PER 1000 SF OF BUILDING AREA:	5.28 STALLS

PROPOSED PARKING PROVIDED:	
10' WIDE STALLS	845 STALLS
HANDICAP STALLS	21 (3 VAN) STALLS
TOTAL PROPOSED PARKING	865 STALLS
NO. OF STALLS PER 1000 SF OF BUILDING AREA:	5.71 STALLS
TOTAL PARKING GAINED	+102 STALLS

VICINITY MAP

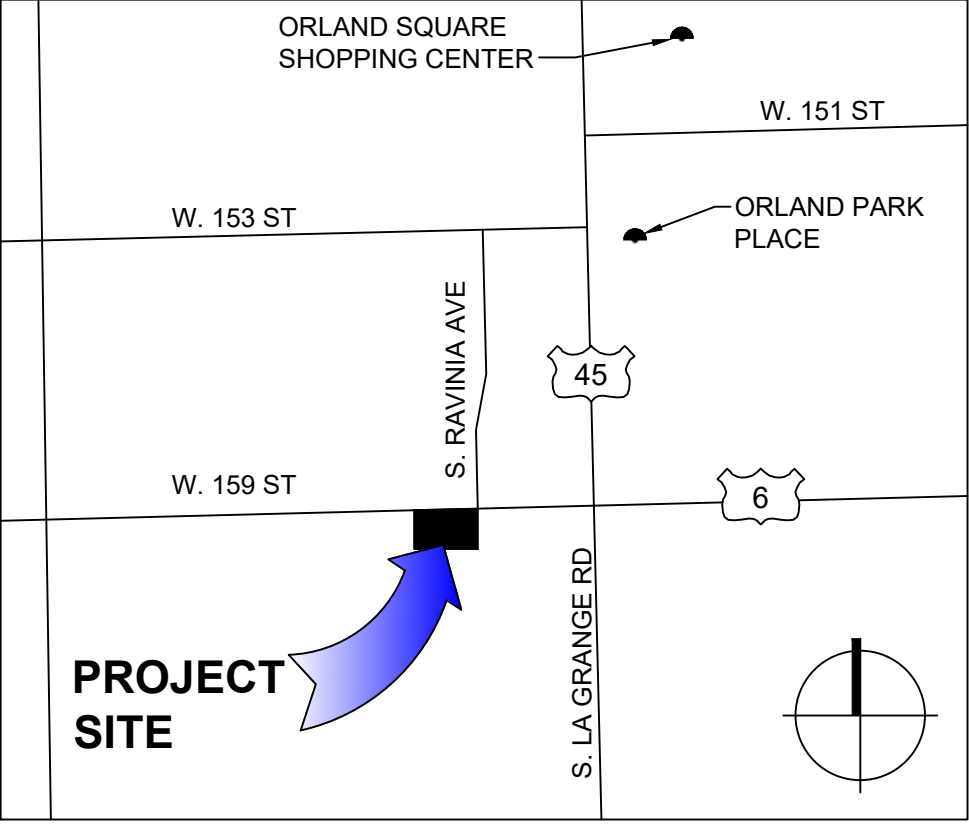

REGIONAL MAP

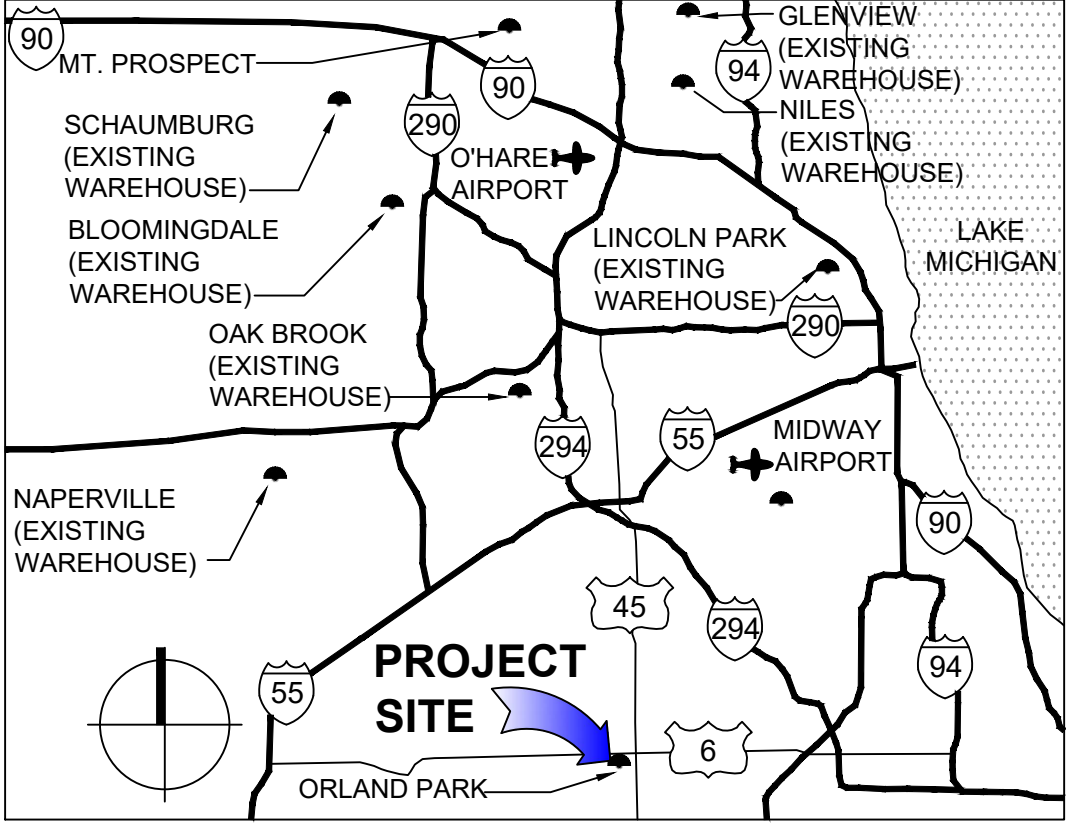

REVISED PER  
VILLAGE COMMENTS

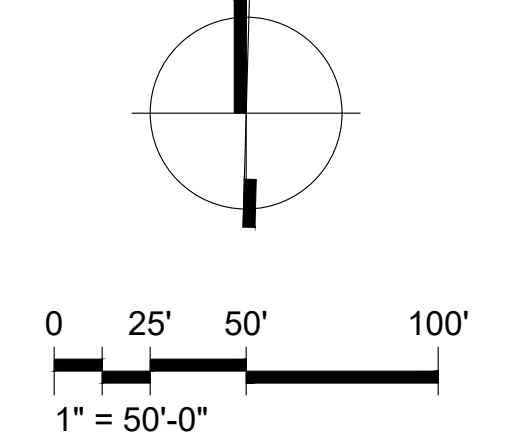

ORLAND PARK , IL  
#647

9915 WEST 159TH STREET  
ORLAND PARK , IL 60462

1101 Second Ave, Ste 100  
Seattle, WA 98101  
206 962 6500  
MG2.com



03-1462-12  
JUNE 27, 2025

AERIAL  
SITE PLAN

DD12-10

COSTCO WHOLESALE

ORLAND PARK , IL

AERIAL SITE PLAN

JUNE 27 , 2025

© MG2, Inc. All rights reserved. No part of this document may be reproduced in any form or by any means without permission in writing from MG2.



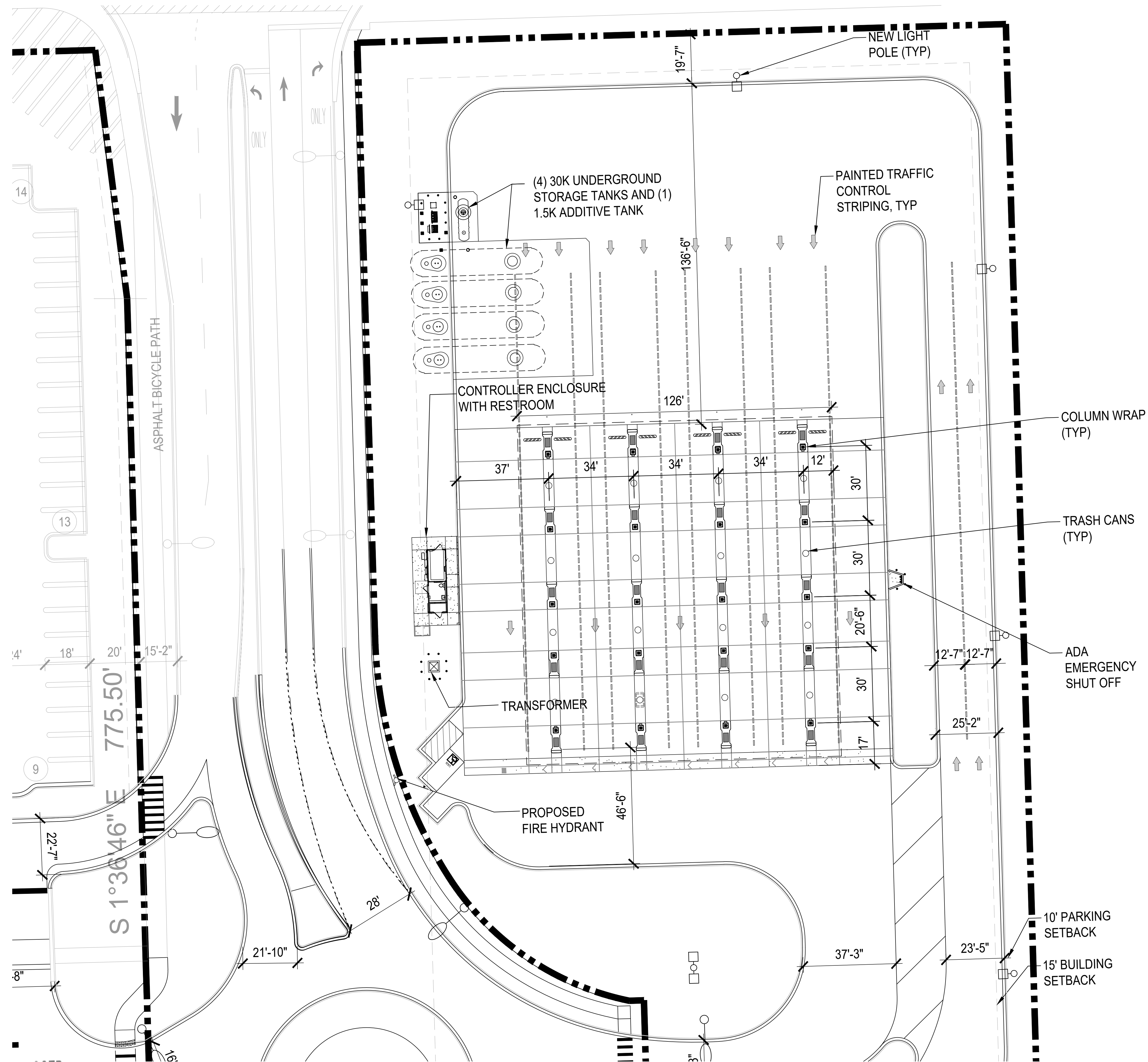

REVISED PER  
VILLAGE COMMENTS

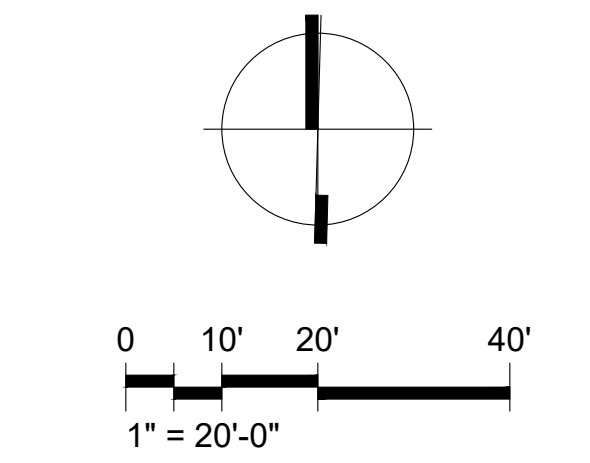

ORLAND PARK, IL  
#647

9915 WEST 159TH STREET  
ORLAND PARK, IL 60462

1101 Second Ave, Ste 100  
Seattle, WA 98101  
206 962 6500  
MG2.com



03-1462-12  
JUNE 27, 2025

ENLARGED SITE  
PLAN

DD11-10A

COSTCO WHOLESALE

ENLARGED SITE PLAN

ORLAND PARK, IL

JUNE 27, 2025

© MG2, Inc. All rights reserved. No part of this document may be reproduced in any form or by any means without permission in writing from MG2.

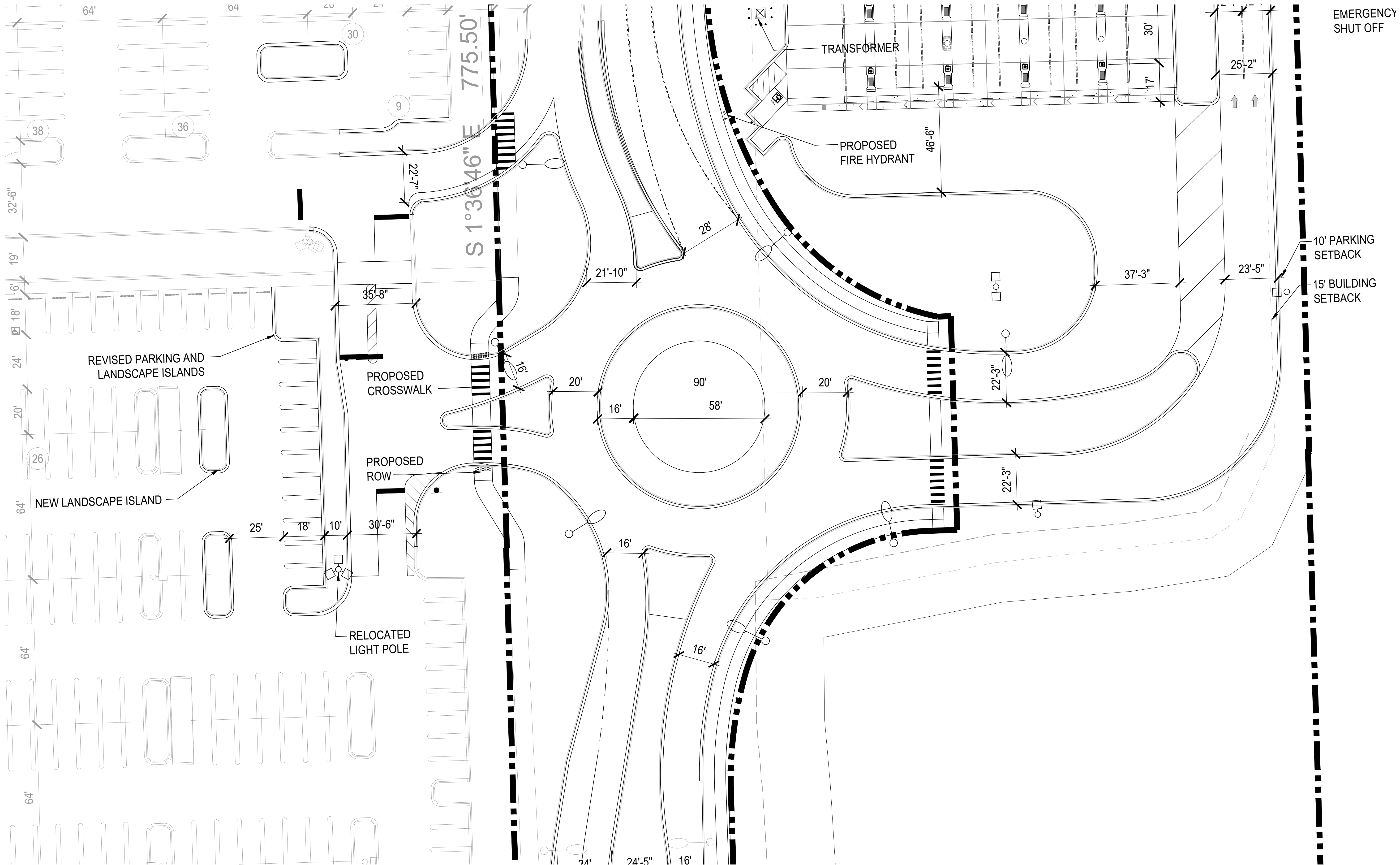

REVISED PER  
VILLAGE COMMENTS

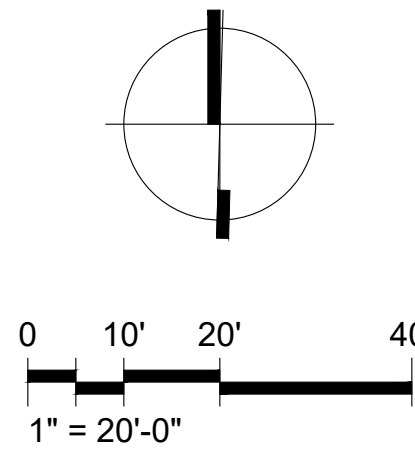

ORLAND PARK , IL  
#647

9915 WEST 159TH STREET  
ORLAND PARK , IL 60462

1101 Second Ave, Ste 100  
Seattle, WA 98101  
206 962 6500  
MG2.com



03-1462-12  
JUNE 27, 2025

ENLARGED SITE  
PLAN

DD11-10B

COSTCO WHOLESALE

ORLAND PARK , IL

ENLARGED SITE PLAN

JUNE 27 , 2025

© MG2, Inc. All rights reserved. No part of this document may be reproduced in any form or by any means without permission in writing from MG2.

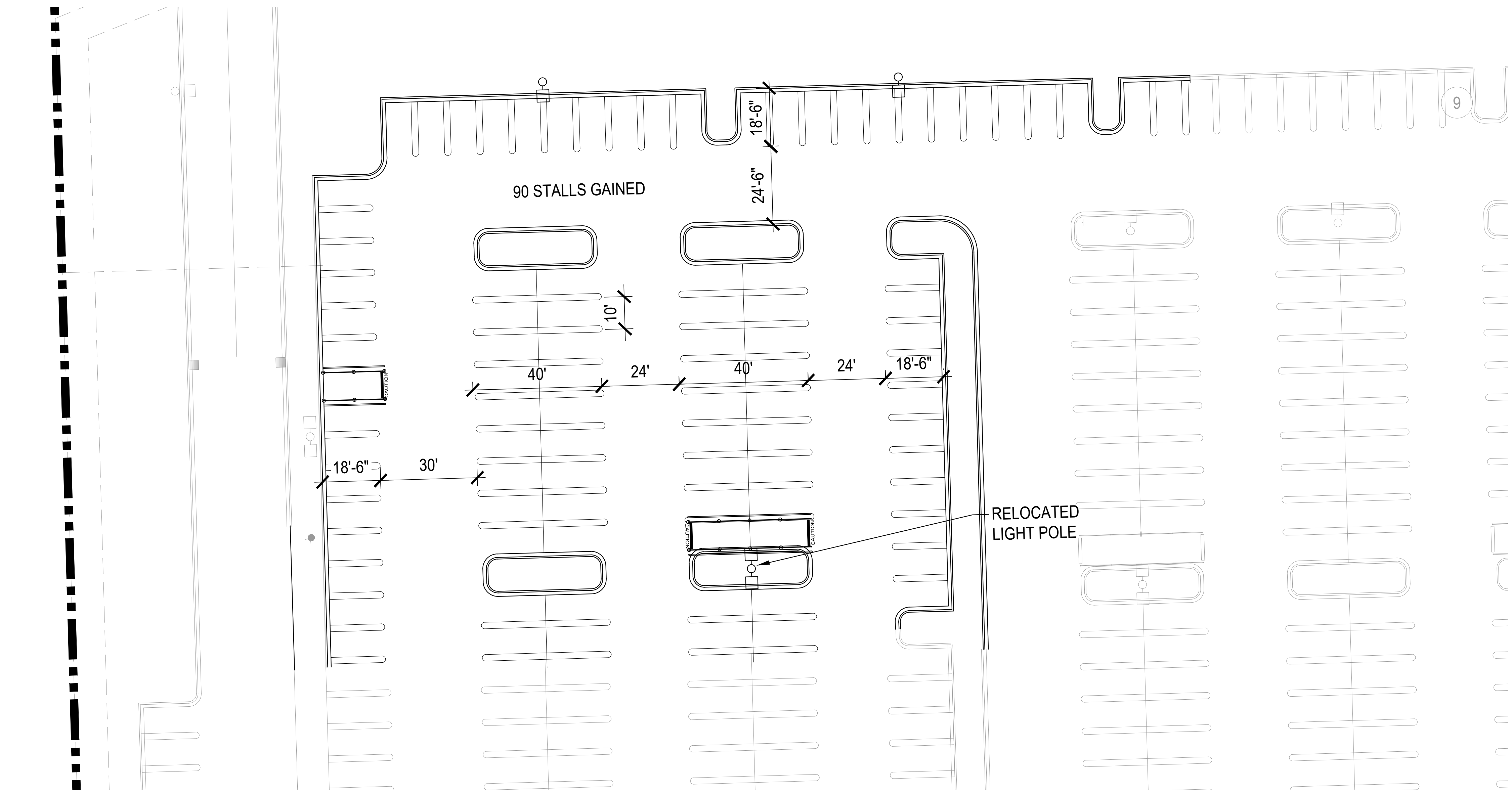

1

## NORTH PARKING PLAN

SCALE: 1" = 20'

REVISED PER  
VILLAGE COMMENTS

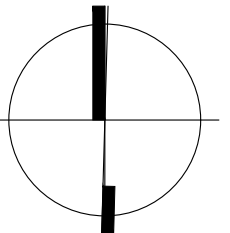

0 10' 20' 40'  
1" = 20'-0"

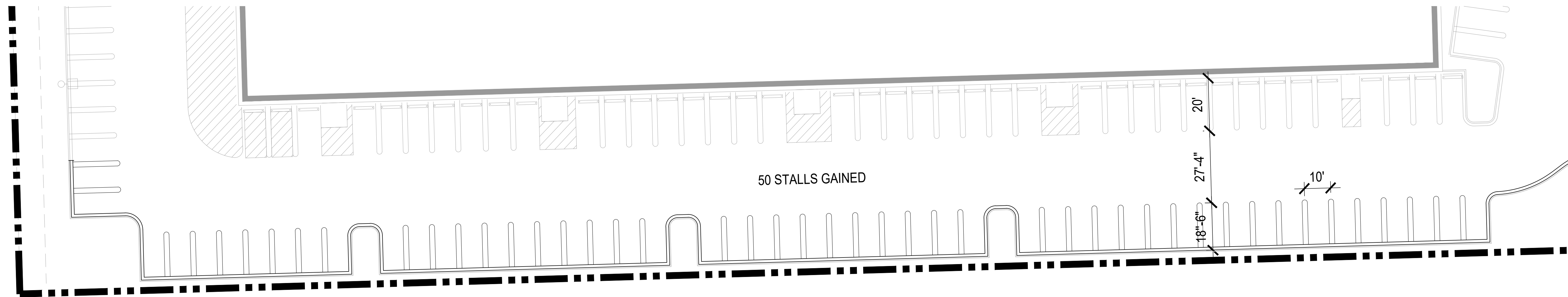

2

## SOUTH PARKING PLAN

SCALE: 1" = 20'

# COSTCO WHOLESALE

ORLAND PARK , IL

# ENLARGED SITE PLAN

JUNE 27 , 2025

**COSTCO**  
**WHOLESALE**

ORLAND PARK , IL  
#647

9915 WEST 159TH STREET  
ORLAND PARK , IL 60462

1101 Second Ave, Ste 100  
Seattle, WA 98101  
206 962 6500  
MG2.com

**MG2**

03-1462-12  
JUNE 27, 2025

ENLARGED SITE  
PLAN

DD11-10C

© MG2, Inc. All rights reserved. No part of this document may be reproduced in any form or by any means without permission in writing from MG2.



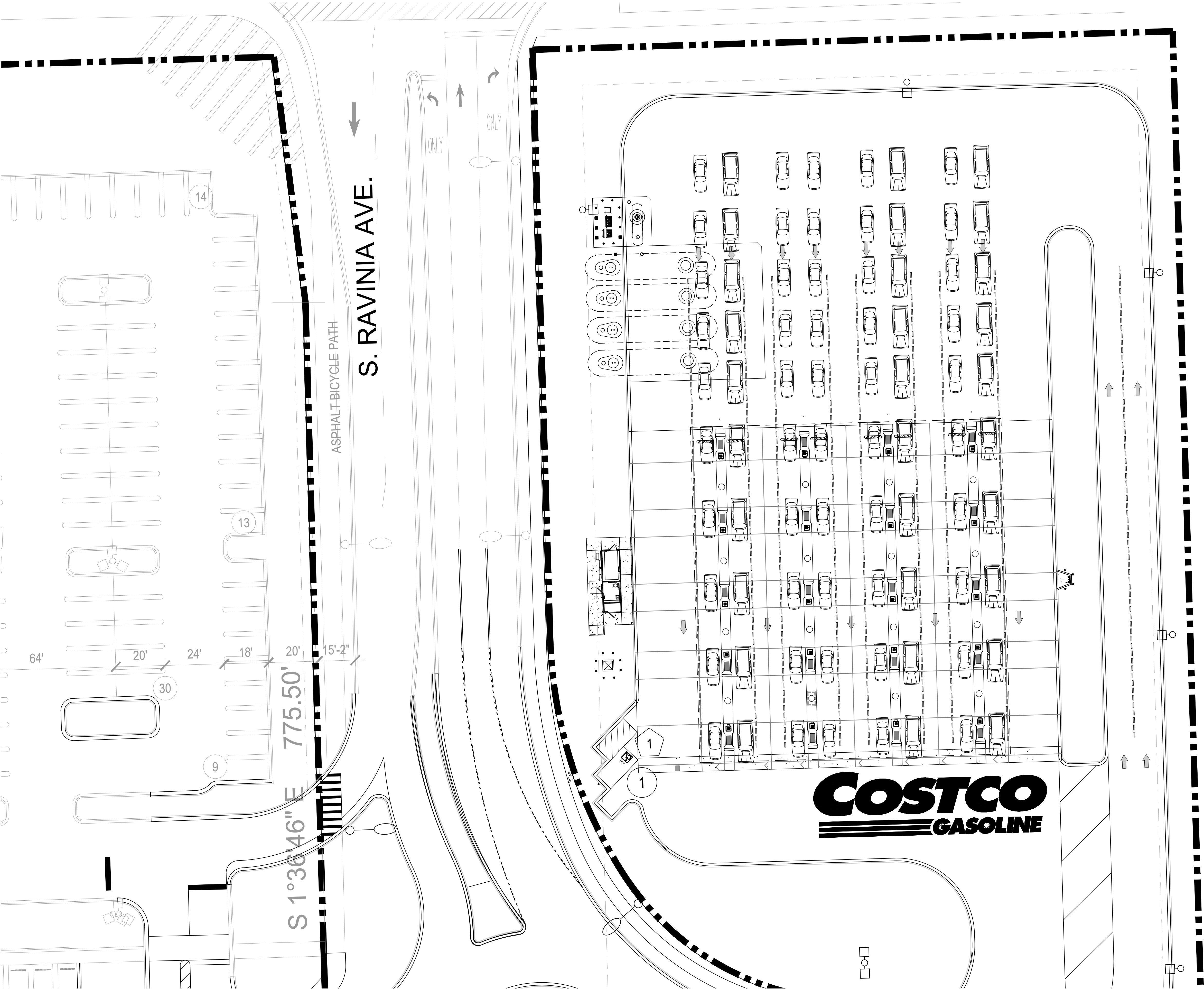

COSTCO WHOLESALE

VEHICLE QUEUING PLAN

ORLAND PARK , IL

JUNE 27 , 2025

REVISED PER  
VILLAGE COMMENTS

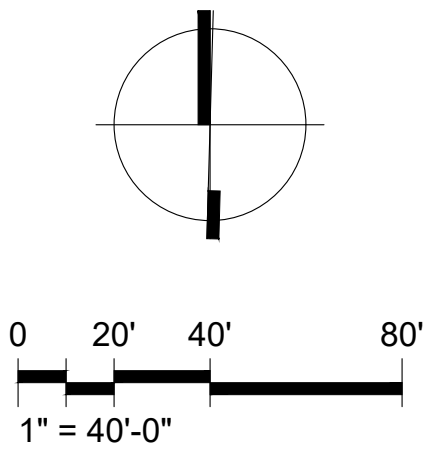

ORLAND PARK , IL  
#647

9915 WEST 158TH STREET  
ORLAND PARK , IL 60462

1101 Second Ave, Ste 100  
Seattle, WA 98101  
206 962 6500  
MG2.com



03-1462-12  
JUNE 27, 2025

VEHICLE QUEUING  
PLAN

DD11-10D

CONCEPTUAL STACKING	
CARS @ DISPENSERS	40
CARS STACKING	40
TOTAL CARS IN AREA	80