

REVISIONS

Issued for permit 5/14/2010
Issued for bid 6/08/2010
Addendum 1 6/18/2010 delta 1
Addendum 2 6/21/2010 delta 2
Addendum 3 6/24/2010 delta 3
Addendum 4 7/1/2010 delta 4
Permit Resubmittal 7/12/10 delta 5
Revised Revision 7/28/10
Village Review 08/12/10
Issued for Construction 8/23/10 delta 7
Village Review 1/19/11 delta 8

ORLAND FIRE PROTECTION DISTRICT
FIRE ADMINISTRATION ADDITION
AND REMODEL

9788 W. 151ST ORLAND PARK, IL 60462

SRBL ARCHITECTS
WWW.SRBLARCHITECTS.COM
1161-A LAKE COOK ROAD
DEERFIELD, ILLINOIS 60015
TEL 847.272.9500
FAX 847.272.9510

LANDSCAPE PLAN
SOUTH

Hitchcock
Design Group
Chicago, Illinois
HDS Project No. 04-074-006-02-0000-08

PROJECT NO.

09120

DATE:

June 9, 2010

DRAWN BY:

PLK

APPROVED:

EFH

SHEET

L1.2

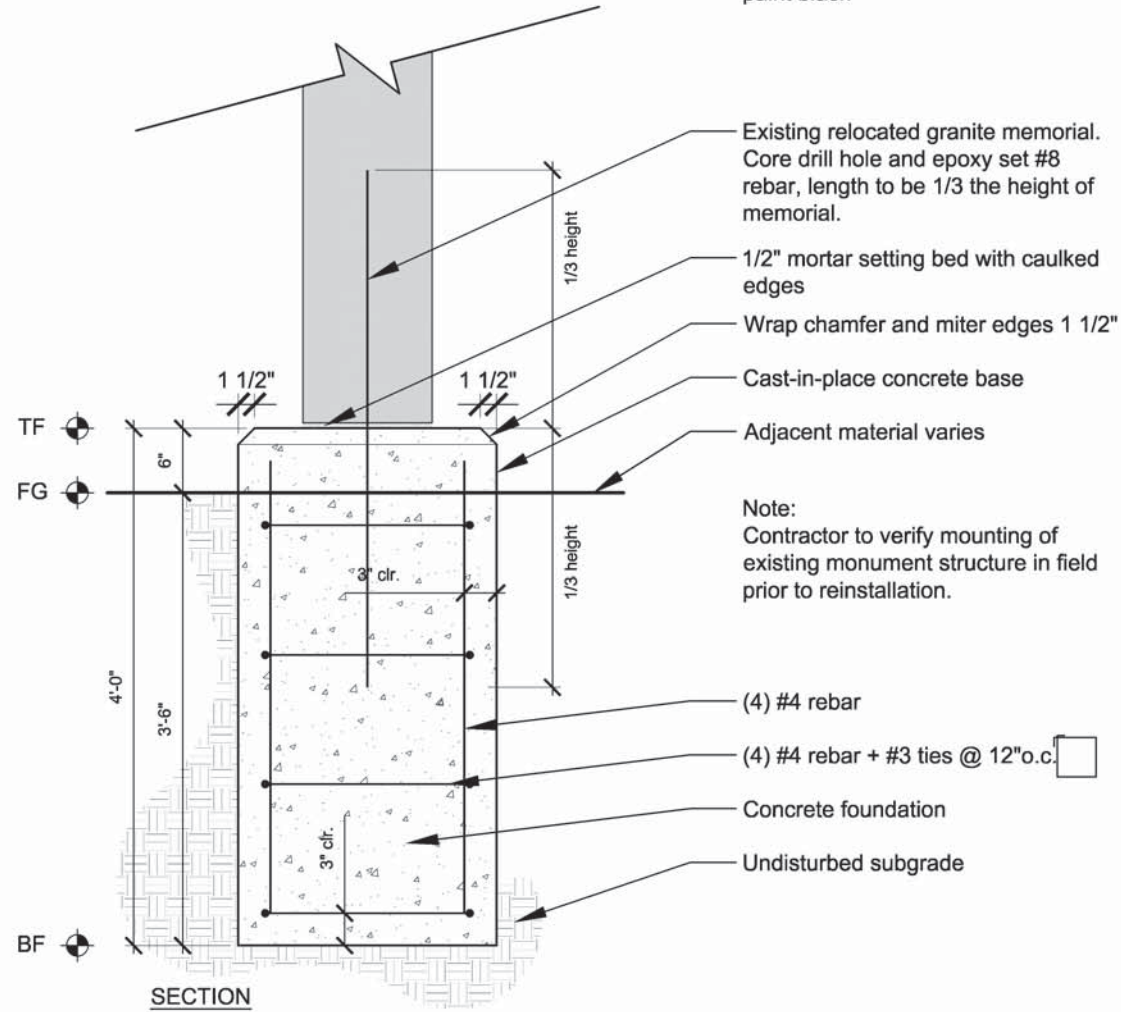
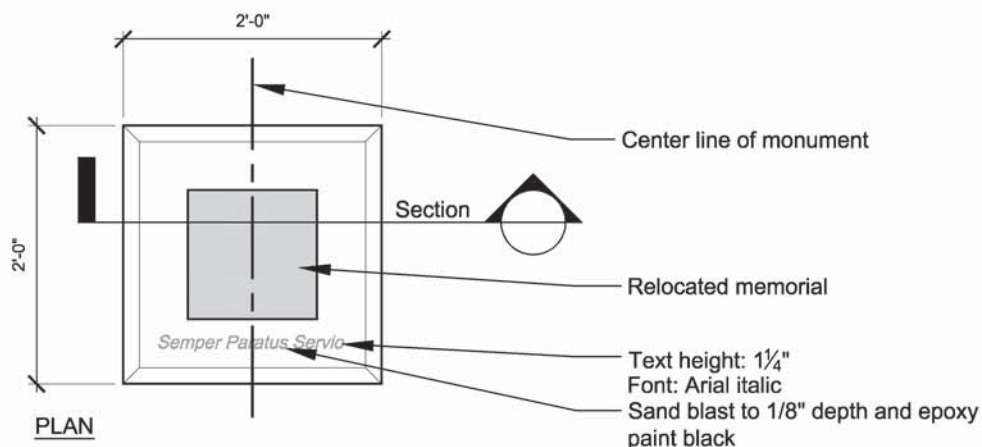

1 Memorial Foundation
Scale: 1" = 1'-0"

2 Detail Not Used

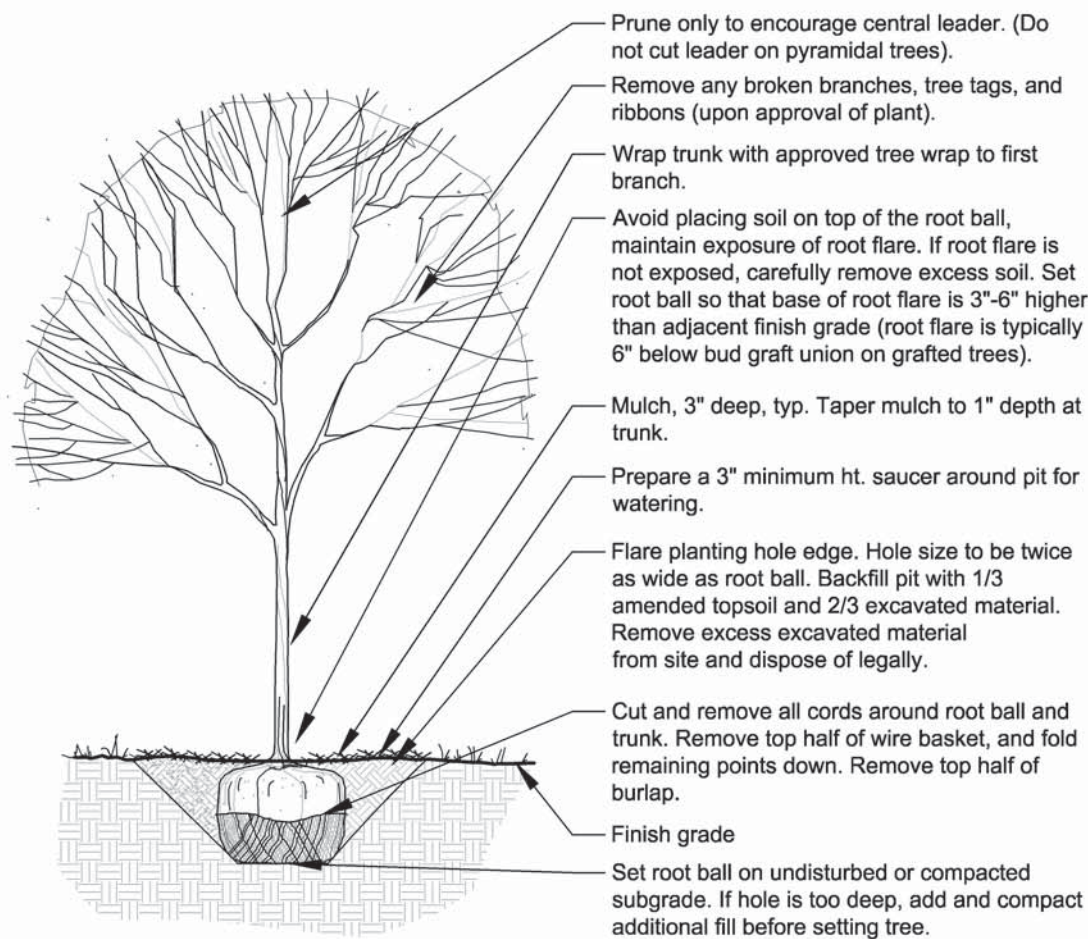

3 Deciduous Tree Planting
Scale: 1/2" = 1'-0"

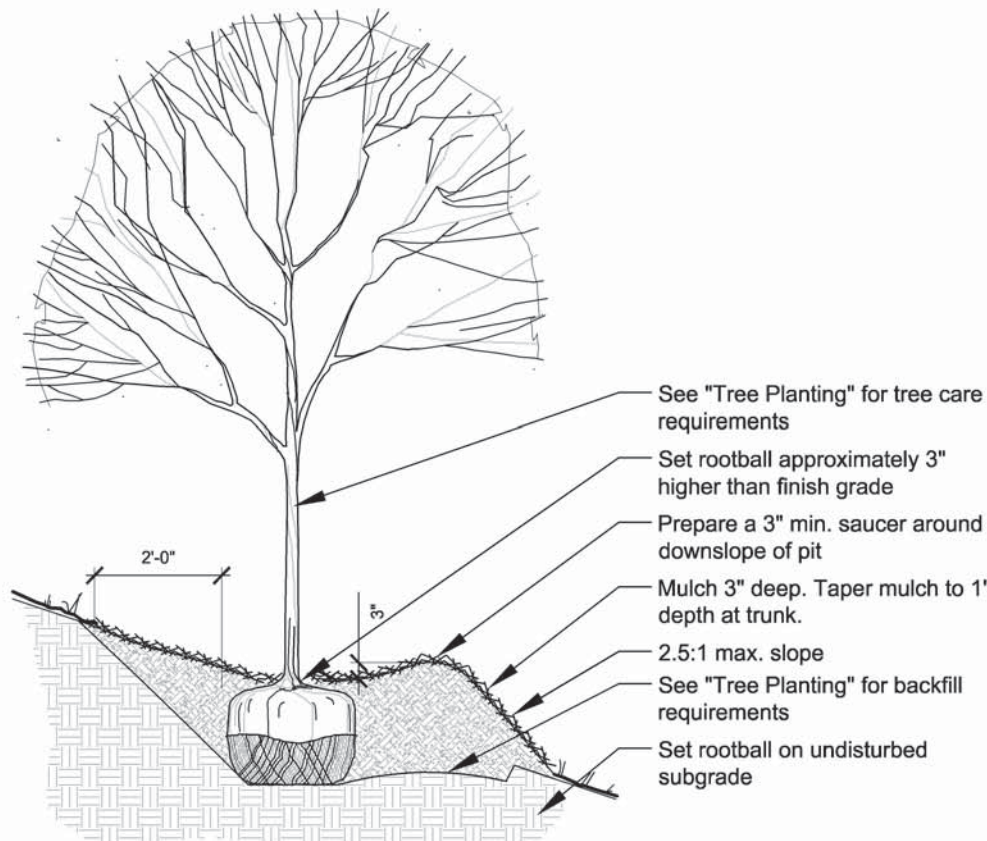

4 Slope Condition Tree Planting
Scale: 1/2" = 1'-0"

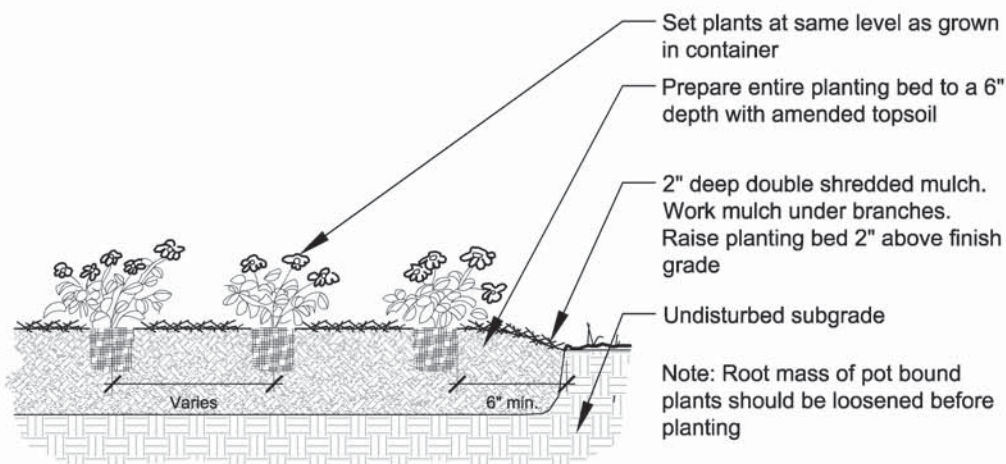

5 Perennial Planting
Scale: 1/2" = 1'-0"

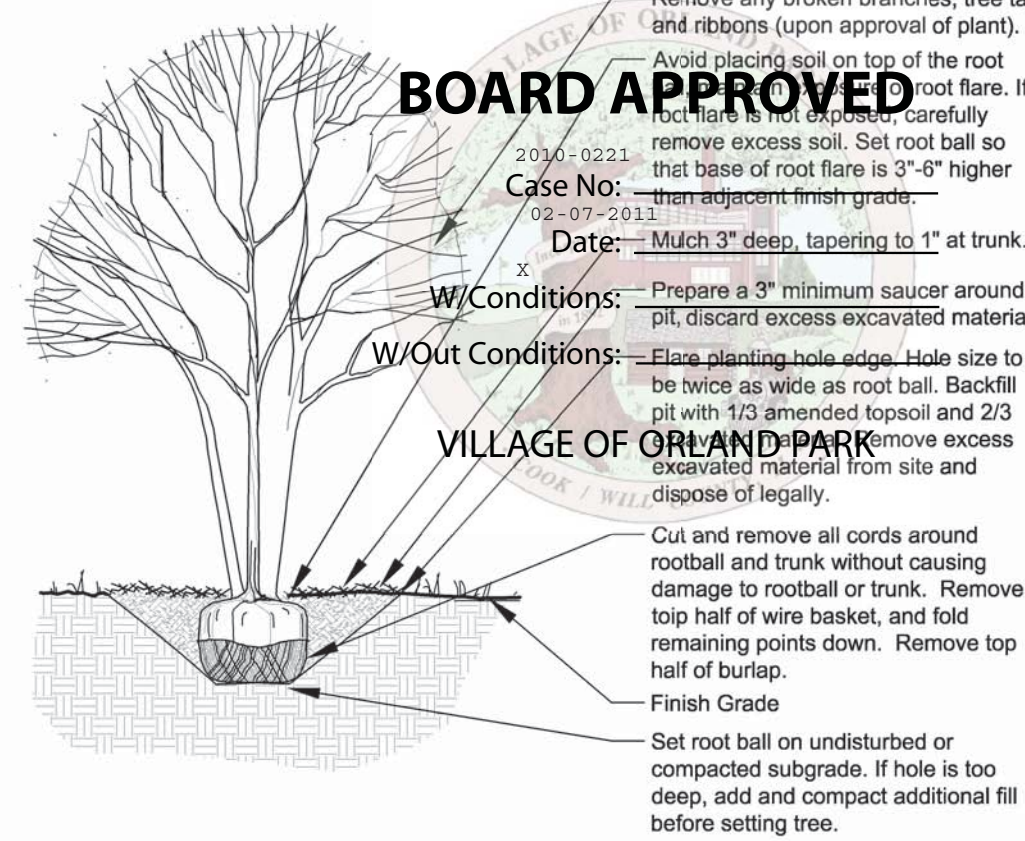

6 Ornamental Tree Planting
Scale: 1/2" = 1'-0"

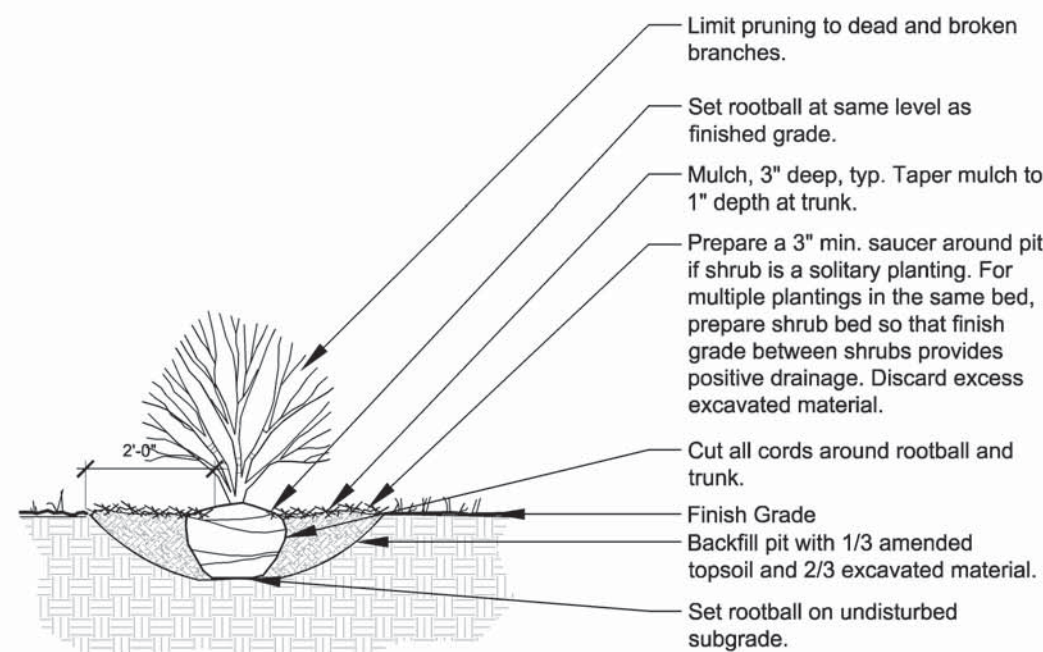

7 Shrub Planting
Scale: 1/2" = 1'-0"

BOARD APPROVED

Case No: 2010-0221
Date: 02-07-2011

W/Conditions:

W/Out Conditions:

VILLAGE OF ORLAND PARK

REVISIONS
Issued for permit 5/14/2010 Issued for bid 6/08/2010 Addendum 1 6/18/2010 delta 1 Addendum 2 6/21/2010 delta 2 Addendum 3 6/24/2010 delta 3 Addendum 4 7/1/2010 delta 4 Permit Resubmittal 7/12/10 delta 5 Bioswale Revision 7/28/10 Village Review 08/12/10 Issued for Construction 8/23/10 delta 7 Village Review 1/19/11 delta 8



ORLAND FIRE PROTECTION DISTRICT
FIRE ADMINISTRATION ADDITION
AND REMODEL

9788 W. 151ST ORLAND PARK, IL 60462

SRBL ARCHITECTS
WWW.SRBLARCHITECTS.COM
TEL 847.272.9500
FAX 847.272.9510
1161-A LAKE COOK ROAD
DEERFIELD, ILLINOIS 60015

SITE AND LANDSCAPE
DETAILS
Hitchcock
Design Group
Creative Better Places®
HGS Project No. 14-0874-006-02-0000-001

PROJECT NO.

09120

DATE: June 9, 2010

DRAWN BY: PLK APPROVED: EFH

SHEET

L2.1