

SHEET NOTES

- FURNISH AND INSTALL ONE (1) TYPE EA FIXTURE ON EXISTING POLE (AT HEIGHT TO MATCH THE EXISTING HEADS) AND CONNECT TO EXISTING WIRING/CIRCUITRY COMPLETE AS REQUIRED. CONTACT THE MANUFACTURER FOR POLE DRILLING PATTERN. VERIFY CONDITIONS AND REQUIREMENTS IN FIELD.
- ALTERNATE E1: FURNISH AND INSTALL ONE (1) TYPE EB FIXTURE MOUNTED ON THE NORTHWEST SIDE OF PRECAST CONCRETE WING WALL. CONNECT COMPLETE AS REQUIRED. VERIFY CONDITIONS AND REQUIREMENTS IN FIELD.
- ALTERNATE E1: PROVIDE ONE (1) NEW 20A, 1-POLE CIRCUIT BREAKER IN EXISTING PANEL 'HL' (OLP) AND ROUTE VIA ONE (1) SPARE POLE OF THE EXISTING INTERMATIC TIMECLOCK (#T1401B - SEVEN-DAY DIAL TIME SWITCH, 4 POLE SINGLE THROW) LOCATED IN THE ELECTRICAL ROOM, ADJACENT TO THE EXISTING PANEL 'HL' (OLP). ROUTE 2 #12 4 1/2" GRID IN 3/4" CONDUIT CONCEALED IN AREAS WITH CEILING AND AS HIGH AS POSSIBLE IN AREAS WITHOUT CEILING AND CONNECT COMPLETE AS REQUIRED. VERIFY CONDITIONS AND REQUIREMENTS IN FIELD.

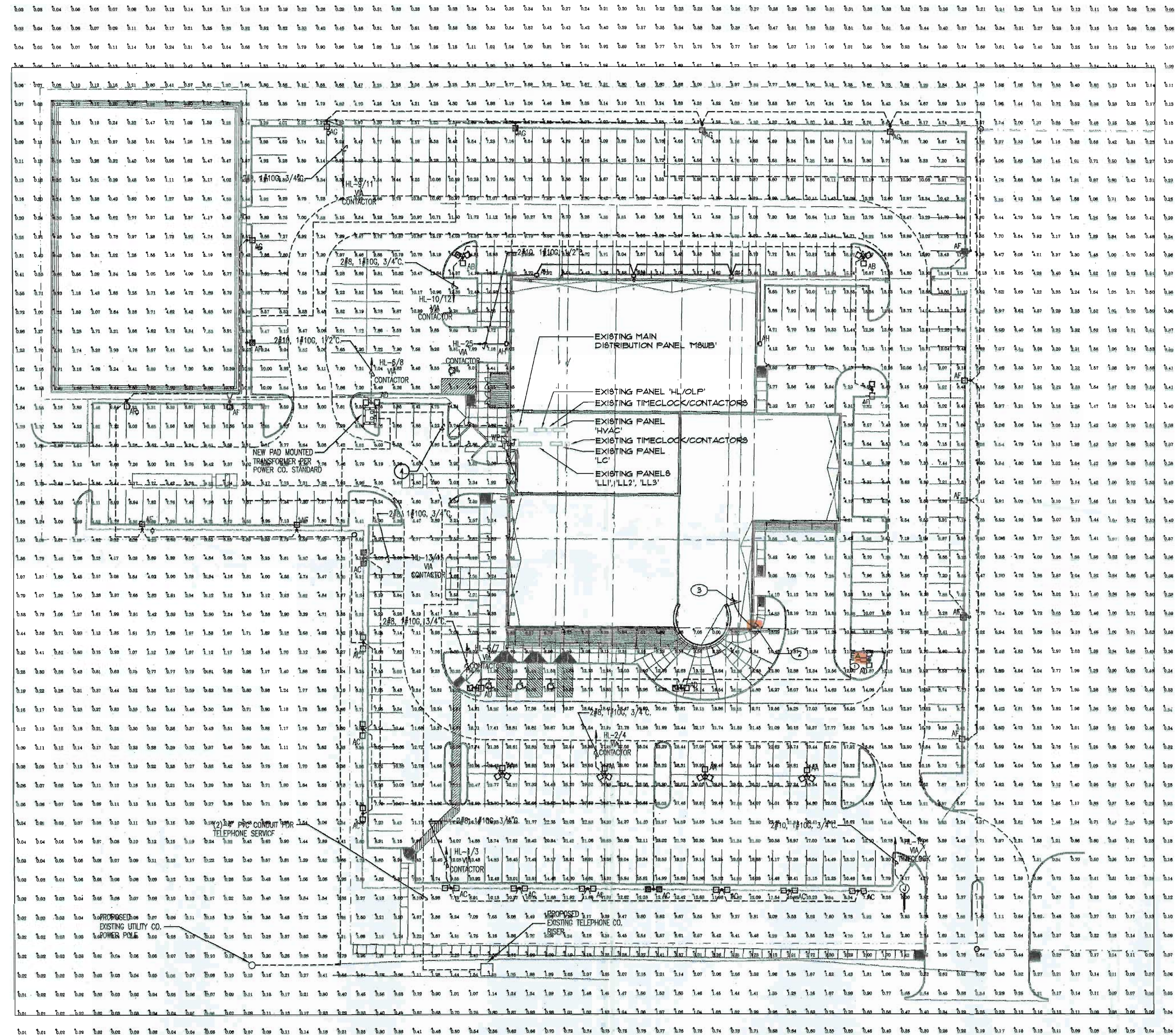

BOARD APPROVED
CASE NO. 2108-0552
DATE 12-1-09
W/CONDITIONS _____
W/O CONDITIONS



- 3
 - 2
 - 1
- REVISIONS

Symbol	Qty	Label	Arrangement	LIF	Description
EA	1	EA	SINGLE	1,000	AFPL23-400MB-ED28
KA	1	KA	SINGLE	1,000	EVE2-400M-ASY-BS
JA	4	JA	2 @ 120 DEGREE	0,000	EVE2-1000M-SYM
AB	2	AB	2 @ 120 DEGREE	0,000	EVE2-1000M-SYMC
AC	11	AC	TWIN	0,400	EVE2-400M-ASY-BS
AD	5	AD	BACK-BACK	0,500	EVE2-400M-SYM
AF	10	AF	SINGLE	0,800	EVE2-1000M-ASY
AG	5	AG	SINGLE	0,800	EVE2-1000M-ASY-BS

EXTERIOR (NEW) LIGHTING LUMINAIRE SCHEDULE

TAG	SYMBOL	DESCRIPTION	MANUFACTURER SERIES OR CATALOG NUMBER	VOLTAGE/BALLAST	LAMPS/CROSS SECTION	MOUNTING	REMARKS
EA	EA	15" SQUARE SHOEBOX STYLE FIXTURE WITH ASYMMETRIC DISTRIBUTION WITH HOUSE SIDE SHIELD	LITHONIA #KVE2-400M-ASY-400-RV26-HS (WITH COLOR SELECTED BY OWNER) MOUNTED ON EXISTING POLE	480 VOLT	ONE (1) 400W MH VERTICAL	ON EXISTING POLE	-
EB	EB	15" HIGH, 20" WIDE FLOOD LIGHT WITH MEDIUM FLOOD DISTRIBUTION WITH FULL SHIELD AND WALL MOUNT TENON	KIM #AF23-400MH211-CCP-F82-UM2 (WITH COLOR SELECTED BY OWNER)	277 VOLT	ONE (1) 400W MH	MOUNTED ON BUILDING	-

SHEET TITLE
**COMPOSITE SITE PLAN
PHOTOMETRIC OF BASE
BID AND ALTERNATE**

r.i. millies & associates, inc.
CONSULTING ENGINEERS
9711 VALPARAISO DRIVE SUITE A
MUNSTER, IN 46321
(219) 924-8400
(708) 474-0104
FAX (219) 924-5092
rim@rimfirm.com

PROJECT
COMMUNITY HONDA
PHASE I SITE LIGHTING IMPROVEMENT
ORLAND PARK, ILLINOIS

SHEET NO.
E1P