



<b>To:</b>	Village of Orland Park	<b>Contact:</b>	Mr. John Ingram
<b>Address:</b>	14700 Ravinia Avenue Orland Park, IL 60462	<b>Phone:</b>	708-403-6104
<b>Project Name:</b>	LFI Swale Connection	<b>Email:</b>	<a href="mailto:jingram@orlandpark.org">jingram@orlandpark.org</a>
<b>Location:</b>	Orland Park, IL 60462	<b>Ref #:</b>	PER17848
		<b>Date:</b>	5/29/2019

V3 Construction Group proposed to execute the following scope of work:

LFI SWALE	QUANTITY	UNIT	UNIT PRICE	TOTAL
<b>1.00 IN-SITU REMEDIATION</b>				
1.10 Mobilization	1.000	LS	\$ 1,500.00	\$ 1,500.00
1.20 Loader	16.000	HR	\$ 220.00	\$ 3,520.00
1.30 Dozer	16.000	LS	\$ 245.00	\$ 3,920.00
1.40 Foreman	16.000	HR	\$ 145.00	\$ 2,320.00
<b>SUBTOTAL - IN-SITU REMEDIATION:</b>				<b>\$ 11,260.00</b>
<b>2.00 RESTORATION</b>				
2.10 Seeding & Erosion Control Blanket	2,360.000	SY	\$ 1.85	\$ 4,366.00
2.20 Silt Log	120.000	LF	\$ 10.00	\$ 1,200.00
2.30 Native Plug Planting	650.000	EA	\$ 4.00	\$ 2,600.00
<b>SUBTOTAL - IN-SITU REMEDIATION:</b>				<b>\$ 8,166.00</b>
				<b>\$ 19,426.00</b>

**Project Notes:**

- All material will remain in the swale area. Grading will be adjusted to accommodate material and generally conform to the grading plan in the attached exhibit.
- No topsoil import is provided for in this proposal. V3 will notify the Village personnel if adequate topsoil is not present on site to support the proposed vegetation establishment.
- The Village of Orland Park personnel will be responsible for the following:
  - Complete adjustment of existing storm manhole on the northern berm along 156th Street.
  - Complete adjustment of existing fire hydrant adjacent to the public works lot and within the slope.
  - Remove and dispose of existing fencing within the grading limits.
  - Provide rip rap for placement by V3 (estimate 4 loads of RR4)
  - Remove and replace existing chain link fencing at the perimeter of the public works property.
- Plug species have not been designed at the time of this proposal. Plug pricing herein anticipates species such as Bull Rush, Pickerel Weed, and Water Lilies.
- No hydrologic study has been performed by V3 on this detention facility and therefore there is no guarantee for performance of the native vegetation.
- Supplemental plug installation may be necessary in order to achieve a native plant density capable of competing with invasive vegetation. Supplemental plug planting should be included in future maintenance contract.
- Proposal assumes the absence of any invasive plant species present before installation. These would need to be removed prior to the installation and is not included in this proposal.

**Payment & Contract Notes:**

- Net payment is due upon receipt of invoice.
- Invoices unpaid after thirty (30) days will incur a finance charge of three percent (3.0%) per month.
- This proposal is valid for 30 days from the date of estimate above.
- This proposal excludes: bonds, permits, and special insurance (e.g. waiver of subrogation, railroad protective liability etc.)
- Final payment, including any retained monies, is due immediately upon satisfactory completion of the work and receipt by purchaser of the final invoice.
- Purchaser warrants that he/she has the authority to make this agreement.
- This contract is limited to the work identified. Any additional work will be agreed to by change order and made a part of this agreement.
- This contract shall be interpreted under the laws of the State of Illinois.

<b>ACCEPTED:</b> <i>The above prices, specifications and conditions are satisfactory and hereby accepted.</i>	<b>CONFIRMED:</b> <i>The above prices, specifications and conditions are satisfactory and hereby confirmed.</i>
<b>Purchaser:</b> <u>Village of Orland Park</u>	<b>Seller:</b> <u>V3 Construction Group, Ltd.</u>
<b>Signature</b> _____	<b>Signature:</b> 
<b>Printed Name:</b> _____	<b>Printed Name:</b> <u>Michael Famiglietti</u>
<b>Date:</b> _____	<b>Date:</b> <u>5/29/2019</u>



**"The Professional Approach to Ecology"**

<b>To:</b> Village of Orland Park <b>Address:</b> 14700 Ravinia Avenue Orland Park, IL	<b>Contact:</b> Brad Millis <b>Phone:</b> 630-512-1137 <b>Email:</b> <a href="mailto:bmillis@v3co.com">bmillis@v3co.com</a>
<b>Project Name:</b> LFI Management 2019-2021 <b>Project Address:</b> 156th & LaGrange Road Orland Park, IL	<b>Ref #:</b> PER17877 <b>Exhibit:</b> V3 Exhibit_LFI Management 2019-2021 <b>Date:</b> 6/26/2019

V3 Companies proposes to perform the following work:

Item	Item Description	Quantity	Unit	Unit Price	Total Price
<b>2019</b>					
1.0	Weed Control	3	EA	\$ 1,150.00	\$ 3,450.00
<b>Sub Total 2019:</b>					<b>\$ 3,450.00</b>
<b>2020</b>					
2.0	Supplemental Plug Planting	1500	EA	\$ 4.39	\$ 6,585.00
3.0	Supplemental Seeding	1	EA	\$ 3,200.00	\$ 3,200.00
4.0	Weed Control	5	EA	\$ 1,200.00	\$ 6,000.00
<b>Sub Total 2020:</b>					<b>\$ 15,785.00</b>
<b>2021</b>					
5.0	Weed Control	5	EA	\$ 1,250.00	\$ 6,250.00
<b>Sub Total 2021:</b>					<b>\$ 6,250.00</b>
<b>Total:</b>					<b>\$ 25,485.00</b>

**Project Notes:**

- 1.0 Weed control proposed for the project area depicted on the attached exhibit is for the control of common invasive weed species.

**Contract Terms & Conditions**

- 1.0 This proposal constitutes the entire agreement between the purchaser and V3 Companies of Illinois, Ltd.
- 2.0 Net payment is due upon receipt of invoice.
- 3.0 Final payment, including any retained monies, is due immediately upon satisfactory completion of the work and receipt by purchaser of the final invoice.
- 4.0 Invoices unpaid after thirty (30) days will incur a finance charge of three percent (3.0%) per month.
- 5.0 Purchaser warrants that he/she has the authority to make this agreement.
- 6.0 This contract is limited to the work identified. Any additional work will be agreed to by change order and made a part of this agreement.
- 7.0 This contract shall be interpreted under the laws of the State of Illinois.

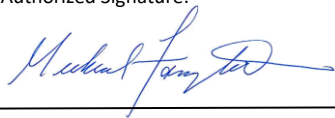
<b>ACCEPTED:</b> The above prices, specifications and conditions are satisfactory and hereby accepted.  <b>Purchaser:</b> _____  <b>Signature</b> _____  <b>Printed Name:</b> _____  <b>Date:</b> _____	<b>CONFIRMED:</b> V3 Companies of Illinois, Ltd.  Authorized Signature:  _____  Printed Name: <u>Michael Famiglietti, P.E.</u>
--	---

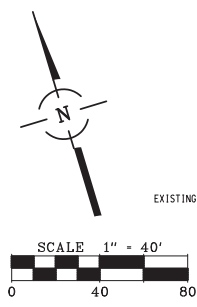

EXISTING RAVINIA  
DETENTION AREA

RAVINIA AVENUE

156TH STREET

NORTH FACILITY

ORLAND PARK  
PUBLIC WORKS FACILITY

F/F=94.50

LEGEND

- BIORETENTION VOLUME CONTROL LIMITS
- OVERLAND FLOW ROUTE
- PROPOSED STORM SEWER
- PROPOSED UNDERDRAIN (SEE MWRD DETAIL) (SEE SHEET UT1 FOR UNDERDRAIN INVERT ELEVATIONS)
- PROPOSED FLARED END SECTION
- PROPOSED STORM STRUCTURE

PETROLEUM IMPACTED SOILS  
PER ETS ENVIRONMENTAL & ASSOCIATES, LLC  
"FIGURE A PETROLEUM IMPACTED SOIL MAP"  
DATED 10/16

**SUMMARY**

VOLUME CONTROL
VOLUME CONTROL REQUIRED = 0.83 AC-FT *
VOLUME CONTROL PROVIDED=
NORTH FACILITY= 0.17 AC-FT
SOUTH FACILITY= 0.67 AC-FT
TOTAL= 0.84 AC-FT

\* FOR LAGRANGE RETAIL DEVELOPMENT SITE (9.92 ACRES) AND FUTURE PUBLIC WORKS (1.90 ACRES)

**NORTH FACILITY**

VOLUME TYPE	PERCENTAGE	MEDIA VOLUME	STORAGE VOLUME	VOLUME PROVIDED	ELEVATION
GRAVEL STORAGE	1.00	1/4	1.00 x 1/4	0.25	886.50-886.50
SOIL MEDIA	0.25	1/4	0.25 x 0.25 x 1/4	0.03	886.50-886.50
ASSUME 1" COARSE AGG. (BELOW INVERT)	0.36	1/4	0.36 x 0.36 x 1/4	0.03	886.50-886.50
ASSUME 1" COARSE AGG. (BELOW INVERT)	0.36	1/4	0.36 x 0.36 x 1/4	0.03	886.50-886.50
TOTAL				0.17	

NOTES:  
1. OFFSET A MINIMUM OF 10 FEET FROM FOUNDATIONS UNLESS WATERPROOFED, 20 FEET FROM SANITARY SEWERS, 20 FEET FROM ROADWAY GRAVEL SHOULDER AND 100 FEET FROM POTABLE WATER WELLS OR SEPTIC TANKS.  
2. WOOD INSTALLATION ON SLOPES GREATER THAN 15 TO 1 AND ABOVE COMPACTED FILL.  
3. WOOD INSTALLATION ON SLOPES GREATER THAN 15 TO 1 AND ABOVE COMPACTED FILL.  
4. STONE STORAGE OPTIONS ARE C-1, D-1, D-2, D-3, D-4, D-5, D-6, D-7, D-8, D-9, D-10, D-11, D-12, D-13, D-14, D-15, D-16, D-17, D-18, D-19, D-20, D-21, D-22, D-23, D-24, D-25, D-26, D-27, D-28, D-29, D-30, D-31, D-32, D-33, D-34, D-35, D-36, D-37, D-38, D-39, D-40, D-41, D-42, D-43, D-44, D-45, D-46, D-47, D-48, D-49, D-50, D-51, D-52, D-53, D-54, D-55, D-56, D-57, D-58, D-59, D-60, D-61, D-62, D-63, D-64, D-65, D-66, D-67, D-68, D-69, D-70, D-71, D-72, D-73, D-74, D-75, D-76, D-77, D-78, D-79, D-80, D-81, D-82, D-83, D-84, D-85, D-86, D-87, D-88, D-89, D-90, D-91, D-92, D-93, D-94, D-95, D-96, D-97, D-98, D-99, D-100, D-101, D-102, D-103, D-104, D-105, D-106, D-107, D-108, D-109, D-110, D-111, D-112, D-113, D-114, D-115, D-116, D-117, D-118, D-119, D-120, D-121, D-122, D-123, D-124, D-125, D-126, D-127, D-128, D-129, D-130, D-131, D-132, D-133, D-134, D-135, D-136, D-137, D-138, D-139, D-140, D-141, D-142, D-143, D-144, D-145, D-146, D-147, D-148, D-149, D-150, D-151, D-152, D-153, D-154, D-155, D-156, D-157, D-158, D-159, D-160, D-161, D-162, D-163, D-164, D-165, D-166, D-167, D-168, D-169, D-170, D-171, D-172, D-173, D-174, D-175, D-176, D-177, D-178, D-179, D-180, D-181, D-182, D-183, D-184, D-185, D-186, D-187, D-188, D-189, D-190, D-191, D-192, D-193, D-194, D-195, D-196, D-197, D-198, D-199, D-200, D-201, D-202, D-203, D-204, D-205, D-206, D-207, D-208, D-209, D-210, D-211, D-212, D-213, D-214, D-215, D-216, D-217, D-218, D-219, D-220, D-221, D-222, D-223, D-224, D-225, D-226, D-227, D-228, D-229, D-230, D-231, D-232, D-233, D-234, D-235, D-236, D-237, D-238, D-239, D-240, D-241, D-242, D-243, D-244, D-245, D-246, D-247, D-248, D-249, D-250, D-251, D-252, D-253, D-254, D-255, D-256, D-257, D-258, D-259, D-260, D-261, D-262, D-263, D-264, D-265, D-266, D-267, D-268, D-269, D-270, D-271, D-272, D-273, D-274, D-275, D-276, D-277, D-278, D-279, D-280, D-281, D-282, D-283, D-284, D-285, D-286, D-287, D-288, D-289, D-290, D-291, D-292, D-293, D-294, D-295, D-296, D-297, D-298, D-299, D-300, D-301, D-302, D-303, D-304, D-305, D-306, D-307, D-308, D-309, D-310, D-311, D-312, D-313, D-314, D-315, D-316, D-317, D-318, D-319, D-320, D-321, D-322, D-323, D-324, D-325, D-326, D-327, D-328, D-329, D-330, D-331, D-332, D-333, D-334, D-335, D-336, D-337, D-338, D-339, D-340, D-341, D-342, D-343, D-344, D-345, D-346, D-347, D-348, D-349, D-350, D-351, D-352, D-353, D-354, D-355, D-356, D-357, D-358, D-359, D-360, D-361, D-362, D-363, D-364, D-365, D-366, D-367, D-368, D-369, D-370, D-371, D-372, D-373, D-374, D-375, D-376, D-377, D-378, D-379, D-380, D-381, D-382, D-383, D-384, D-385, D-386, D-387, D-388, D-389, D-390, D-391, D-392, D-393, D-394, D-395, D-396, D-397, D-398, D-399, D-400, D-401, D-402, D-403, D-404, D-405, D-406, D-407, D-408, D-409, D-410, D-411, D-412, D-413, D-414, D-415, D-416, D-417, D-418, D-419, D-420, D-421, D-422, D-423, D-424, D-425, D-426, D-427, D-428, D-429, D-430, D-431, D-432, D-433, D-434, D-435, D-436, D-437, D-438, D-439, D-440, D-441, D-442, D-443, D-444, D-445, D-446, D-447, D-448, D-449, D-450, D-451, D-452, D-453, D-454, D-455, D-456, D-457, D-458, D-459, D-460, D-461, D-462, D-463, D-464, D-465, D-466, D-467, D-468, D-469, D-470, D-471, D-472, D-473, D-474, D-475, D-476, D-477, D-478, D-479, D-480, D-481, D-482, D-483, D-484, D-485, D-486, D-487, D-488, D-489, D-490, D-491, D-492, D-493, D-494, D-495, D-496, D-497, D-498, D-499, D-500, D-501, D-502, D-503, D-504, D-505, D-506, D-507, D-508, D-509, D-510, D-511, D-512, D-513, D-514, D-515, D-516, D-517, D-518, D-519, D-520, D-521, D-522, D-523, D-524, D-525, D-526, D-527, D-528, D-529, D-530, D-531, D-532, D-533, D-534, D-535, D-536, D-537, D-538, D-539, D-540, D-541, D-542, D-543, D-544, D-545, D-546, D-547, D-548, D-549, D-550, D-551, D-552, D-553, D-554, D-555, D-556, D-557, D-558, D-559, D-560, D-561, D-562, D-563, D-564, D-565, D-566, D-567, D-568, D-569, D-570, D-571, D-572, D-573, D-574, D-575, D-576, D-577, D-578, D-579, D-580, D-581, D-582, D-583, D-584, D-585, D-586, D-587, D-588, D-589, D-590, D-591, D-592, D-593, D-594, D-595, D-596, D-597, D-598, D-599, D-600, D-601, D-602, D-603, D-604, D-605, D-606, D-607, D-608, D-609, D-610, D-611, D-612, D-613, D-614, D-615, D-616, D-617, D-618, D-619, D-620, D-621, D-622, D-623, D-624, D-625, D-626, D-627, D-628, D-629, D-630, D-631, D-632, D-633, D-634, D-635, D-636, D-637, D-638, D-639, D-640, D-641, D-642, D-643, D-644, D-645, D-646, D-647, D-648, D-649, D-650, D-651, D-652, D-653, D-654, D-655, D-656, D-657, D-658, D-659, D-660, D-661, D-662, D-663, D-664, D-665, D-666, D-667, D-668, D-669, D-670, D-671, D-672, D-673, D-674, D-675, D-676, D-677, D-678, D-679, D-680, D-681, D-682, D-683, D-684, D-685, D-686, D-687, D-688, D-689, D-690, D-691, D-692, D-693, D-694, D-695, D-696, D-697, D-698, D-699, D-700, D-701, D-702, D-703, D-704, D-705, D-706, D-707, D-708, D-709, D-710, D-711, D-712, D-713, D-714, D-715, D-716, D-717, D-718, D-719, D-720, D-721, D-722, D-723, D-724, D-725, D-726, D-727, D-728, D-729, D-730, D-731, D-732, D-733, D-734, D-735, D-736, D-737, D-738, D-739, D-740, D-741, D-742, D-743, D-744, D-745, D-746, D-747, D-748, D-749, D-750, D-751, D-752, D-753, D-754, D-755, D-756, D-757, D-758, D-759, D-760, D-761, D-762, D-763, D-764, D-765, D-766, D-767, D-768, D-769, D-770, D-771, D-772, D-773, D-774, D-775, D-776, D-777, D-778, D-779, D-780, D-781, D-782, D-783, D-784, D-785, D-786, D-787, D-788, D-789, D-790, D-791, D-792, D-793, D-794, D-795, D-796, D-797, D-798, D-799, D-800, D-801, D-802, D-803, D-804, D-805, D-806, D-807, D-808, D-809, D-810, D-811, D-812, D-813, D-814, D-815, D-816, D-817, D-818, D-819, D-820, D-821, D-822, D-823, D-824, D-825, D-826, D-827, D-828, D-829, D-830, D-831, D-832, D-833, D-834, D-835, D-836, D-837, D-838, D-839, D-840, D-841, D-842, D-843, D-844, D-845, D-846, D-847, D-848, D-849, D-850, D-851, D-852, D-853, D-854, D-855, D-856, D-857, D-858, D-859, D-860, D-861, D-862, D-863, D-864, D-865, D-866, D-867, D-868, D-869, D-870, D-871, D-872, D-873, D-874, D-875, D-876, D-877, D-878, D-879, D-880, D-881, D-882, D-883, D-884, D-885, D-886, D-887, D-888, D-889, D-890, D-891, D-892, D-893, D-894, D-895, D-896, D-897, D-898, D-899, D-900, D-901, D-902, D-903, D-904, D-905, D-906, D-907, D-908, D-909, D-910, D-911, D-912, D-913, D-914, D-915, D-916, D-917, D-918, D-919, D-920, D-921, D-922, D-923, D-924, D-925, D-926, D-927, D-928, D-929, D-930, D-931, D-932, D-933, D-934, D-935, D-936, D-937, D-938, D-939, D-940, D-941, D-942, D-943, D-944, D-945, D-946, D-947, D-948, D-949, D-950, D-951, D-952, D-953, D-954, D-955, D-956, D-957, D-958, D-959, D-960, D-961, D-962, D-963, D-964, D-965, D-966, D-967, D-968, D-969, D-970, D-971, D-972, D-973, D-974, D-975, D-976, D-977, D-978, D-979, D-980, D-981, D-982, D-983, D-984, D-985, D-986, D-987, D-988, D-989, D-990, D-991, D-992, D-993, D-994, D-995, D-996, D-997, D-998, D-999, D-1000, D-1001, D-1002, D-1003, D-1004, D-1005, D-1006, D-1007, D-1008, D-1009, D-1010, D-1011, D-1012, D-1013, D-1014, D-1015, D-1016, D-1017, D-1018, D-1019, D-1020, D-1021, D-1022, D-1023, D-1024, D-1025, D-1026, D-1027, D-1028, D-1029, D-1030, D-1031, D-1032, D-1033, D-1034, D-1035, D-1036, D-1037, D-1038, D-1039, D-1040, D-1041, D-1042, D-1043, D-1044, D-1045, D-1046, D-1047, D-1048, D-1049, D-1050, D-1051, D-1052, D-1053, D-1054, D-1055, D-1056, D-1057, D-1058, D-1059, D-1060, D-1061, D-1062, D-1063, D-1064, D-1065, D-1066, D-1067, D-1068, D-1069, D-1070, D-1071, D-1072, D-1073, D-1074, D-1075, D-1076, D-1077, D-1078, D-1079, D-1080, D-1081, D-1082, D-1083, D-1084, D-1085, D-1086, D-1087, D-1088, D-1089, D-1090, D-1091, D-1092, D-1093, D-1094, D-1095, D-1096, D-1097, D-1098, D-1099, D-1100, D-1101, D-1102, D-1103, D-1104, D-1105, D-1106, D-1107, D-1108, D-1109, D-1110, D-1111, D-1112, D-1113, D-1114, D-1115, D-1116, D-1117, D-1118, D-1119, D-1120, D-1121, D-1122, D-1123, D-1124, D-1125, D-1126, D-1127, D-1128, D-1129, D-1130, D-1131, D-1132, D-1133, D-1134, D-1135, D-1136, D-1137, D-1138, D-1139, D-1140, D-1141, D-1142, D-1143, D-1144, D-1145, D-1146, D-1147, D-1148, D-1149, D-1150, D-1151, D-1152, D-1153, D-1154, D-1155, D-1156, D-1157, D-1158, D-1159, D-1160, D-1161, D-1162, D-1163, D-1164, D-1165, D-1166, D-1167, D-1168, D-1169, D-1170, D-1171, D-1172, D-1173, D-1174, D-1175, D-1176, D-1177, D-1178, D-1179, D-1180, D-1181, D-1182, D-1183, D-1184, D-1185, D-1186, D-1187, D-1188, D-1189, D-1190, D-1191, D-1192, D-1193, D-1194, D-1195, D-1196, D-1197, D-1198, D-1199, D-1200, D-1201, D-1202, D-1203, D-1204, D-1205, D-1206, D-1207, D-1208, D-1209, D-1210, D-1211, D-1212, D-1213, D-1214, D-1215, D-1216, D-1217, D-1218, D-1219, D-1220, D-1221, D-1222, D-1223, D-1224, D-1225, D-1226, D-1227, D-1228, D-1229, D-1230, D-1231, D-1232, D-1233, D-1234, D-1235, D-1236, D-1237, D-1238, D-1239, D-1240, D-1241, D-1242, D-1243, D-1244, D-1245, D-1246, D-1247, D-1248, D-1249, D-1250, D-1251, D-1252, D-1253, D-1254, D-1255, D-1256, D-1257, D-1258, D-1259, D-1260, D-1261, D-1262, D-1263, D-1264, D-1265, D-1266, D-1267, D-1268, D-1269, D-1270, D-1271, D-1272, D-1273, D-1274, D-1275, D-1276, D-1277, D-1278, D-1279, D-1280, D-1281, D-1282, D-1283, D-1284, D-1285, D-1286, D-1287, D-1288, D-1289, D-1290, D-1291, D-1292, D-1293, D-1294, D-1295, D-1296, D-1297, D-1298, D-1299, D-1300, D-1301, D-1302, D-1303, D-1304, D-1305, D-1306, D-1307, D-1308, D-1309, D-1310, D-1311, D-1312, D-1313, D-1314, D-1315, D-1316, D-1317, D-1318, D-1319, D-1320, D-1321, D-1322, D-1323, D-1324, D-1325, D-1326, D-1327, D-1328, D-1329, D-1330, D-1331, D-1332, D-1333, D-1334, D-1335, D-1336, D-1337, D-1338, D-1339, D-1340, D-1341, D-1342, D-1343, D-1344, D-1345, D-1346, D-1347, D-1348, D-1349, D-1350, D-1351, D-1352, D-1353, D-1354, D-1355, D-1356, D-1357, D-1358, D-1359, D-1360, D-1361, D-1362, D-1363, D-1364, D-1365, D-1366, D-1367, D-1368, D-1369, D-1370, D-1371, D-1372, D-1373, D-1374, D-1375, D-1376, D-1377, D-1378, D-1379, D-1380, D-1381, D-1382, D-1383, D-1384, D-1385, D-1386, D-1387, D-1388, D-1389, D-1390, D-1391, D-1392, D-1393, D-1394, D-1395, D-1396, D-1397, D-1398, D-1399, D-1400, D-1401, D-1402, D-1403, D-1404, D-1405, D-1406, D-1407, D-1408, D-1409, D-1410, D-1411, D-1412, D-1413, D-1414, D-1415, D-1416, D-1417, D-1418, D-1419, D-1420, D-1421, D-1422, D-1423, D-1424, D-1425, D-1426, D-1427, D-1428, D-1429, D-1430, D-1431, D-1432, D-1433, D-1434, D-1435, D-1436, D-1437, D-1438, D-1439, D-1440, D-1441, D-1442, D-1443, D-1444, D-1445, D-1446, D-1447, D-1448, D-1449, D-1450, D-1451, D-1452, D-1453, D-1454, D-1455, D-1456, D-1457, D-1458, D-1459, D-1460, D-1461, D-1462, D-1463, D-1464, D-1465, D-1466, D-1467, D-1468, D-1469, D-1470, D-1471, D-1472, D-1473, D-1474, D-1475, D-1476, D-1477, D-1478, D-1479, D-1480, D-1481, D-1482, D-1483, D-1484, D-1485, D-1486, D-1487, D-1488, D-1489, D-1490, D-1491, D-1492, D-1493, D-1494, D-1495, D-1496, D-1497, D-1498, D-1499, D-1500, D-1501, D-1502, D-1503, D-1504, D-1505, D-1506, D-1507, D-1508, D-1509, D-1510, D-1511, D-1512, D-1513, D-1514, D-1515, D-1516, D-1517, D-1518, D-1519, D-1520, D-1521, D-1522, D-1523, D-1524, D-1525, D-1526, D-1527, D-1528, D-1529, D-1530, D-1531, D-1532, D-1533, D-1534, D-1535, D-1536, D-1537, D-1538, D-1539, D-1540, D-1541, D-1542, D-1543, D-1544, D-1545, D-1546, D-1547, D-1548, D-1549, D-1550, D-1551, D-1552, D-1553, D-1554, D-1555, D-1556, D-1557, D-1558, D-1559, D-1560, D-1561, D-1562, D-1563, D-1564, D-1565, D-1566, D-1567, D-1568, D-1569, D-1570, D-1571, D-1572, D-1573, D-1574, D-1575, D-1576, D-1577, D-1578, D-1579, D-1580, D-1581, D-1582, D-1583, D-1584, D-1585, D-1586, D-1587, D-1588, D-1589, D-1590, D-1591, D-1592, D-1593, D-1594, D-1595, D-1596, D-1597, D-1598, D-1599, D-1600, D-1601, D-1602, D-1603, D-1604, D-1605, D-1606, D-1607, D-1608, D-1609, D-1610, D-1611, D-1612, D-1613, D-1614, D-1615, D-1616, D-1617, D-1618, D-1619, D-1620, D-1621, D-1622, D-1623, D-1624, D-1625, D-1626, D-1627, D-1628, D-1629, D-1630, D-1631, D-1632, D-1633, D-1634, D-1635, D-1636, D-1637, D-1638, D-1639, D-1640, D-1641, D-1642, D-1643, D-1644, D-1645, D-1646, D-1647, D-1648, D-1649, D-1650, D-1651, D-1652, D-1653, D-1654, D-1655, D-1656, D-1657, D-1658, D-1659, D-1660, D-1661, D-1662, D-1663, D-1664, D-1665, D-1666, D-1667, D-1668, D-1669, D-1670, D-1671, D-1672, D-1673, D-1674, D-1675, D-1676, D-1677, D-1678, D-1679, D-1680, D-1681, D-1682, D-1683, D-1684, D-1685, D-1686, D-1687, D-1688, D-1689, D-1690, D-1691, D-1692, D-1693, D-1694, D-1695, D-1696, D-1697, D-1698



## **V3 COMPANIES GENERAL TERMS AND CONDITIONS**

### **1. CLIENT'S RESPONSIBILITIES**

CLIENT shall do the following in a timely manner so as not to delay the services of CONSULTANT.

- a. Provide all criteria and full information as to CLIENT's requirements for the Project, including design objectives and constraints, borings, probings and subsurface explorations, hydrographic surveys, laboratory tests, environmental assessment and impact statements, property, boundary, easement, right-of-way, topographic and utility surveys, property and legal descriptions, zoning, deed and other land use restrictions; all of which CONSULTANT may use and rely upon in performing services under this Agreement.
- b. Arrange for access to and make all provisions for CONSULTANT to enter upon public and private property as required for CONSULTANT to perform services under this Agreement.
- c. Give prompt written notice to CONSULTANT whenever CLIENT observes or otherwise becomes aware of any development that affects the scope or timing of CONSULTANT's services, or any defect or non-conformance in the work of any Contractor.

### **2. CONSULTANT'S RESPONSIBILITIES**

CONSULTANT will render engineering services in accordance with generally accepted and currently recognized engineering practices and principles. CONSULTANT makes no warranty, either expressed or implied, with respect to its services.

- a. Notwithstanding anything to the contrary which may be contained in this Agreement or any other material incorporated herein by reference, or in any Agreement between the CLIENT and any other party concerning the Project, the CONSULTANT shall not have control or be in charge of and shall not be responsible for the means, methods, techniques, sequences or procedures of construction, or the safety, safety precautions or programs of the CLIENT, the construction contractor, other contractors or subcontractors, other than its own activities or own subcontractors in the performance of the work described in this agreement. Nor shall the CONSULTANT be responsible for the acts or omissions of the CLIENT, or for the failure of the CLIENT, any architect, engineer, consultant, contractor or subcontractor to carry out their respective responsibilities in accordance with the Project documents, this Agreement or any other agreement concerning the Project. Any provision which purports to amend this provision shall be without effect unless it contains a reference that the content of this condition is expressly amended for the purposes described in such amendment and is signed by the CONSULTANT.
- b. CLIENT reserves the right by written change order or amendment to make changes in requirements, amount of work, or engineering time schedule adjustments, and CONSULTANT and CLIENT shall negotiate appropriate adjustments acceptable to both parties to accommodate any changes.
- c. The CONSULTANT will be responsible for correctly laying out the design data shown on the contract documents where construction staking services are a part of this Agreement. The CONSULTANT is not responsible for, and CLIENT agrees herewith to hold CONSULTANT harmless from any and all errors which may be contained within the Contract Documents. It is expressly understood that the uncovering of errors in the plans and specifications is not the responsibility of the CONSULTANT and any and all costs associated with such errors shall be borne by others.

### **3. TERMS OF PAYMENT**

CONSULTANT shall submit monthly statements for Basic and Additional Services rendered and for Reimbursable Expenses incurred, based upon CONSULTANT's estimate of the proportion of the total services actually completed at the time of billing or based upon actual hours expended during the billing period. CLIENT shall make prompt monthly payments in response to CONSULTANT's monthly statements.

If CLIENT fails to make any payment due CONSULTANT for services and expenses within thirty (30) days after receipt of CONSULTANT's statement therefore, the past amounts due CONSULTANT will be increased at the rate of 1.5% per month from said thirtieth day. CONSULTANT may after giving seven days written notice to CLIENT, suspend services under this Agreement until CONSULTANT has been paid in full all amounts due for services, expenses and charges. CONSULTANT shall have no liability whatsoever to CLIENT for any costs or damages as a result of such suspension.

### **4. SUSPENSION OF SERVICES**

CLIENT may, at any time, by written order to CONSULTANT require CONSULTANT to stop all, or any part, of the services required by this Agreement. Upon receipt of such an order CONSULTANT shall immediately comply with its terms and take all reasonable steps to minimize the occurrence of costs allocable to the services covered by the order. CLIENT, however, shall pay all costs associated with the suspension.

### **5. TERMINATION**

This Agreement may be terminated by either party upon fourteen (14) days written notice in the event of substantial failure by the other party to perform in accordance with the terms hereof through no fault of the terminating party. This Agreement may be terminated by CLIENT, under the same terms, whenever CLIENT shall determine that termination is in its best interests. Cost of termination, including salaries, overhead and fee, incurred by CONSULTANT either before or after the termination date shall be reimbursed by CLIENT.

### **6. ATTORNEY'S FEES**

In the event of any dispute that leads to litigation arising from or related to the services provided under this agreement, the prevailing party will be entitled to recovery of all reasonable costs incurred, including staff time, court costs, attorney's fees and other related expenses.

### **7. REUSE OF DOCUMENTS**

All documents including but not limited to Reports, Drawings and Specifications prepared or furnished by CONSULTANT (and CONSULTANT's independent professional associates and consultants) pursuant to this Agreement are instruments of service in respect of the Project and CONSULTANT shall retain an ownership and property interest therein whether or not the Project is completed. CLIENT may make and retain copies for information and reference in connection with the use and occupancy of the Project by CLIENT and others; however, such documents are not intended or represented to be suitable for reuse by CLIENT or others on extensions of the Project or on any other project. Any reuse without written verification or adaptation by CONSULTANT for the specific purpose intended will be at CLIENT's sole risk and without liability or legal exposure to CONSULTANT, or to CONSULTANT's independent professional associates or consultants, and CLIENT shall indemnify and hold harmless CONSULTANT and CONSULTANT's independent professional associates and consultants from all claims, damages, losses and expenses including reasonable attorney's fees and costs of defense arising out of or resulting therefrom. Any such verification or adaptation will entitle CONSULTANT to further compensation at rates to be agreed upon by CLIENT and CONSULTANT.

## **8. INSURANCE**

Upon CLIENT request the CONSULTANT shall provide the CLIENT with certificates of insurance evidencing all coverages held by the CONSULTANT.

In order that the CLIENT and the CONSULTANT may be fully protected against claims, the CLIENT agrees to secure from all CONTRACTORS and SUBCONTRACTORS working directly or indirectly on the project, prior to the commencement of work of any kind, a separate policy of insurance covering public liability, death and property damage naming the CLIENT and the CONSULTANT and their officers, employees and agents as additional insureds, and that said CONTRACTOR and SUBCONTRACTORS shall maintain such insurance in effect and bear all costs for the same until completion or acceptance of the work. Certificates of said insurance shall be delivered to the CLIENT and to the CONSULTANT as evidence of compliance with this provision. However, the lack of acknowledgment and follow-up by CONSULTANT regarding the receipt of said certificates does not waive CLIENT's and CONTRACTOR's obligation to provide said certificates.

## **9. FACSIMILE TRANSMISSIONS.**

The parties agree that each may rely, without investigation, upon the genuineness and authenticity of any document, including any signature or purported signature, transmitted by facsimile machine, without reviewing or requiring receipt of the original document. Each document or signature so transmitted shall be deemed an enforceable original. Upon request, the transmitting party agrees to provide the receiving party with the original document transmitted by facsimile machine; however, the parties agree that the failure of either party to comply with such a request shall in no way affect the genuineness, authenticity or enforceability of the document. Each party waives and relinquishes as a defense to the formation or enforceability of any contract between the parties, or provision thereof the fact that a facsimile transmission was used.

## **10. CERTIFICATIONS, GUARANTEES AND WARRANTIES**

CONSULTANT shall not be required to sign any documents, no matter by whom requested, that would result in the CONSULTANT having to certify, guarantee or warrant the existence of conditions whose existence the CONSULTANT cannot ascertain. CLIENT also agrees not to make resolution of any dispute with CONSULTANT or payment of any amount due to the CONSULTANT in any way contingent upon the CONSULTANT signing any such certification.

## **11. INDEMNIFICATION**

CONSULTANT agrees to the fullest extent permitted by law, to indemnify and hold CLIENT harmless from any loss, cost (including reasonable attorney's fees and costs of defense) or expense for property damage and bodily injury, including death, caused by CONSULTANT's, or its employees' negligent acts, errors or omissions in the performance of professional services under this Agreement.

CLIENT agrees to the fullest extent permitted by law, to indemnify and hold CONSULTANT harmless from any loss, cost (including reasonable attorney's fees and costs of defense) or expense for property damage and bodily injury, including death, caused solely by CLIENT's, its agents or employees, negligent acts, errors or omissions in the performance of professional services under this Agreement

If the negligence or willful misconduct of both the CONSULTANT and CLIENT (or a person identified above for whom each is liable) is a cause of such damage or injury, the loss, cost, or expense shall be shared between CONSULTANT and CLIENT in proportion to their relative degrees of negligence acts, errors or omissions and the right of indemnity shall apply for such proportion.

## **12. WAIVER OF CONTRACT BREACH**

The waiver of one party of any breach of this Agreement or the failure of one party to enforce at any time, or for any period of time, any of the provisions hereof, shall be limited to the particular instance, shall not operate or be deemed to waive any future breaches of this Agreement and shall not be construed to be a waiver of any provision, except for the particular instance.

## **13. LIMITATION OF LIABILITY**

CLIENT and CONSULTANT have discussed the risks, rewards, and benefits of the project and the CONSULTANT's total fee for services. Risks have been allocated such that the CLIENT agrees that, to the fullest extent permitted by law, the CONSULTANT's total liability to the CLIENT for any and all injuries, claims, losses, expenses, damages, or claim expenses arising out of this agreement from any cause or causes shall not exceed \$100,000. Such causes include but are not limited to the CONSULTANT's negligence, errors, omissions, strict liability, or breach of contract.

## **14. CONTROLLING LAW**

This Agreement is to be governed by the law of the State of Illinois.

## **15. CONSTRUCTION STAKING PROVISIONS**

- a. The destruction of any point(s) labeled C.P. (control point) without the consent of the CONSULTANT will be charged as a non-contract item, at \$300.00 per incident. Control points will be marked, highly visible and identifiable by a "pig-pen" or "triple lath" configuration surrounding each control point.
- b. CONSULTANT will require a minimum of 48 hours notice for scheduling of survey crews. Once the crew is on site, crew will return for as long as required to finish the requested work. ADDITIONAL WORK given to crew, while crew is on-site, will be performed in a minimum of 48 hours. Scheduled surveying requests shall constitute a minimum of 4 hours of field work.
- c. It is understood that it is the CLIENT's responsibility to notify the CONSULTANT (in writing) of any and all revisions to the contract documents. Current blue-line drawings for the project shall be supplied to CONSULTANT by CLIENT.
- d. If underground utility lines and/or curb lines are incorrectly constructed, and the CONSULTANT's stakes are claimed to be the source of error, the stakes in question MUST BE IN THE GROUND as set by the CONSULTANT in order that a re-verification of the location of the stakes can be accomplished.
- e. The CONSULTANT must be notified in writing within 24 hours of any potential staking error by the CLIENT so that the CONSULTANT may assess and verify the cause of the error. No claims shall be made as a result of a staking error against the CONSULTANT without the foregoing notification of the error in writing as specified.
- f. It is understood that the CONSULTANT will set offset stakes one time only, except as otherwise provided in this Agreement. A loss of a stake or stakes due to construction, vandalism, or an act of god will be replaced as an additional service to this Agreement. If the CONSULTANT is called upon to check or verify stakes that he has placed in the ground, and if it is found that those stakes were located and marked according to plan, the CONSULTANT's services will be considered an additional service to this Agreement.
- g. It is understood that it is not the responsibility of the CONSULTANT to verify the horizontal and/or vertical alignment of utility structures after they are built. Such services, should they be required by the CLIENT or the CONTRACTOR, will be provided as an additional service to this Agreement.
- h. CONSULTANT reserves the right to rely on the accuracy of the contract documents and is not responsible for the discovery of any errors or omissions that may exist on the contract documents.