

159th Street

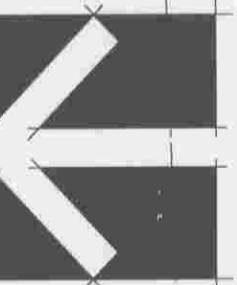

# Schematic Site Plan No. 3A

SCALE: 1" = 30'-0"  
 9-18-07  
 REV. 10-26-2007  
 REV. 11-28-2007

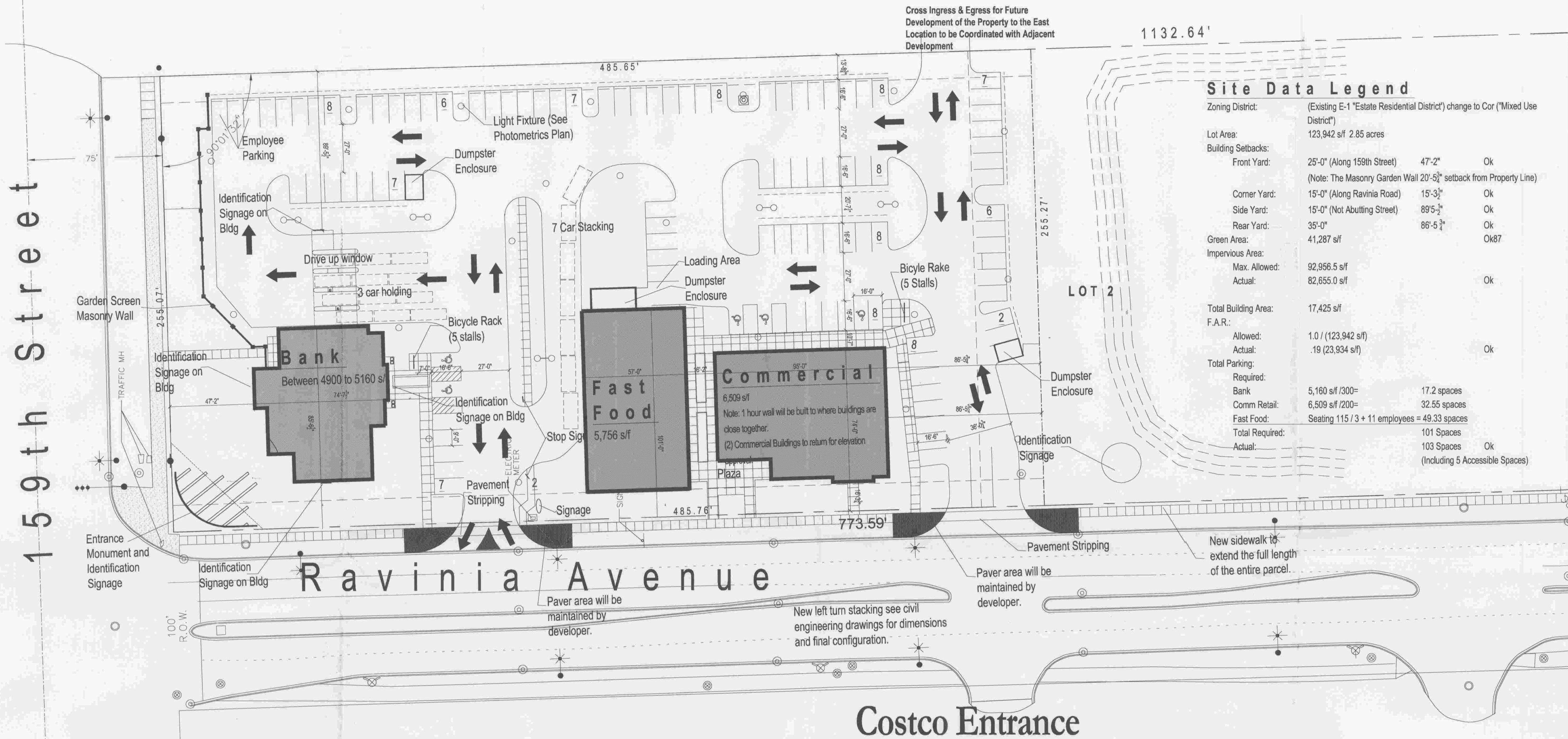

Cross Ingress & Egress for Future Development of the Property to the East Location to be Coordinated with Adjacent Development

1132.64'

## Site Data Legend

Zoning District:	(Existing E-1 "Estate Residential District") change to Cor ("Mixed Use District")	
Lot Area:	123,942 s/f 2.85 acres	
Building Setbacks:		
Front Yard:	25'-0" (Along 159th Street)	47'-2" Ok
(Note: The Masonry Garden Wall 20'-5 1/2" setback from Property Line)		
Corner Yard:	15'-0" (Along Ravinia Road)	15'-3 1/2" Ok
Side Yard:	15'-0" (Not Abutting Street)	89'-5 1/2" Ok
Rear Yard:	35'-0"	86'-5 3/4" Ok
Green Area:	41,287 s/f Ok87	
Impervious Area:		
Max. Allowed:	92,956.5 s/f	
Actual:	82,655.0 s/f Ok	
Total Building Area:	17,425 s/f	
F.A.R.:		
Allowed:	1.0 / (123,942 s/f)	
Actual:	.19 (23,934 s/f) Ok	
Total Parking:		
Required:		
Bank	5,160 s/f /300=	17.2 spaces
Comm Retail:	6,509 s/f /200=	32.55 spaces
Fast Food:	Seating 115 / 3 + 11 employees =	49.33 spaces
Total Required:	101 Spaces	
Actual:	103 Spaces Ok (Including 5 Accessible Spaces)	

NO.	BY:	DATE:	DESCRIPTION:
1	SAS	10/18/07	DESIGN REVIEW
2	SAS	10/24/07	OWNER REVISIONS
3	SAS	10/29/07	VILLAGE SUBMITTAL FOR SITE PLAN REVIEW
4	SAS	11/28/07	RESPONSE TO VILLAGE COMMENTS
5	SAS	12/10/07	traffic study response

**NOTE TO BUILDING DEPARTMENT:**  
 THESE DOCUMENTS (PLANS & SPECIFICATIONS) ARE VALID FOR PERMITS ONLY WHEN THE ARCHITECT'S ORIGINAL SEAL AND SIGNATURE APPEARS AND IS AFFIXED, AND UNLESS OTHERWISE PROVIDED IN WRITING ARE INTENDED AS A PERMIT SUBMITTAL FOR ONE (1) BUILDING ONLY.  
 © The Shalvis Group, P.C. 2007

Proposed New Bank Facility for:  
**Heritage Bank**  
 159th and Ravinia Avenue  
 Orland Park, Illinois  
 For Preliminary Review by Owner

**THE SHALVIS GROUP P.C. ARCHITECTURE**  
 11500 W. 153rd Street, Suite NW, Orland Park, Illinois 60467  
 p. 708.478.6800 f. 708.478.6801 www.shalvisgroup.com

PROJECT ARCHITECT: S.A.S. DATE: 10/17/2007  
 DRAFTPERSON: SAS SCALE: See Sheet  
 APPROVED: [Signature] COMPUTER NAME: [Name]  
 PREPARED FOR: Heritage Bank  
 LOCATION: Heritage Bank, 159th and Ravinia Avenue, Orland Park, Illinois  
 JOB NUMBER: 2007-055

© The Shalvis Group, P.C. 2007  
 Copyright, 2007, The Shalvis Group, P.C. These plans are protected under copyright laws of the United States and foreign countries, and are to be used only for the construction and repair and remodeling of the structure or structures defined in the contract between the Architect and the Owner. Any use of these plans to construct, remodel or repair additional structures constitutes a violation of the Architect's copyright of these plans and is prohibited.

SHEET NUMBER:  
**A-1.0** OF