

Prepared by and after recording

Return to:

Klein, Thorpe & Jenkins, Ltd.
20 N. Wacker Drive
Suite 1660
Chicago, Illinois 60606

On Behalf Of:

The Village of Orland Park, IL
Record against:
PIN: 27-06-202-020-0000



Doc#: 1535129043 Fee: \$50.00

Karen A. Yarbrough

Cook County Recorder of Deeds

Date: 12/17/2015 03:21 PM Pg: 1 of 7

VILLAGE OF ORLAND PARK

VILLAGE CLERK'S CERTIFICATE CERTIFYING COPY OF AN ORDINANCE ENTITLED "**ORDINANCE NO. 5040**", VILLAGE OF ORLAND PARK, COOK COUNTY, ILLINOIS, AN ORDINANCE ANNEXING PROPERTY (GREYSTONE RIDGE – 11434 W. 139TH STREET)

PIN: 27-06-202-020-0000

**AFTER RECORDING RETURN TO:
RECORDER'S BOX 324**

A handwritten signature in black ink, appearing to be the initials 'Bam' or similar, written in a cursive style.

VILLAGE OF ORLAND PARK

14700 Ravinia Avenue
Orland Park, IL 60462
www.orland-park.il.us

Ordinance No: 5040

File Number: 2015-0784

AN ORDINANCE ANNEXING PROPERTY (GREYSTONE RIDGE - 11434 W. 139TH STREET)

VILLAGE OF ORLAND PARK STATE OF ILLINOIS, COUNTIES OF COOK AND WILL

Published in pamphlet form this 8th day of December, 2015 by authority of the President and Board of Trustees of the Village of Orland Park, Cook and Will Counties, Illinois.

VILLAGE OF ORLAND PARK

Ordinance No: 5040

AN ORDINANCE ANNEXING PROPERTY (GREYSTONE RIDGE - 11434 W. 139TH STREET)

BE IT ORDAINED by the President and Board of Trustees of the Village of Orland Park, Cook and Will Counties, Illinois:

SECTION 1

That this President and Board of Trustees find as follows:

- (a) A Petition has been filed with the Village Clerk and presented in proper form to the President and Board of Trustees of the Village of Orland Park, requesting that the territory described in Section 2 of this Ordinance be annexed to the Village of Orland Park, Cook and Will Counties, Illinois.
- (b) Such Petition was signed by all of the owners of record of such territory, there being no electors residing on said territory.
- (c) Such territory is not within the corporate limits of any municipality but is contiguous to the Village of Orland Park, Cook and Will Counties, Illinois, a municipality existing under the laws of the State of Illinois.
- (d) That the Village of Orland Park, Cook and Will Counties, Illinois, does not provide fire protection service, and the territory herein described is not located in a public library district.
- (e) Notice of the proposed annexation has been given to the Orland Township, Cook County, Commissioner of Highways.

SECTION 2

That the territory legally described as follows:

THE EAST HALF (EXCEPT THE SOUTH 493.62 FEET OF THE WEST 228.0 FEET THEREOF) OF THE SOUTH WEST QUARTER OF THE NORTH EAST QUARTER OF SECTION 6, TOWNSHIP 36 NORTH, RANGE 12 EAST OF THE THIRD PRINCIPAL MERIDIAN IN COOK COUNTY, ILLINOIS.

Property Tax Identification Number for the Subject Property is 27-06-202-020-0000.

be and the same is hereby annexed to the Village of Orland Park, Cook and Will Counties, Illinois, all in conformance with and as shown on a plat and map of annexation of said territory prepared by a registered land surveyor of the State of Illinois, attached hereto and made a part hereof as EXHIBIT A.



VILLAGE OF ORLAND PARK

Certification

14700 Ravinia Avenue
Orland Park, IL 60462
(708) 403-6150

STATE OF ILLINOIS COUNTIES OF COOK AND WILL

I, John C. Mehalek, DO HEREBY CERTIFY that I am the duly elected and qualified Village Clerk of the Village of Orland Park, Illinois, and as such Village Clerk I am the keeper of the minutes and records of the proceedings of the Board of Trustees of said Village and have in my custody the minutes and books of the records of said Village.

I DO FURTHER CERTIFY that the attached and foregoing is a true and correct copy of:

Ordinance No. 5040

I DO FURTHER CERTIFY that the original Ordinance of which the foregoing is a true copy is entrusted to my care for safekeeping and that I am the lawful keeper of the same.

IN WITNESS WHEREOF, I have hereunto set my hand and affixed the corporate seal of the Village Of Orland Park aforesaid, at the said Village, in the Counties and State aforesaid, this 8th day of December 2015.

John C. Mehalek, Village Clerk



VILLAGE OF ORLAND PARK

Ordinance No: 5040

SECTION 3

That the Village Clerk is hereby and herewith instructed to record with the Recorder of Deeds of Cook County, Illinois, and to file with the County Clerk of Cook County, Illinois:

- (a) a copy of this Ordinance certified as correct by the Clerk of said Village of Orland Park; and
- (b) a plat of the land included in this annexation, as required by law, said plat to be attached to the afore-said certified copy of this Ordinance.

SECTION 4

That this Ordinance shall be in full force and effect from and after its adoption and approval as required by law.

PASSED this 7th day of December, 2015

/s/ John C. Mehalek

John C. Mehalek, Village Clerk

Aye: 6 Trustee Fenton, Trustee Gira, Trustee Griffin Ruzich, Trustee Calandriello, Trustee Carroll, and President McLaughlin
Nay: 0
Absent: 1 Trustee Dodge

DEPOSITED in my office this 7th day of December, 2015

/s/ John C. Mehalek

John C. Mehalek, Village Clerk

APPROVED this 7th day of December, 2015

/s/ Daniel J. McLaughlin

Daniel J. McLaughlin, Village President

VILLAGE OF ORLAND PARK

Ordinance No: 5040

PUBLISHED this 8th day of December, 2015

/s/ John C. Mehalek

John C. Mehalek, Village Clerk

PLAT OF ANNEXATION TO THE VILLAGE OF ORLAND PARK COOK COUNTY, ILLINOIS

LEGAL DESCRIPTION
THE EAST HALF (EXCEPT THE SOUTH 40.64% FEET OF THE WEST 20.00 FEET THEREOF) OF THE SOUTH WEST QUARTER, RANGE 14E, TOWNSHIP 38N, RANGE 12E EAST OF THE THIRD PRINCIPAL MERIDIAN IN COOK COUNTY, ILLINOIS.

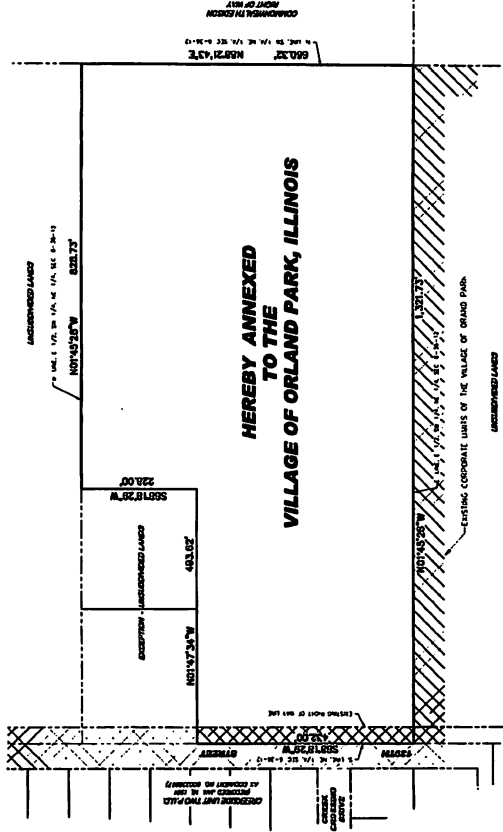

PARCEL IDENTIFICATION NUMBER
27-38-302-000-000

BASES OF BEARING
ASSUMED THE SOUTH LINE, N.E. 1/4 SECTION 27, T.38N. R.12E. S.100°17'25\"/>

COMMON ADDRESS
11434 135th St.
Orland Park, Illinois

SITE DATA
GROSS AREA: 8790.00 SQ. FEET
OR 11.500 ACRES

Submitted by:
Village of Orland Park
14700 Ravinia Avenue
Orland Park, Illinois 60462
708-403-6100

Return the original plat to:
Village of Orland Park
14700 Ravinia Avenue
Orland Park, Illinois 60462
708-403-6100

PERMISSION TO RECORD
STATE OF ILLINOIS }
COUNTY OF WELLS } SS

I, STEVEN J. LAUR, AN ILLINOIS PROFESSIONAL LAND SURVEYOR, NO. 032-00086, HEREBY GRANT PERMISSION TO RECORD THIS PLAT OF ANNEXATION AND PROVIDE THE SURVEYOR WITH A RECORDED COPY OF SAID PLAT.

DATED THIS 15TH DAY OF JULY, A.D. 2013.

STEVEN J. LAUR
ILLINOIS PROFESSIONAL LAND SURVEYOR NO. 032-00086
LICENSE EXPIRES NOVEMBER 30, 2019



STEVEN J. LAUR
ILLINOIS PROFESSIONAL LAND SURVEYOR NO. 032-00086
LICENSE EXPIRES NOVEMBER 30, 2019

STATE OF ILLINOIS }
COUNTY OF WELLS } SS

I, STEVEN J. LAUR, AN ILLINOIS PROFESSIONAL LAND SURVEYOR, DO HEREBY CERTIFY THAT STEVEN J. LAUR, AN ILLINOIS PROFESSIONAL LAND SURVEYOR, HAS PREPARED THIS PLAT OF ANNEXATION AND THAT THE PLAT ACCORDS WITH THE RECORDS OF THE COUNTY RECORDS AND THAT THE PLAT ACCORDS WITH THE RECORDS OF THE COUNTY RECORDS.

ALL DIMENSIONS SHOWN ARE IN FEET AND DECIMAL PARTS THEREOF.

DATED THIS 15TH DAY OF JULY, A.D. 2013.

STEVEN J. LAUR
ILLINOIS PROFESSIONAL LAND SURVEYOR NO. 032-00086
LICENSE EXPIRES NOVEMBER 30, 2019



PLAT OF ANNEXATION			
NO.	DATE	DESCRIPTION	EXPIRES
1	07/15/2013	ROCK SPUR RIDGE	

PREPARED FOR:
GREYSTONE RIDGE, LLC
7912 COUNTY LINE ROAD
DUNER PARK, ILLINOIS 60427
800-526-1446

8550 W. 118th Street, Suite 1
Orland Park, Illinois 60462
708-328-4881 voice
708-328-4882 fax

DRAFTING COMPLETED: 07/20/13
FIELD WORK COMPLETED: 07/20/13

PROJECT MANAGERS: EA
SCALE: 1" = 100'
SHEET NO. 1 of 1
PLAT NO. 03-00713



EXHIBIT A