

Centennial Park Dog Park Fundraising

Our Goal

Through the efforts of the Village of Orland Park Parks Department and along with generous contributions from dog lovers like you, the Village of Orland Park is beginning preliminary measures to develop a securely fenced open space area where owners can let their dogs off leash for exercise, socialization and fun.

How Can I Help?

We are seeking contributions through private donors such as you to make this dog park a reality. Through your generous donations of financial resources, time, and materials we can develop this much needed Dog Park.



Make a tax deductible monetary contribution



Add a donation checkbox to the water bill mailing



Sponsor specific pieces of equipment:

<u>Item</u>	<u>Donation</u>
Shade Structure	\$5000
Drinking Fountain	\$4000
Benches	\$1200
Sanitation Station	\$1000
Trees	\$300
Engraved Brick 4x8	\$100
Advertising Banner (per year)	\$1000
Fountain	TBD
Dog bone picnic table	\$4500



Become a Dog Park sponsor by purchasing the naming rights for the dog park.

- Naming the Dog Park for a 10 year commitment: \$50,000
- Naming as area within the Dog Park for a 10 year commitment: \$10,000



Donations of new building materials such as fencing, irrigation supplies, concrete, etc.

We are in the process of applying for a grant from Petco and a sponsorship from PetSmart for additional funding. Orland Park is also participating in the "Bark for Your Park" contest sponsored by PetSafe. The winner will be awarded \$100,000 to build a Dog Park.

LEGEND

-  BENCH
-  DELUXE BENCH
-  PICNIC TABLE
-  MUTT MITTS & DISPENSER
-  PET WASTE
-  WASTE
-  WATER FOUNTAIN
-  DOUBLE GATE
-  HYDRANT
-  PARK SIGN & BULLETIN BOARD
-  EXISTING OVERLOOK

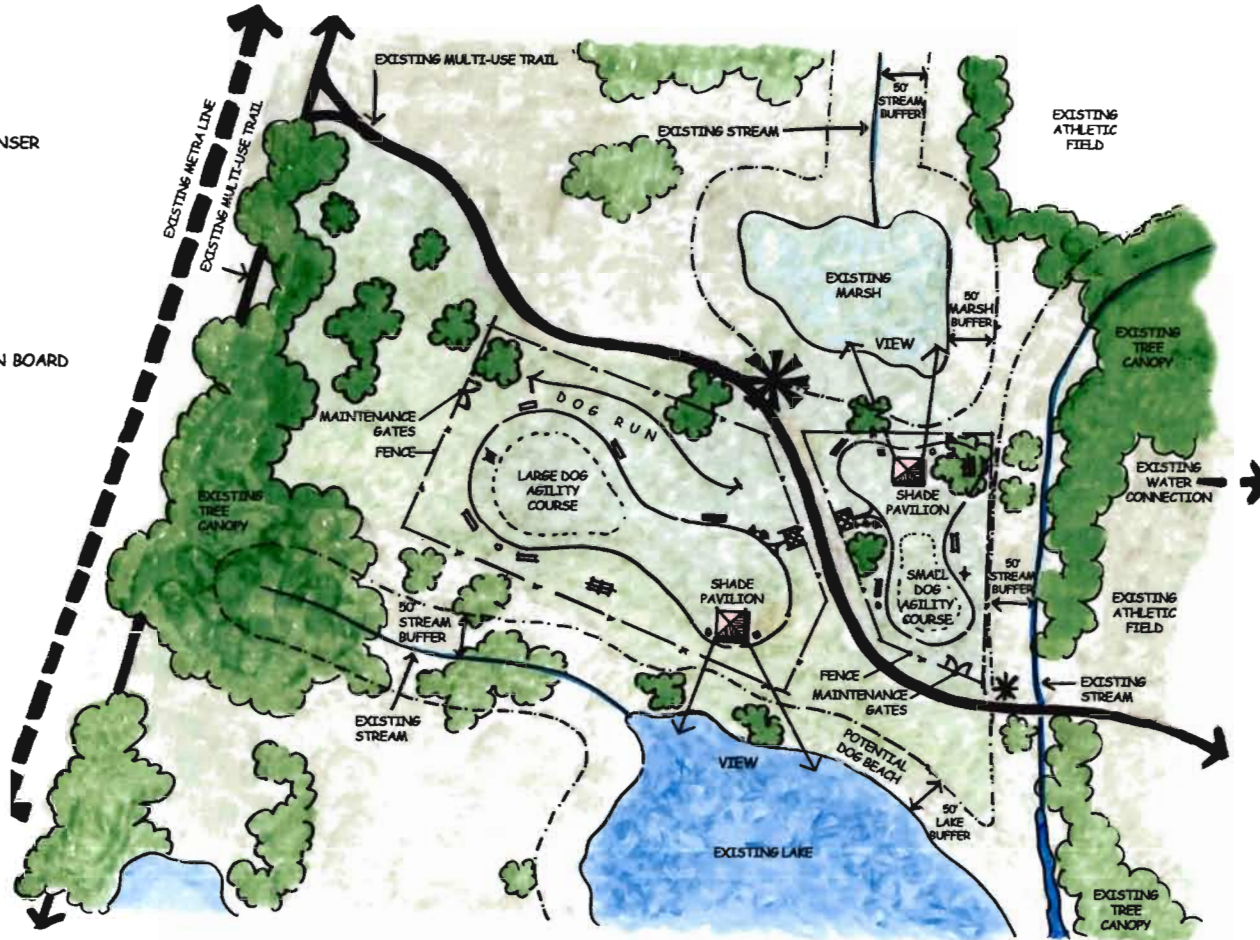

DESIGN APPROACH

This site plan provides for two separate dog parks (one for small dogs and one for large dogs). The parks are situated adjacent to the existing lake within Centennial Park. The parks have been located on either side of an existing multi-use pathway, both parks can be accessed from this pathway. This pathway also leads to an existing parking lot that can be utilized by the dog park user. An existing water connection centrally located just east of the proposed park locations will provide hook-up to drinking fountains and potential Phase II play fountains/dog showers.

LARGE DOG PARK

+/- 2.0 Acre Park

The large dog park is located just west of the existing multi-use trail and takes advantage of the views to the existing lake. The large dog park would provide surround fencing with a double gated entrance and a secondary maintenance access. The park would also provide a large dog agility equipment system, a shade pavilion, a dog run, walking pathways, a picnic table, dog and people water fountains, dog and people waste receptacles and dog mutt mitts/dispensers.

SMALL DOG PARK:

+/- 1.0 Acre Park

The small dog park is located on the eastern side of the existing multi-use trail and takes advantage of the views to an existing marsh/wetland. The park would provide surround fencing with a double gated entrance and a secondary maintenance access. The park would also provide a small dog agility equipment system, a shade pavilion, walking pathways, a picnic table, dog and people water fountains, dog and people waste receptacles, and dog mutt mitts/dispensers.

Dog Park at Centennial Park
Village of Orland Park



© 2011 Google

© 2010 Google

Imagery Date: 6/30/2010



2002

41°36'23.15" N 87°52'17.32" W elev 686 ft

Eye alt 2072 ft





**Support A
Dog Park**



**Memorial
Tree/Bench**



Volunteer



Adopt-A-Path



Adopt-A-Park



DOG-ON-it-PARKS



Turning off-leash areas into . . . PARKS!



The first dog exercise equipment engineered for public park use.

Dog-ON-It-Parks Features:

- Designed for the average recreational off-leash park user with no prior experience
- Safely practice obedience skills & build confidence, plus it's great family exercise for all ages
- Components provide fun activities for all abilities and dog sizes
- Highest quality materials to be both safe & vandal-resistant in public park environments
- Proprietary PawsGrip™ texture is slip-resistant for better traction on ramps
- ADA Accessible for use by everyone  (with accessible surfacing)
- Exclusive 5-year warranty
- Training information & user support at www.dog-on-it-parks.com



Tough enough for any park setting:

- Galvanized steel pipe with baked powder coat finish
- Polymeric PawsGrip™ coating is nearly as tough as steel
- Extra-strong, reinforced 12-gauge steel planks
- Solid polyethylene & recycled plastic with stainless steel hardware
- Tunnel interior is specially molded to be slip-resistant



Complete:

SYSTEM 1

(Minimum area 75' x 150')

- Includes the most popular activities
- Activities for all size dogs
- Twelve fun & challenging activities
- Includes Custom Park Rules Sign & Pet Parking Post

(Site furnishings shown not included)

Small Dog:

SYSTEM 2

(Minimum area 50' x 100')

- Created specifically for small dogs
- Includes seven size-appropriate activities



More details on each component & training tips at www.dog-on-it-parks.com

EXERCISE COMPONENTS:

S-TUNNEL #6802-S

Slip resistant tunnel interior with or without Dog Houses
(Shown w/2 Doghouses)



WAIT TABLE

3' x 3'

#6403-S
8" Height



#6404
16" Height



ADJUSTABLE TIRE JUMP #6520

16" of adjustment for all dog sizes.



JUMP WALL #6601-S, #6602-S, #6603

3 heights available



ADJUSTABLE JUMP BAR #6521-S

Knock-down safety bar adjusts to 7 positions



HOUD HURDLES #6509-S

Set of 4 hurdles

6" Height



AGILITY WALK #6413-S

Slip resistant (set of 5 steps)



FLEXIBLE WEAVE POSTS #6516-S

Safely flexes with no spring back. Set of 6



HOUD HOOPS #6415

Set of 5 hoops



A-FRAME #6401

3' high x 14" long x 38" wide



DOG TEETER-TOTTER #6412

10' long x 12" wide with shock absorbers



DOG WALK RAMP #6402

3' high x 18' long x 20" wide



(-S suffix indicates component is also suitable for Small Dog areas)



DOG-ON-it-PARKS

626 128th St SW #104A 🐾 Everett, WA 98204
 877-FIT-DOGS 🐾 www.dog-on-it-parks.com



#6902 PET
 PARKING POST

PHONE: 877-348-3647 🐾 FAX: 425-347-3056 🐾 OR CONTACT YOUR LOCAL DEALER

MUTT MITT #7401 / #7402

Single & Double Dispensers hold 360 Bags each



DOG DRINKING FOUNTAIN #7221 / #7222

All Stainless-Steel design



RED FIRE HYDRANT 32" HIGH #7260



FIBERGLASS DOG PARK RULES SIGN #7230



Custom
 Text
 Available

6' DELUXE DOG PAW BENCH #7201

Other styles & custom logos available



SINGLE POST PICNIC TABLE #7204

4 Seats - 46" Top



WASTE RECEPTACLES

#7501:
 Dog Waste
 22-Gallon



#7502:
 Trash Only
 32-Gallon



SHADE & PARK SHELTERS

Many sizes available



ENGINEERED WOLF FIBER



Clean traction! The perfect dog park surfacing.

877-FIT-DOGS 🐾 www.dog-on-it-parks.com

Amenities and Pricing for Dog Park in Centennial Park

5/10/2011

Estimated Expenses

Amenities	Pricing	Quantity	Comments	Extended Price
equipment system	\$21,235	1	this includes activities for all size dogs & custom rules sign	\$21,235
small dog equipment system	\$8,256	1	created specifically for small dogs	\$8,256
fencing*	\$26	2050	separate areas for large and small dogs - double gated, self closing gates w/10' transition - 6' fence - bury several inches to prevent escape - large gate for mower access (per linear ft.)	\$53,300
dog paw bench (basic)	\$562	8		\$4,496
dog paw bench (deluxe)	\$1,284	4		\$5,136
picnic table	\$1,975	2	dog bone picnic table, seats 6	\$3,950
drinking fountain	\$3,535	2		\$7,070
shade shelter	\$4,585	2		\$9,170
paved walking path*	\$36,000	1	around perimeter	\$36,000
mutt mitts and dispenser	\$175	4		\$700
pet waste receptacle	\$621	2	22 gallon w/liner	\$1,242
trash only receptacle	\$648	2	32 gallon w/liner	\$1,296
spray fire hydrant	\$1,080	2	10 second timer	\$2,160
access to water main	\$10,000	1		\$10,000
bulletin board	\$1,350	1		\$1,350
park sign	\$2,400	1		\$2,400
landscaping	\$15,000	1		\$15,000
				\$182,761

*alternate larger large dog area would increase fencing to \$78,000

*can be added as later phase

dog beach in later phase

fountains in later phase