

[Handwritten signature]

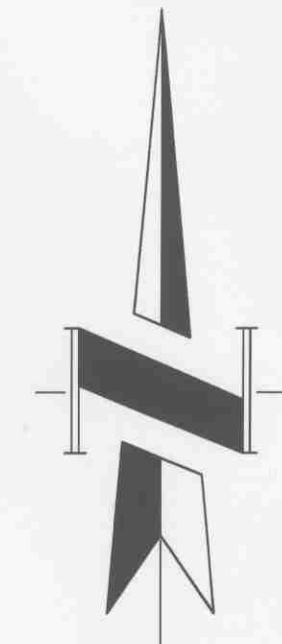

PROJECT SUMMARY

GROSS AREA: 27,539 SF
(0.63 AC)

**AREA OF WETLAND,
FLOODWAY, FLOOD-
PLAIN, OPEN WATER:** 0 AC

NET BUILDABLE AREA: 27,539 SF
(0.63 AC)

PARKING
TOTAL REQUIRED 29
TOTAL PROVIDED 29
HC STALLS: 2
STANDARD: 27

BUILDING AREA: 5,886 SF
LANDSCAPED AREA: 7,252 SF
(27% OF GROSS AREA)

FLOOR AREA RATIO: 0.21
GROSS IMPERV. AREA: 20,287 SF
(73%)

LOT COUNT: 1
BUILDING COUNT 1

VARIANCE TABLE

	REQ'D	PROPOSED
1) SIDE YARD SETBACK	15'	8'
2) ISLAND WIDTH	10'	4 @ 10' 2 @ 6' 1 @ 5.5'

BOARD APPROVED
CASE NO. 2007-0642.2
DATE 12-17-07
W/CONDITIONS
W/O CONDITIONS

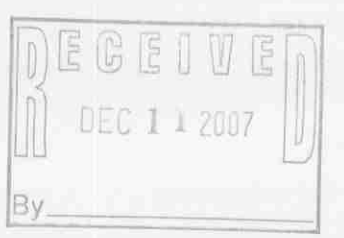

REVISIONS			LEXMOR ENGINEERING, LLC		
No.	DATE	REMARKS	9405 Bormet Drive, Suite 1 Mokena, IL 60448 E-MAIL: brad@lexmor.net		
3	12/05/07	ORLAND PARK	ORLAND PARK	ILLINOIS	
2	08/20/07	VARIANCE TABLE	DRAWN BY: D. VOITH	DATE: 06/21/07	
1	07/26/07	REVIEW #1	CHECKED BY: B. BRINK	SCALE: 1" = 20'	
No.	DATE	REMARKS	SHEET 1 OF 1	PROJECT No. 04-007	

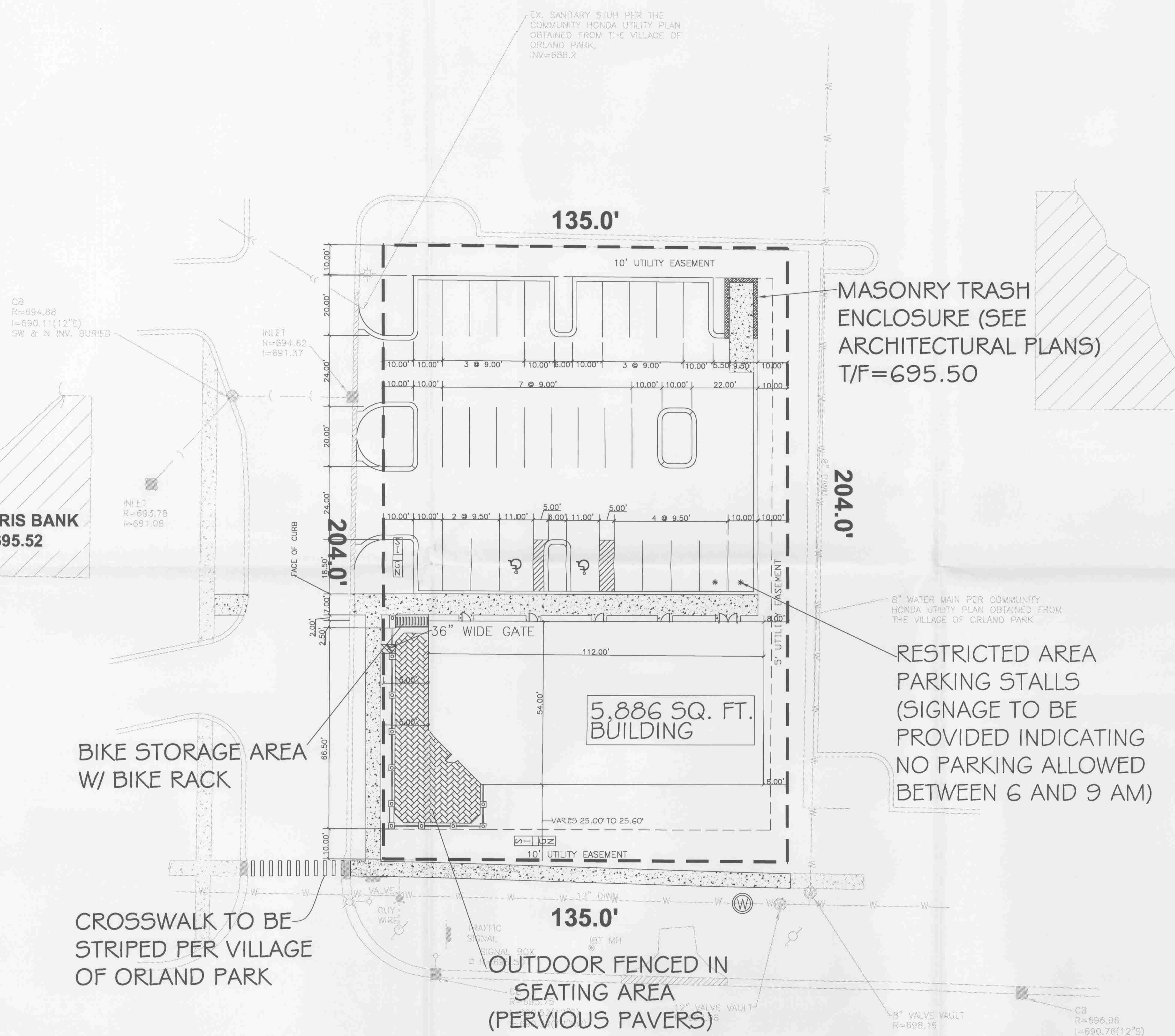

MASONRY TRASH ENCLOSURE (SEE ARCHITECTURAL PLANS)
T/F=695.50

RESTRICTED AREA PARKING STALLS (SIGNAGE TO BE PROVIDED INDICATING NO PARKING ALLOWED BETWEEN 6 AND 9 AM)

NOTE: ALL MECHANICAL EQUIPMENT SHALL BE SCREENED EITHER WITH LANDSCAPING AT GRADE LEVEL OR ON THE ROOF WITH A PARAPET CONSTRUCTED OF MATERIAL SIMILAR TO BUILDING.