

LANDSCAPE PLAN SCALE

1" = 20'-0"

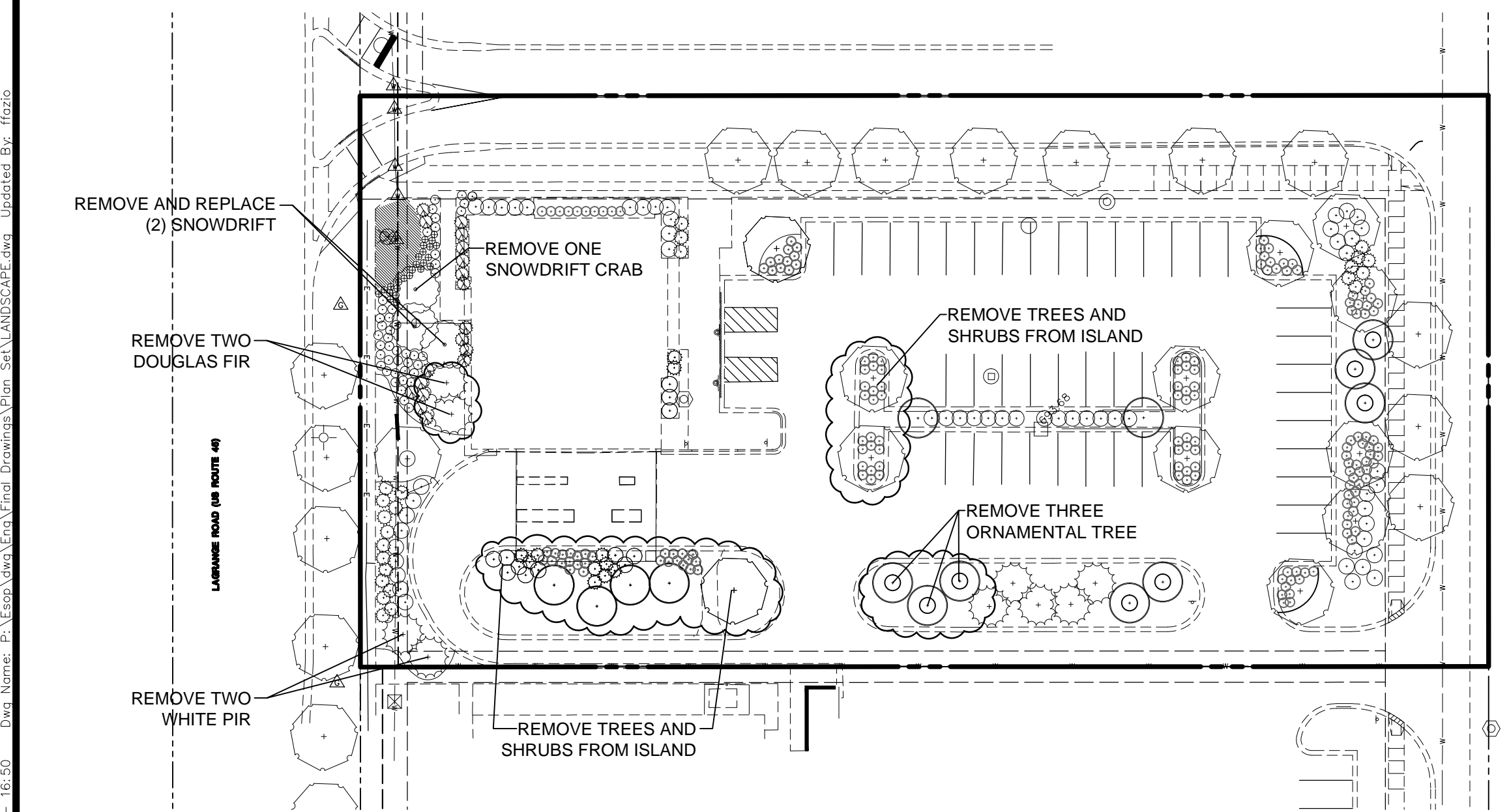

TURF AREA



PLANT MATERIAL REMOVAL PLAN SCALE

1" = 40'-0"



Key	Quantity	Name COMMON/ Botanical	Size	Comments
ACNI	2	GREENCOLUMN BLACK MAPLE/ <i>Acer nigrum</i> 'Greencolumn'	2-1/2" BB	
ARME	14	VIKING BLACK CHOKEBERRY/ <i>Aronia melanocarpa</i> 'Viking'	3'	Planted 3'-0" on center
BENI	3	RIVER BIRCH/ <i>Betula nigra</i>	8' BB	3-stem clump
JUCH	15	GREEN SARGENT JUHIPER/ <i>Juniperus chinensis sargentii</i> 'Viricis'	24"	
GLTR	4	SKYLINE HONEYLOCUST/ <i>Gleditsia triacanthos</i> var. <i>inermis</i> 'Skyline'	2-1/2" BB	
PEAT	20	RUSSIAN SAGE/ <i>Perovskia atriplicifolia</i> 'Longin'	1 Gallon	
PYCA	3	CLEVELAND SELECT (Chanticleer) PEAR/ <i>Pyrus calleryana</i> 'Glens Form'	2-1/2" BB	
RHAR	23	GRO-LOW FRAGRANT SUMAC/ <i>Rhus aromatica</i> 'Gro-Low'	#5 Container	Planted 3'-0" on center
RIAL	13	ALPINE CURRANT/ <i>Ribes alpinum</i>	3'	Planted 3'-0" on center
ROCA	7	CAREFREE WONDER ROSE/ <i>Rosa</i> 'Carefree Wonder'	2 Gallon	
RUFU	150	BLACK - EYED SUSAN/ <i>Rudbeckia fulgida</i> 'Goldstrum'	1 Gallon	
VIDE	14	AUTUMN JAZZ VIBURNUM/ <i>Viburnum dentatum</i> 'Ralph Senior'	3'	Planted 3'-0" on center

Village of Orland Park – Required Landscaping

BUFFERYARDS

North – Commercial adjacent to Collector Road – "B" Bufferyard
 South – Commercial adjacent to Commercial – "B" Bufferyard
 West – Commercial adjacent to Arterial Road – "C" Bufferyard
 East – Commercial adjacent to Commercial – "B" Bufferyard

North Bufferyard – "B" 20 feet wide

361.0 feet of property line
 100 feet = 3.61

2.4 canopy trees = (8.66) = 9 canopy trees (7 existing trees & 2 added on plan)
 3.61 X 0.6 understory trees = (2.16) = 2 understory trees (2 added on plan)
 12 shrubs = (43.3) = 43 shrubs (27 existing & 16 added on plan)

South Bufferyard – "B" 10' to 20' feet wide

361.0 feet of property line
 100 feet = 3.61

2.4 canopy trees = (8.66) = 9 canopy trees (1 canopy & 5 evergreen trees & 3 canopy trees added on plan)
 3.61 X 0.6 understory trees = (2.16) = 2 understory trees (2 existing & 1 added on plan)
 12 shrubs = (43.3) = 43 shrubs (17 existing & 38 added on plan)

West Bufferyard – "C" 25 feet wide

183.5 feet of property line
 100 feet = 1.84

3.5 canopy trees = (6.44) = 6 canopy trees (5 existing)
 1.84 X 1.4 understory trees = (2.58) = 3 understory trees (2 existing)
 14 shrubs = (25.70) = 26 shrubs (82 existing & additional added on plan)

East Bufferyard – "B" 20 feet wide

183.5 feet of property line
 100 feet = 1.84

2.4 canopy trees = (4.4) = 4 trees (7 existing)
 1.84 X 0.6 understory trees = (1.10) = 1 understory tree (3 existing)
 12 shrubs = (22.1) = 22 shrubs (83 existing)

INTERIOR LOT LANDSCAPING

Minimum ten foot wide landscaped area shall front not less than 70% of the side of all buildings which front dedicated streets or access lanes.

BOARD APPROVED

Case No: 2014-0280
 Date: 11/3/14
 W/Conditions: _____
 W/Out Conditions: _____

VILLAGE OF ORLAND PARK

West side of existing and proposed building front on LaGrange Road and they have 100% frontage landscaped.

One tree per 10,000 square feet of lot area for commercial development.

96,206.5 sq. ft. of lot area
 - 10,000 sq. ft. = (9.6) = 10 trees

Existing and proposed trees far exceed this 10 tree requirement

PARKWAY STANDARDS

1 tree per 40 feet of frontage

LaGrange Road - 183.5/40 = (4.59) = 5 trees (4 existing)

156th Place (North) - 361.0/40 = (9.03) = 9 trees (7 existing trees & 2 added on plan)

95th Avenue (East) - 183.5/40 = (4.59) = 5 trees (3 existing trees & 2 added on plan)

PARKING LOT LANDSCAPING

One landscape island per 7 parking spaces

47 total parking spaces
 7 spaces = (6.71) = 7 islands required

There are 7 islands on the plan counting interior islands and islands at end of rows.

Each island shall be 200 square feet and 10 feet wide.

Every island complies except for the existing center island which is less than 10 feet wide, but exceeds the 200 square feet when the entire island is calculated.

Each island shall include at least 1 tree and 1 shrub per 200 square feet of island area.

All island exceed this requirement.

General Comments

1. Rake, weed, and replenish shredded bark mulch in all existing planting beds. There should be a minimum of 3" to 4" of depth of mulch.
2. Trim out dead branches in existing trees and shrubs.
3. Add topsoil and seed in areas where settling has occurred at edges of curbs and sidewalks.
4. Take care in removing plant material from damaging structures or other plant material.
5. Provide fertilizer and weed control on all existing turf areas.
6. Edge all planting beds.
7. Locate and identify the locations of the existing irrigation system. Be sure to turn off and locate areas where the existing system will be cut off.

MANHARD CONSULTING LTD
 15631 SOUTH LAGRANGE ROAD, ORLAND PARK, ILLINOIS
 LANDSCAPE PLAN
 JPS INTERESTS
 SCALE: 1" = 20'
 SHEET L1 OF 2
 ESOP 140421
 DATE: 6-26-14
 DRAWN BY: REH
 PROJ. ASSOC: GRC1
 PROJ. MGR: FF
 REVISIONS: 10-27-14 REVISION PER LANDSCAPE REVIEW
 9-29-14 REVISION PER LANDSCAPE REVIEW
 8-18-14 ISSUED FOR CONSTRUCTION
 7-7-14 ISSUED FOR BID
 DATE: _____
 REVISIONS: _____
 DRAWN BY: _____
 PROJ. ASSOC: _____
 PROJ. MGR: _____
 DATE: _____
 SCALE: _____
 SHEET _____ OF _____
 ESOP _____