

#### GENERAL STATEMENTS:

- ALMOST ALL TREES ON PATH SIDE WITHIN EX ROW WILL BE REMOVED
- AROUND 700' OF STM SEWER IS NEEDED IN EACH OPTION
- DUE TO VERTICAL CONFLICTS, THE PROPOSED PATH THAT IS WITHIN THE EX ROW WOULD BE REMOVED AND REPLACED AS PART OF FUTURE COUNTY HIGHWAY ROADWAY RECON OF 153RD STREET TO A 5-LANE SECTION
- PATH ALONG WOLF ROAD ACCOMODATES THE EXISTING AND POTENTIAL 5-LANE ROADWAY
- BOTH OPTIONS REQUIRE COUNTY CONSTRUCTION PERMIT

#### PATH IN EX ROW:

##### BENEFITS:

- NO LAND ACO ANTICIPATED

##### CHALLENGES:

- DESIGN WALLS AND STM SEWER AROUND ATT FO DUCT
- RELOC FIRE HYDRANT
- A SEGMENT HAS GUARD RAIL AT PAVEMENT EDGE MAKING A VERY NARROW PATH CORRIDOR
- WET AREA MAY REQUIRE LIGHTWEIGHT FILL

#### PATH IN EX ROW AND PR PERM EASE:

##### BENEFITS:

- LESS WALL AND STM SEWER
- LESS POTENTIAL CONFLICT WITH ATT
- NO GUARD RAIL
- NO FIRE HYDRANT RELOCATION
- MINIMIZED IMPACT AT WET AREA
- NO ADDITIONAL TREE REMOVAL NEEDED

##### CHALLENGES:

- LAND ACO NEEDED, BUT PROVIDES ENHANCED CONDITIONS TO PATH USERS AND PROPERTY OWNERS

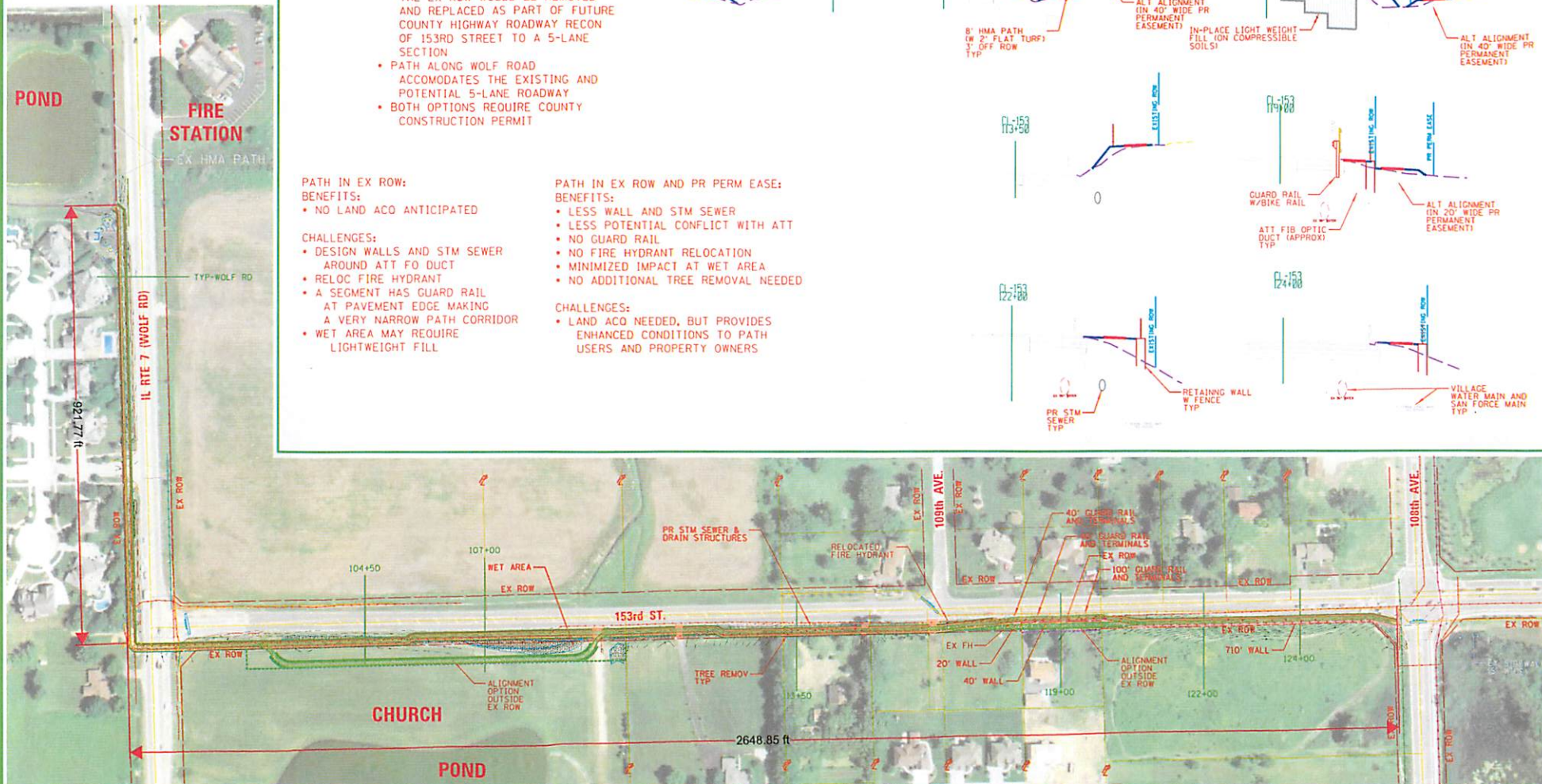
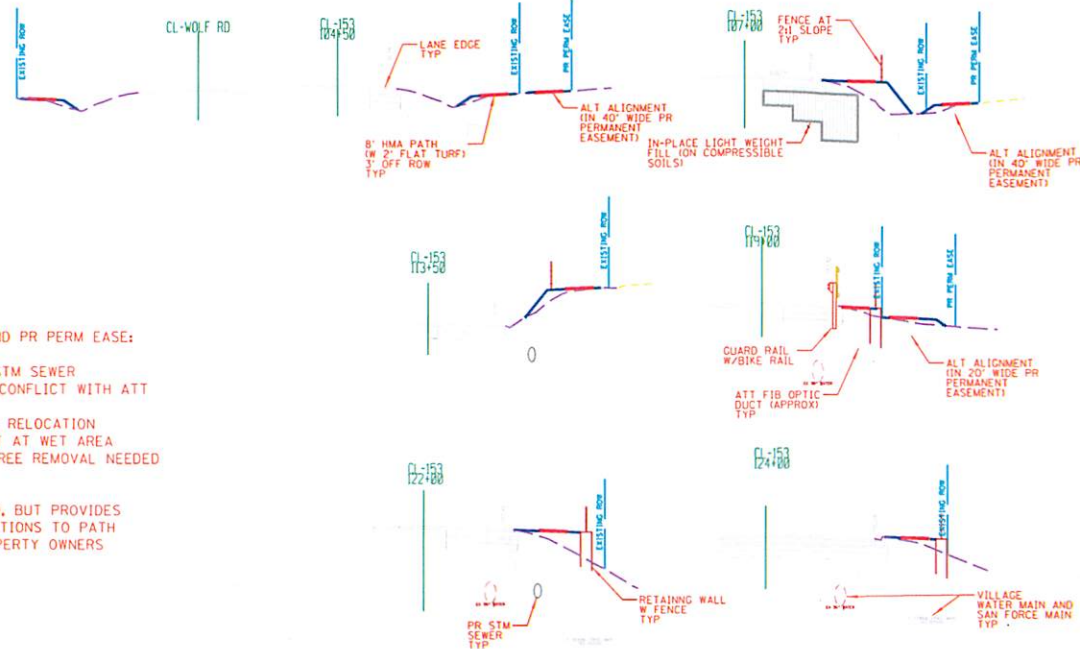

**CHRISTOPHER B. BURKE ENGINEERING, LTD.**  
9575 W. Higgins Road, Suite 600  
Rosemont, Illinois 60018  
(847) 823-0500

CLIENTS:



**Village of Orland Park**  
14700 Governors Road  
Orland Park, Illinois

NO.	DATE	NATURE OF REVISION	CHKD.	MOODEL
1	5/27/2011	ISSUED FOR PERMIT		
2	5/27/2011	REVISED PER COMMENTS		
3	5/27/2011	REVISED PER COMMENTS		
4	5/27/2011	REVISED PER COMMENTS		
5	5/27/2011	REVISED PER COMMENTS		
6	5/27/2011	REVISED PER COMMENTS		
7	5/27/2011	REVISED PER COMMENTS		
8	5/27/2011	REVISED PER COMMENTS		
9	5/27/2011	REVISED PER COMMENTS		
10	5/27/2011	REVISED PER COMMENTS		

TITLE:

**153rd ST. BIKE PATH  
CONCEPT ALTERNATE ALIGNMENTS**

PROJ. NO. 110166  
DATE: 5/27/2011  
SHEET 1 OF 1  
DRAWING NO. EXH 1