

PRELIMINARY SITE PLAN FOR 15615 S. HARLEM INC. RETAIL CENTER

ORLAND PARK, ILLINOIS

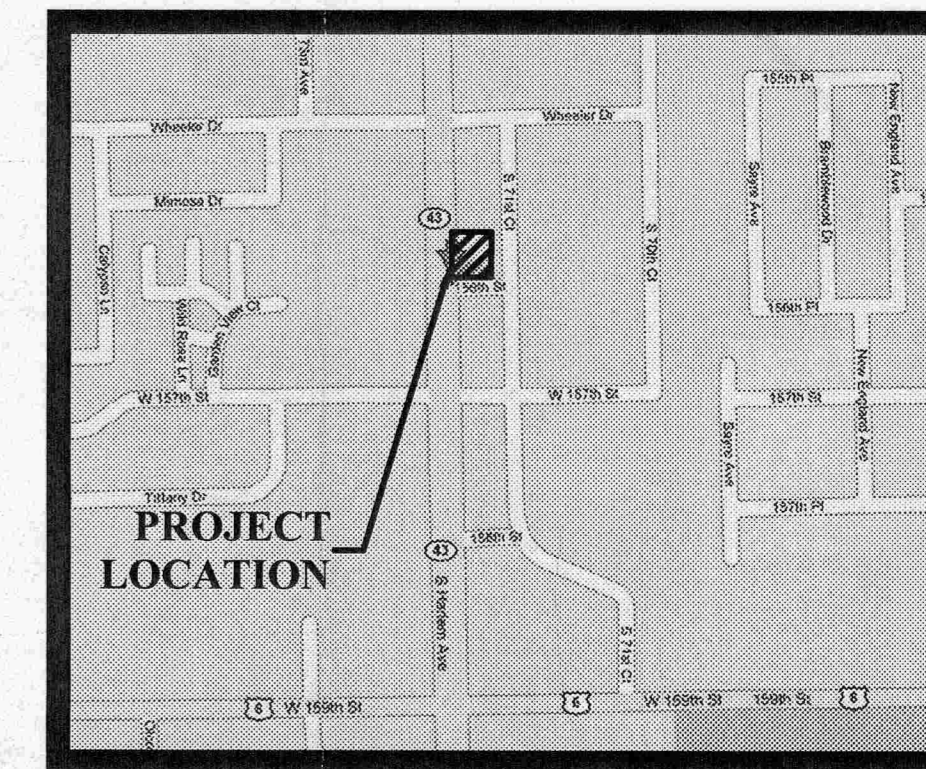

LOCATION MAP
NOT TO SCALE



LEGAL DESCRIPTION:

THE NORTH 270.00 FEET OF LOT 108 IN CATALINA'S COMMERCIAL AND INDUSTRIAL SUBDIVISION OF LOTS 3 AND 6 IN SILVER LAKE GARDENS UNIT NO. 7, A SUBDIVISION OF PART OF THE WEST QUARTER OF SECTION 18, TOWNSHIP 36 NORTH, RANGE 13, EAST OF THE THIRD PRINCIPAL MERIDIAN, ACCORDING TO THE PLAT THEREOF RECORDED NOVEMBER 2, 1973, AS DOCUMENT NO. 22532993, IN COOK COUNTY, ILLINOIS.

AREA IN SURVEY: 54,000 SQUARE FEET OR 1.2397 ACRES

P.I.N.

28-18-308-004-0000

PROPERTY ADDRESS:

15605 S. HARLEM AVENUE
ORLAND PARK, ILLINOIS
BREMEN TOWNSHIP

SITE DATA:

TOTAL (GROSS) SITE AREA	= 1.24 ac = 54,000 SF
LANDSCAPE AREA	= 0.87 ac = 37,894 SF
COMMERCIAL UNIT AREA (1 STORY)	= 14,030 SF
FLOOR AREA RATIO	= 0.26
PARKING REQUIRED	= 70 SPACES
PARKING PROVIDED	= 53 SPACES
REGULAR	= 50
HANDICAP	= 3
AVAILABLE SHARED PARKING	= 25 SPACES
GROSS IMPERVIOUS AREA (PROP)	= 37,894 SF (70%)
GROSS IMPERVIOUS AREA (EXIST)	= 45,738 SF (85%)
NUMBER OF LOTS	= 1
NUMBER OF BUILDINGS	= 1 (BIZ ZONED)

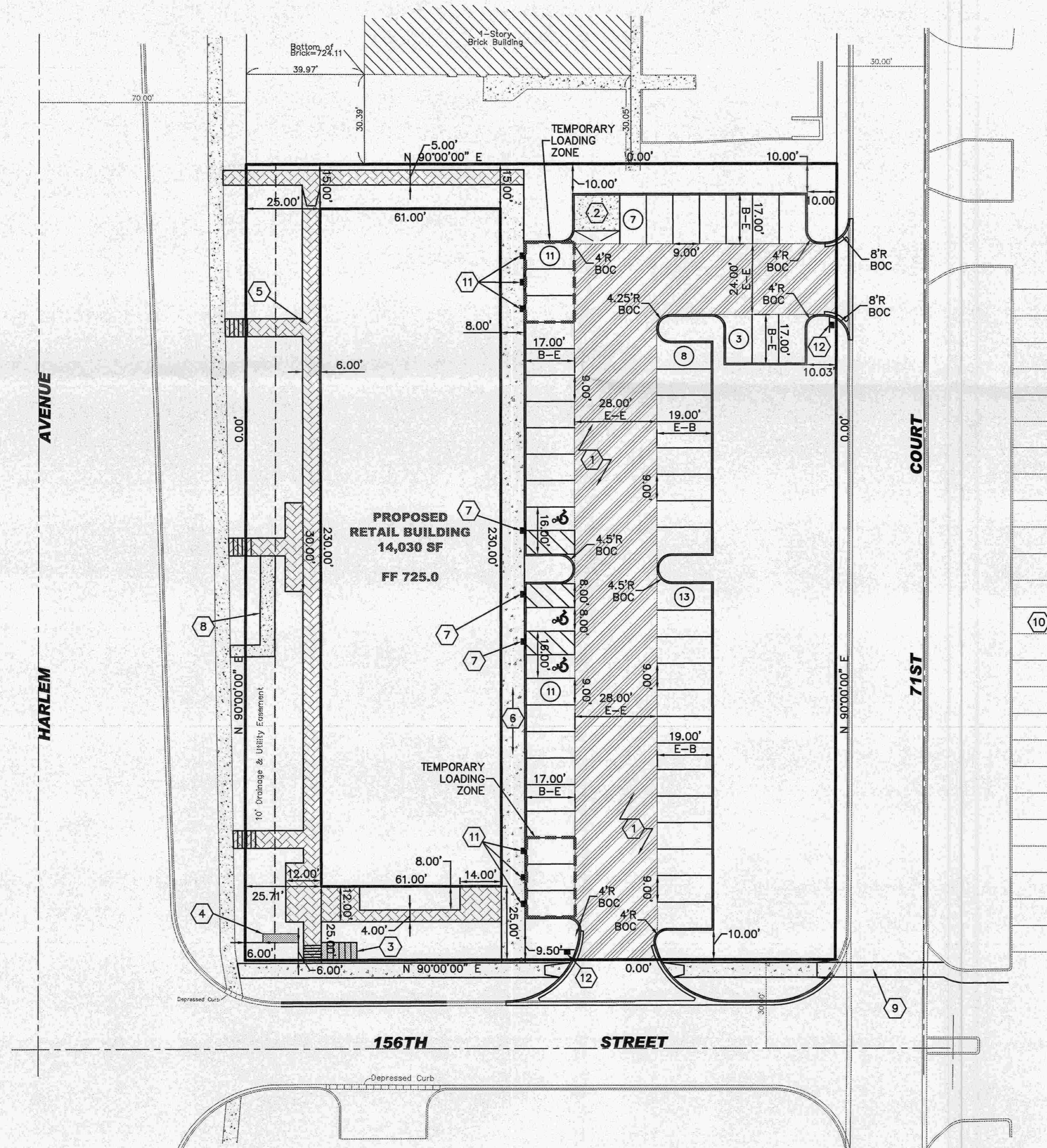

SITE PLAN KEYED NOTES

- ① PERMEABLE PAVERS
- ② TRASH ENCLOSURE W/ FENCE & GATES, CONCRETE PAD
- ③ BIKE RACK
- ④ MONUMENT SIGN
- ⑤ PAVER BRICK SIDEWALK
- ⑥ CONCRETE SIDEWALK
- ⑦ HANDICAP PARKING SIGN
- ⑧ HANDICAP RAMP W/ RAILING
- ⑨ STRIPED CROSS WALK
- ⑩ LOCATION OF SHARED PARKING
- ⑪ TEMPORARY LOADING ZONE NO PARKING 6 AM - 9 AM SIGN
- ⑫ ADDITIONAL PARKING LOCATION DIRECTION SIGN

NO.	DATE	DESCRIPTION	BY
1	04-23-08	PER VILLAGE REVIEW	ADM

15615 S. HARLEM INC.
15615 S. HARLEM AVENUE
ORLAND PARK, ILLINOIS 60462
(708) 259-3590

PRELIMINARY SITE PLAN
FOR
RETAIL CENTER
ORLAND PARK, ILLINOIS

DESIGNTEK ENGINEERING, INC.
CONSULTING AND SITE DESIGN ENGINEERS
9500 BORMET DRIVE, SUITE 504
MOKENA, ILLINOIS 60448
(708) 326-4961
IL PROF. LIC. NO.: 184-003740



PROJECT INFORMATION
Project No.: 07-0051
Scale: 1" = 30'
Date: 03-18-08
Design By: ADM
Drafted By: ADM
Checked By: SDS

SCOTT D. SCHREINER
PROFESSIONAL ENGINEER
06/149702
Exp 11/30/09

REVIEW SET
NOT FOR CONSTRUCTION