

GENERAL LANDSCAPE DETAILS

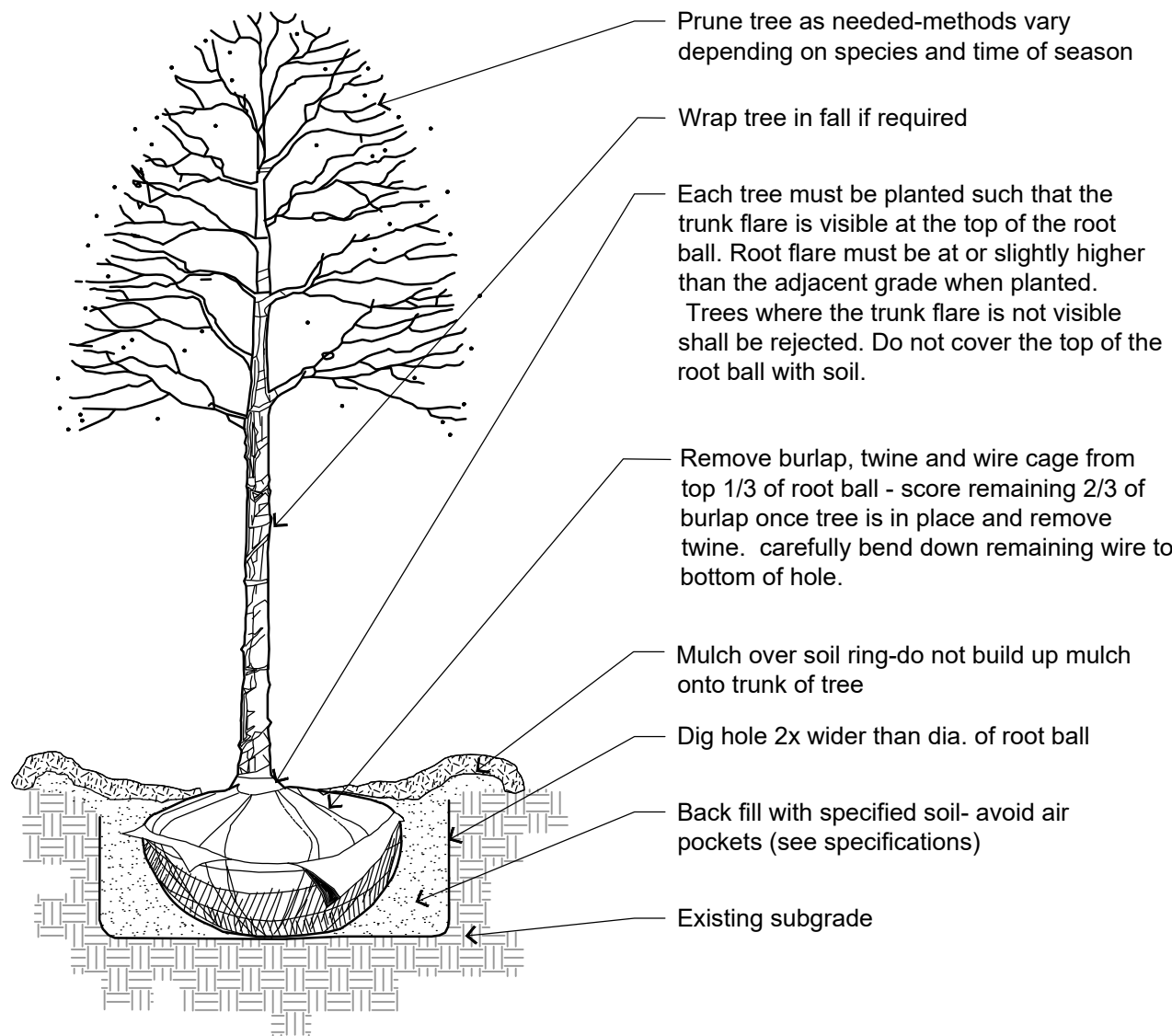

1 DECIDUOUS TREE PLANTING DETAIL
NOT TO SCALE

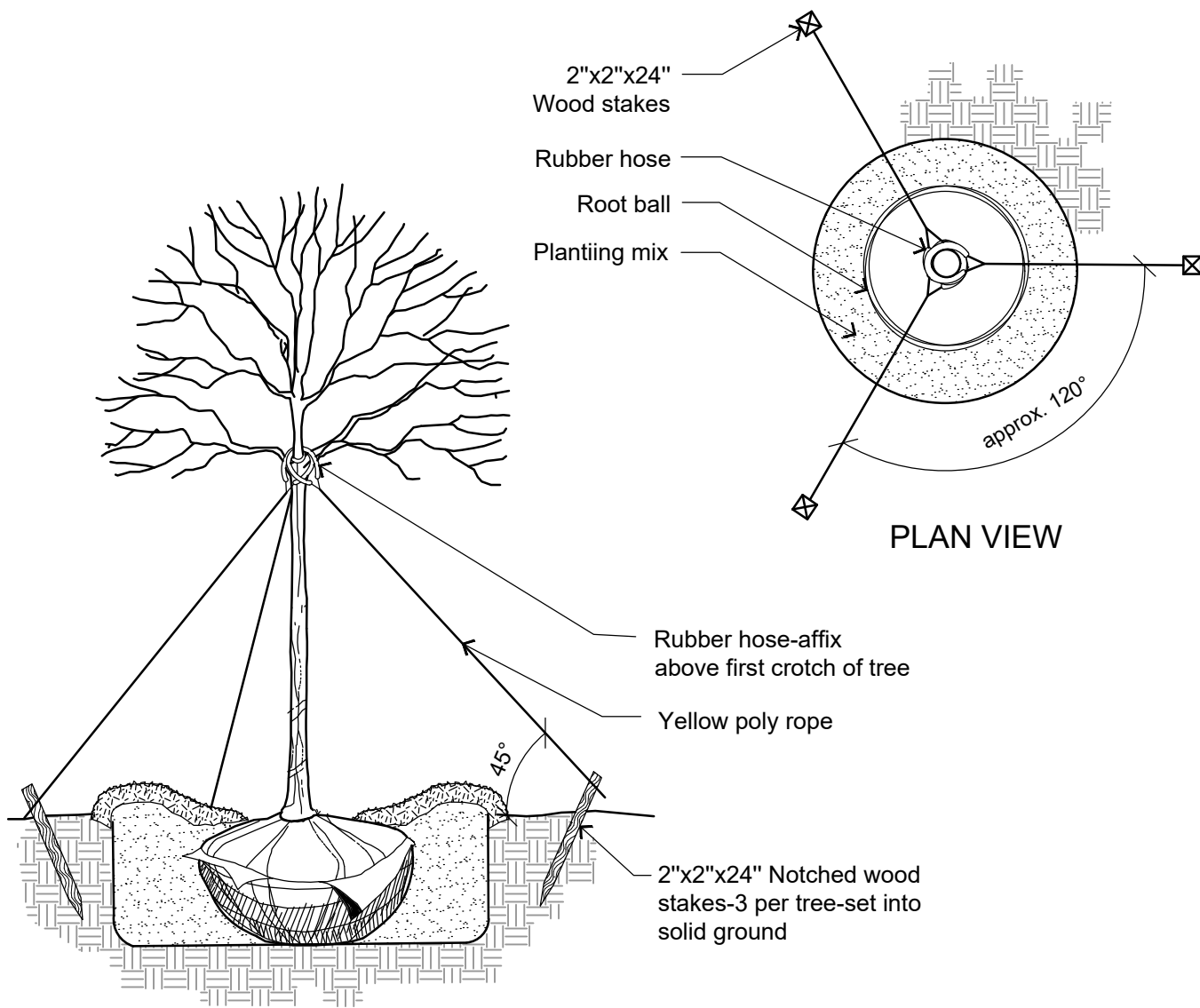

2 DECIDUOUS TREE STAKING DETAIL
NOT TO SCALE

PLANT KEY

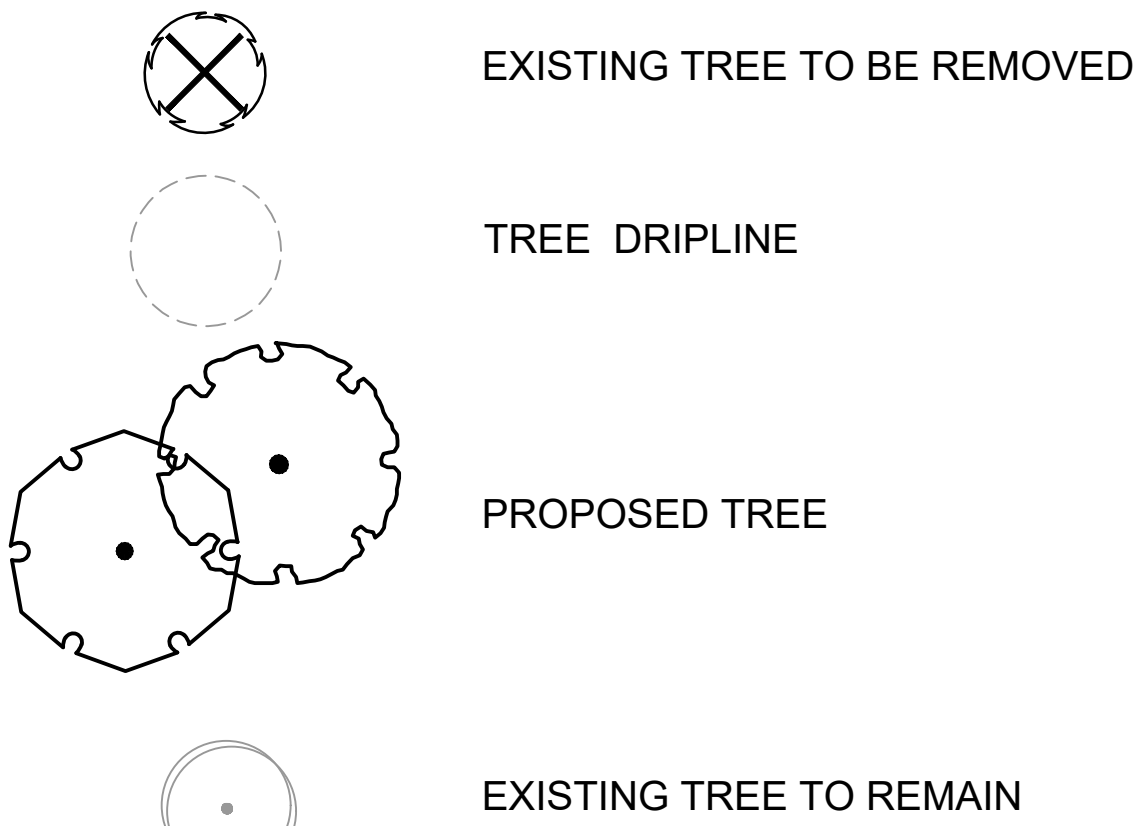

PLANT SCHEDULE

CANOPY TREES	QTY	COMMON NAME	BOTANICAL NAME	SIZE	ROOT	REMARKS
CHH	2	Chicagoland Hackberry	Celtis occidentalis 'Chicagoland'	2 1/2" CAL	B&B	Full, matching heads
RO	3	Red Oak	Quercus rubra	2 1/2" CAL	B&B	Full, matching heads

TREE MITIGATION CALCULATIONS

		TREE	BOTANICAL NAME	SIZE	NATIVE OR NON-NATIVE	CONDITION	MITIGATION	NUMBER OF REPLACEMENT TREES
Centennial	1	Maple	Acer x freemanii	5"	non native	Good	1 tree at 2.5"	1
	2	Maple	Acer x freemanii	11"	non native	Good	1 tree at 2.5"	1
	3	Maple	Acer x freemanii	11"	non native	Good	1 tree at 2.5"	1
	4	Flowering Pear	Pyrus calleryana	12"	non native	Good	NA-species exempt	0
	5	Flowering Pear	Pyrus calleryana	12"	non native	Good	NA-species exempt	0
	6	Maple	Acer x freemanii	11"	non native	Good	1 tree at 2.5"	1
	7	Flowering Pear	Pyrus calleryana	18"	non native	Good	NA-species exempt	0
	8	Maple	Acer x freemanii	12"	non native	Good	1 tree at 2.5"	1

GENERAL LANDSCAPE NOTES

- Contractor responsible for contacting public and private underground utility locating service to have site marked prior to any digging or earthwork.
- Contractor to verify all plant quantities shown on plant list and verify with plan. Report any discrepancies immediately to general contractor.
- All plantings shall comply with standards as described in American Standard of Nursery Stock - ANSI Z60.1 (latest version). General contractor or owner's representative reserves the right to inspect and potentially reject any plants that are inferior, compromised, undersized, diseased, improperly transported, installed incorrectly or damaged.
- Any potential plant substitutions must be submitted in writing to the general contractor and approved by the owner's representative prior to installation. All plants must be installed as per sizes and quantities shown on plant material schedule, unless approved by the owner's representative. Any potential changes to sizes shown on plan and appropriate cost credits / adjustments must be submitted in writing to the general contractor and approved by the owner's representative prior to installation.
- The subsequent requirements regarding topsoil should be coordinated between the general contractor, grading contractor and landscape contractor.
- Subgrade areas shall be graded to within 1", more or less, of proposed subgrade. Deviations shall not be consistent in one direction.
- Topsoil shall be placed to meet proposed finished grade. All other landscaped areas to receive a minimum depth of 3" of clean topsoil (per note below).
- Topsoil shall be: screened existing stockpiled topsoil, existing in-place soil, or screened soil from an off-site source that will support plant growth, and meets the following requirements. Clean topsoil shall be free of rocks, coarse fragments, gravel, sticks, trash, roots, debris over 3/4" and any substances harmful to plant growth. It also must be free of plants or plant parts of any noxious weeds. Topsoil shall contain 3 to 5 percent decomposed organic matter and a pH between 5.5 and 7.0.
- Seeded areas: to receive a settled minimum depth of 3" of blended, prepared and non-compacted topsoil. Landscape contractor is responsible for excavation and removal of unwanted material (gravel, debris, roots and other extraneous material harmful to plant growth) to the specified depth, supplementing with additional topsoil (if necessary) and the fine grading of all seeded areas.
- Tree planting (see planting detail): plant all trees slightly higher than finished grade at root flare. Remove excess soil from top of root ball, if needed. Scarify side walls of tree pit prior to installation. Remove and discard non-biodegradable burlap and wire cage (if applicable) from top one-third of rootball. Carefully bend remaining wire down to the bottom of hole once the tree has been placed into the hole and will no longer be moved. Score the remaining two-thirds of burlap and remove twine. Backfill pit with 75% existing soil removed from excavation and 25% compost blended prior to backfilling holes. Discard any gravel, heavy clay or stones. Avoid any air pockets and do not tamp soil down. When hole is two-thirds full, trees shall be watered thoroughly, and water left to soak in before proceeding.

Provide a 3" deep, 4 ft. diameter shredded hardwood bark mulch ring around all trees in lawn areas. Do not build up any mulch onto trunk of any tree. Trees that are installed incorrectly will be replaced at the time and expense of the landscape contractor. Trees too large for two people to lift in and out of holes, shall be placed with sling. Do not rock the trees in holes to raise them. Stake trees per detail and remove at the end of the one year warranty period.
- Mulching: all tree to receive a 3" deep layer of high-quality shredded hardwood bark mulch (not enviromulch or wood chips). Mulch shall be uniform in size, color, quality and overall appearance. Mulch shall be free of debris, large wood chunks, soil, rocks, weeds, invasive plant parts or seeds and any other material injurious to plant growth. Do not allow mulch to contact tree trunks.
- Compost shall be stable, and weed-free organic matter. It shall be resistant to further decomposition and free of compounds, such as ammonia and organic acids, in concentrations toxic to plant growth. The compost shall contain no pathogens or other chemical contaminants and meet the requirements of WisDNR S100 Compost Specification.
- Lawn installation for all seeded turfgrass areas: remove / kill off any existing unwanted vegetation prior to seeding. Prepare the topsoil and seed bed by removing all surface stones 1" or larger and grading lawn areas to finish grade. Apply a starter fertilizer and specified seed, to ensure good seed to soil contact, and provide mulch covering suitable to germinate and establish turf. Provide seed and fertilizer mix information to general contractor prior to installation. Erosion control measures are to be used in swales and on steep grades, where applicable. Methods of installation may vary at the discretion of the landscape contractor on his/her responsibility to establish and guarantee a smooth, uniform, quality turf. If straw mulch is used as a mulch covering, a tackifier may be necessary to avoid wind damage. Marsh hay containing reed canary grass is not acceptable as a mulch covering.

An acceptable quality turf is defined as having no more than 5% of the total area with bare spots larger than 1/2 square foot and uniform coverage throughout all turf areas.
- Seed mix for lawn areas - use only a premium quality seed mix. Premium blend seed mix (or equivalent): 50% blended bluegrass, 25% creeping red fescue, 25% perennial ryegrass applied at 5 lbs per 1,000 SF or at recommended rates from supplier. Provide seed specifications to general contractor prior to installation.
- Warranty and replacements: All trees shall be warranted by the landscape contractor to be in healthy and flourishing condition for a period of one calendar year after the date of acceptance. This assumes the owner performs required maintenance (i.e. regular watering) after the landscape contractor's maintenance period has been completed. Landscape contractor shall inform owner when required maintenance has concluded. Only one replacement per plant will be required during the warranty period, except for losses or replacements due to failure to comply with specified requirements. Replacements shall be plants of the same variety specified on the plan and closely match adjacent specimens in size.
- The landscape contractor is responsible for the watering and maintenance of all landscape areas at time of planting and throughout construction until the substantial completion of the installation and acceptance by the owner. This includes all trees and turf grass areas. Work also includes watering, fertilizing, trimming, mowing lawn areas and sweeping up grass clippings.
- Project completion: upon substantial completion of the project, the landscape contractor is responsible to conduct a final review with the owner's representative and the general contractor to answer questions and ensure that all specifications have been met. The landscape contractor is to provide watering and general ongoing maintenance instructions (in writing) for the new plantings and lawn to the owner and general contractor.

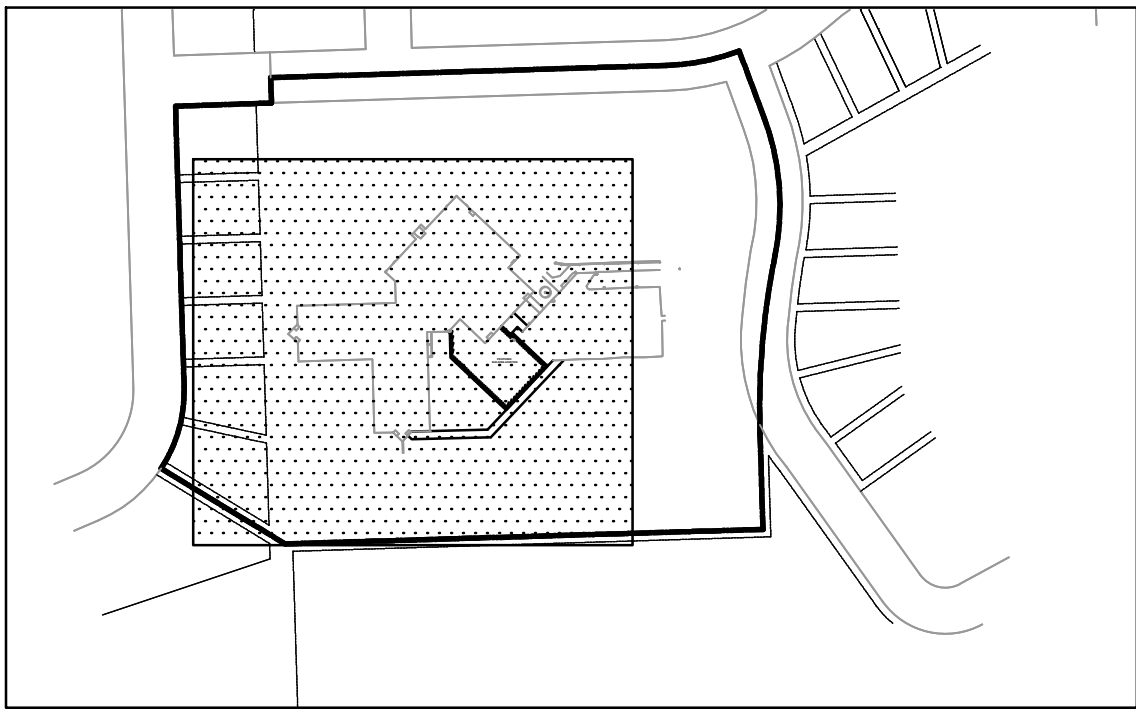

KEY MAP

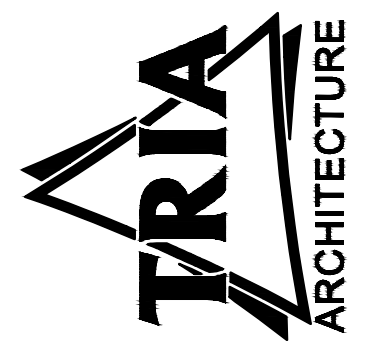

CIVIL CONSULTANT:
(P) 630.603.7171
STRUCTURAL CONSULTANT:
(P) 630.341.0549
(P) 630.351.0864
PEP CONSULTANT:
(P) 312.982.0560
reSmith
171 E. Douglas Road, Suite 208
Bolingbrook, Illinois 60440
Larson Engineering, Inc.
141 E. Douglas Road, Suite 208
Bolingbrook, Illinois 60440
PLANS ENGINEERING
(P) 312.982.0560
PREPARED FOR
(P) 312.982.0560

ORLAND SCHOOL DISTRICT 135
2023 ADDITIONS AND RENOVATIONS AT:
CENTENNIAL PRIMARY SCHOOL
14101 CREEK CROSSING DR, ORLAND PARK, IL 60462

PROJECT NUMBER	17-084
PROJECT NAME	TS
DESIGN BY	DJB
ISSUED FOR	XX/XX/XX
DATE	1/20/2023

LANDSCAPE PLAN



R.A.SMITH, INC. ASSUMES NO RESPONSIBILITY FOR DAMAGES, LIABILITY OR COSTS RESULTING FROM CHANGES OR ALTERATIONS MADE TO THIS PLAN WITHOUT THE EXPRESSED WRITTEN CONSENT OF R.A.SMITH, INC.
ALL COPYRIGHTS TO THESE DRAWINGS ARE RESERVED. THEY MAY NOT BE COPIED, CHANGED, OR ASSIGNED TO ANY THIRD PARTY IN ANY MANNER WITHOUT OBTAINING THE EXPRESSED WRITTEN PERMISSION OF R.A.SMITH, INC.

L1.00