



Orland Park Fire Training Facility

10730 163rd Place
Orland Park, IL.

L1 - LANDSCAPE PLAN
L2 - LANDSCAPE PLAN

D1 - PLANTING DETAIL & SPECS

For



BOARD APPROVED

Case No: 2009-0670

Date: 11-2-2009

W/Conditions:

W/Out Conditions:

VILLAGE OF ORLAND PARK
COOK / WILL COUNTY



CALL
JULIE
BEFORE YOU DIG

COVER

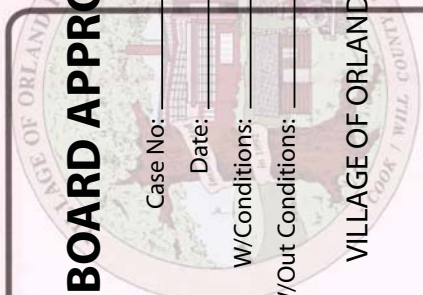

BOARD APPROVED

Case No: _____
 Date: _____
 W/Conditions: _____
 W/Out Conditions: _____

VILLAGE OF ORLAND PARK

Orland Park Fire Training Facility
 10730 163rd Place
 Orland Park, IL



Date: Aug 21, 2009
 Drawn By: Bucky Burrell
 Project No.: 09-B

DATE	DESCRIPTION
9-15-09	Changes by owner 1.
10-31-09	Changes from review 2.
10-14-09	Changes by owner 3.

Copyright 2009 Bary Landscaping, Inc.
 and all ideas contained herein are the
 sole property of Bary Landscaping, Inc.
 Reproduction of the design or concept
 without the consent of Bary
 Landscaping, Inc. is prohibited.

15001 West 159th Street
 Lockport, Illinois 60441
 815-838-4100
 815-838-3200

Sheet No. **L2** of **2**

Legend	QTY	BOTANICAL NAME	COMMON NAME	SIZE
17 Trees <i>All shade/overstory trees shall have a central leader</i>				
AcRS	4	Acer rubrum 'Red Sunset'	Maple, Red Sunset	2 1/2" cal
ALGL	4	Aulus glabrosa	Alder, European Black	2 1/2" cal
GLSKY	2	Gleditsia triacanthos inermis 'Skyline'	Honeylocust, Skyline	2 1/2" cal
PiAr	3	Pinus callignaya 'Aristocrat'	Pine, Aristocrat	2 1/2" cal
TGR	1	Tilia cordata 'Greenspire'	Linden, Greenspire	2 1/2" cal
LUCA	3	Limonium carolinianum 'Accolade'	Blm, Accolade	2 1/2" cal
100 Shrubs				
EuAC	9	Euconymus alatus compacta	Burning Bush, Dwarf	4"
FoSun	14	Forsythia x intermedia 'Sunrise'	Forsythia, Sunrise	36"
SpShw	8	Spiraea japonica 'Snowmound'	Spiraea, Snowmound	18"
VBM	12	Viburnum dentatum 'Blue Muffin'	Viburnum, Blue Muffin	4"
VDI	12	Viburnum plicatum	Viburnum, Doublefile	4"
VJu	12	Viburnum 'Judd'	Viburnum, Judd	4"
VMo	21	Viburnum lentago 'Mebican'	Viburnum, Mohican	4"
WeWR	12	Weigelia florida 'Wine & Roses'	Weigelia, Wine & Roses	24"
24 Evergreen Trees				
PcAb	10	Pinus strobus	Norway Spruce	8"
PcBH	4	Pinus glauca 'Dorset'	Spruce, Black Hills	8"
PcPu	5	Pinus colorata	Spruce, Colorado Blue	8"
PAI	2	Pinus nigra	Pine, Austrian	8"
PSI	3	Pinus strobus	Pine, Eastern White	8"
60 Evergreen Shrubs				
JuCPH	34	Juniperus chinensis compacta	Juniper, Compact Pfitzer	24"
ThTe	4	Thuja occidentalis 'Tobey'	Arbovitae, Tobey	4"
TxDn	6	Taxus x media 'Densiformis'	Yew, Densiformis	24"
20 Ornamental Grasses				
CaKF	20	Chamaecrista x acutiflora 'Karl Forester'	Grass, Feather Reed	1 gal
HDF	12	Hosta 'Francis'	Hosta Lily, Francisc	1 gal

Hardwood Mulch is to be a double processed premium product - 65 cu. yd. 2.
 Sod - 2852 yd sq. 3.

NOTES:

- All Plants To Be Mulched With Hardwood Mulch, Unless Specified Or Detailed Otherwise.
- Bed Edges To Be Spade Edged Where Not Outlined By Concrete.
- Tree Rings To Be 6" Diameter When The Tree Is Not In A Bed.
- Tree Staking Is At The Discretion Of The Contractor. The Trees Are To Stay Plumb During The Guarantee Period Per The Specs.
- Owner Is To Maintain Landscape Once Installed.



DRAFT
 For Village Review and Bidding
 Not for Construction

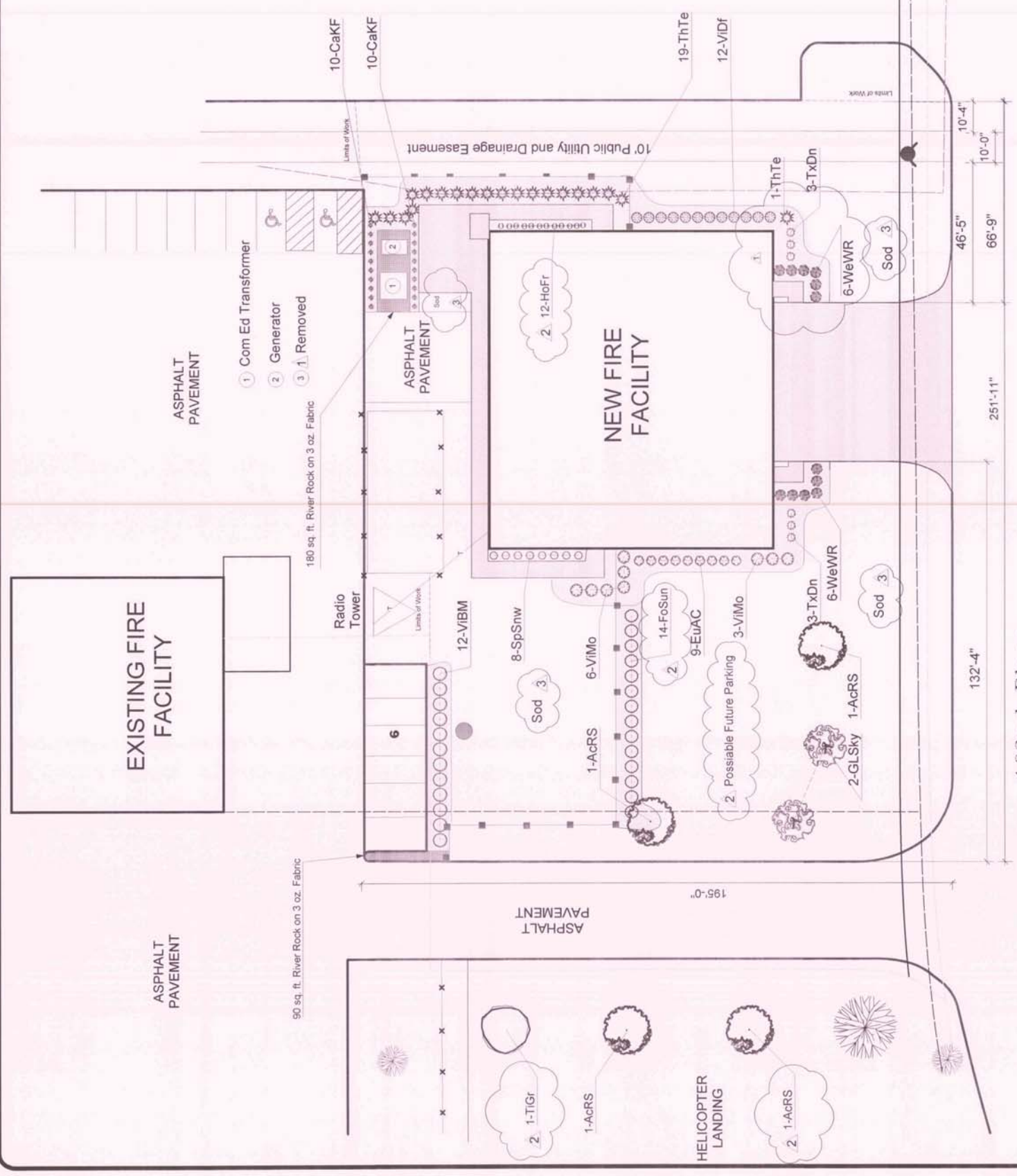

THE ORLAND PARK LANDSCAPE ORDINANCE REQUIREMENTS

Required Items	Provided Items
Parkway Trees 1 per 40' as noted in ord. 3199	3 Provided
163rd Place West of Drive 132' 3 needed	0 Provided - <12' for 40' distance less area for sight triangle - distance now less than 40'
163rd Place East of the Drive 1 needed	4 Provided on adjacent lot to not impede view when leaving the fire station. Noted by * on sheet L1
Site Development 38,850 Sq. Ft. - 3.8 trees needed per 305-15-11	None On Site To Preserve
Preserved Trees	None On Site To Preserve

LANDSCAPE SPECIFICATIONS

Site Conditions

It is the responsibility of the Landscape Contractor to locate all underground utilities and perform work in a manner which will avoid possible damage. Hand excavate, as required. J.U.L.I.E. or DIGGER is to be notified prior to excavation to locate joint member utilities.

Substitutions of plant material due only to lack of availability or hardness may be approved by the Landscape Architect. Adjustments of plant locations may be permitted as dictated by site conditions and approved by Owner with consultation of Landscape Architect.

All permits, if required, are to be secured by the Landscape Contractor. The Contractor is responsible for protecting all existing vegetation to be preserved.

Acceptance

Final acceptance will commence once the maintenance period has ended. Upon completion of the work, a review will be made by the landscape architect who will provide writing to the owner any deficiencies which will constitute the punch list. The landscape contractor is to satisfy this punch list prior to preliminary acceptance. Within ten (10) days the owner will provide written preliminary acceptance to the contractor, at which time the maintenance period will begin.

Final acceptance will be at the end of the maintenance period once the landscape contractor has submitted in writing that the maintenance period has ended. After the owner and landscape architect have reviewed the plant material and turf areas on site to determine that the plant material is healthy and thriving, sod is knitted to the soil, seed has established to at least 75% coverage and the irrigation system is functional and providing adequate water to all areas covered by heads. Within ten (10) days, written final acceptance will be provided to the landscape contractor.

Edging of Beds

Where mulch beds meet lawn areas, provide a sharp vertical spade edge unless otherwise noted.

Field Verification

The contractor is to verify all existing conditions and site deficiencies prior to bidding and make notations and exclusions on the bid for any inconsistencies. The drawings and symbols supercede any quantities provided by the landscape architect.

Grading

Fine grade lawn areas to smooth, even surface with loose, uniformly fine texture. Roll, rake, and drag lawn areas, remove ridges and fill depressions, as required to meet finish grades.

All lawn areas shall not be higher than adjacent paved surfaces in order to maintain positive surface drainage.

Planting berms, islands, and peninsulas to be graded as noted on the plan or detail. Any changes as dictated by site conditions and approved by Owner with consultation of Landscape Architect.

Guarantee

All plant material (excluding annual flowers) shall be guaranteed for one year after final acceptance.

Irrigation

After fine grading, irrigation system is to be installed. If any lawn areas have been damaged, the areas are to be restored to specified condition prior to installation. See additional specifications on the irrigation plan.

Lawn Preparation and Installation

Loosen subgrade of lawn areas to a maximum depth of 4 inches. Remove stones measuring over 3/4 inch. Remove sticks, roots, rubbish, and other extraneous matter. Limit preparation to areas which will be seeded, or sodded promptly after preparation.

Maintenance Period

There is no maintenance period on this project. Maintenance prior to acceptance is incidental to the contract and is not the start of the maintenance period.

Mulching Planting Beds

Mulched beds shall encompass all groups of plant material and be generous enough to permit ease of landscape maintenance. Mulch rings shall be a minimum 6" diameter for individual trees, evergreens and ornamental trees.

Mulch all plantings with a shredded hardwood bark mulch to a depth of 3" unless otherwise noted.

Ground cover shall be mulched with mushroom compost to a depth of 1" unless otherwise noted.

Perennial plants shall be mulched to a depth of 2" unless otherwise noted.

Plant Material Installation

The Landscape Architect may inspect trees and shrubs at site before planting, for compliance with requirements for genus, species, variety, size, and quality. Landscape Architect retains right to further inspect trees and shrubs for size and condition of balls and root systems, insects, injuries and latent defects, and to reject unsatisfactory or defective material at any time. The Village may reject any materials that are diseased, deformed, or otherwise not exhibiting superior quality. During progress of work tie trees or shrubs in such manner as to damage bark, break branches, or destroy natural shape. Do not drop balled and burlapped stock during delivery.

Plant trees and shrubs after final grades, are established and prior to planting of lawns. If planting of trees and occurs after lawn work, protect lawn areas and promptly repair damage to lawns resulting from planting operations.

Remove rejected trees or shrubs immediately from project site.

Provide freshly dug trees, evergreens and shrubs. Do not prune prior to delivery unless, otherwise approved by Architect. Do not bend or bind.

Provide healthy, vigorous nursery stock grown in recognized nursery in accordance with good horticultural practice and free of disease, insects, eggs, larvae, and defects.

Deliver plant material after preparations for planting have been completed and plant immediately. If planting is delayed more than 6 hours after delivery, set trees, evergreens and shrubs in shade, protect from weather and mechanical damage, and keep roots, moist by covering with mulch, burlap or other acceptable means of retaining moisture.

All plant material shall be balled and burlapped (B&B) unless otherwise noted on the plant list. Material quality and measurement should conform to the most recent edition of the American Standards for Nursery Stock, ANSIZ60 by the American Nursery and Landscape Association. Do not remove container grown stock from containers until planting time.

Plant handling and installation shall conform to accepted landscape practices. Protect all plants in leaf with acceptable coverings during transportation. All planting areas will require a topsoil mixture consisting of 1/4 topsoil, 1/2 mushroom compost and 1/4 sand. The groundcover beds shall have a 4" minimum of this mixture. Existing soil shall be removed.

Dig holes large enough to allow for root ball and backfill with planting soil. Work soil around ball to eliminate air pockets and leave a slight saucer indentation around plants to hold water. Water thoroughly after planting, taking care not to cover crowns of plants with wet soils. Prune broken or cross branching before planting. Do not remove tree leader, but prune and double leaders.

Staking of trees to be done on the approval of the Landscape Architect per the detail.

Seeding

Turf seed to be Cleasens Sunny Mix or a prior to planting approved equal. All seeding is to be covered at the end of the day to provide protection for the seed. Cover on flat areas or slopes of less than 10:1 can be Hydro Mulched at the rate of 2000 lb. per acre. Slopes up to 4:1 can be hydro mulched when tackifier is added at the applicable rate. S 75 straw blanket or a prior to planting approved equal can be used up to a 4:1 slope. Slopes of greater decline, the blanket is called out on the plans.

Sod

Time delivery so that sod will be placed within 24 hours after stripping. Protect sod against drying and breaking of rolled strips.

After a lawn section has been installed and rolled, watering shall commence immediately while installation continues on other sections of the job by the contractor.

Warranty

All work provided by the landscape contractor shall be free from defects of materials and workmanship for the period of one (1) year from the date of final acceptance of the project. Irrigation as a whole will also carry a one (1) year warranty including initial startup, blowout. Any plumbing provided for the irrigation contractor is to be warranted by the installing contractor.

Watering

Sodded turf areas are to be watered at the rate of twice a day during the first ten (10) days of establishment by the owner.

Once established, a minimum of one (1) inch is to be provided per week to maintain the growth.

Seeded areas to be watered to insure proper germination, once seeds have germinated, water may be decreased, but the seeded areas must not be allowed to dry out completely. Watering to continue for four (4) weeks after germination or until the grass has become sufficiently established to warrant watering on an as needed basis by the owner.

BOARD APPROVED

Case No: _____

Date: _____

W/Conditions: _____

W/Out Conditions: _____

VILLAGE OF ORLAND PARK

Landscaping Specifications and Details
Orland Park Fire Training Facility
10730 163rd Place
Orland Park, IL



Date: February 22, 2006
Drawn By: Buddy Burrill
Project No.: 06-071B

DATE	DESCRIPTION

Copyright 2007 Beary Landscaping, Inc.
All rights reserved. The design and any other material contained herein are the sole property of Beary Landscaping, Inc. Reproduction of the design or concept embodied herein in any form in whole or in part without the consent of Beary Landscaping, Inc. is prohibited.

15001 West 159th Street
Lockport, Illinois 60441
815-838-4100
815-838-3200
Fax: 815-838-3200



Sheet No.

D1 of 1

