



**VILLAGE OF  
ORLAND PARK  
RFP #24-014**

CPAC Modernization Project  
- Phase 1

June 6, 2024

# TABLE OF **CONTENTS**

---

**1. OPERATING HISTORY**

**2. PROJECT TEAM / QUALIFICATIONS**

**3. PROJECT EXPERIENCE**

**4. REFERENCES**

**5. PROPOSAL SUMMARY SHEET**

**6. CERTIFICATE OF COMPLIANCE**

**7. INSURANCE REQUIREMENTS**

**8. BID BOND**



# 1

## OPERATING HISTORY





## Company Introduction

### About The George Sollitt Construction Company (GSCC)

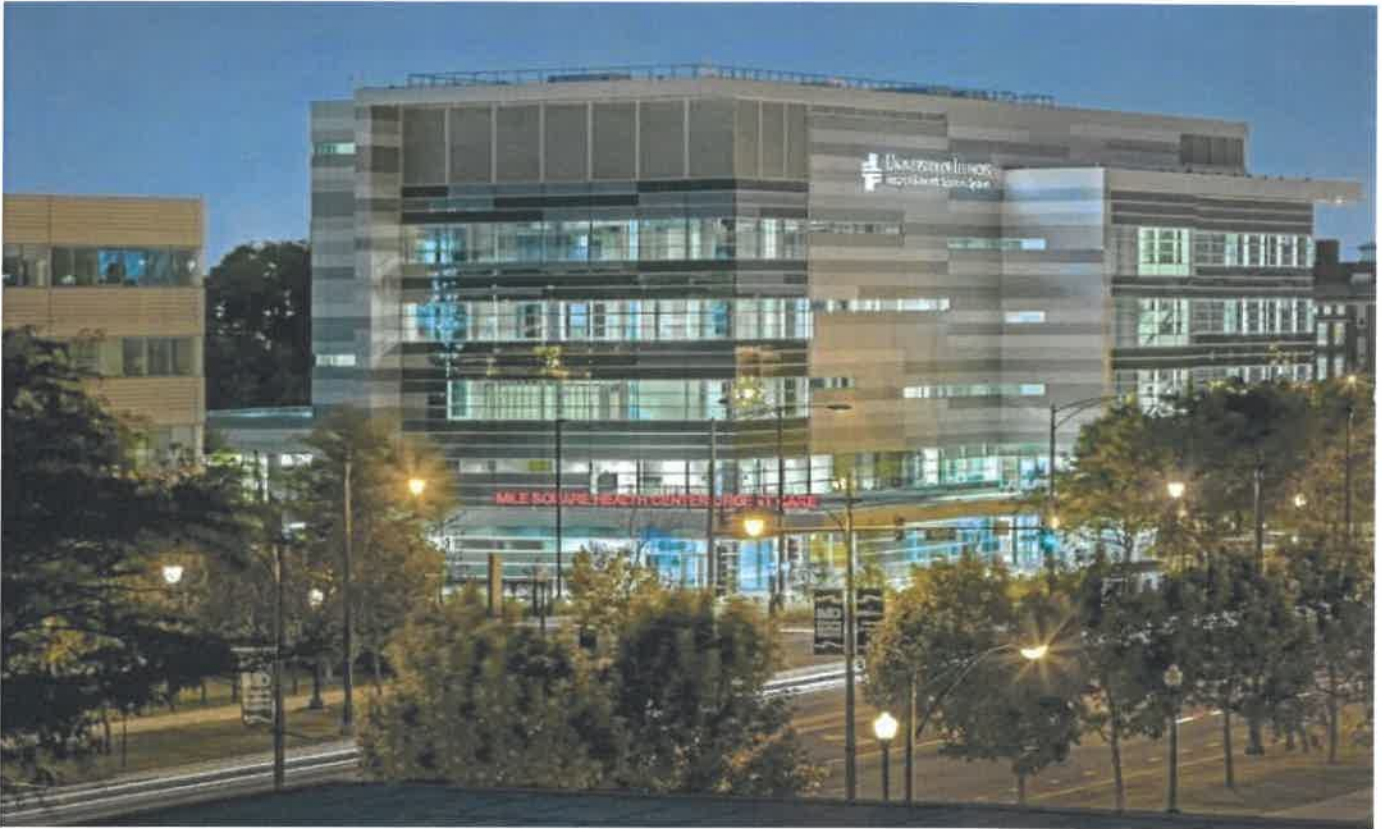

#### **In-House Capabilities**

- Preconstruction Consulting
- Construction Management
- General Contracting
- Design-Build
- LEED + Sustainable Construction
- Building Information Modeling

#### **Key Contact Person:**

Henry B. Ryan III, President  
The George Sollitt Construction Company  
185 Hansen Court, Suite 100  
Wood Dale, Illinois 60191  
Phone: (630) 860-7333, ext. 3945  
Email: hryan@sollitt.com

George Sollitt was a 6th generation relative of John Sollitt who began building in Chicago in 1838 and completed many notable projects including the Palmer House, Old Courthouse and Tremont House. The GSCC was incorporated in the state of Illinois in 1935. Today we are a company 100% wholly owned by the employees. We are like a family, so safety is of paramount importance to us along with honestly and efficiently building the vision our client's desire.

#### **Philosophy**

As an employee-owned company, our firm is built on people, desire, teamwork and client satisfaction. Our success is the result of our outstanding team of professionals, dedicated to meeting the demands of our clients in today's complex construction industry.

#### **Primary Area of Expertise**

The George Sollitt Construction Company is a full-service contractor providing a complete range of pre-construction and construction services related to General Contracting, Construction Management, Design/Build and LEED Construction.

Our primary areas of experience include Affordable Housing, Educational, Institutional, Municipal, Religious and Health Care construction Projects.

#### **Mission**

Our mission is to deliver high-quality projects to our clients on time, on budget, as specified. We will provide the resources and specialized services our clients demand with a professional staff ready to assist in all key disciplines.



# 2

## PROJECT TEAM / QUALIFICATIONS





**Michael Polacheck**  
Senior Project Manager, LEED AP  
The George Sollitt Construction Co.

**Project Role**  
Senior Project Manager



### About Mike

Mike has been with Sollitt for over 18 years. As a senior project manager, he comes with proven experience in successfully completing large scale and complex projects. His resume includes both new construction and renovation experience in the public and private sector. Mike demonstrates strong problem-solving skills in analyzing challenging issues and developing effective solutions.

He took the lead in managing the preconstruction and construction of (2) of our recent CM projects. Rosenwald Courts was an extremely challenging conversion of a historic landmark building that was in very poor condition. He provided preconstruction estimating, value engineering and final budget so the project could move forward.

Once Rosenwald Courts was under construction, significant structural deficiencies were discovered that required management control to define and complete restoration of the structural shell prior to construction moving forward. These unknown costs were managed and sequenced to allow construction to proceed and remain on schedule.

Mike completed a similar role on our Southside Recycling project, working with the owner and architect in design cost estimates, final budget, and construction. Through the project, Mike identified several V.E. items, buyout opportunities and construction savings that ultimately saved the owner over \$6M on a final GMP of \$44,755,000.

Mike also provided preconstruction and CM services for our Apostolic Faith Church project. Mike and his team were able to save over \$1.2M to the initial GMP contract which the owner used to enhance the space and provide additional scope.



Belmont Cragin Elementary School

### Professional Highlights

#### Education

BS - Industrial Technology/Construction Management Illinois State University

#### Training/Certifications

Chicagoland Contractors Safety Council - OSHA 30 Hr. Class  
US Army Corps of Engineers Construction Quality Management  
LEED 2.2 Accredited Professional Autodesk NavisWorks Level 1 (BIM) Certification  
Revit MEP Essentials Scaffold Use & Erection  
2hr Asbestos Awareness Training Mechanical Contractors Assoc.  
Commission Systems Certification  
American Concrete Institute Slab on Grad Certification

#### Relevant Experience

Public Building Commission of Chicago Back of the Yards High School  
Public Building Commission of Chicago Westinghouse High School  
Hanson Stadium UAF  
Historic Rosenwald Courts Apartments & Flats Renovation and Addition  
Southside Recycling Chicago (General Iron III)  
Apostolic Faith Church Renovations and Additions  
Historic Chicago Vocational Career Academy  
Public Building Commission of Chicago Belmont Cragin Elementary School  
Ricky Rockets Kankakee  
Chicago Public Schools Nixon Elementary School  
MWRD of Greater Chicago Westside Imhoff Battery A and Skimming Tank Demolition  
Joliet Junior College City Center  
Chicago Public Schools Brian Piccolo Specialty School  
Chicago Public Schools Bronzeville Classical School Renovation and Demolition  
Governor's State University - Cafeteria Renovation  
Public Building Commission of Chicago Adam Clayton Powell, Jr. Paideia Academy  
Public Building Commission of Chicago West Ridge Elementary School  
Public Building Commission of Chicago Tarkington Elementary School  
Cicero Public School District 99 Goodwin Elementary School  
Belvidere Elementary and High Schools  
City of Chicago Dept. of Water Management S. Water Purification Plant Renovation



Back of the Yards High School



Southside Recycling Chicago (General Iron III)

## Oscar Fuentes

Superintendent, The George Sollitt Construction Co.

## Project Role

Superintendent



### About Oscar

Oscar is a highly dependable & talented bilingual Foreman Carpenter & Assistant Superintendent with 30+ years of leadership in the construction industry. He has a sound knowledge of commercial and private construction procedures and regulations codes. Which includes scheduling, collaborating with the owner and design team, directing field activities, quickly reviewing submittals, and making informed decisions. Oscar demonstrates daily his ability to maintain the safety and quality of a project while striving to maintain the project on schedule. He provides a great depth of experience in overseeing jobsites from start to finish.

### Professional Highlights

#### Training/Certifications

Sollitt Safety Training Program  
Chicagoland Contractors Safety Council – OSHA 30 Hour  
Collaborative Leadership Program  
Chicagoland (AGC) Construction Supervision Fundamentals, Fire Stop, Lead Safety for Renovation Repair

#### Education

Carpenter Apprenticeship School  
Elk Grove Village, IL

#### Relevant Experience

Ridge Park Fieldhouse Renovation Chicago Park District  
Ricky Rockets Buffalo Grove  
College of Lake County Student Services & Adult Education Center  
Chicago Public Schools Daniel C. Beard Elementary School Renovation  
Chicago Public Schools Adlai Stevenson Elementary School New Pre-K Annex  
Recycling Chicago (General Iron III)  
M-5 IL Tollway Maintenance Facility  
Public Building Commission of Chicago John Merlo Branch Library  
Ricky Rockets South Elgin  
Public Building Commission of Chicago Louis A. Agassiz



Ricky Rockets Buffalo Grove



Daniel C. Beard Elementary School Renovation



Adlai Stevenson Elementary School New Pre-K Annex



**3**

**PROJECT EXPERIENCE**





# McGuane Park Fieldhouse Renovation

Chicago, IL | Owner: Chicago Park District

## Renovation and Site Improvements



The McGuane Park Fieldhouse Renovation project consisted of interior and exterior improvements of an existing 2-story park district fieldhouse.

The project featured a full interior renovation of the building lobby and rotunda portion, a new elevator addition, interior renovation of the second floor and minor interior finishes and equipment changes in the gymnasium and swimming pool areas.

New lighting and MEP systems were installed including a new roof top unit for the 2nd floor and new switch-gear for the building.

Exterior and site work included exterior door and curtain wall systems, a new elevator structure, entryway canopies at the main lobby, parking lot underground utilities and resurfacing, trash enclosure, spray pool feature area, concrete walkways and landscaping.

The new elevator structure was constructed of cold-formed metal framing and rainscreen panels. The main library and rotunda area features new large, round light fixtures over solid surface bench seating.

The new steel canopies at the main lobby entrances are filled with illuminated, colored glass that dazzle in the evenings.



Reference:  
Chicago Park District  
Dept. of Procurement  
Mr. Stephen Grant  
(312) 742-4649

RADA Architects  
Mr. William Sitton  
Principal  
(312) 856-1970

Initial Cost: \$4,758,950  
Final Cost: \$4,800,130 (Owner Initiated CO)  
Project Start: October 2019  
Substantial Completion: January 2021



# Belmont Cragin Elementary School

Chicago, IL | Owner: Chicago Public Schools

## Elementary School

Sollitt was awarded the new Belmont-Cragin Elementary School and Early Childhood Center project located at 6112 W. Fullerton Ave., Chicago, IL. This project consisted of renovating and constructing an 83,000sf, three-story, steel frame and masonry CPS L-shaped prototype design to serve a diverse community of 500+ Pre-K through 8<sup>th</sup> grade students.

The school sits at the southeastern corner of Riis Park. Uniquely, the school connects to the existing, historical Riis Park Fieldhouse so the school and Park District can jointly use the gymnasium and provide shared space for after-school activity use for the school and Park District functions.

Belmont Cragin has two wings, they comprise of general classrooms and naturally lit library space with day-lighting controls, custom built-in seating and quiet reading spaces, cafetorium, gymnasium and a state-of-the-art state & rigging system for assemblies, plays and after school activities. There are specialty classrooms that focus on early education, STEM, science, art, music, choir and special education.

### References:

Owner: Public Building Commission of Chicago  
Paulo Hernandez  
(312) 216-7248

Architect: SMNG A Ltd.  
Marion Lawson  
(312) 829-3355

Initial Cost: \$34M  
Final Cost \$33,525,142  
July 2021 – November 2022







**Public Building Commission of Chicago  
Back of the Yards High School  
Chicago, Illinois  
(Seeking LEED Silver)  
Sollitt / Brown & Momen Joint Venture**

**Chicago Public School  
Back of the Yards High School  
Chicago, Illinois**

Original Contract Amount:  
\$63,822,440

Final Contract Amount:  
\$63,357,369

Change Order Amount: \$465,070.15  
(Owner Initiated)

Architects Completion:  
December 2014

Substantial Completion:  
December 2014

Final Completion:  
December 2015

Square Footage: 215,000

Students: 1200

Duration: 23 months

Architect of Record:  
Ms. Tracy Salvia - Principal  
STL Architects, Inc.

Contract Type: General Contractor  
Lump Sum

Owner Reference:  
Mr. Ray Giderof  
Public Building Commission of  
Chicago  
(312) 744-8310

Project Team:  
Project Executive: Jamie Rahn  
Project Manager: Mike Polacheck  
Asst. PM: Ashlee Dameron  
Superintendent: Al Lindstrom

The new Back of the Yards High School is located at 2111 West 47th Street, Chicago, Illinois. This project will implement the new CPS Urban Model High School (UMHS) prototypical design to serve 1200 students.

This 212,285 SF, three floors plus lower level, steel frame and masonry construction building will include music, art, and athletic functions.

Chicago Building Congress has awarded BOTYHS the 2014, 1st place Merit Award for New Construction in Chicago over \$55 million.

The MBE/WBE goals of 25/4 were exceeded with the achievement of 35/6. Scheduled to receive Silver level certification, the team efforts resulted in a Gold level LEED for schools certification.

**School Includes:**

- Handicapped ramp
- Observation deck with stadium seating
- Locker rooms and coaches offices
- Water polo
- Custom teak benches
- Custom SS column enclosures
- Full aquatic center and pool
- Full Astro turf soccer and football stadium
- First time use of a unitized window system in the CPS Program
- City of Chicago Library was incorporated into the school midway through the project
- Stage and theater with state of the art sound system with retractable auditorium seating for multiuse purpose



4

REFERENCES

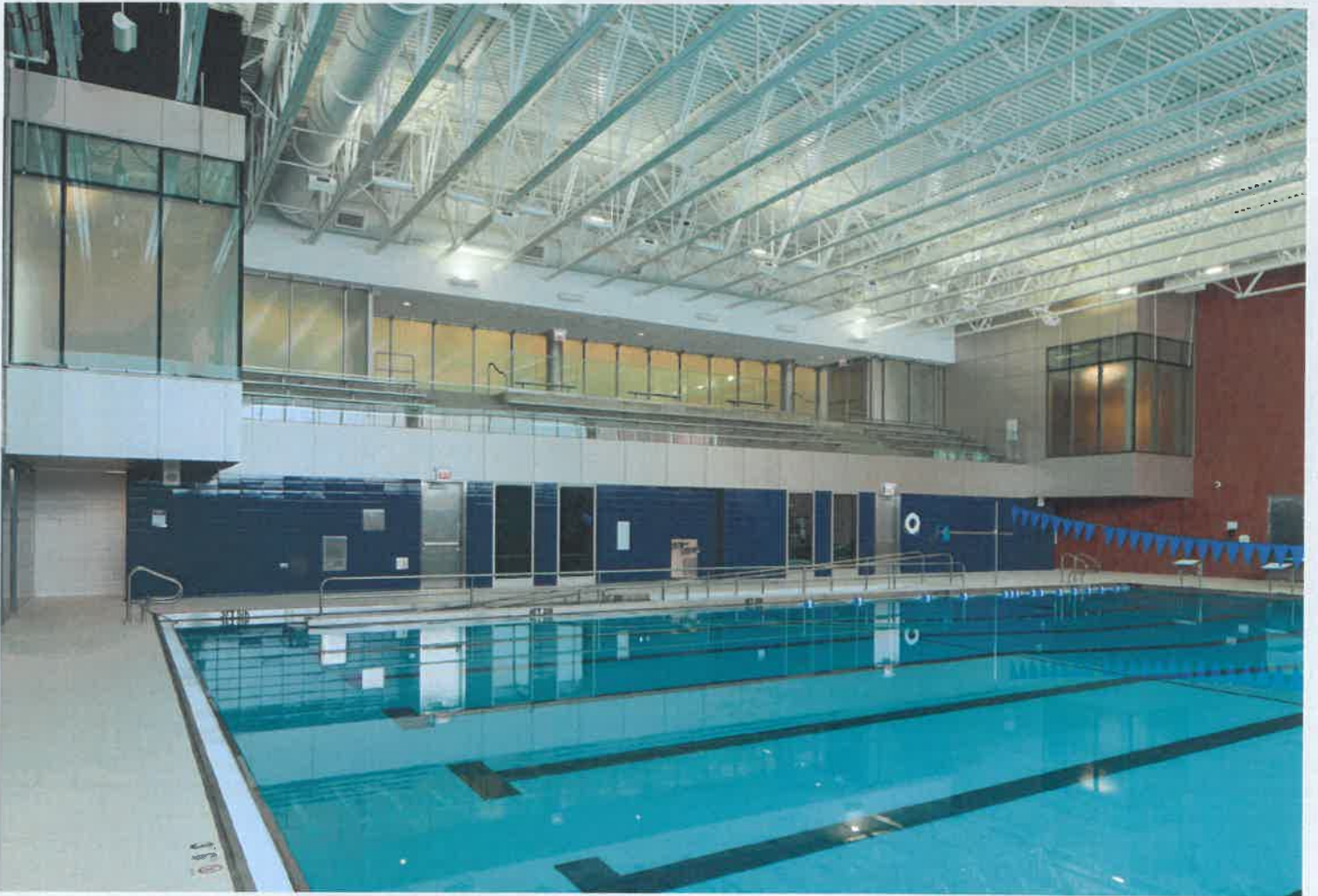



## REFERENCES

Provide three (3) references for which your organization has performed similar work.

Proposer's Name: The George Sollitt Construction Company  
(Enter Name of Business Organization)

1. ORGANIZATION SEE ATTACHED REFERENCES SHEETS  
ADDRESS \_\_\_\_\_  
PHONE NUMBER \_\_\_\_\_  
CONTACT PERSON \_\_\_\_\_  
YEAR OF PROJECT \_\_\_\_\_
  
2. ORGANIZATION \_\_\_\_\_  
ADDRESS \_\_\_\_\_  
PHONE NUMBER \_\_\_\_\_  
CONTACT PERSON \_\_\_\_\_  
YEAR OF PROJECT \_\_\_\_\_
  
3. ORGANIZATION \_\_\_\_\_  
ADDRESS \_\_\_\_\_  
PHONE NUMBER \_\_\_\_\_  
CONTACT PERSON \_\_\_\_\_  
YEAR OF PROJECT \_\_\_\_\_

## References



<u>Name and Location of Project</u>	<u>Owner</u>	<u>Owner Reference</u>	<u>Date Complete</u>
<b>CPS Hibbard ROF</b> Renovation Chicago, IL	Chicago Public Schools	Mike Natarus 773.824.6349	In Progress
<b>CPS Warehouse</b> Renovation Chicago, IL	Chicago Public Schools	Jeff Havel 630.335.2567	In Progress
<b>M-5 Maintenance Facility</b> New Construction Hoffman Estates, IL	Illinois State Toll Highway Authority	William Doyle 773.892.7414	2024
<b>Belmont Cragin Elementary School</b> Renovation/Addition Chicago, IL	Public Building Commission of Chicago	Paulo Hernandez 312.216.7248	2023
<b>Nixon Elementary School</b> Renovation/Addition Chicago, IL	Chicago Public Schools	Frank Annunzio 773.457.5124	2023
<b>Salt Dome Replacement Facility</b> Renovation/Addition Chicago, IL	Public Building Commission of Chicago	Karina Aguilar 312.622.2997	2023
<b>CPS Daniel C. Beard Elementary School</b> Renovation/Addition Chicago, IL	Chicago Public School	Scott Sutton 312.771.1873	2023
<b>Metropolitan Water Reclamation District</b> Stickney New Mechanical Mixers Stickney, IL	Metropolitan Water Reclamation District	Colin Devit 708.714.4743	2023
<b>College of Lake County</b> New Construction Waukegan, IL	Illinois Capital Development Board	Mark Jones 312.898.6995	2023
<b>Ricky Rockets - Buffalo Grove</b> New Construction Buffalo Grove, IL	Heidner Properties	Eric Grabowski 331.452.2575	2023
<b>M-16 Maintenance Facility and Site Improvements</b> New Construction Bensenville, IL	Illinois State Toll Highway Authority	William Doyle 773.892.7414	2023
<b>CPS Farragut SIT</b> Site Renovation Chicago, IL	Chicago Public Schools	Mayra Vega 312.504.3645	2023
<b>CPS Onahan ROF</b> Renovation Chicago, IL	Chicago Public Schools	Mike Natarus 773.824.6349	2023
<b>Ricky Rockets - Hickory Hills</b> New Construction Buffalo Grove, IL	Heidner Properties	Eric Grabowski 331.452.2575	2021





## References

<u>Name and Location of Project</u>	<u>Owner</u>	<u>Owner Reference</u>	<u>Date Complete</u>
<b>Adlai Stevenson Elementary School Pre-K Annex</b> Renovation Chicago, IL	Chicago Public Schools	Arun Kumar 312.450.5998	2021
<b>General Iron III</b> New Construction Chicago, IL	Reserve Management Group	Hal Tolin 773.491.3153	2021
<b>Prussing Elementary School</b> New Construction Chicago, IL	Public Building Commission of Chicago	LeRoy Stewart 773.766.1644	2021
<b>Merlo Branch Library</b> Renovation Chicago, IL	Public Building Commission of Chicago	Karina Aguilar 312.622.2997	2021
<b>McGuane Park Field House</b> Renovation Chicago, IL	Chicago Park District	Stephen Grant 312.742.4649	2021
<b>Governor's State Cafeteria Renovation</b> University Park, IL	Governor's State University	James Zumerchik 708.235.7451	2021
<b>Brian Piccolo Elementary Specialty School</b> Renovation Chicago, IL	Chicago Public Schools	Frank Annunzio 773.457.5124	2020
<b>IDOT Dan Ryan Field Office</b> Renovation Chicago, IL	Illinois Capital Development Board	Darnell Barnes 312.519.5476	2020
<b>Nicholas Senn High School</b> Renovation Chicago, IL	Chicago Public Schools	Scott Sutton 312.771.1873	2020



## References

<u>Name and Location of Project</u>	<u>Owner</u>	<u>Owner Reference</u>	<u>Date Complete</u>
<b>St. Joseph's School</b> Addition/Renovation Downers Grove, IL	Diocese of Joliet	Christopher Nye <a href="mailto:cnye@dioceseofjoliet.org">cnye@dioceseofjoliet.org</a>	2020
<b>Roquette R&amp;D Facility</b> Renovation Geneva, IL	Roquette America, Inc.	Mark Rector 319.524.5757	2020
<b>O'Hare Deicing Message Boards</b> Renovation Chicago, IL	Chicago Voice & Data Authority	John Beran 847.878.5023	2020
<b>Louis Agassiz Elementary School</b> Renovation Chicago, IL	Chicago Public Schools	Thomas Arey 773.571.2718	2019
<b>Dore Elementary School</b> New Construction Chicago, IL	Public Building Commission of Chicago	Karina Aguilar 312.622.2997	2019

**5**

**PROPOSAL SUMMARY SHEET**





**PROPOSER SUMMARY SHEET**  
**RFP #24-014**  
**CPAC Modernization Project – Phase 1**

Business Name: The George Sollitt Construction Company  
Street Address: 185 Hansen Court, Suite 100  
City, State, Zip: Wood Dale, Illinois 60191  
Contact Name: Henry B. Ryan III  
Title: President  
Phone: 630-860-7333 Fax: 630-860-7347  
E-Mail address: hryan@sollitt.com

**Price Proposal**

BASE BID PRICE Must include all Allowances in Section 012100	\$ <u>2,165,000<sup>00</sup></u>
ALTERNATE #1 PRICE	\$ <u>278,700<sup>00</sup></u>
GRAND TOTAL PROPOSAL PRICE	\$ <u>2,443,700<sup>00</sup></u>

**AUTHORIZATION & SIGNATURE**

Name of Authorized Signee: Henry B. Ryan III  
Signature of Authorized Signee:   
Title: President Date: May 29, 2024



THE GEORGE SOLLITT CONSTRUCTION COMPANY

GENERAL CONTRACTORS

CONSTRUCTION MANAGERS

June 6, 2024

Village of Orland Park
Orland Park, Cook County, Illinois

Reference: RFP #24-014 – CPAC Modernization Project – Phase 1

Subject: Addenda Acknowledgement

To Whom It May Concern:

This letter is to confirm The George Sollitt Construction Company is in receipt of the following addenda for the above referenced project.

- Addendum No. 1 dated May 30, 2024.
• Addendum No. 2 dated June 4, 2024.
•
•
•
•

Very truly yours,
THE GEORGE SOLLITT CONSTRUCTION COMPANY

By [Signature]
Henry B. Ryan III, President



6

CERTIFICATE OF COMPLIANCE



 **ORLAND PARK**  
**CERTIFICATE OF COMPLIANCE**

*Proposals shall complete this Certificate of Compliance. Failure to comply with all submission requirements may result in a determination that the Proposals is not responsible.*

The undersigned Henry B. Ryan III,  
(Enter Name of Person Making Certification)

as President  
(Enter Title of Person Making Certification)

and on behalf of The George Sollitt Construction Company,  
(Enter Name of Business Organization)

certifies that Proposers is:

1) **A BUSINESS ORGANIZATION:** Yes [] No [ ]

Federal Employer I.D. #: 36-1795790  
(or Social Security # if a sole proprietor or individual)

The form of business organization of the Proposer is (check one):

- Sole Proprietor
- Independent Contractor (Individual)
- Partnership
- LLC
- Corporation Illinois April 27, 1935  
(State of Incorporation) (Date of Incorporation)

2) **STATUS OF OWNERSHIP**

Illinois Public Act 102-0265, approved August 2021, requires the Village of Orland Park to collect "Status of Ownership" information. This information is collected for reporting purposes only. Please check the following that applies to the ownership of your business and include any certifications for the categories checked with the proposal. Business ownership categories are as defined in the Business Enterprise for Minorities, Women, and Persons with Disabilities Act, 30 ILCS 575/0.01 *et seq.*

- Minority-Owned [ ]
- Women-Owned [ ]
- Veteran-Owned [ ]
- Disabled-Owned [ ]
- Small Business [ ] ([SBA standards](#))
- Prefer not to disclose [ ]
- Not Applicable []

How are you certifying? Certificates Attached [ ] Self-Certifying [ ]



**STATUS OF OWNERSHIP FOR SUBCONTRACTORS**

This information is collected for reporting purposes only. Please check the following that applies to the ownership of subcontractors.

Minority-Owned [ ]                      Small Business [ ] ([SBA standards](#))  
Women-Owned [ ]                      Prefer not to disclose [X] Unknown at this time  
Veteran-Owned [ ]                      Not Applicable [ ]  
Disabled-Owned [ ]

**3) AUTHORIZED TO DO BUSINESS IN ILLINOIS: Yes [X] No [ ]**

The Proposer is authorized to do business in the State of Illinois.

**4) ELIGIBLE TO ENTER INTO PUBLIC CONTRACTS: Yes [X] No [ ]**

The Proposer is eligible to enter into public contracts, and is not barred from contracting with any unit of state or local government as a result of a violation of either Section 33E-3, or 33E-4 of the Illinois Criminal Code, or of any similar offense of "bid-rigging" or "bid-rotating" of any state or of the United States.

**5) SEXUAL HARASSMENT POLICY COMPLIANT: Yes [X] No [ ]**

Please be advised that Public Act 87-1257, effective July 1, 1993, 775 ILCS 5/2-105 (A) has been amended to provide that every party to a public contract must have a written sexual harassment policy in place in full compliance with 775 ILCS 5/2-105 (A) (4) and includes, at a minimum, the following information:

(I) the illegality of sexual harassment; (II) the definition of sexual harassment under State law; (III) a description of sexual harassment, utilizing examples; (IV) the vendor's internal complaint process including penalties; (V) the legal recourse, investigative and complaint process available through the Department of Human Rights (the "Department") and the Human Rights Commission (the "Commission"); (VI) directions on how to contact the Department and Commission; and (VII) protection against retaliation as provided by Section 6-101 of the Act. (Illinois Human Rights Act). (emphasis added). Pursuant to 775 ILCS 5/1-103 (M) (2002), a "public contract" includes "...every contract to which the State, any of its political subdivisions or any municipal corporation is a party."

**6) EQUAL EMPLOYMENT OPPORTUNITY COMPLIANT: Yes [X] No [ ]**

During the performance of this Project, Proposer agrees to comply with the "Illinois Human Rights Act", 775 ILCS Title 5 and the Rules and Regulations of the Illinois Department of Human Rights published at 44 Illinois Administrative Code Section 750, et seq.

The Proposer shall:

(I) not discriminate against any employee or applicant for employment because of race, color,

religion, sex, marital status, national origin or ancestry, age, or physical or mental handicap unrelated to ability, or an unfavorable discharge from military service; (II) examine all job classifications to determine if minority persons or women are underutilized and will take appropriate affirmative action to rectify any such underutilization; (III) ensure all solicitations or advertisements for employees placed by it or on its behalf, it will state that all applicants will be afforded equal opportunity without discrimination because of race, color, religion, sex, marital status, national origin or ancestry, age, or physical or mental handicap unrelated to ability, or an unfavorable discharge from military service; (IV) send to each labor organization or representative of workers with which it has or is bound by a collective bargaining or other agreement or understanding, a notice advising such labor organization or representative of the Vendor's obligations under the Illinois Human Rights Act and Department's Rules and Regulations for Public Contract; (V) submit reports as required by the Department's Rules and Regulations for Public Contracts, furnish all relevant information as may from time to time be requested by the Department or the contracting agency, and in all respects comply with the Illinois Human Rights Act and Department's Rules and Regulations for Public Contracts; (VI) permit access to all relevant books, records, accounts and work sites by personnel of the contracting agency and Department for purposes of investigation to ascertain compliance with the Illinois Human Rights Act and Department's Rules and Regulations for Public Contracts; and (VII) include verbatim or by reference the provisions of this Equal Employment Opportunity Clause in every subcontract it awards under which any portion of this Agreement obligations are undertaken or assumed, so that such provisions will be binding upon such subcontractor.

In the same manner as the other provisions of this Agreement, the Proposer will be liable for compliance with applicable provisions of this clause by such subcontractors; and further it will promptly notify the contracting agency and the Department in the event any subcontractor fails or refuses to comply therewith. In addition, the Proposer will not utilize any subcontractor declared by the Illinois Human Rights Department to be ineligible for contracts or subcontracts with the State of Illinois or any of its political subdivisions or municipal corporations.

"Subcontract" means any agreement, arrangement or understanding, written or otherwise, between the Proposer and any person under which any portion of the Proposer's obligations under one or more public contracts is performed, undertaken or assumed; the term "subcontract", however, shall not include any agreement, arrangement or understanding in which the parties stand in the relationship of an employer and an employee, or between a Proposer or other organization and its customers.

In the event of the Proposer's noncompliance with any provision of this Equal Employment Opportunity Clause, the Illinois Human Right Act, or the Rules and Regulations for Public Contracts of the Department of Human Rights the Proposer may be declared non-responsible and therefore ineligible for future contracts or subcontracts with the State of Illinois or any of its political subdivisions or municipal corporations, and this agreement may be canceled or avoided in whole or in part, and such other sanctions or penalties may be imposed or remedies involved as provided by statute or regulation.

7) **PREVAILING WAGE COMPLIANCE:**      Yes     No

In the manner and to the extent required by law, this RFP is subject to the Illinois Prevailing Wage Act and to all laws governing the payment of wages to laborers, workers and mechanics of a Proposer or any subcontractor of a Proposer bound to this agreement who is performing services covered by this contract. If awarded the Contract, per 820 ILCS 130 et seq. as



amended, Proposer shall pay not less than the prevailing hourly rate of wages, the generally prevailing rate of hourly wages for legal holiday and overtime work, and the prevailing hourly rate for welfare and other benefits as determined by the Illinois Department of Labor or the Village and as set forth in the schedule of prevailing wages for this contract to all laborers, workers and mechanics performing work under this contract (available at <https://www2.illinois.gov/idol/Laws-Rules/CONMED/Pages/Rates.aspx>).

The undersigned Proposer further stipulates and certifies that it has maintained a satisfactory record of Prevailing Wage Act compliance with no significant Prevailing Wage Act violations for the past three (3) years.

**Certified Payroll.** The Illinois Prevailing Wage Act requires any contractor and each subcontractor who participates in public works to file with the Illinois Department of Labor (IDOL) certified payroll for those calendar months during which work on a public works project has occurred. The Act requires certified payroll to be filed with IDOL no later than the 15th day of each calendar month for the immediately preceding month through the Illinois Prevailing Wage Portal—an electronic database IDOL has established for collecting and retaining certified payroll. The Portal may be accessed using this link: <https://www2.illinois.gov/idol/Laws-Rules/CONMED/Pages/certifiedtranscriptofpayroll.aspx>. The Village reserves the right to withhold payment due to Contractor until Contractor and its subcontractors display compliance with this provision of the Act.

**8) PARTICIPATION IN APPRENTICESHIP AND TRAINING PROGRAM:      Yes     No**

Proposer participates in apprenticeship and training programs applicable to the work to be performed on the project, which are approved by and registered with the United States Department of Labor’s Office of Apprenticeship.

**Name of A&T Program:** Various - See attached certificates

**Brief Description of Program:** Training between Union and its signatory members to create and maintain safe, productive and well-educated laborers, carpenters, etc.

---

---

---

---

**9) TAX COMPLIANT:    Yes     No**

Proposer is current in the payment of any tax administered by the Illinois Department of Revenue, or if it is not: (a) it is contesting its liability for the tax or the amount of tax in accordance with procedures established by the appropriate Revenue Act; or (b) it has entered into an agreement with the Department of Revenue for payment of all taxes due and is currently in compliance with that agreement.

**AUTHORIZATION & SIGNATURE:**

I certify that I am authorized to execute this Certificate of Compliance on behalf of the Proposer set forth on the Proposer Summary Sheet, that I have personal knowledge of all the information set forth herein and that all statements, representations, that the proposal is genuine and not collusive, and information provided in or with this Certificate are true and accurate.

The undersigned, having become familiar with the Project specified in this RFP, proposes to provide and furnish all of the labor, materials, necessary tools, expendable equipment and all utility and transportation services necessary to perform and complete in a workmanlike manner all of the work required for the Project.

**ACKNOWLEDGED AND AGREED TO:**

  
\_\_\_\_\_  
Signature of Authorized Officer

Henry B. Ryan III  
Name of Authorized Officer

President  
Title

June 6, 2024  
Date

United States Department of Labor  
Office of Apprenticeship Training, Employer and Labor Services  
Bureau of Apprenticeship and Training

Certificate of Registration

Chicagoand Laborers' J.A.T.C.

Carol Stream, Illinois

For the Trade - Construction Craft Laborer

Registered as part of the National Apprenticeship Program

in accordance with the basic standards of apprenticeship

established by the Secretary of Labor



April 12, 1999

Date REVISED August 13, 2004

IL017990001

Registration No.

*Loi. Chao*

Secretary of Labor

*Anthony Sauer*

Administrator, Apprenticeship Training, Employer and Labor Services



# The United States Department of Labor



## Bureau of Apprenticeship and Training Certificate of Registration

CEMENT MASONS' AREA JOINT APPRENTICESHIP & CEMENT MASONS UNION LOC. NO. 502  
BELLWOOD, ILLINOIS

FOR THE TRADE OF: CEMENT MASON

*Registered as part of the National Apprenticeship Program  
in accordance with the basic standards of apprenticeship  
established by the Secretary of Labor*

REGISTERED: OCTOBER 17, 1945  
REVISED: DECEMBER 29, 1988

*Date*

*Alan McLaughlin*

Secretary of Labor

*James D. Van Ede*

Director, Bureau of Apprenticeship and Training

008-0816

Registration No.

# The United States Department of Labor

## Office of Apprenticeship

### Certificate of Registration of Apprenticeship Program Illinois District Council No. 1 Bricklayers D.C.T.C.

Addison, Illinois

For the Trades of - Bricklayer, Marble Setter, Marble Finisher, Plasterer, Stonemason,  
Pointer-Cleaner-Caulker, Terrazzo Finisher, Terrazzo Worker, Tile Setter,  
& Tile Finisher

*Registered as part of the National Apprenticeship System  
in accordance with the basic standards of apprenticeship  
established by the Secretary of Labor*

May 30, 2003

Revised: May 25, 2010

IL015030003

Registration No.



*Abelardo J. Solis*  
Secretary of Labor

*Ad V. Ladd*  
Administrator, Office of Apprenticeship

The United States Department of Labor

Office of Apprenticeship  
Certificate of Registration of Apprenticeship Program

*Journeyman Plasterers JATC Local #5  
Alsip, Illinois*

*For the Trade of - Plasterer*

*Registered as part of the National Apprenticeship System  
in accordance with the basic standards of apprenticeship  
established by the Secretary of Labor*

*January 29, 1946*

*Date Revised September, 2009*

*IL015460004*

*Registration No.*



*Helda F. Solis*  
*Secretary of Labor*

*Ann V. Ladd*  
*Administrator, Office of Apprenticeship*



The United States Department of Labor

Office of Apprenticeship

Certificate of Registration of Apprenticeship Program

*Ironworkers Local #1  
Forest Park, Illinois  
For the Trade - Structural Steel / Iron Worker*

*Registered as part of the National Apprenticeship System  
in accordance with the basic standards of apprenticeship  
established by the Secretary of Labor*



*S. F. Chao*  
Secretary of Labor

*Anthony Suroso*  
Administrator, Office of Apprenticeship

September 9, 1953

REvised January 16, 2006

IL008-530001

Registration No.

United States Department of Labor

Office of Apprenticeship Training, Employer and Labor Services

Bureau of Apprenticeship and Training

Certificate of Registration

Sheet Metal Workers Local #1 North JATC

LaSalle, Illinois

For the Trade -- Sheet Metal Worker

Registered as part of the National Apprenticeship Program

in accordance with the basic standards of apprenticeship

established by the Secretary of Labor

February 14, 1990

Date Revised August 2, 2007

IL007900001

Registration No.

Lois Cheo

Secretary of Labor

Anthony Swanson

Administrator, Apprenticeship Training, Employer and Labor Services

# United States Department of Labor

Office of Apprenticeship Training, Employer and Labor Services  
Bureau of Apprenticeship and Training

Certificate of Registration

Operating Engineers Local #150

Mainfield, Illinois

For the Trade of Operating Engineer

Registered as part of the National Apprenticeship Program

in accordance with the basic standards of apprenticeship

established by the Secretary of Labor

November 5, 2002

Date

2E 008780173

Registration No.



*Shof. Chao*

Secretary of Labor

*Anthony Suvosa*

Manufacturing Apprenticeship Training, Employer and Labor Services



The United States Department of Labor



Bureau of Apprenticeship and Training  
Certificate of Registration

CHICAGO & NORTHEAST ILLINOIS DISTRICT COUNCIL OF CARPENTERS  
ELK GROVE VILLAGE, ILLINOIS

FOR THE TRADES OF: CARPENTER - LATHER

*Registered as part of the National Apprenticeship Program  
in accordance with the basic standards of apprenticeship  
established by the Secretary of Labor*

AUGUST 30, 1965

REVISED: MARCH 16, 1989

017-0557  
Registration No.

*Ann McLaughlin*

Secretary of Labor

*James D. Van Eick*

Director, Bureau of Apprenticeship and Training

United States Department of Labor

Office of Apprenticeship Training, Employer and Labor Services  
Bureau of Apprenticeship and Training

Certificate of Registration

Chicagoand Laborers' J.A.T.C.

Carol Stream, Illinois

For the Trade - Construction Craft Laborer

Registered as part of the National Apprenticeship Program

in accordance with the basic standards of apprenticeship

established by the Secretary of Labor



April 12, 1999

Date REVISED August 13, 2004

IL017990001

Registration No.

Loi. Chao

Secretary of Labor

Anthony Sampaio

Administrator, Apprenticeship Training, Employer and Labor Services

The United States Department of Labor

Office of Apprenticeship  
Certificate of Registration of Apprenticeship Program

Chicagoland Roofers' Joint Apprenticeship & Trng. Committee  
Indian Head Park, Illinois  
For the Trade - Roofer -

*Registered as part of the National Apprenticeship System  
in accordance with the basic standards of apprenticeship  
established by the Secretary of Labor*

June 11, 1945

Date Revised: March 27, 2007

IL015450002

Registration No.

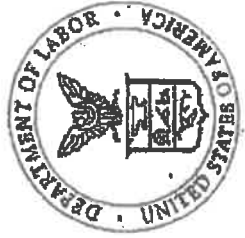

*D. P. Chao*  
Secretary of Labor

*Anthony Swape*  
Administrator, Office of Apprenticeship



United States Department of Labor  
Bureau of Apprenticeship and Training

*Confidential*

PIPEFITTERS ASSOCIATION U. A. LOCAL #597 J. A. C.  
CHICAGO, ILLINOIS

FOR THE TRADE OF  
PIPEFITTER

*Registered as part of the National Apprenticeship Program  
in accordance with the basic standards of apprenticeship  
established by the Secretary of Labor*



REVISER: FEBRUARY 5, 1951  
DATE: APRIL 4, 1988

017-0556  
REGISTRATION NO.

*Ed. Duke*

SECRETARY OF LABOR

*Thomas V. Hyman*

DIRECTOR, BUREAU OF APPRENTICESHIP AND TRAINING

# United States Department of Labor

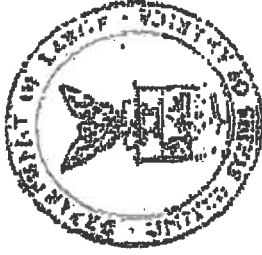

## Bureau of Apprenticeship and Training Certificate of Registration

*International Association of Heat & Frost Insulators  
Local 17, I.A.F.C., Chicago, Illinois*

*For the Trade of Insulation Worker  
Registered as part of the National Apprenticeship Program  
in accordance with the basic standards of apprenticeship  
established by the Secretary of Labor*

*September 7, 1990*

Date  
Revision  
012-0480

Registration No.

*Jose M. Hernandez*

Secretary of Labor

*Anthony Swiney*  
Director, Bureau of Apprenticeship and Training

The United States Department of Labor

Office of Apprenticeship

Certificate of Registration of Apprenticeship Program

Plumbers' J.A.C., Local 130, U.A.

Chicago, Illinois

For the Trade – Plumber

*Registered as part of the National Apprenticeship System*

*in accordance with the basic standards of apprenticeship*

*established by the Secretary of Labor*

June 23, 2008

Date

IL017-440001

Registration No.

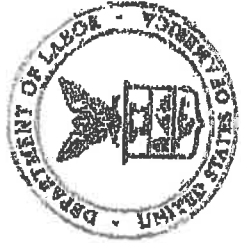

*Walter F. Solko*  
Secretary of Labor

*Ann V. Lull*  
Chief, Plumbers' Office of Apprenticeship

# United States Department of Labor



## Bureau of Apprenticeship and Training

### Certificate of Registration *Electricians*

*Joliet, Illinois*

*For the Trades of Electrician and Telecommunications Technician  
Registered as part of the National Apprenticeship Program  
in accordance with the basic standards of apprenticeship  
established by the Secretary of Labor*

**December 31, 1978**

Date Revised February 13, 2001

**IL0120514**

Registration No.

*Alfred M. Allen*

Secretary of Labor

*Anthony Swartz*  
Director, Bureau of Apprenticeship and Training



United States Department of Labor  
Bureau of Apprenticeship and Training

*Certificate of Registration*

SPRINKLER FITTERS LOCAL #281

PALOS HEIGHTS, IL

FOR THE TRADE OF

SPRINKLER FITTER

*Registered as part of the National Apprenticeship Program  
in accordance with the basic standards of apprenticeship  
established by the Secretary of Labor*

SEPTEMBER 4, 1985  
DATE

IL017 680001  
REGISTRATION NO.



*Raymond J. Donovan*

SECRETARY OF LABOR

*Thomas V. Hogue*

DIRECTOR, BUREAU OF APPRENTICESHIP AND TRAINING

*The United States Department of Labor*

*Office of Apprenticeship*

*Certificate of Registration of Apprenticeship Program*

*Journeyman Plasterers JATC Local #5*

*Alsip, Illinois*

*For the Trade of - Plasterer*

*Registered as part of the National Apprenticeship System  
in accordance with the basic standards of apprenticeship  
established by the Secretary of Labor*

*January 29, 1946*

*Date Revised September, 2009*

*IL015460004*

*Registration No.*



*Walter F. Solis*  
*Secretary of Labor*

*Al V. Hall*  
*Administrator, Office of Apprenticeship*

7

INSURANCE REQUIREMENTS





# ORLAND PARK

## INSURANCE REQUIREMENTS

Please sign and provide a policy Specimen Certificate of Insurance showing current coverages.

If awarded the contract, all **Required Policy Endorsements** noted in the left column in **red bold** type **MUST** be provided.

Standard Insurance Requirements	Please provide the following coverage if box is checked.
<p><b><u>WORKERS' COMPENSATION &amp; EMPLOYER LIABILITY</u></b>            Full Statutory Limits - Employers Liability            \$500,000 – Each Accident            \$500,000 – Each Employee            \$500,000 – Policy Limit  <b>Waiver of Subrogation in favor of the Village of Orland Park</b></p> <p><b><u>AUTOMOBILE LIABILITY</u></b> (ISO Form CA 0001)            \$1,000,000 – Combined Single Limit Per Occurrence            Bodily Injury &amp; Property Damage. Applicable for All Company Vehicles.</p> <p><b><u>GENERAL LIABILITY</u></b> (Occurrence basis) (ISO Form CG 0001)            \$1,000,000 – Combined Single Limit Per Occurrence            Bodily Injury &amp; Property Damage            \$2,000,000 – General Aggregate Limit            \$1,000,000 – Personal &amp; Advertising Injury            \$2,000,000 – Products/Completed Operations Aggregate</p> <p><b><u>ADDITIONAL INSURED ENDORSEMENTS:</u></b>  <i>(Not applicable for Goods Only Purchases)</i></p> <ul style="list-style-type: none"> <li>• <b>ISO CG 20 10 or CG 20 26 (or Equivalent)</b> Commercial General Liability Coverage</li> <li>• <b>CG 20 01 Primary &amp; Non-Contributory (or Equivalent)</b> The Village must be named as the Primary Non-Contributory which makes the Village a priority and collects off the policy prior to any other claimants.</li> <li>• <b>Blanket General Liability Waiver of Subrogation - Village of Orland Park</b> A provision that prohibits an insurer from pursuing a third party to recover damages for covered losses.</li> </ul>	<p><b><u>LIABILITY UMBRELLA</u></b> (Follow Form Policy)  <input checked="" type="checkbox"/> \$1,000,000 – Each Occurrence            \$1,000,000 – Aggregate  <input type="checkbox"/> \$2,000,000 – Each Occurrence            \$2,000,000 – Aggregate  <input type="checkbox"/> Other: _____  <b>EXCESS MUST COVER:</b> General Liability, Automobile Liability, Employers' Liability</p> <p><b><u>PROFESSIONAL LIABILITY</u></b>  <input type="checkbox"/> \$1,000,000 Limit – Claims Made Form, Indicate Retroactive Date  <input type="checkbox"/> \$2,000,000 Limit – Claims Made Form, Indicate Retroactive Date  <input type="checkbox"/> Other: _____            Deductible not-to-exceed \$50,000 without prior written approval</p> <p><input type="checkbox"/> <b><u>BUILDERS RISK</u></b>            Completed Property Full Replacement Cost Limits – Structures under construction</p> <p><input type="checkbox"/> <b><u>ENVIRONMENTAL IMPAIRMENT/POLLUTION LIABILITY</u></b>            \$1,000,000 Limit for bodily injury, property damage and remediation costs resulting from a pollution incident at, on or mitigating beyond the job site</p> <p><input type="checkbox"/> <b><u>CYBER LIABILITY</u></b>            \$1,000,000 Limit per Data Breach for liability, notification, response, credit monitoring service costs, and software/property damage</p> <p><input type="checkbox"/> <b>CG 20 37 ADDITIONAL INSURED</b> – Completed Operations (Provide only if box is checked)</p>



Any insurance policies providing the coverages required of the Consultant, excluding Professional Liability, shall be specifically endorsed to identify "The Village of Orland Park, and their respective officers, trustees, directors, officials, employees, volunteers and agents as Additional Insureds on a primary/non-contributory basis with respect to all claims arising out of operations by or on behalf of the named insured." The required additional Insured coverage shall be provided on the Insurance Service Office (ISO) CG 20 10 or CG 20 26 endorsements or an endorsement at least as broad as the above noted endorsements as determined by the Village of Orland Park. Any Village of Orland Park insurance coverage shall be deemed to be on an excess or contingent basis as confirmed by the required (ISO) CG 20 01 Additional Insured Primary & Non- Contributory Endorsement. The policies shall also contain a Waiver of Subrogation in favor of the Additional Insureds in regard to General Liability and Workers' Compensation coverage. The certificate of insurance shall also state this information on its face. Any insurance company providing coverage must hold an A-, VII rating according to Best's Key Rating Guide. Each insurance policy required shall have the Village of Orland Park expressly endorsed onto the policy as a Cancellation Notice Recipient. Should any of the policies be cancelled before the expiration date thereof, notice will be delivered in accordance with the policy provisions. Permitting the contractor, or any subcontractor, to proceed with any work prior to our receipt of the foregoing certificate and endorsements shall not be a waiver of the contractor's obligation to provide all the above insurance.

Consultant agrees that prior to any commencement of work to furnish evidence of Insurance coverage providing for at minimum the coverages, endorsements and limits described above directly to the Village of Orland Park, 14700 S. Ravinia Avenue, Orland Park, IL 60462. Failure to provide this evidence in the time frame specified and prior to beginning of work may result in the termination of the Village's relationship with the contractor.

ACCEPTED & AGREED THIS 6th DAY OF June, 2024

  
Signature

**Henry B. Ryan III, President**

Printed Name & Title

Authorized to execute agreements for:  
The George Sollitt Construction Company

Name of Company

**THIS ENDORSEMENT CHANGES THE POLICY. PLEASE READ IT CAREFULLY.**

**ADDITIONAL INSURED – OWNERS, LESSEES OR  
CONTRACTORS – SCHEDULED PERSON OR  
ORGANIZATION**

This endorsement modifies insurance provided under the following:

COMMERCIAL GENERAL LIABILITY COVERAGE PART

**SCHEDULE**

Name Of Additional Insured Person(s) Or Organization(s)	Location(s) Of Covered Operations
Information required to complete this Schedule, if not shown above, will be shown in the Declarations.	

**A. Section II – Who Is An Insured** is amended to include as an additional insured the person(s) or organization(s) shown in the Schedule, but only with respect to liability for "bodily injury", "property damage" or "personal and advertising injury" caused, in whole or in part, by:

1. Your acts or omissions; or
2. The acts or omissions of those acting on your behalf;

in the performance of your ongoing operations for the additional insured(s) at the location(s) designated above.

However:

1. The insurance afforded to such additional insured only applies to the extent permitted by law; and
2. If coverage provided to the additional insured is required by a contract or agreement, the insurance afforded to such additional insured will not be broader than that which you are required by the contract or agreement to provide for such additional insured.

**B.** With respect to the insurance afforded to these additional insureds, the following additional exclusions apply:

This insurance does not apply to "bodily injury" or "property damage" occurring after:

1. All work, including materials, parts or equipment furnished in connection with such work, on the project (other than service, maintenance or repairs) to be performed by or on behalf of the additional insured(s) at the location of the covered operations has been completed; or
2. That portion of "your work" out of which the injury or damage arises has been put to its intended use by any person or organization other than another contractor or subcontractor engaged in performing operations for a principal as a part of the same project.

C. With respect to the insurance afforded to these additional insureds, the following is added to **Section III – Limits Of Insurance:**

If coverage provided to the additional insured is required by a contract or agreement, the most we will pay on behalf of the additional insured is the amount of insurance:

1. Required by the contract or agreement; or

2. Available under the applicable Limits of Insurance shown in the Declarations; whichever is less.

This endorsement shall not increase the applicable Limits of Insurance shown in the Declarations.

SAMPLE

POLICY NUMBER:

COMMERCIAL GENERAL LIABILITY  
CG 20 26 07 04

**THIS ENDORSEMENT CHANGES THE POLICY. PLEASE READ IT CAREFULLY.**

## **ADDITIONAL INSURED – DESIGNATED PERSON OR ORGANIZATION**

This endorsement modifies insurance provided under the following:

COMMERCIAL GENERAL LIABILITY COVERAGE PART

**SCHEDULE**

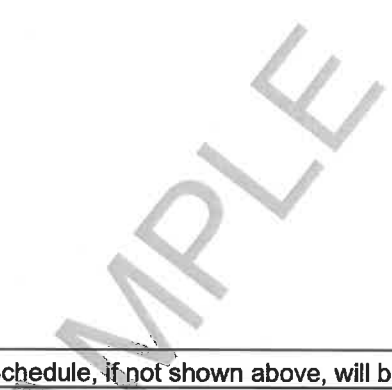
Name Of Additional Insured Person(s) Or Organization(s)

Information required to complete this Schedule, if not shown above, will be shown in the Declarations.

**Section II – Who Is An Insured** is amended to include as an additional insured the person(s) or organization(s) shown in the Schedule, but only with respect to liability for "bodily injury", "property damage" or "personal and advertising injury" caused, in whole or in part, by your acts or omissions or the acts or omissions of those acting on your behalf:

- A.** In the performance of your ongoing operations; or
- B.** In connection with your premises owned by or rented to you.



**THIS ENDORSEMENT CHANGES THE POLICY. PLEASE READ IT CAREFULLY.**

**ADDITIONAL INSURED – OWNERS, LESSEES OR  
CONTRACTORS – AUTOMATIC STATUS WHEN  
REQUIRED IN CONSTRUCTION AGREEMENT WITH YOU**

This endorsement modifies insurance provided under the following:

COMMERCIAL GENERAL LIABILITY COVERAGE PART

**A. Section II – Who Is An Insured** is amended to include as an additional insured any person or organization for whom you are performing operations when you and such person or organization have agreed in writing in a contract or agreement that such person or organization be added as an additional insured on your policy. Such person or organization is an additional insured only with respect to liability for "bodily injury", "property damage" or "personal and advertising injury" caused, in whole or in part, by:

- 1. Your acts or omissions; or
- 2. The acts or omissions of those acting on your behalf;

in the performance of your ongoing operations for the additional insured.

However, the insurance afforded to such additional insured:

- 1. Only applies to the extent permitted by law; and
- 2. Will not be broader than that which you are required by the contract or agreement to provide for such additional insured.

A person's or organization's status as an additional insured under this endorsement ends when your operations for that additional insured are completed.

**B.** With respect to the insurance afforded to these additional insureds, the following additional exclusions apply:

This insurance does not apply to:

- 1. "Bodily injury", "property damage" or "personal and advertising injury" arising out of the rendering of, or the failure to render,

any professional architectural, engineering or surveying services, including:

- a. The preparing, approving, or failing to prepare or approve, maps, shop drawings, opinions, reports, surveys, field orders, change orders or drawings and specifications; or
- b. Supervisory, inspection, architectural or engineering activities.

This exclusion applies even if the claims against any insured allege negligence or other wrongdoing in the supervision, hiring, employment, training or monitoring of others by that insured, if the "occurrence" which caused the "bodily injury" or "property damage", or the offense which caused the "personal and advertising injury", involved the rendering of or the failure to render any professional architectural, engineering or surveying services.

2. "Bodily injury" or "property damage" occurring after:

- a. All work, including materials, parts or equipment furnished in connection with such work, on the project (other than service, maintenance or repairs) to be performed by or on behalf of the additional insured(s) at the location of the covered operations has been completed; or
- b. That portion of "your work" out of which the injury or damage arises has been put to its intended use by any person or organization other than another contractor or subcontractor engaged in

performing operations for a principal as a part of the same project.

C. With respect to the insurance afforded to these additional insureds, the following is added to **Section III – Limits Of Insurance**: The most we will pay on behalf of the additional insured is the amount of insurance:

1. Required by the contract or agreement you have entered into with the additional insured; or

2. Available under the applicable Limits of Insurance shown in the Declarations; whichever is less.

This endorsement shall not increase the applicable Limits of Insurance shown in the Declarations.

SAMPLE

Policy Number:

COMMERCIAL GENERAL LIABILITY  
CG 20 01 04 13

**THIS ENDORSEMENT CHANGES THE POLICY. PLEASE READ IT CAREFULLY.**

## **PRIMARY AND NONCONTRIBUTORY – OTHER INSURANCE CONDITION**

This endorsement modifies insurance provided under the following:

COMMERCIAL GENERAL LIABILITY COVERAGE PART  
PRODUCTS/COMPLETED OPERATIONS LIABILITY COVERAGE PART

The following is added to the **Other Insurance Condition** and supersedes any provision to the contrary:

### **Primary And Noncontributory Insurance**

This insurance is primary to and will not seek contribution from any other insurance available to an additional insured under your policy provided that:

(1) The additional insured is a Named Insured under such other insurance; and

(2) You have agreed in writing in a contract or agreement that this insurance would be primary and would not seek contribution from any other insurance available to the additional insured.

**SAMPLE**

POLICY NUMBER:

COMMERCIAL GENERAL LIABILITY  
CG 20 37 07 04

**THIS ENDORSEMENT CHANGES THE POLICY. PLEASE READ IT CAREFULLY.**

## **ADDITIONAL INSURED – OWNERS, LESSEES OR CONTRACTORS – COMPLETED OPERATIONS**

This endorsement modifies insurance provided under the following:

COMMERCIAL GENERAL LIABILITY COVERAGE PART

### **SCHEDULE**

<b>Name Of Additional Insured Person(s) Or Organization(s):</b>	<b>Location And Description Of Completed Operations</b>
Information required to complete this Schedule, if not shown above, will be shown in the Declarations.	

**Section II – Who Is An Insured** is amended to include as an additional insured the person(s) or organization(s) shown in the Schedule, but only with respect to liability for "bodily injury" or "property damage" caused, in whole or in part, by "your work" at the location designated and described in the schedule of this endorsement performed for that additional insured and included in the "products-completed operations hazard".





# CERTIFICATE OF LIABILITY INSURANCE

DATE (MM/DD/YYYY)

5/31/2024

THIS CERTIFICATE IS ISSUED AS A MATTER OF INFORMATION ONLY AND CONFERS NO RIGHTS UPON THE CERTIFICATE HOLDER. THIS CERTIFICATE DOES NOT AFFIRMATIVELY OR NEGATIVELY AMEND, EXTEND OR ALTER THE COVERAGE AFFORDED BY THE POLICIES BELOW. THIS CERTIFICATE OF INSURANCE DOES NOT CONSTITUTE A CONTRACT BETWEEN THE ISSUING INSURER(S), AUTHORIZED REPRESENTATIVE OR PRODUCER, AND THE CERTIFICATE HOLDER.

**IMPORTANT:** If the certificate holder is an ADDITIONAL INSURED, the policy(ies) must have ADDITIONAL INSURED provisions or be endorsed. If SUBROGATION IS WAIVED, subject to the terms and conditions of the policy, certain policies may require an endorsement. A statement on this certificate does not confer rights to the certificate holder in lieu of such endorsement(s).

<b>PRODUCER</b> Cottingham & Butler 800 Main St. Dubuque IA 52001	<b>CONTACT NAME:</b> PHONE (A/C, No., Ext): 888-785-4677		<b>FAX (A/C, No.):</b> 563-583-7339
	<b>E-MAIL ADDRESS:</b>		
<b>INSURED</b> THEGEOR-01 The George Sollitt Construction Company 185 Hansen Court Suite 100 Wood Dale IL 60191	<b>INSURER(S) AFFORDING COVERAGE</b>		<b>NAIC #</b>
	<b>INSURER A :</b> State Automobile Mutual Insurance Company		25135
	<b>INSURER B :</b> Plaza Insurance Company		30945
	<b>INSURER C :</b>		
	<b>INSURER D :</b>		
	<b>INSURER E :</b>		
<b>INSURER F :</b>			

**COVERAGES**                      **CERTIFICATE NUMBER:** 1617146588                      **REVISION NUMBER:**

THIS IS TO CERTIFY THAT THE POLICIES OF INSURANCE LISTED BELOW HAVE BEEN ISSUED TO THE INSURED NAMED ABOVE FOR THE POLICY PERIOD INDICATED. NOTWITHSTANDING ANY REQUIREMENT, TERM OR CONDITION OF ANY CONTRACT OR OTHER DOCUMENT WITH RESPECT TO WHICH THIS CERTIFICATE MAY BE ISSUED OR MAY PERTAIN, THE INSURANCE AFFORDED BY THE POLICIES DESCRIBED HEREIN IS SUBJECT TO ALL THE TERMS, EXCLUSIONS AND CONDITIONS OF SUCH POLICIES. LIMITS SHOWN MAY HAVE BEEN REDUCED BY PAID CLAIMS.

INSR LTR	TYPE OF INSURANCE	ADDL SUBR INSD WVD	POLICY NUMBER	POLICY EFF (MM/DD/YYYY)	POLICY EXP (MM/DD/YYYY)	LIMITS
A	<input checked="" type="checkbox"/> COMMERCIAL GENERAL LIABILITY <input type="checkbox"/> CLAIMS-MADE <input checked="" type="checkbox"/> OCCUR  GEN'L AGGREGATE LIMIT APPLIES PER: <input checked="" type="checkbox"/> POLICY <input checked="" type="checkbox"/> PRO-JECT <input checked="" type="checkbox"/> LOC OTHER:		10179081CP	6/30/2023	6/30/2024	EACH OCCURRENCE \$ 1,000,000 DAMAGE TO RENTED PREMISES (Ea occurrence) \$ 100,000 MED EXP (Any one person) \$ 5,000 PERSONAL & ADV INJURY \$ 1,000,000 GENERAL AGGREGATE \$ 2,000,000 PRODUCTS - COMP/OP AGG \$ 2,000,000 \$
A	<b>AUTOMOBILE LIABILITY</b> <input checked="" type="checkbox"/> ANY AUTO <input type="checkbox"/> OWNED AUTOS ONLY <input type="checkbox"/> SCHEDULED AUTOS <input checked="" type="checkbox"/> HIRED AUTOS ONLY <input checked="" type="checkbox"/> NON-OWNED AUTOS ONLY		10179083CA	6/30/2023	6/30/2024	COMBINED SINGLE LIMIT (Ea accident) \$ 1,000,000 BODILY INJURY (Per person) \$ BODILY INJURY (Per accident) \$ PROPERTY DAMAGE (Per accident) \$ \$
A	<input checked="" type="checkbox"/> UMBRELLA LIAB <input checked="" type="checkbox"/> OCCUR <input type="checkbox"/> EXCESS LIAB <input type="checkbox"/> CLAIMS-MADE DED <input checked="" type="checkbox"/> RETENTION \$ 10,000		10179086CU	6/30/2023	6/30/2024	EACH OCCURRENCE \$ 10,000,000 AGGREGATE \$ 10,000,000 \$
B	<b>WORKERS COMPENSATION AND EMPLOYERS' LIABILITY</b> ANY PROPRIETOR/PARTNER/EXECUTIVE OFFICER/MEMBER EXCLUDED? (Mandatory in NH) If yes, describe under DESCRIPTION OF OPERATIONS below	Y / N <input checked="" type="checkbox"/> N / A	10179085WC	6/30/2023	6/30/2024	<input checked="" type="checkbox"/> PER STATUTE <input type="checkbox"/> OTH-ER E.L. EACH ACCIDENT \$ 1,000,000 E.L. DISEASE - EA EMPLOYEE \$ 1,000,000 E.L. DISEASE - POLICY LIMIT \$ 1,000,000

DESCRIPTION OF OPERATIONS / LOCATIONS / VEHICLES (ACORD 101, Additional Remarks Schedule, may be attached if more space is required)

RE: Project CPAC Modernization Project - Phase 1

Village of Orland Park is additional insured on the General Liability policy including ongoing and complete operations and on a primary, non-contributory basis per written contract between the named insured and the certificate holder that requires such a status subject to the terms and conditions of the endorsement attached to the policy. The General Liability policy includes a waiver of subrogation in favor of the certificate holder per written contract between the named insured and the certificate holder that requires such a status subject to the terms and conditions of the endorsement attached to the policy.

**CERTIFICATE HOLDER**

Village of Orland Park  
 14700 S. Ravinia Avenue  
 Orland Park IL 60462

**CANCELLATION**

SHOULD ANY OF THE ABOVE DESCRIBED POLICIES BE CANCELLED BEFORE THE EXPIRATION DATE THEREOF, NOTICE WILL BE DELIVERED IN ACCORDANCE WITH THE POLICY PROVISIONS.

AUTHORIZED REPRESENTATIVE

*Emily Glanz*

© 1988-2015 ACORD CORPORATION. All rights reserved.

- a. Subject to **b.** below, the most we will pay for "property damage" including all resulting loss of use is:
  - 1) \$2,500 as a result of any one "occurrence" and the most we will pay for the sum of all occurrences during the policy period is the aggregate limit of \$10,000; or
  - 2) The amount shown in the Declarations, if greater than **1)** above, for Property Of Others In The Care, Custody, And Control Of The Insured & Voluntary Property Damage.
- b. The limit in **3.a.** above is part of and not in addition to the Commercial General Liability Each Occurrence limit described in Paragraph **5.** of **Section III – Limits of Insurance** of the Commercial General Liability Coverage Form.

We will not pay for "property damage" in any one "occurrence" until the amount of loss or damage exceeds the deductible shown for this coverage in the policy declarations. We will then pay the amount of loss or damage in excess of the deductible, up to the applicable limit of insurance. The limits of insurance will not be reduced by the application of such deductible amount.

We may pay any part or the entire deductible amount to effect settlement of any claim or "suit" and, upon notification of the action taken; you shall promptly reimburse us for such part of the deductible amount as has been paid by us.
- c. The amount we pay for the sum of all occurrences in an annual policy period is the Aggregate Limit for this coverage. This amount is part of and not in addition to the Commercial General Liability General Aggregate Limit described in Paragraph **2.** of **Section III – Limits of Insurance** of the Commercial General Liability Coverage Form.

**B. ADDITIONAL INSURED – AUTOMATIC STATUS WHEN REQUIRED IN A WRITTEN CONSTRUCTION AGREEMENT**

The words "you" and "your" as used in this provision refer to the Named Insured shown in the Declarations and any other person or organization qualifying as a Named Insured under the policy to which this endorsement is attached. "You" and "your" do not refer to an additional insured.

1. **SECTION II – WHO IS AN INSURED** is amended to include any person or organization whom you are required to add as an additional insured under a written contract or written agreement executed by you, but only with respect to liability for "bodily injury", "property damage" or "personal and advertising injury" and subject to the following:
  - a. If such written contract or written agreement specifically requires that you provide that the person or organization be named as an additional insured under one or both of the following endorsements:
    - (1) The Insurance Services Office (ISO) CG 20 10 (10/01 edition); or
    - (2) The Insurance Services Office (ISO) CG 20 37 (10/01 edition),such person or organization is then an additional insured with respect to such endorsement(s), but only with respect to liability for "bodily injury", "property damage" or "personal and advertising injury" arising out of:
    - (a) Your ongoing operations, with respect to Paragraph **D.1.a.(1)** above; or
    - (b) "Your work" and included in the "products-completed operations hazard",, with respect to Paragraph **D.1.a.(2)** above,which is the subject of the written contract or written agreement.

However, solely with respect to this Paragraph **D.1.a.**, insurance afforded to such additional insured:

- i. Only applies if the "bodily injury", "property damage" or "personal and advertising injury" offense occurs subsequent to your execution of the written contract or written agreement; and
- ii. Does not apply to "bodily injury" or "property damage" caused by "your work" and included within the "products-completed operations hazard" unless the written contract or written agreement specifically requires that you provide such coverage to such additional insured.

- b.** If such written contract or written agreement specifically requires that you provide that the person or organization be named as an additional insured under one or both of the following endorsements:

**(1)** The Insurance Services Office (ISO) CG 20 10 (07/04 edition); or

**(2)** The Insurance Services Office (ISO) CG 20 37 (07/04 edition),

such person or organization is then an additional insured with respect to such endorsement(s), but only with respect to liability for "bodily injury", "property damage" or "personal and advertising injury" is caused, in whole or in part, by:

**(a)** Your acts or omissions; or

**(b)** The acts or omissions of those acting on your behalf,

in the performance of:

1. Your ongoing operations, with respect to Paragraph **D.1.b.(1)** above; or

2. "Your work" and included in the "products-completed operations hazard", with respect to Paragraph **D.1.b.(2)** above,

which is the subject of the written contract or written agreement.

However, solely with respect to this Paragraph **D.1.b.**, insurance afforded to such additional insured:

i. Only applies if the "bodily injury", "property damage" or "personal and advertising injury" offense occurs subsequent to your execution of the written contract or written agreement; and

ii. Does not apply to "bodily injury" or "property damage" caused by "your work" and included within the "products-completed operations hazard" unless the written contract or written agreement specifically requires that you provide such coverage to such additional insured.

- c.** If neither Paragraph **D.1.a.** nor Paragraph **D.1.b** above apply and such written contract or written agreement requires that you provide that the person or organization be named as an additional insured:

**(1)** Under the Insurance Services Office (ISO) CG 20 10 (04/13) or Insurance Services Office (ISO) CG 20 10 (12/19) edition, any subsequent edition, or if no edition date is specified; or

**(2)** With respect to ongoing operations if no form is specified;

such person or organization is then an additional insured, but only with respect to liability for "bodily injury", "property damage" or "personal and advertising injury" is caused, in whole or in part by:

**(a)** Your acts or omissions; or

**(b)** The acts or omissions of those acting on your behalf,

in the performance of your ongoing operations, which is the subject of the written contract or written agreement.

However, solely with respect to this Paragraph **D.1.c.** insurance afforded to such additional insured:

i. Only applies to the extent permitted by law;

ii. Will not be broader than that which you are required by the written contract or written agreement to provide for such additional insured; and

iii. Only applies if the "bodily injury", "property damage" or "personal and advertising injury" offense occurs subsequent to your execution of the written contract or written agreement.

- d.** If neither Paragraph **D.1.a.** nor Paragraph **D.1.b** above apply and such written contract or written agreement requires that you provide that the person or organization be named as an additional insured:

(1) Under the Insurance Services Office (ISO) CG 20 37 (04/13) or Insurance Services Office (ISO) CG 20 37 (12/19) edition, any subsequent edition, or if no edition date is specified; or

(2) With respect to the "products-completed operations hazard" if no form is specified,

such person or organization is then an additional insured, but only with respect to liability for "bodily injury" or "property damage" caused, in whole or in part by "your work" and included in the "products-completed operations hazard", which is the subject of the written contract or written agreement.

However, solely with respect to this Paragraph **D.1.d.**, insurance afforded to such additional insured:

(a) Only applies to the extent permitted by law;

(b) Will not be broader than that which you are required by the written contract or written agreement to provide for such additional insured; and

(c) Only applies if the "bodily injury" or "property damage" occurs subsequent to your execution of the written contract or written agreement.

2. With respect to the insurance afforded to the additional insured described above, the following additional exclusion applies:

a. This insurance does not apply to "bodily injury", "property damage" or "personal and advertising injury" arising out of the rendering of, or the failure to render any professional engineering, architectural or surveying services by you or others on your behalf, including:

(1) The preparing, approving, failing to prepare approve, maps, shop drawings, opinions, reports, surveys, field orders, change orders, or drawings and specifications; or

(2) Supervisor or inspection activities performed as part of any related architectural or engineering activities.

This exclusion applies even if the claims against any insured allege negligence or other wrongdoing in the supervision, hiring, employment, training or monitoring of others by that insured, if the "occurrence" which caused the "bodily injury" or "property damage", or the offense which caused the "personal and advertising injury", involved the rendering of or the failure to render any professional architectural, engineering or surveying services.

3. With respect to the insurance afforded to an additional insured under Paragraph **D.1.c.** or Paragraph **D.1.d.** of this endorsement, the following applies:

a. The following is added to **SECTION III – LIMITS OF INSURANCE**:

The most we will pay on behalf of the additional insured is the amount of insurance:

(1) Required by a written contract or written agreement; or

(2) Available under the applicable Limits of Insurance shown in the Declarations, whichever is less.

This endorsement shall not increase the applicable Limits of Insurance shown in the Declarations.

b. Paragraph **9.f.** of **SECTION V - DEFINITIONS** is amended as follows:

f. That part of any other contract or agreement pertaining to your business (including an indemnification of a municipality in connection with work performed for a municipality) under which you assume the tort liability of another party to pay for "bodily injury" or "property damage" to a third person or organization, provided the "bodily injury" or "property damage" is caused, in whole or in part, by you or by those acting on your behalf. However, such part of a contract or agreement shall only be considered an "insured contract" to the extent your assumption of the tort liability is permitted by law. Tort liability means a liability that would be imposed by law in the absence of any contract or agreement.



4. With respect to the coverage provided under this endorsement:
- a. The following is added to Paragraph 4.a. of the **Other Insurance**, of **SECTION IV – COMMERCIAL GENERAL LIABILITY CONDITIONS**:

**Primary and Noncontributory Insurance**

However, this insurance is primary to and will not seek contribution from any other insurance available to a person or organization added as an additional insured under the terms of the endorsement provided that:

- (1) The person or organization is a Named Insured under such other insurance; and
- (2) You have agreed in writing in a contract or agreement that this insurance would be primary and would not seek contribution from any other insurance available to the additional insured.

- b. The following paragraph is added to Paragraph 4.b. of the **Other Insurance Condition** under **SECTION IV – COMMERCIAL GENERAL LIABILITY CONDITIONS**:

This insurance is excess over:

Any of the other insurance, whether primary, excess, contingent or on any other basis, available to an additional insured, in which the additional insured on our policy is also covered as an additional insured on another policy providing coverage for the same "occurrence", offense, claim or "suit". This provision does not apply to any policy in which the additional insured is a Named Insured on such other policy and where our policy is required by a written contract or written agreement to provide coverage to the additional insured on a primary and non-contributory basis.

5. This additional insured provision does not apply to an additional insured or project which has been specifically addressed by separate endorsement to this Coverage Part showing the additional insured in a Schedule of additional insureds.

**C. ADDITIONAL INSURED – AUTOMATIC STATUS WHEN REQUIRED FOR PERMITS**

1. The words "you" and "your" as used in this provision refer to the Named Insured shown in the Declarations and any other person or organization qualifying as a Named Insured under the policy to which this endorsement is attached. "You" and "your" do not refer to an additional insured.
2. **SECTION II – WHO IS AN INSURED** is amended to include any state, governmental agency, subdivision or political subdivision for which you are required to add as an additional insured because of the issuance or existence of a permit, but only with respect to:

- a. Liability for "bodily injury", "property damage" or "personal and advertising injury" caused, in whole or in part, by:

- (1) Your acts or omissions; or
- (2) The acts or omissions of those acting on your behalf;
- in the performance of your ongoing operations for which the permit was issued; and

- b. Permits:

- (1) Currently in effect or becoming effective during the term of this policy; and
- (2) Executed prior to the "bodily injury", "property damage," or "personal and advertising injury".

However:

- a. The insurance afforded to such additional insured only applies to the extent permitted by law; and
- b. If coverage provided to the additional insured is required by a contract or agreement, the insurance afforded to such additional insured will not be broader than that which you are required by the contract or agreement to provide for such additional insured.

A person's or organization's status as an additional insured for ongoing operations ends when your operations for which the permit was issued are completed.

**15. WAIVER OF TRANSFER OF RIGHTS OF RECOVERY AGAINST OTHERS (WAIVER OF SUBROGATION)**

Condition **8. Transfer Of Rights Of Recovery Against Others To Us** of **SECTION IV - COMMERCIAL GENERAL LIABILITY CONDITIONS** is amended by the addition of the following:

We waive any right of recovery against any person(s) or organization(s), because of any payment we make under this Coverage Part, to whom the insured has waived its right of recovery in a written contract or agreement. Such waiver by us applies only to the extent that the insured has waived its right of recovery against such person(s) or organization(s) prior to the loss.

**16. PRIMARY AND NONCONTRIBUTORY**

Subparagraph **a. Primary Insurance** of Paragraph **4. Other Insurance** of **SECTION IV - COMMERCIAL GENERAL LIABILITY CONDITIONS** is amended by the following additional paragraph:

However, this insurance is primary to and will not seek contribution from any other insurance available to an additional insured under the terms of this Coverage Form or amendatory endorsement provided that:

- a. The additional insured is a Named Insured under such other insurance; and
- b. You have agreed in writing in a contract or agreement that this insurance would be primary and would not seek contribution from any other insurance available to the additional insured.

**17. "MOBILE EQUIPMENT" REDEFINED**

**SECTION V - DEFINITIONS** is amended as follows:

- a. Paragraph **12.f.(1)(a), (b), and (c)** of the "mobile equipment" definition does not apply to self-propelled vehicles of less than 1,000 pounds gross vehicle weight.

**18. UNINTENTIONAL FAILURE TO DISCLOSE ALL HAZARDS**

Unless otherwise amended by separate endorsement to this Coverage Form, the following paragraph is added to Paragraph **6.** of **SECTION IV - CONDITIONS**: Based on our reliance on your representations as to existing hazards, if you unintentionally fail to disclose all such hazards prior to the beginning of the policy period of this Coverage Form, we shall not deny coverage under this Coverage Form because of such failure.

**19. FELLOW EMPLOYEE COVERAGE**

For the purpose of this coverage, paragraph **2.a.(1)**, in **SECTION II – WHO IS AN INSURED**, is replaced by the following:

**(1)** "Bodily injury" or "personal and advertising injury":

- (a)** To you, to your partners or member (if you are a partnership or joint venture), to your members (if you are a limited liability company), to a co "employee" while in the course of his or her employment or performing duties related to the conduct of your business, or to your other "volunteer workers" while performing duties related to the conduct of your business.
- (b)** To the spouse, child, parent, brother or sister of that co-"employee" or "volunteer worker" as a consequence of Paragraph **(1)(a)** above;
- (c)** For which there is any obligation to share damages with or repay someone else who must pay damages because of the injury described in Paragraph **(1)(a)** or **(b)** above; or
- (d)** Arising out of his or her providing or failing to provide professional health care services.

However, this does not apply to "bodily injury" to a co-"employee" when caused by your "employee", except with respect to claims for "bodily injury" to:

- (a)** A person arising out of any:
  - (i)** Refusal to employ that person;
  - (ii)** Termination of that person's employment; or
  - (iii)** Employment-related practices, policies, acts or omissions, such as coercion, demotion, evaluation, reassignment, discipline, defamation, harassment, humiliation or discrimination directed at that person;



## **BID BOND**



# BID BOND

Travelers Casualty and Surety Company of America  
Hartford, Connecticut 06183

---

**CONTRACTOR:**

*(Name, legal status and address)*

The George Sollitt Construction Company  
185 Hansen Court, Suite 100  
Wood Dale, IL 60191

**SURETY:**

*(Name, legal status and principal place of business)*

Travelers Casualty and Surety Company of America  
One Tower Square  
Hartford, CT 06183

**OWNER:**

*(Name, legal status and address)*

Village of Orland Park  
14700 S. Ravinia Avenue  
Orland Park, IL 60492

**BOND AMOUNT:**            10%            Ten Percent of Amount Bid

**PROJECT:**

*(Name, location or address, and Project number, if any)*

CPAC Modernization Project – Phase 1 - RFP #24-014

The Contractor and Surety are bound to the Owner in the amount set forth above, for the payment of which the Contractor and Surety bind themselves, their heirs, executors, administrators, successors and assigns, jointly and severally, as provided herein. The conditions of this Bond are such that if the Owner accepts the bid of the Contractor within the time specified in the bid documents, or within such time period as may be agreed to by the Owner and Contractor, and the Contractor either (1) enters into a contract with the Owner in accordance with the terms of such bid, and gives such bond or bonds as may be specified in the bidding or Contract Documents, with a surety admitted in the jurisdiction of the Project and otherwise acceptable to the Owner, for the faithful performance of such Contract and for the prompt payment of labor and material furnished in the prosecution thereof; or (2) pays to the Owner the difference, not to exceed the amount of this Bond, between the amount specified in said bid and such larger amount for which the Owner may in good faith contract with another party to perform the work covered by said bid, then this obligation shall be null and void, otherwise to remain in full force and effect. The Surety hereby waives any notice of an agreement between the Owner and Contractor to extend the time in which the Owner may accept the bid. Waiver of notice by the Surety shall not apply to any extension exceeding sixty (60) days in the aggregate beyond the time for acceptance of bids specified in the bid documents, and the Owner and Contractor shall obtain the Surety's consent for an extension beyond sixty (60) days.

If this Bond is issued in connection with a subcontractor's bid to a Contractor, the term Contractor in this Bond shall be deemed to be Subcontractor and the term Owner shall be deemed to be Contractor.

When this Bond has been furnished to comply with a statutory or other legal requirement in the location of the Project, any provision in this Bond conflicting with said statutory or legal requirement shall be deemed deleted herefrom and provisions conforming to such statutory or other legal requirement shall be deemed incorporated herein. When so furnished, the intent is that this Bond shall be construed as a statutory bond and not as a common law bond.

Signed and sealed this 6th day of June, 2024

*Shirley Dameron*

(Witness)

*Oscar F. Rincon*

(Witness) Oscar F. Rincon

The George Sollitt Construction Company

(Principal)

(Seal)

By: *H. B. Ryan III*

(Title) Henry B. Ryan III, President

Travelers Casualty and Surety Company of America

(Surety)

(Seal)

By: *Peter S. Forker*

(Title) Peter S. Forker

Attorney-in-Fact





**Travelers Casualty and Surety Company of America  
Travelers Casualty and Surety Company  
St. Paul Fire and Marine Insurance Company**

**POWER OF ATTORNEY**

**KNOW ALL MEN BY THESE PRESENTS:** That Travelers Casualty and Surety Company of America, Travelers Casualty and Surety Company, and St. Paul Fire and Marine Insurance Company are corporations duly organized under the laws of the State of Connecticut (herein collectively called the "Companies"), and that the Companies do hereby make, constitute and appoint **Peter S Forker** of **ROLLING MEADOWS**, Illinois, their true and lawful Attorney(s)-in-Fact to sign, execute, seal and acknowledge any and all bonds, recognizances, conditional undertakings and other writings obligatory in the nature thereof on behalf of the Companies in their business of guaranteeing the fidelity of persons, guaranteeing the performance of contracts and executing or guaranteeing bonds and undertakings required or permitted in any actions or proceedings allowed by law.

**IN WITNESS WHEREOF**, the Companies have caused this instrument to be signed, and their corporate seals to be hereto affixed, this **21st** day of **April**, 2021.



State of Connecticut

City of Hartford ss.

By:   
Robert L. Raney, Senior Vice President

On this the **21st** day of **April**, 2021, before me personally appeared **Robert L. Raney**, who acknowledged himself to be the Senior Vice President of each of the Companies, and that he, as such, being authorized so to do, executed the foregoing instrument for the purposes therein contained by signing on behalf of said Companies by himself as a duly authorized officer.

**IN WITNESS WHEREOF**, I hereunto set my hand and official seal.

My Commission expires the **30th** day of **June**, 2026



  
Anna P. Nowik, Notary Public

This Power of Attorney is granted under and by the authority of the following resolutions adopted by the Boards of Directors of each of the Companies, which resolutions are now in full force and effect, reading as follows:

**RESOLVED**, that the Chairman, the President, any Vice Chairman, any Executive Vice President, any Senior Vice President, any Vice President, any Second Vice President, the Treasurer, any Assistant Treasurer, the Corporate Secretary or any Assistant Secretary may appoint Attorneys-in-Fact and Agents to act for and on behalf of the Company and may give such appointee such authority as his or her certificate of authority may prescribe to sign with the Company's name and seal with the Company's seal bonds, recognizances, contracts of indemnity, and other writings obligatory in the nature of a bond, recognizance, or conditional undertaking, and any of said officers or the Board of Directors at any time may remove any such appointee and revoke the power given him or her; and it is

**FURTHER RESOLVED**, that the Chairman, the President, any Vice Chairman, any Executive Vice President, any Senior Vice President or any Vice President may delegate all or any part of the foregoing authority to one or more officers or employees of this Company, provided that each such delegation is in writing and a copy thereof is filed in the office of the Secretary; and it is

**FURTHER RESOLVED**, that any bond, recognizance, contract of indemnity, or writing obligatory in the nature of a bond, recognizance, or conditional undertaking shall be valid and binding upon the Company when (a) signed by the President, any Vice Chairman, any Executive Vice President, any Senior Vice President or any Vice President, any Second Vice President, the Treasurer, any Assistant Treasurer, the Corporate Secretary or any Assistant Secretary and duly attested and sealed with the Company's seal by a Secretary or Assistant Secretary; or (b) duly executed (under seal, if required) by one or more Attorneys-in-Fact and Agents pursuant to the power prescribed in his or her certificate or their certificates of authority or by one or more Company officers pursuant to a written delegation of authority; and it is

**FURTHER RESOLVED**, that the signature of each of the following officers: President, any Executive Vice President, any Senior Vice President, any Vice President, any Assistant Vice President, any Secretary, any Assistant Secretary, and the seal of the Company may be affixed by facsimile to any Power of Attorney or to any certificate relating thereto appointing Resident Vice Presidents, Resident Assistant Secretaries or Attorneys-in-Fact for purposes only of executing and attesting bonds and undertakings and other writings obligatory in the nature thereof, and any such Power of Attorney or certificate bearing such facsimile signature or facsimile seal shall be valid and binding upon the Company and any such power so executed and certified by such facsimile signature and facsimile seal shall be valid and binding on the Company in the future with respect to any bond or understanding to which it is attached.

I, **Kevin E. Hughes**, the undersigned, Assistant Secretary of each of the Companies, do hereby certify that the above and foregoing is a true and correct copy of the Power of Attorney executed by said Companies, which remains in full force and effect.

Dated this **6th** day of **June**, 2021



  
Kevin E. Hughes, Assistant Secretary

**To verify the authenticity of this Power of Attorney, please call us at 1-800-421-3880.  
Please refer to the above-named Attorney(s)-in-Fact and the details of the bond to which this Power of Attorney is attached.**

ACKNOWLEDGMENT BY SURETY

STATE OF Illinois }  
County of Cook } ss.

On this 6th day of JUNE, 2024, before me personally  
appeared Peter S. Forker, known to, me to be the Attorney-in-Fact of  
Travelers Casualty and Surety Company of America

\_\_\_\_\_, the corporation  
that executed the within instrument, and acknowledged to me that such corporation executed the same.

IN WITNESS WHEREOF, I have hereunto set my hand and affixed my official seal, at my office in the aforesaid County, the day and  
year in this certificate first above written.

Oscar F. Rincon  
Notary Public in the State of Illinois  
County of Cook

