

# CUZZIN'S ITALIAN RESTAURANT

## INTERIOR BUILD-OUT

**CUZZIN'S RESTAURANT**  
8600 159TH STREET  
SUITE 4B  
ORLAND PARK, IL.

OWNER:  
**MARY LIGAMMARI**  
708-228-0060  
708-774-0774 cell

ARCHITECT:  
**DOUG FULLICK**  
doug@fullick.com  
708-420-3624 cell

### GENERAL NOTES

1. CONTRACTORS TO OBTAIN ALL LICENSES OR FEES REQUIRED TO WORK IN THE CITY OF ORLAND PARK (ILLINOIS), COOK COUNTY AND/OR THE STATE OF ILLINOIS.
2. MAXIMUM HOT WATER TEMPERATURE AT ALL HAND SINKS TO BE 110 DEGREES F.
3. SEPARATE QUADRS TO BE INSTALLED ON THE HAND SINK NEXT TO THE REFR SINK.

A-1  
COVER SHEET  
FLOOR PLAN  
SCHEDULES

A-2  
REFLECTED CEILING PLAN  
EQUIPMENT PLAN  
EQUIPMENT SCHEDULE



6 PROJECT LOCATION MAP  
SCALE: NTS

7 SHEET INDEX  
SCALE: NTS

Design Use Group(s) Classification (B 302.1)	Assembly
Construction Type (B 602)	III-B
Building/ Horizontal Projection Area (B 503.1)	2,831 Square Feet
Building Height in Feet (B 503.1)	10' for this permit
Number of Stories (B 503.1)	1
Required Number of Exits (B 1009)	Two
Number of Exits	Two
Occupant Load	72 Max. Dining Area Seats per Zoning +10 Employees 82 Total
Fire Protection per NFPA 72, 17A, 98 (B 903)	Required

- (Village Code Amendments (VC)) as of March 2007
- 2006 International Building Code with Amendments, Village Code, Title 5, Chapter 1
  - 2005 National Electrical Code with Amendments, Village Code, Title 5, Chapter 3
  - 2004 State of Illinois Plumbing Code with Amendments, Village Code, Title 5, Chapter 4
  - 2008 International Fire Code with Amendments, Village Code, Title 5, Chapter 5
  - 2000 International Mechanical Code with Amendments, Village Code, Title 5, Chapter 6
  - 2006 International Property Maintenance Code w/ Amendments, Village Code, Title 5, Chapter 7
  - 2008 Illinois Energy Conservation Code (IECC)
  - 1997 Illinois Accessibility Code

5 APPLICABLE CODES  
SCALE: NTS

4 PROJECT DATA  
SCALE: NTS

TAG#	TYPE	WIDTH	HEIGHT	MATERIAL	FRAME	RATING	NOTES
01	EXIST	12'-3 1/2"	7'-2"	ALUM.	ALUM.	-	PROVIDE PAINC HARDWARE TO EXIST DOOR
02	NEW	3'-0"	7'-2"	1-3/4" WOOD	WOOD	-	PROVIDE PAINC HARDWARE REMOVE 12X12 LITE
03	EXIST	3'-0"	7'-2"	1-3/4" HAZELNUT	HM	-	PROVIDE PAINC HARDWARE REMOVE SCREEN DOOR
04	EXIST	3'-0"	7'-2"	1-3/4" WOOD	WOOD	-	NO WORK PROPOSED
05	EXIST	3'-0"	7'-2"	1-3/4" WOOD	WOOD	-	NO WORK PROPOSED
06	NEW	3'-0"	7'-2"	1-3/4" WOOD	WOOD	-	PROVIDE PAINC HARDWARE
07	EXIST	3'-0"	7'-2"	1-3/4" WOOD	WOOD	-	PROVIDE LEVER TYPE HANDLE TO EXIST DOOR
08	EXIST	3'-0"	7'-2"	1-3/4" WOOD	WOOD	-	NO WORK PROPOSED
09	EXIST	3'-0"	7'-2"	1-3/4" WOOD	WOOD	-	NO WORK PROPOSED

3 DOOR SCHEDULE  
SCALE: NTS

ROOM	DESCRIPTION	FLOOR	CONING	WALLS	CEILING	NOTES
1	DINING AREA	0PT/CT	PTD./CT	PAINT/PP	ACT	
2	VESTIBLE	0PT	PTD. WOOD	PAINT	ACT	
3	KITCHEN	CT	CT	FR/SS	ACT/PP	
4	DRY STORAGE AREA	WCI	PTD. WOOD	PAINT/PP	ACT	
5	WOMEN TOILET ROOM	CT	CT	PAINT/CT	ACT	NO WORK PROPOSED
6	MEN TOILET ROOM	CT	CT	PAINT/CT	ACT	NO WORK PROPOSED
7	OFFICE	0PT	PTD. WOOD	PAINT	ACT	NO WORK PROPOSED
8	BUS STATION	CT	PTD. WOOD	PAINT	ACT	
9	CORRIDOR	0PT	PTD. WOOD	PAINT	ACT	

**LEGEND**  
 0PT = CARPET  
 CT = CERAMIC TILE  
 WCI = VINYL COMPOSITION TILE  
 PTD = PAINTED  
 ACT = ACROUSTICAL CEILING TILE  
 W = WOOD  
 FRP = FIBER REINFORCED PANEL  
 SS = STAINLESS STEEL

2 ROOM FINISH SCHEDULE  
SCALE: NTS

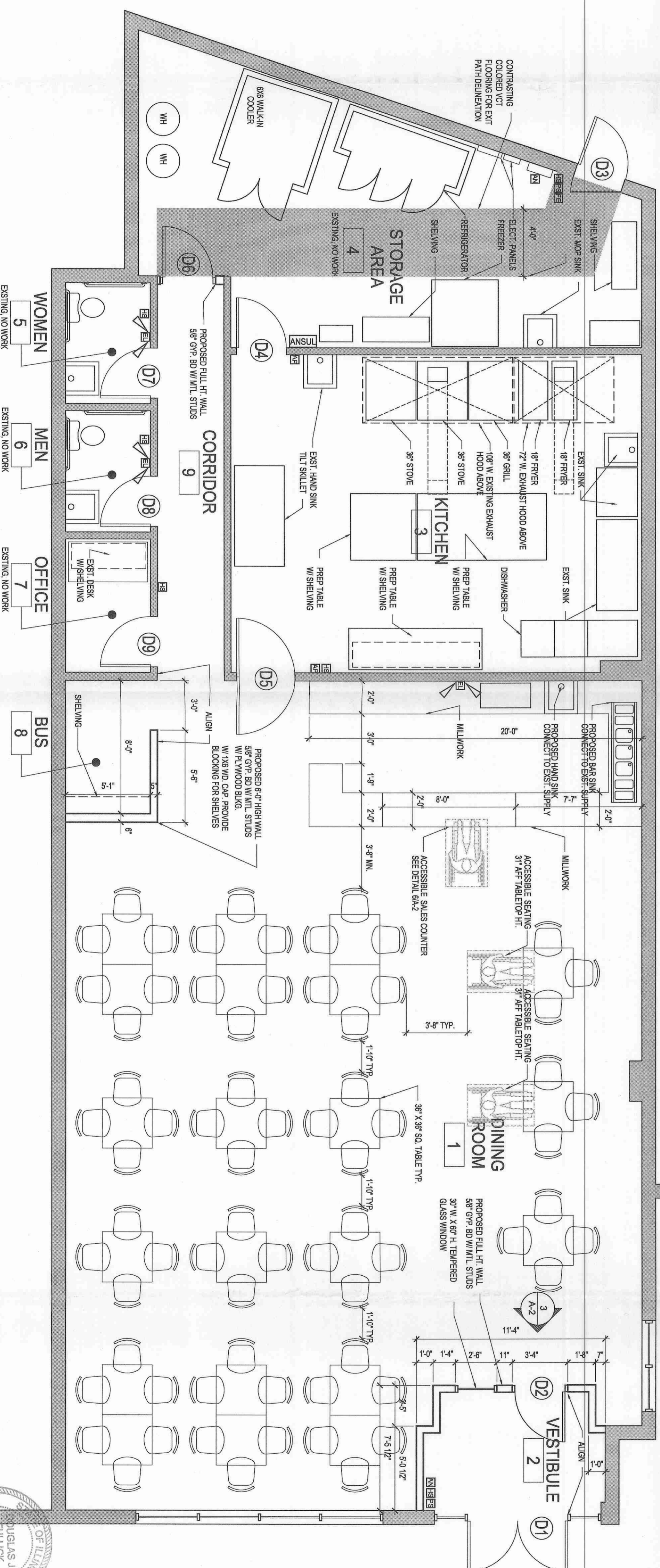

1 FLOOR PLAN  
SCALE: 1/4" = 1'-0"

### LEGEND

PROPOSED NEW PARTITION:  
 EXISTING WALL TO REMAIN:

A-1

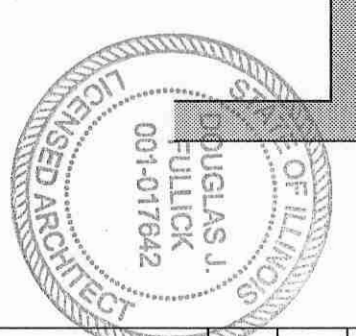

COVER SHEET  
FLOOR PLAN

NO.	REVISION/SITUATIONS	DATE	SHEET TITLE
1	ISSUED FOR PERMIT REVIEW	2/6/2010	COVER SHEET FLOOR PLAN
2	PERMIT RESUBMITTAL	2/6/2010	
3	PERMIT RESUBMITTAL	07/07/2010	

AS NOTED	SCALE	DESIGN BY	CHECKED BY	SHEET NUMBER
20/10-05	SCALE	DOUGLAS J. FULLICK	DOUGLAS J. FULLICK	A-1