

00+00 Sta 524+83.83

WOLF ROAD

525+00

143RD STREET

YUNKER SCHOOL SITE

PROMENADE PLAZA

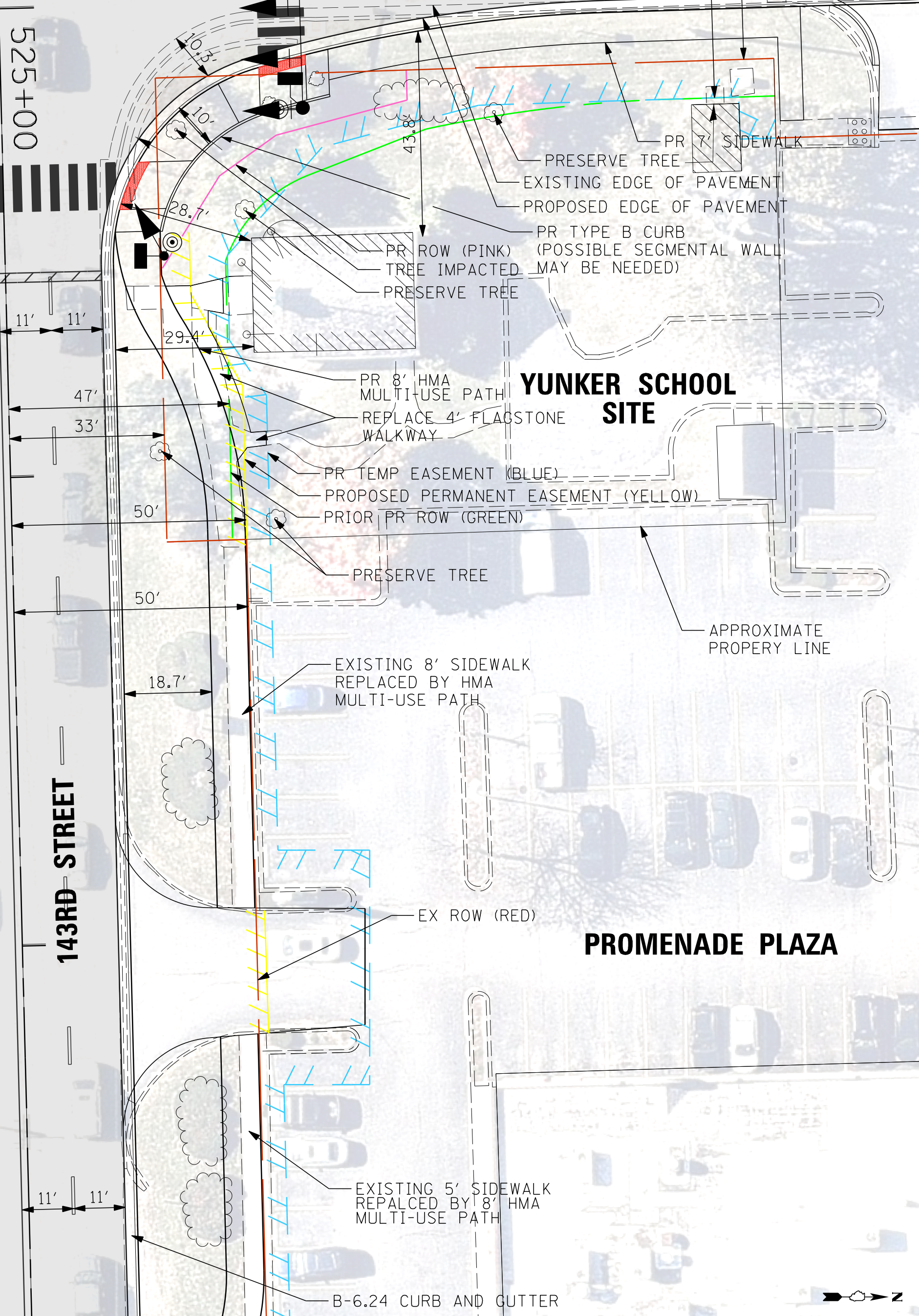

- PR 7' SIDEWALK
- PRESERVE TREE
- EXISTING EDGE OF PAVEMENT
- PROPOSED EDGE OF PAVEMENT
- PR TYPE B CURB
- PR ROW (PINK) (POSSIBLE SEGMENTAL WALL MAY BE NEEDED)
- TREE IMPACTED
- PRESERVE TREE
- PR 8' HMA MULTI-USE PATH
- REPLACE 4' FLAGSTONE WALKWAY
- PR TEMP EASEMENT (BLUE)
- PROPOSED PERMANENT EASEMENT (YELLOW)
- PRIOR PR ROW (GREEN)
- PRESERVE TREE
- EXISTING 8' SIDEWALK REPLACED BY HMA MULTI-USE PATH
- EX ROW (RED)
- EXISTING 5' SIDEWALK REPLACED BY 8' HMA MULTI-USE PATH
- B-6.24 CURB AND GUTTER

APPROXIMATE PROPERTY LINE

PRELIMINARY - SUBJECT TO CHANGE

**CB** CHRISTOPHER B. BURKE ENGINEERING, LTD.  
 9575 W. Higgins Road, Suite 600  
 Rosemont, Illinois 60018  
 (847) 823-0500

CLIENT:  
**VILLAGE OF ORLAND PARK**

DSGN.	MJM	TITLE:
DRW.	RPD	
CHKD.		
SCALE:	20'	
PLOT DATE:	11/2/2018	
CAD USER:	amf/legn	
FILE:	YunkerSchoolHouseEIR	
MODEL:	A11 2	

**YUNKER SCHOOL HOUSE**  
**WOLF ROAD ALT. 2 DESIGN**  
**PHASE I STUDY - 143RD STREET**

PROJ. NO. 140381
DATE: 11/2/2018
SHEET 1 OF 1
DRAWING NO.
EXH 2