

**CLERK'S CONTRACT and AGREEMENT COVER PAGE**

**Legistar File ID#:** 2021-0902

**Innoprise Contract #:** C22-040

**Year:** 2022

**Amount:** \$55,945.05

**Department:** Public Works

**Contract Type:**

**Contractors Name:** Trane

**Contract Description:** BAS Replacement



**TRANE**

## TRANE BUILDING ADVANTAGE AGREEMENT BAS R'NEWAL

### Trane Office

Trane U.S. Inc.  
7100 South Madison  
WILLOWBROOK, IL 60527

### Trane Representative

Erich Franks  
Cell: 630-740-2928  
Office: (630) 734-3200

### Proposal ID

3125768

### Contact Telephone Number for Service

(630) 734-3200

### Service Contract Number

3125768

### Company Name

Orland Park Health and Fitness  
15430 West Ave  
Orland Park, IL 60462

Charmaine O'Sullivan

### Site Address

Orland Park Health and Fitness  
15430 West Ave  
Orland Park, IL 60462  
United States

December 6, 2021

## SC+OPE OF SERVICES – STANDARD INCLUSIONS

The BAS R'newal is a multi-year program that provides a proactive approach to addressing your aging Building Automation System (BAS) and driving building and energy performance.

### BAS R'NEWAL PROGRAM INCLUDES:

- Extended warranty on Tracer SC+
- Tracer SC+ end user training
- Tracer SC+ software upgrades
- Customer BAS Migration Plan
- On-going Performance Reviews:
  - Tracer BAS Operations Review
  - Building Performance Assessments
  - Energy Check
- BAS R'newal Performance Report

Trane delivers the value by partnering with you to improve the performance of your Building Automation System. From the day we install the new system, we will be there to make sure your new product works as promised and stays up to date with the most current version and capabilities. We will be on-site to make sure you and your staff knows how to use the new product successfully, including the new mobile Tracer SC+ App.

We will provide a flexible migration plan for you so that if a unit controller fails unexpectedly, you will have a plan, or if you would like to be proactive with a planned replacement program, we can help make sure that the phases meet your budget and business needs.

We will actively help you utilize your new investment to make sure your BAS is performing its best. We will address the core building automation system basic control strategies and identify additional opportunities where you can improve and also save energy.

Finally, we will tell you how your BAS, HVAC & energy performance is improving with a formal BAS R'newal Report that will identify both our performance throughout the program as well as proactively address problem areas and provide recommendations on how to resolve and improve performance and drive lower costs.

### CONTROLS INSTALLATION

During the installation period, Trane will install the following Trane BAS:

- Tracer SC+ to replace the existing one (1) Trane BCU's
- Bring all programming of current PCM's into new Tracer SC+
- Trane Communication Bridge to allow your existing unit controllers to remain in place while still enjoying the latest building automation system web and Wireless Comm technology.
- Tracer Pro to run an analysis of the current system. This will identify any issues with unit controllers.
- Intelligent Services connection for Building Performance Assessment.

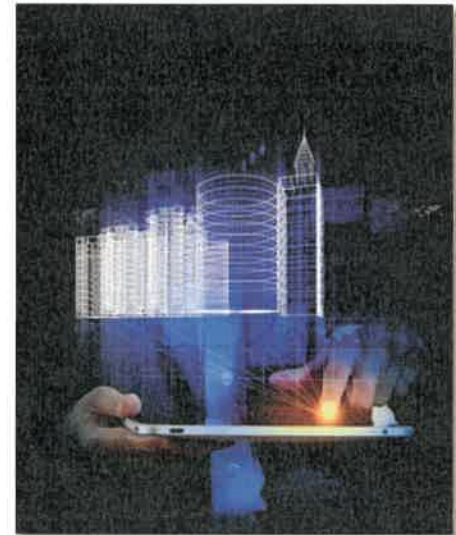



## CONTROLS SERVICES

After the installation of the new Tracer SC+, Trane will perform the following services throughout the program.

	Installation Period	Q1*	Q2*	Q3*	Q4*
YEAR 1	Install new Trane Tracer SC+ building controller and components  Connect to Trane intelligent services continuous monitoring & analytics platform	On-Site End User Training on new Tracer SC+  Tracer Ops Review & Correction  Initial Energy Check - BASELINE	Migration Plan & Customer Review	On-Site User Coaching session	Annual Energy Check - UPDATE  BAS R'newal Performance Report & Review





## EQUIPMENT

The following will be installed:

The following "Covered Equipment" will be serviced at Orland Park Health and Fitness:

Equipment	Qty	Manufacturer	Model Number	Serial Number	Asset Tag
Tracer Tracer SC+	1	Trane	BMSC+	TBD	



# PRICING AND ACCEPTANCE



Charmaine O'Sullivan  
Orland Park Health and Fitness  
15430 West Ave  
Orland Park, IL 60462

Site Address:  
Orland Park Health and Fitness  
15430 West Ave  
Orland Park, IL 60462

Purchase Amount
53,281.00

- Applicable taxes are not included and will be added to the invoice.
- Payment will be upon completion of Controls Installation project.
- Repairs of communication issues or repairs of system issues are not included in this proposal
- Pricing good for 30 days- Amount above reflects Jan 1, 2022 pricing.

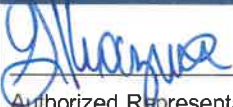
**This Agreement is subject to Customer's acceptance of the attached Trane Terms and Conditions (Service).**

CUSTOMER ACCEPTANCE	TRANE ACCEPTANCE
 _____ Authorized Representative	Trane U.S. Inc. _____ Submitted By: Erich Franks
 _____ Printed Name	Proposal Date: December 6, 2021 Cell: 630-740-2928 Office: (630) 734-3200 License Number:
 _____ Title	_____ Authorized Representative
_____ Purchase Order	_____ Title
_____ Acceptance Date	_____ Signature Date



LET'S GO BEYOND™

## TERMS AND CONDITIONS

“Company” shall mean Trane U.S. Inc. for Company performance in the United States and Trane Canada ULC for Company performance in Canada.

**1. Agreement.** These terms and conditions (“Terms”) are an integral part of Company’s offer and form the basis of any agreement (the “Agreement”) resulting from Company’s proposal (the “Proposal”) for the following commercial services as stated in the Proposal (collectively, the “Services”): inspection, maintenance and repair (the “Maintenance Services”) on equipment (the “Covered Equipment”), specified Additional Work (if any), and, if included in the Proposal, Intelligent Services, Energy Assessment, Energy Performance Solutions, and any other services using remote connectivity (collectively and individually referred to in these Terms as “Energy and Building Performance Services”). **COMPANY’S TERMS ARE SUBJECT TO PERIODIC CHANGE OR AMENDMENT.**

**2. Acceptance.** The Proposal is subject to acceptance in writing by the party to whom this offer is made or an authorized agent (“Customer”) delivered to Company within 30 days from the date of the Proposal. If Customer accepts the Proposal by placing an order, without the addition of any other terms and conditions of sale or any other modification, Customer’s order shall be deemed acceptance of the Proposal subject to these Terms and Conditions. If Customer’s order is expressly conditioned upon Company’s acceptance or assent to terms and/or conditions other than those expressed herein, return of such order by Company with Company’s Terms and Conditions attached or referenced serves as Company’s notice of objection to Customer’s terms and as Company’s counter-offer to perform in accordance with the Proposal and Company Terms and Conditions. If Customer does not reject or object in writing to Company within 10 days, Company’s counter-offer will be deemed accepted. Customer’s acceptance of performance by Company will in any event constitute an acceptance by Customer of Company’s Terms and Conditions. This Agreement is subject to credit approval by Company. Upon disapproval of credit, Company may delay or suspend performance or, at its option, renegotiate prices and/or Terms and Conditions with Customer. If Company and Customer are unable to agree on such revisions, this Agreement shall be cancelled without any liability, other than Customer’s obligation to pay for Services provided by Company to the date of cancellation.

**3. Fees and Taxes.** Fees for the Services (the “Service Fees”) are as set forth in the Proposal. Except as otherwise stated in the Proposal, Service Fees are based on performance during regular business hours. Charges for performance outside Company’s normal business hours shall be billed separately according to then prevailing overtime or emergency labor/labour rates. In addition to the stated Service Fees, Customer shall pay all taxes not legally required to be paid by Company or, alternatively, shall provide Company with an acceptable tax exemption certificate.

**4. Payment.** Payment is due upon receipt of Company’s invoice. Customer, an Illinois Municipal Corporation, shall make payment pursuant to the Illinois Local Government Prompt Payment Act, 50 ILCS 505/1 et seq.

**5. Customer Breach.** Each of the following constitutes a breach by Customer and shall give Company the right, without an election of remedies, to suspend performance or terminate this Agreement by delivery of written notice declaring termination. Upon termination, Customer shall be liable to the Company for all Services furnished to date and all damages sustained by Company (including lost profit and overhead): (a) Any failure by Customer to pay amounts when due;

(b) any general assignment by Customer for the benefit of its creditors, Customer’s bankruptcy, insolvency, or receivership; (c) Any representation or warranty furnished by Customer in connection with this Agreement is false or misleading in any material respect when made; or (d) Any failure by Customer to perform or comply with any material provision of this Agreement.

**5b. Company Breach.** Each of the following constitutes a breach by Company and shall give Customer the right, without an election of remedies, to suspend performance or terminate this Agreement by delivery of written notice declaring termination. Upon termination, Company shall be liable to Customer for all damages sustained by Customer (including lost profit and overhead): (a) any failure by Company to perform its obligations under this Agreement; (b) any general assignment by Company for the benefit of its creditors, Company’s bankruptcy, insolvency, or receivership; (c) Any representation or warranty furnished by Company in connection with this Agreement is false or misleading in any material respect when made; or (d) Any failure by Company to perform or comply with any material provision of this Agreement.

**6. Performance.** Company shall perform the Services in accordance with industry standards generally applicable in the state or province where the Services are performed under similar circumstances when Company performs the Services. Company may refuse to perform where working conditions could endanger property or put people at risk. Unless otherwise agreed by Customer and Company, at Customer’s expense and before the Services begin, Customer will provide any necessary access platforms, catwalks to safely perform the Services in compliance with OSHA, state, or provincial industrial safety regulations or any other applicable industrial safety standards or guidelines. This Agreement presupposes that all major pieces of Covered Equipment are in proper operating condition as of the date hereof. Services furnished are premised on the Covered Equipment being in a maintainable condition. In no event shall Company have any obligation to replace Covered Equipment that is no longer maintainable. During the first 30 days of this Agreement, or upon initial inspection, and/or upon seasonal start-up (if included in the Services), if an inspection by Company of Covered Equipment indicates repairs or replacement is required, Company will provide a written quotation for such repairs or replacement. If Customer does not authorize such repairs or replacement, Company may remove the unacceptable equipment from the Covered Equipment and adjust the Service Fees accordingly. Customer authorizes Company to utilize Customer’s telephone line or network infrastructure to connect to controls, systems and/or equipment provided or serviced by Company and to provide Services contracted for or otherwise requested by Customer, including remote diagnostic and repair service. Customer acknowledges that Company is not responsible for any adverse impact to Customer’s communications and network infrastructure. Company may elect to install/attach to Customer equipment or provide portable devices (hardware and/or software) for execution of control or diagnostic procedures. Such devices shall remain the personal proprietary property of Company and in no event shall become a fixture of Customer locations. Customer shall not acquire any interest, title or equity in any hardware, software, processes, and other intellectual or proprietary rights to devices used in connection with the Services on Customer equipment. Company may remove such devices at its discretion. Parts used for any repairs made will be those selected by Company as suitable for the repair and may be parts not manufactured by Company.

**7. Customer Obligations.** Customer shall: (a) Provide Company reasonable and safe access to the Covered Equipment and areas where Company is to work; (b) Follow manufacturer recommendations concerning teardown and internal inspection, major overhaul, restoration or refurbishing of the Covered Equipment; unless expressly stated in the SC+ope of Services statement, Company is not performing any manufacturer recommended teardown and internal inspection, major overhaul, restoration or refurbishing of the Covered Equipment; and (c) Where applicable, unless water treatment is expressly included in the Services, provide professional cooling tower water treatment in accordance with any reasonable recommendations provided by Company.

**8. Exclusions.** Unless expressly included in the Covered Equipment or the Services, the Services do not include, and Company shall not be responsible for or liable to the Customer for any claims, losses, damages or expenses suffered by the Customer in any way connected with, relating to or arising from, any of the following: (a) Any guarantee of room conditions or system performance; (b) Inspection, maintenance, repair, replacement of or services for: chilled water and condenser water pumps and piping; electrical disconnect switches or circuit breakers; motor starting equipment that is not factory mounted and interconnecting power wiring; recording or portable instruments, gauges or thermometers; non-moving parts or non-maintainable parts of the system, including, but not limited to, storage tanks; pressure vessels, shells, coils, tubes, housings, castings, casings, drain pans, panels, duct work; piping: hydraulic, hydronic, pneumatic, gas, or refrigerant; insulation; pipe covering; refractory material; fuses, unit cabinets; electrical wiring; ductwork or conduit; electrical distribution system; hydronic structural supports and similar items; the appearance of decorative casing or cabinets; damage sustained by other equipment or systems; and/or any failure, misadjustment or design deficiencies in other equipment or systems; (c) Damage, repairs or replacement of parts made necessary as a result of electrical power failure, low voltage, burned out main or branch fuses, low water pressure, vandalism, misuse or abuse, wear and tear, end of life failure, water damage, improper operation, unauthorized alteration of equipment, accident, acts or omissions of Customer or others, damage due to freezing weather, calamity, malicious act, or any Event of Force Majeure; (d) Any damage or malfunction resulting from vibration, electrolytic action, freezing, contamination, corrosion, erosion, or caused by SC+ale or sludge on internal tubes except where water treatment protection services are provided by Company as part of this Agreement; (e) Furnishing any items of equipment, material, or labor/labour, or performing special tests recommended or required by insurance companies or federal, state, or local governments; (f) Failure or inadequacy of any structure or foundation supporting or surrounding the equipment to be worked on or any portion thereof;



(g) Building access or alterations that might be necessary to repair or replace Customer's existing equipment; (h) The normal function of starting and stopping equipment or the opening and closing of valves, dampers or regulators normally installed to protect equipment against damage; (i) Valves that are not factory mounted: balance, stop, control, and other valves external to the device unless specifically included in the Agreement; (j) Any responsibility for design or redesign of the system or the Covered Equipment, obsolescence, safety tests, or removal or reinstallation of valve bodies and dampers; (k) Any services, claims, or damages arising out of Customer's failure to comply with its obligations under this Agreement; (l) Failure of Customer to follow manufacturer recommendations concerning teardown and internal inspection, overhaul and refurbishing of equipment; (m) Any claims, damages, losses, or expenses, arising from or related to conditions that existed in, on, or upon the premises before the effective date of this Agreement ("Pre-Existing Conditions"), including, without limitation, damages, losses, or expenses involving pre-existing building envelope issues, mechanical issues, plumbing issues, and/or indoor air quality issues involving mold/mould and/or fungi; (n) Replacement of refrigerant is excluded, unless replacement of refrigerant is expressly stated as included within the Services, in which case replacement shall in no event exceed the stated percentage of rated system charge per year expressly stated in the Services; (o) crane or rigging costs; (p) Any Services, claims, or damages arising out of refrigerant not supplied by Trane. Customer shall be responsible for: (i) The cost of any additional replacement refrigerant; (ii) Operation of any equipment; and (iii) Any claims, damages, losses, or expenses, arising from or related to work done by or services provided by individuals or entities that are not employed by or hired by Company.

**9. Limited Warranty.** Company warrants that: (a) the material manufactured by Company and provided to Customer in performance of the Services is free from defects in material and manufacture for a period of 12 months from the earlier of the date of equipment start-up or replacement; and (b) the labor/labour portion of the Maintenance Services and Additional Work has been properly performed for a period of 90 days from date of completion (the "Limited Warranty"). Company obligations of equipment start-up, if any are stated in the Proposal, are coterminous with the Limited Warranty period. Defects must be reported to Company within the Limited Warranty period. Company's obligation under the Limited Warranty is limited to repairing or replacing the defective part at its option and to correcting any labor/labour improperly performed by Company. No liability whatsoever shall attach to Company until the Maintenance Services and

Additional Work have been paid for in full. Exclusions from this Warranty include claims, losses, damages and expenses in any way connected with, related to or arising from failure or malfunction of equipment due to the following: wear and tear; end of life failure; corrosion; erosion; deterioration; Customer's failure to follow the Company-provided maintenance plan; unauthorized or improper maintenance; unauthorized or improper parts or material; refrigerant not supplied by Trane; and modifications made by others to equipment. Company shall not be obligated to pay for the cost of lost refrigerant or lost product. Some components of equipment manufactured by Company may be warranted directly from the component supplier, in which case this Limited Warranty shall not apply to those components and any warranty of such components shall be the warranty given by such component supplier. Notwithstanding the foregoing, all warranties provided herein terminate upon termination or cancellation of this Agreement. Equipment, material and/or parts that are not manufactured by Company are not warranted by Company and have such warranties as may be extended by the respective manufacturer. **THE REMEDIES SET FORTH IN THIS LIMITED WARRANTY ARE THE SOLE AND EXCLUSIVE REMEDIES FOR WARRANTY CLAIMS PROVIDED BY COMPANY TO CUSTOMER UNDER THIS AGREEMENT AND ARE IN LIEU OF ALL OTHER WARRANTIES AND LIABILITIES, LIABILITIES, CONDITIONS AND REMEDIES, WHETHER IN CONTRACT, WARRANTY, STATUTE OR TORT (INCLUDING NEGLIGENCE), EXPRESS OR IMPLIED, IN LAW OR IN FACT, INCLUDING ANY IMPLIED WARRANTIES OF MERCHANTABILITY AND FITNESS FOR A PARTICULAR PURPOSE AND/OR OTHERS ARISING FROM COURSE OF DEALING OR TRADE. COMPANY EXPRESSLY DISCLAIMS ANY REPRESENTATIONS OR WARRANTIES, ENDORSEMENTS OR CONDITIONS OF ANY KIND, EXPRESS OR IMPLIED, INCLUDING ANY IMPLIED WARRANTIES OF QUALITY, FITNESS, MERCHANTABILITY, DURABILITY AND/OR OTHERS ARISING FROM COURSE OF DEALING OR TRADE OR REGARDING PREVENTION BY THE SCOPE OF SERVICES, OR ANY COMPONENT THEREOF, OF MOLD/MOULD, FUNGUS, BACTERIA, MICROBIAL GROWTH, OR ANY OTHER CONTAMINATES. COMPANY EXPRESSLY DISCLAIMS ANY LIABILITY IF THE SCOPE OF SERVICES OR ANY COMPONENT THEREOF IS USED TO PREVENT OR INHIBIT THE GROWTH OF SUCH MATERIALS. THE ENERGY AND BUILDING PERFORMANCE SERVICES ARE PROVIDED ON AN "AS IS" BASIS WITHOUT WARRANTIES OF ANY KIND.**

**10. Indemnity.** To the maximum extent permitted by law, Company and Customer shall indemnify and hold harmless each other from any and all claims, actions, costs, expenses, damages and liabilities, including reasonable attorneys' fees, resulting from death or bodily injury or damage to real or personal property, to the extent caused by the negligence or misconduct of the indemnifying party, and/or its respective employees or other authorized agents in connection with their activities within the scope of this Agreement. Neither party shall indemnify the other against claims, damages, expenses, or liabilities to the extent attributable to the acts or omissions of the other party or third parties. If the parties are both at fault, the obligation to indemnify shall be proportional to their relative fault. The duty to indemnify and hold harmless will continue in full force and effect, notwithstanding the expiration or early termination of this Agreement, with respect to any claims based on facts or conditions that occurred prior to expiration or termination of this Agreement.

**11. Limitation of Liability. NOTWITHSTANDING ANYTHING TO THE CONTRARY, NEITHER PARTY SHALL BE LIABLE FOR SPECIAL, INCIDENTAL, INDIRECT, OR CONSEQUENTIAL LOSSES OR DAMAGES OF ANY KIND (INCLUDING WITHOUT LIMITATION REFRIGERANT LOSS, PRODUCT LOSS, LOST REVENUE OR PROFITS, OR LIABILITY TO THIRD PARTIES), OR PUNITIVE DAMAGES WHETHER BASED IN CONTRACT, WARRANTY, STATUTE, TORT (INCLUDING NEGLIGENCE), STRICT LIABILITY, INDEMNITY OR ANY OTHER LEGAL THEORY OR FACTS. NOTWITHSTANDING ANY OTHER PROVISION OF THIS AGREEMENT, THE TOTAL AND AGGREGATE LIABILITY OF THE COMPANY TO THE CUSTOMER WITH RESPECT TO ANY AND ALL CLAIMS CONNECTED WITH, RELATED TO OR ARISING FROM THE PERFORMANCE OR NON-PERFORMANCE OF THIS AGREEMENT, WHETHER BASED IN CONTRACT, WARRANTY, STATUTE, TORT (INCLUDING NEGLIGENCE), STRICT LIABILITY, INDEMNITY OR ANY OTHER LEGAL THEORY OR FACTS, SHALL NOT EXCEED THE COMPENSATION RECEIVED BY COMPANY OVER THE 12 MONTH PERIOD PRECEDING THE DATE OF OCCURRENCE FOR THE SERVICES AND ADDITIONAL WORK FOR THE LOCATION WHERE THE LOSS OCCURRED. IN NO EVENT SHALL COMPANY BE LIABLE FOR ANY DAMAGES (WHETHER DIRECT OR INDIRECT) RESULTING FROM MOLD/MOULD, FUNGUS, BACTERIA, MICROBIAL GROWTH, OR OTHER CONTAMINATES OR AIRBORNE BIOLOGICAL AGENTS. TO THE MAXIMUM EXTENT ALLOWED BY LAW, COMPANY SHALL NOT BE LIABLE FOR ANY OF THE FOLLOWING IN CONNECTION WITH PROVIDING THE ENERGY AND BUILDING PERFORMANCE SERVICES: INTERRUPTION, DELETION, DEFECT, DELAY IN OPERATION OR TRANSMISSION; CUSTOMER'S NETWORK SECURITY; COMPUTER VIRUS; COMMUNICATION FAILURE; THEFT OR DESTRUCTION OF DATA; GAPS IN DATA COLLECTED; AND UNAUTHORIZED ACCESS TO CUSTOMER'S DATA OR COMMUNICATIONS NETWORK.**

**12. Asbestos and Hazardous Materials.** The Services expressly exclude any identification, abatement, cleanup, control, disposal, removal or other work connected with asbestos polychlorinated biphenyl ("PCB"), or other hazardous materials (collectively, "Hazardous Materials"). Customer warrants and represents that there are no Hazardous Materials on the premises that will in any way affect Company's performance, except as set forth in a writing signed by Company disclosing the existence and location of any Hazardous Materials in all areas within which Company will be performing. Should Company become aware of or suspect the presence of Hazardous Materials, Company may immediately stop work in the affected area and notify Customer. Customer will be responsible for correcting the condition in accordance with all applicable laws and regulations. Customer shall be exclusively responsible for and shall indemnify and hold harmless Company (including its employees, agents and subcontractors) from and against any loss, claim, liability, fees, penalties, injury (including death) or liability of any nature, and the payment thereof, arising out of or relating to any Hazardous Materials on or about the premises, not brought onto the premises by Company. Company shall be required to resume performance only in the absence of Hazardous Materials or when the affected area has been rendered harmless. In no event shall Company be obligated to transport or handle Hazardous Materials, provide any notices to any governmental agency, or examine the premises site for the presence of Hazardous Materials.

**13. Insurance.** Company agrees to maintain the following insurance during the term of this Agreement with limits not less than shown below and will, upon request from Customer, provide a Certificate of evidencing the following coverage:

Commercial General Liability	\$2,000,000 per occurrence
Automobile Liability	\$2,000,000 CSL
Workers Compensation	Statutory Limits

If Customer has requested to be named as an additional insured under Company's insurance policy, Company will do so but only subject to Company's manuscript additional insured endorsement under its primary Commercial General Liability policies. In no event does Company or its insurer waive rights of subrogation.





LET'S GO BEYOND™

**14. Force Majeure.** Company's duty to perform under this Agreement is contingent upon the non-occurrence of an Event of Force Majeure. If Company is unable to carry out any material obligation under this Agreement due to an Event of Force Majeure, this Agreement shall at Company's election (i) remain in effect but Company's obligations shall be suspended until the uncontrollable event terminates or (ii) be terminated upon 10 days notice to Customer, in which event Customer shall pay Company for all parts of the Services furnished to the date of termination. An "Event of Force Majeure" shall mean any cause or event beyond the control of Company. Without limiting the foregoing, "Event of Force Majeure" includes: acts of God; acts of terrorism, war or the public enemy; flood; earthquake; lightning; tornado; storm; fire; civil disobedience; pandemic; insurrections; riots; labor/labour disputes; labor/labour or material shortages from the usual sources of supply; sabotage; restraint by court order or public authority (whether valid or invalid), and action or non-action by or inability to obtain or keep in force the necessary governmental authorizations, permits, licenses, certificates or approvals if not caused by Company; and the requirements of any applicable government in any manner that diverts either the material or the finished product to the direct or indirect benefit of the government.

**15. Maintenance Services Other Than Solely Scheduled Service.** If Company's Maintenance Services hereunder are not limited solely to Scheduled Service, the following provisions shall also apply: (a) Required restoration shall be performed by Customer at its cost prior to Company being obligated to perform hereunder; (b) any changes, adjustments, service or repairs made to the Equipment by any party other than Company, unless approved by Company in writing, may, at Company's option, terminate Company's obligation to render further service to the Equipment so affected; in such case no refund of any portion of the Service Fees shall be made; and (c) Customer shall (i) promptly notify Company of any unusual performance of Equipment; (ii) permit only Company personnel to repair or adjust Equipment and/or controls during the Term or a Renewal Term; and (iii) utilize qualified personnel to properly operate the Equipment in accordance with the applicable operating manuals and recommended procedures.

**16. General.** Except as provided below, to the maximum extent provided by law, this Agreement is made and shall be interpreted and enforced in accordance with the laws of the state or province in which Company performs the Services. Any dispute arising under or relating to this Agreement shall be decided by litigation in a court of competent jurisdiction located in the state or province in which the Services are performed. To the extent the premises are owned and/or operated by any agency of the United States Federal Government, determination of any substantive issue of law shall be according to the United States Federal common law of Government contracts as enunciated and applied by United States Federal judicial bodies and boards of contract appeals of the United States Federal Government. This Agreement contains all of the agreements, representations and understandings of the parties and supersedes all previous understandings, commitments or agreements, oral or written, related to the Services. If any term or condition of this Agreement is invalid, illegal or incapable of being enforced by any rule of law, all other Terms of this Agreement will nevertheless remain in full force and effect as long as the economic or legal substance of the transaction contemplated hereby is not affected in a manner adverse to any party hereto. Customer may not assign, transfer, or convey this Agreement, or any part hereof, without the written consent of Company. Subject to the foregoing, this Agreement shall bind and inure to the benefit of the parties hereto and their permitted successors and assigns. This Agreement may be executed in several counterparts, each of which when executed shall be deemed to be an original, but all together shall constitute but one and the same Agreement. A fully executed facsimile copy hereof or the several counterparts shall suffice as an original. Customer may not assign, transfer, or convey this Agreement, or any part hereof, or its right, title or interest herein, without the written consent of Company. Subject to the foregoing, this Agreement shall be binding upon and inure to the benefit of the parties' respective successors and assigns. No failure or delay by the Company in enforcing any right or exercising any remedy under this Agreement shall be deemed to be a waiver by the Company of any right or remedy.

**17. Equal Employment Opportunity/Affirmative Action Clause.** Company is a federal contractor that complies fully with Executive Order 11246, as amended, and the applicable regulations contained in 41 C.F.R. Parts 60-1 through 60-60, 29 U.S.C. Section 793 and the applicable regulations contained in 41 C.F.R. Part 60-741; and 38 U.S.C. Section 4212 and the applicable regulations contained in 41 C.F.R. Part 60-250 Executive Order 13496 and Section 29 CFR 471, appendix A to subpart A, regarding the notice of employee rights in the United States and with Canadian Charter of Rights and Freedoms Schedule B to the Canada Act 1982 (U.K.) 1982, c. 11 and applicable Provincial Human Rights Codes and employment law in Canada.

**18. U.S. Government Services.** The following provision applies only to direct sales by Company to the US Government. The Parties acknowledge that all items or services ordered and delivered under this Agreement are Commercial Items as defined under Part 12 of the Federal Acquisition Regulation (FAR). In particular, Company agrees to be bound only by those Federal contracting clauses that apply to "commercial" suppliers and that are contained in FAR 52.212-5(e)(1). Company complies with 52.219-8 or 52.219-9 in its service and installation contracting business. The following provision applies only to indirect sales by Company to the US Government. As a Commercial Item Subcontractor, Company accepts only the following mandatory flow down provisions: 52.219-8; 52.222-26; 52.222-35; 52.222-36; 52.222-39; 52.247-64. If the Services are in connection with a U.S. Government contract, Customer certifies that it has provided and will provide current, accurate, and complete information, representations and certifications to all government officials, including but not limited to the contracting officer and officials of the Small Business Administration, on all matters related to the prime contract, including but not limited to all aspects of its ownership, eligibility, and performance. Anything herein notwithstanding, Company will have no obligations to Customer unless and until Customer provides Company with a true, correct and complete executed copy of the prime contract. Upon request, Customer will provide copies to Company of all requested written communications with any government official related to the prime contract prior to or concurrent with the execution thereof, including but not limited to any communications related to Customer's ownership, eligibility or performance of the prime contract. Customer will obtain written authorization and approval from Company prior to providing any government official any information about Company's performance of the Services that are the subject of the Proposal or this Agreement, other than the Proposal or this Agreement.

**19. Limited Waiver of Sovereign Immunity.** If Customer is an Indian tribe (in the U.S.) or a First Nation or Band Council (in Canada), Customer, whether acting in its capacity as a government, governmental entity, a duly organized corporate entity or otherwise, for itself and for its agents, successors, and assigns:

(1) hereby provides this limited waiver or its sovereign immunity as to any damages, claims, lawsuit, or cause of action (herein "Action") brought against Customer by Company and arising or alleged to arise out of the furnishing by Company of any product or service under this Agreement, whether such Action is based in contract, tort, strict liability, civil liability or any other legal theory; (2) agrees that jurisdiction and venue for any such Action shall be proper and valid (a) if Customer is in the U.S., in any state or United States court located in the state in which Company is performing this Agreement or (b) if Customer is in Canada, in the superior court of the province or territory in which the work was performed; (3) expressly consents to such Action, and waives any objection to jurisdiction or venue; (4) waives any requirement of exhaustion of tribal court or administrative remedies for any Action arising out of or related to this Agreement; and (5) expressly acknowledges and agrees that Company is not subject to the jurisdiction of Customer's tribal court or any similar tribal forum, that Customer will not bring any action against Company in tribal court, and that Customer will not avail itself of any ruling or direction of the tribal court permitting or directing it to suspend its payment or other obligations under this Agreement. The individual signing on behalf of Customer warrants and represents that such individual is duly authorized to provide this waiver and enter into this Agreement and that this Agreement constitutes the valid and legally binding obligation of Customer, enforceable in accordance with its terms.

**20. Assignment.** Company shall not assign the duties and obligations involved in the performance of any services pursuant to this Agreement without the written consent of the Village, and shall not transfer any interest on this Agreement (whether by assignment or notation) without prior written consent of the Village; provided, however, that claims for money by the Company may be assigned to a bank, trust company, or other financial institution without such approval. Written notice of any intent to assign or transfer shall be furnished promptly to the Village by the Company."

**21. Compliance with Laws.** Company agrees to comply with all federal, state and local laws, ordinances, statutes, rules and regulations in the performance of its duties and obligations under this Agreement.

**22. Entire Agreement.** The parties acknowledge that the scope of this agreement does not involve any Connected Services. Therefore, both parties expressly agree that the Trane Connected Services Terms of Use do not apply to this Agreement. This Agreement consists of the following documents: Proposal ID 3125768, including the Trane Terms & Conditions, and this Rider. In the event of any conflict between the two documents, this Rider controls."





## ADDITIONAL REMARKS SCHEDULE

AGENCY	NAMED INSURED Trane U.S. Inc. dba Trane 7100 South Madison Street Willowbrook, IL 60527 United States
EFFECTIVE DATE:	

### ADDITIONAL REMARKS

THIS ADDITIONAL REMARKS FORM IS A SCHEDULE TO ACORD FORM,

FORM NUMBER: \_\_\_\_\_ FORM TITLE: \_\_\_\_\_

Village of Orland Park is included as Additional Insured where required by contract with respect to General Liability pursuant to applicable endorsement.

Village of Orland Park are included as Additional Insured where required by contract with respect to Automobile Liability pursuant to applicable endorsement.

Waiver of Subrogation is applicable where required by written contract, but only to the extent of the Named Insured's negligence.

Job Description: HVAC Building Services

For questions regarding this certificate of insurance contact: Susan Johnson Email: smjohnson@trane.com Phone: 6307343200

**ENDORSEMENT # MAN001**

This endorsement, effective 12:01 A.M. 04/17/2021 forms a part of  
policy No. GL 654-70-64 issued to TRANE TECHNOLOGIES COMPANY LLC  
BY NATIONAL UNION FIRE INSURANCE COMPANY OF PITTSBURGH, PA

**ADDITIONAL INSURED - WHERE REQUIRED UNDER CONTRACT OR AGREEMENT**

*This endorsement modifies insurance provided under the following:*

COMMERCIAL GENERAL LIABILITY COVERAGE FORM

**SECTION II – WHO IS AN INSURED**, is amended to include as an additional insured:

- (1) Any person or organization to whom you become obligated to include as an additional insured under this policy, as a result of any written contract or agreement you enter into which requires you to furnish insurance to that person or organization of the type provided by this policy, but only with respect to liability to the extent caused by you and arising out of your operations, including both continuing and completed operations, or premises owned by or rented to you; or
- (2) Any designated person or organization, designated by you in writing to us, but only with respect to liability to the extent caused by you and arising out of your operations or premises owned by or rented to you and provided the "bodily injury", "property damage" or "personal and advertising injury" occurs subsequent to your written request to designate such person or organization as additional insured.

However, the insurance provided will not exceed the lesser of:

- The coverage and/or limits of this policy, or
- The coverage and/or limits required by said contract or agreement.

All other terms and conditions remain unchanged.

  
\_\_\_\_\_  
Authorized Representative



## WAIVER OF TRANSFER OF RIGHTS OF RECOVERY AGAINST OTHERS TO US

This endorsement modifies insurance provided under the following:

COMMERCIAL GENERAL LIABILITY COVERAGE PART  
PRODUCTS/COMPLETED OPERATIONS LIABILITY COVERAGE PART

### SCHEDULE

**Name Of Person Or Organization:**

PURSUANT TO APPLICABLE CONTRACT OR AGREEMENT YOU ENTER INTO.

Information required to complete this Schedule, if not shown above, will be shown in the Declarations.

The following is added to Paragraph **8. Transfer Of Rights Of Recovery Against Others To Us** of **Section IV - Conditions**:

We waive any right of recovery we may have against the person or organization shown in the Schedule above because of payments we make for injury or damage arising out of your ongoing operations or "your work" done under a contract with that person or organization and included in the "products-completed operations hazard". This waiver applies only to the person or organization shown in the Schedule above.





**WORKERS COMPENSATION  
AND  
EMPLOYERS LIABILITY POLICY**

**ENDORSEMENT WC 00 03 13 (00) - 001**

POLICY NUMBER: UB-8M35413A-21-51-K

**WAIVER OF OUR RIGHT TO RECOVER FROM OTHERS ENDORSEMENT**

We have the right to recover our payments from anyone liable for an injury covered by this policy. We will not enforce our right against the person or organization named in the Schedule. (This agreement applies only to the extent that you perform work under a written contract that requires you to obtain this agreement from us.)

This agreement shall not operate directly or indirectly to benefit any one not named in the Schedule.

**SCHEDULE**

**DESIGNATED PERSON:**

**DESIGNATED ORGANIZATION:**

**ANY PERSON OR ORGANIZATION FOR WHICH THE INSURED HAS AGREED  
BY WRITTEN CONTRACT EXECUTED PRIOR TO LOSS TO FURNISH THIS  
WAIVER.**

Any person or organization for which the employer has agreed by written contract, executed prior to loss, may execute a waiver of subrogation. However, for purposes of work performed by the employer in Missouri, this waiver of subrogation does not apply to any construction group of classifications as designated by the waiver of right to recover from others (subrogation) rule in our manual.



