

# SHEET NOTES

1. FURNISH AND INSTALL ONE (1) TYPE EA FIXTURE ON EXISTING POLE (AT HEIGHT TO MATCH THE EXISTING HEADS) AND CONNECT TO EXISTING WIRING/CIRCUITRY COMPLETE AS REQUIRED. CONTACT THE MANUFACTURER FOR POLE DRILLING PATTERN. VERIFY CONDITIONS AND REQUIREMENTS IN FIELD.

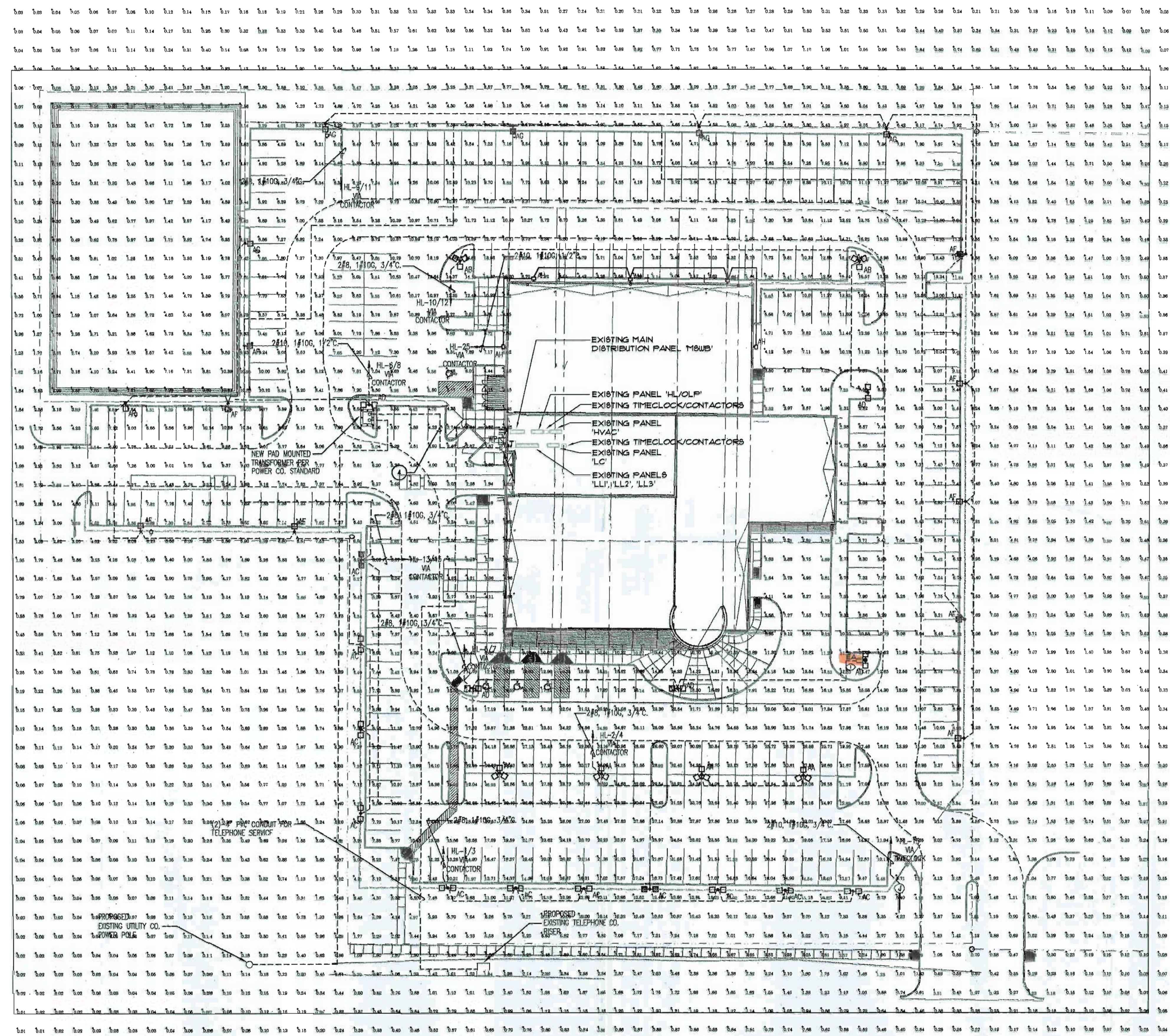

SEAL

BOARD APPROVED  
 CASE NO. 2008-055  
 DATE 12-1-08  
 W/CONDITIONS  
 W/O CONDITIONS

3
2
1

REVISIONS

SHEET TITLE  
**COMPOSITE SITE PLAN  
 PHOTOMETRIC OF BASE  
 BID AND EXISTING**

PROJECT NO:  
 08-04-58  
 DRAWN BY:  
 AM  
 CHECKED BY:  
 DJ  
 DATE: 11/24/08

**r.l. miller & associates, inc.**  
 CONSULTING ENGINEERS  
 9711 VALPARAISO DRIVE  
 SUITE A  
 MUNSTER, IN 46321  
 (219) 924-8400  
 (708) 474-0104  
 FAX (219) 924-5082  
 rlm@rmlinc.com

PROJECT  
**COMMUNITY HONDA**  
 PHASE I SITE LIGHTING IMPROVEMENT  
 ORLAND PARK, ILLINOIS

SHEET NO.  
**E1P**  
 (2)

Symbol	Qty	Label	Arrangement	LFP	Description
⊙	1	EA	SINGLE	1.000	KVE2 400M ASY HB
⊙	4	AA	2 @ 180 DEGREES	0.700	KVE3 1000M SYM
⊙	2	AB	0 @ 180 DEGREES	0.900	KVE4 1000M SYM
⊙	11	AC	FWIN	0.400	KVE2 400M ASY HB
⊙	5	AD	BACK-SIDE	0.600	KVE2 400M SYM
⊙	10	AF	SINGLE	0.600	KVE4 1000M SYM
⊙	5	AO	SINGLE	0.600	KVE3 1000M ASY HB

TAG	SYMBOL	DESCRIPTION	MANUFACTURER SERIES OR CATALOG NUMBER	VOLTAGE/BALLAST	LAMPS/CROSS SECTION	MOUNTING	REMARKS
EA	⊙	25" SQUARE SHOEBOX STYLE FIXTURE WITH ASYMMETRIC DISTRIBUTION WITH HOUSE SIDE SHIELD	LITHONIA KVE2-400M-ASY-400-RPVD6-H6 (WITH COLOR SELECTED BY OWNER) MOUNTED ON EXISTING POLE	400 VOLT	ONE (1) 400W MH VERTICAL	ON EXISTING POLE	

Label	CalcType	Units	Avg	Max	Min	AvgMin	MaxMin
TOTL	Illuminance	Fc	4.69	34.81	0.91	288.00	3480